

Montech X5M

MONTECH X5M Micro ATX Gaming PC Case Instruction Manual

Model: X5M

1. INTRODUCTION

This manual provides detailed instructions for the installation, operation, and maintenance of your MONTECH X5M Micro ATX Gaming PC Case. The X5M is designed for high airflow and features four pre-installed 120mm ARGB fans, a glass side panel, and carbon fiber print accents. Please read this manual thoroughly before beginning assembly to ensure proper setup and optimal performance.



Figure 1.1: Front view of the MONTECH X5M Micro ATX Gaming PC Case. This image displays the case's overall design, including the mesh front panel with three ARGB fans and the tempered glass side panel, offering a clear view of the interior.

2. SETUP AND INSTALLATION

Follow these steps for proper installation of your components into the MONTECH X5M case.

2.1 Component Compatibility

The X5M case offers excellent compatibility for various hardware components.

- **GPU Support:** Supports graphics cards up to 410mm in length, accommodating the latest high-performance models.
- **CPU Cooler Support:** Compatible with mainstream CPU coolers, with a maximum height of 165mm.
- **PSU Support:** Standard ATX Power Supply Units are supported, with a maximum length of 230mm.
- **Storage Support:** Up to 2 HDDs and 4 SSDs can be installed.
- **Motherboard Compatibility:** Designed for Micro ATX motherboards.

Excellent Hardware Compatibility

GeForce RTX™ 50 Series Supported
Mainstream CPU Cooler Supported
Standard ATX PSU Supported
Up to 2 HDDs & 4 SSDs
Storage Supported



Figure 2.1: Internal component compatibility and dimensions. This diagram illustrates the maximum supported sizes for the GPU (405mm), CPU Cooler (165mm), and Power Supply (230mm), along with locations for SSDs and HDDs.

2.2 Cooling System Installation

The X5M case provides superior cooling potential with extensive fan and radiator support.

- **Front:** Supports 3 x 120mm fans, 2 x 140mm fans, or radiators up to 360mm.
- **Top:** Supports 3 x 120mm fans, 2 x 140mm fans, or radiators up to 360mm.
- **Rear:** Supports 1 x 120mm fan.
- **PSU Shroud:** Supports 2 x 120mm fans.

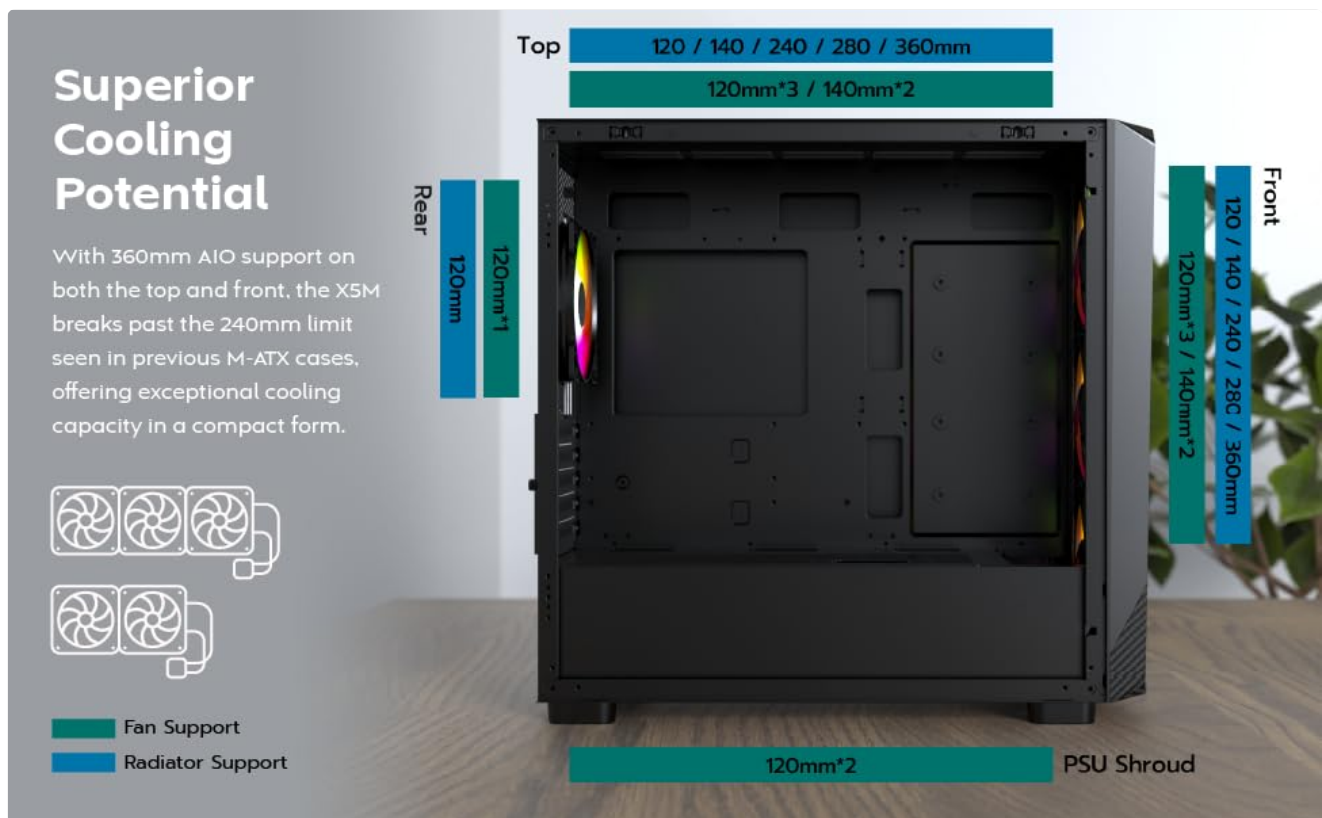

Figure 2.2: Cooling potential and fan/radiator support. This image details the various fan and radiator mounting options on the front, top, rear, and PSU shroud of the case, including supported sizes.

3. OPERATING INSTRUCTIONS

3.1 ARGB Fan Control

The MONTECH X5M comes with four pre-installed 120mm ARGB fans. These fans can be controlled in two ways:

- **Dedicated LED Button:** Use the LED button on the top I/O panel to cycle through 25 built-in lighting modes.
- **Motherboard Synchronization:** For advanced control, connect the ARGB fans to a compatible motherboard header (e.g., ASUS Aura Sync, ASRock Polychrome Sync, MSI Mystic Light Sync, GIGABYTE RGB Fusion 2.0) to synchronize lighting effects with other components.

Ready to Flow & Glow

Pre-installed with 4 ARGB fans. Choose from 25 built-in lighting modes using the dedicated LED button, or take full control through motherboard synchronization.



120mm X 4
1400RPM



Figure 3.1: ARGB fan functionality and airflow. This image demonstrates the pre-installed ARGB fans and their lighting capabilities, along with the directional airflow within the case.

3.2 Front I/O Panel Connectivity

The top I/O panel provides convenient access to various ports for your peripherals.

- **USB Type-C Port:** For modern devices requiring high-speed data transfer.
- **USB 3.0 Port:** For fast data transfer with compatible USB 3.0 devices.
- **USB 2.0 Port:** For standard USB devices.
- **Mic & Audio Jacks:** Separate ports for microphone input and audio output.
- **LED Button:** Controls the ARGB lighting modes of the pre-installed fans.
- **Power Button:** To power on/off your system.



Figure 3.2: Versatile connectivity options on the top I/O panel. This image clearly labels each port and button on the front panel for easy identification and use.

4. MAINTENANCE

Regular maintenance helps ensure the longevity and optimal performance of your PC case and its components.

- **Dust Filters:** Periodically clean the dust filters (if applicable) to maintain optimal airflow and prevent dust buildup inside the case.
- **Interior Cleaning:** Use compressed air to remove dust from internal components and fans. Ensure the system is powered off and unplugged before cleaning.
- **Exterior Cleaning:** Wipe the exterior surfaces with a soft, damp cloth. Avoid abrasive cleaners or solvents that could damage the finish or carbon fiber accents.
- **Cable Management:** Periodically check cable routing to ensure no cables are obstructing airflow or fan operation.

5. TROUBLESHOOTING

This section addresses common issues you might encounter with your PC case.

Issue	Possible Cause	Solution
Fans are not spinning or lighting up.	Loose power or ARGB connection; fan controller issue; motherboard ARGB header not enabled.	Check all fan power cables and ARGB connections. Ensure the fan controller (if used) is powered. Verify motherboard BIOS settings for ARGB headers. Try cycling ARGB modes with the dedicated LED button.

Issue	Possible Cause	Solution
Front panel USB ports are not working.	Loose internal USB header connection to motherboard; incorrect driver installation.	Ensure the USB 2.0, USB 3.0, and USB Type-C cables from the front panel are securely connected to the correct headers on your motherboard. Install or update motherboard chipset drivers.
System overheating.	Insufficient airflow; dust buildup; incorrect fan orientation.	Ensure all fans are spinning and oriented correctly for optimal airflow (front intake, rear/top exhaust). Clean dust filters and internal components. Verify CPU cooler and GPU cooler are properly installed.
Power button unresponsive.	Loose front panel header connection; faulty power supply.	Check the power switch cable connection to the motherboard's front panel header. Ensure the power supply is receiving power and functioning correctly.

6. SPECIFICATIONS



Feature	Detail
Brand	Montech
Model Name	X5M
Case Type	Micro ATX Mid Tower
Motherboard Compatibility	Micro ATX
Material	Plastic with Carbon Fiber Accents, Tempered Glass Side Panel
Color	Black
Item Weight	14.3 pounds (6.49 kg)
Package Dimensions	21.06 x 19.69 x 10.94 inches (53.5 x 50 x 27.8 cm)
GPU Length Support	Up to 410mm
CPU Cooler Height Support	Up to 165mm
PSU Length Support	Up to 230mm
Pre-installed Fans	4 x 120mm ARGB Fans
Front I/O Ports	1 x USB Type-C, 1 x USB 3.0, 1 x USB 2.0, Mic, Audio, LED Button, Power Button
Cooling Method	Air

7. WARRANTY AND SUPPORT

For warranty information and technical support, please refer to the official Montech website or contact Montech customer service directly. Keep your proof of purchase for warranty claims.

Montech Official Website: www.montechpc.com

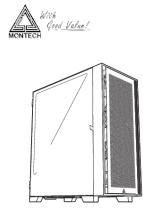
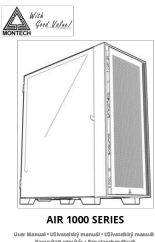
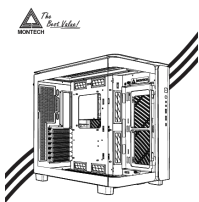
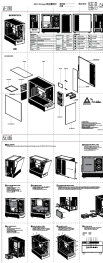
Related Documents - X5M

 <p>AIR 1000 SERIES</p>	<p>Montech AIR 1000 Series PC Case: Specifications and Installation Guide</p> <p>Comprehensive specifications, features, and installation guidance for the Montech AIR 1000 Series PC case, detailing component compatibility, cooling support, and accessory contents.</p>
 <p>AIR 1000 SERIES</p>	<p>Montech AIR 1000 Series PC Case User Manual</p> <p>User manual for the Montech AIR 1000 Series PC case, covering specifications, installation, compatibility, and ARGB controller features. Includes content in English, Czech, Slovak, Hungarian, and German.</p>
 <p>KING 95</p>	<p>Montech KING 95 PC Case User Manual and Specifications</p> <p>Detailed specifications, component breakdown, and installation guides for the Montech KING 95 and KING 95 PRO PC cases. Learn about fan and radiator support, drive bay configurations, I/O interfaces, and cable management.</p>
	<p>Montech XR PC Case: Specifications and Installation Guide</p> <p>Detailed specifications, features, and installation instructions for the Montech XR computer case, including component compatibility and assembly steps.</p>
 <p>SKY TWO</p>	<p>Montech SKY TWO PC Case User Manual</p> <p>Comprehensive user manual for the Montech SKY TWO PC case, detailing specifications, component installation (motherboard, GPU, PSU, SSD/HDD, radiators, fans), and I/O port functions. Includes multilingual support information.</p>

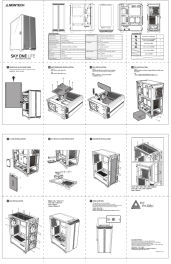

[Montech Sky One Lite ATX Case Installation Guide](#)

A comprehensive guide to installing components in the Montech Sky One Lite ATX computer case, covering motherboard, GPU, PSU, SSD, HDD, and radiator installations, along with fan and ARGB control.