

Anderic MRAC06S1M

Anderic MRAC06S1M Ceiling Fan Receiver Instruction Manual

Model: MRAC06S1M

PRODUCT OVERVIEW

The Anderic MRAC06S1M is a replacement ceiling fan receiver specifically designed for use with Harbor Breeze Mazon ceiling fans. This receiver facilitates the remote control functionality of your ceiling fan, managing fan speeds and light operation. It is engineered for a plug-and-play installation, connecting directly into the fan's motor assembly via a square plug connector.

This receiver is compatible with various Harbor Breeze Mazon models, including 0807421, 2599776, 1059534, MZ44WW3LR, MZ44MBLK3LR, and others. It also works seamlessly with existing Anderic remote models such as RRTR214D, A25-FA0138, KUJCE10311, TR214B, KUJCE10712, TR214A, KUJCE10610, and 2BB78ITLF304C.

IMPORTANT SAFETY INFORMATION

- Always disconnect power to the ceiling fan at the circuit breaker before attempting any installation, maintenance, or troubleshooting.
- Installation should be performed by a qualified electrician or a person with sufficient electrical knowledge to ensure safety and proper function.
- Ensure all wire connections are secure and properly insulated.
- This receiver is designed for specific fan models and connector types. Verify compatibility before installation. If your fan uses standard wire connections at the canopy, this receiver will not be compatible for plug-and-play installation.
- Do not exceed the maximum load ratings for the motor (1.0A) and light (100W incandescent / 60W LED).

PACKAGE CONTENTS

- Anderic MRAC06S1M Ceiling Fan Receiver (1 unit)
- Instruction Manual (this document)

Note: Remote control is not included and must be purchased separately if needed. This receiver is designed to work with existing compatible remotes.

SETUP AND INSTALLATION

The Anderic MRAC06S1M receiver is designed for a straightforward plug-and-play installation into compatible Harbor Breeze Mazon ceiling fans. Ensure your fan's existing receiver uses a square plug connector for direct replacement.

Pre-Installation Checklist:

1. Verify that your ceiling fan model is listed as compatible or uses a square plug connector for its receiver.
2. Ensure you have the necessary tools (e.g., screwdriver, wire strippers if any wiring adjustments are needed, though typically not for plug-and-play).
3. Confirm power is OFF at the circuit breaker before proceeding.

Installation Steps:

1. **Disconnect Power:** Turn off the power to the ceiling fan at the main circuit breaker. Verify power is off using a voltage tester.
2. **Access Fan Housing:** Carefully lower the canopy or access the motor housing of your ceiling fan where the existing receiver is located.
3. **Remove Old Receiver:** Disconnect the existing receiver from the fan's wiring. Note the orientation and connection points if possible, though the square plug design simplifies this.
4. **Install New Receiver:** Connect the Anderic MRAC06S1M receiver into the fan's motor assembly. The square plug connector should fit directly into the corresponding port. Ensure it is seated firmly.
5. **Secure Receiver:** Carefully tuck the receiver and wires back into the fan housing, ensuring no wires are pinched.
6. **Restore Power:** Replace the fan canopy and turn the power back on at the circuit breaker.
7. **Test Functionality:** Use your compatible remote control to test the fan speeds and light operation.



Figure 1: Front view of the Anderic MRAC06S1M receiver, showing its compact design and integrated wiring with the square plug connector.



Figure 2: Angled view of the receiver, clearly showing the distinctive square plug connector essential for plug-and-play compatibility with Harbor Breeze Mazon fans.



Figure 3: Back view of the receiver, displaying the product label with model number MRAC06S1M-LD-F0, input voltage (AC120V 60Hz), and maximum load ratings for motor and light.



Figure 4: Side view of the receiver, showing the capacitor specifications (5+6UF/250V) and a QC Pass sticker, indicating quality control inspection.

Important Note on Compatibility:

This receiver is designed for fans where the receiver connects directly into the motor assembly with a square plug. If your existing receiver connects at the canopy with standard wire connections (individual wires that need to be spliced or connected via wire nuts), this MRAC06S1M receiver will **not** be a plug-and-play replacement and may not be compatible without significant modification.

OPERATING INSTRUCTIONS

Once the Anderic MRAC06S1M receiver is correctly installed, it will enable remote control functionality for your ceiling fan. This receiver is designed to work with specific Anderic and compatible remote models.

Compatible Remote Controls:

The MRAC06S1M receiver is fully compatible with the following remote control models:

- Anderic RRTR214D
- A25-FA0138
- KUJCE10311
- TR214B

- KUJCE10712
- TR214A
- KUJCE10610
- 2BB78ITLF304C

Note: The TR214D remote control is often required for initial pairing or full functionality and is not included with the receiver.

Pairing the Remote (if necessary):

Most compatible remotes will automatically pair or have a simple pairing procedure. Refer to your specific remote control's instruction manual for detailed pairing steps. Typically, this involves:

1. Ensure power to the fan is on.
2. Within a short timeframe (e.g., 30 seconds) of restoring power, press and hold a specific button on the remote (often a "Learn" button, "Fan Off" button, or a combination of buttons) until the fan light blinks or the fan responds.
3. Test all functions (fan speeds, light on/off, dimming if applicable).

MAINTENANCE

The Anderic MRAC06S1M receiver is a sealed electronic component and requires minimal maintenance. Follow these guidelines to ensure its longevity:

- **Keep Dry:** Ensure the receiver is installed in a dry environment, protected from moisture and humidity.
- **Cleanliness:** If accessing the receiver during fan maintenance, gently wipe away any dust or debris with a dry, soft cloth. Do not use liquid cleaners.
- **Ventilation:** Ensure the fan housing allows for adequate airflow around the receiver to prevent overheating.
- **Power Surges:** Consider using surge protection for your home's electrical system to protect electronic components like the receiver from power fluctuations.

TROUBLESHOOTING

If you experience issues with your ceiling fan after installing the MRAC06S1M receiver, refer to the following common problems and solutions:

Problem: Fan or Light Does Not Respond to Remote

- **No Power:** Check the circuit breaker to ensure power is supplied to the fan.
- **Remote Batteries:** Replace the batteries in your remote control.
- **Remote Pairing:** Attempt to re-pair the remote control with the receiver. Refer to the "Operating Instructions" section or your remote's manual.
- **Incorrect Remote:** Ensure you are using a compatible remote control model.
- **Loose Connection:** Turn off power at the breaker, then re-check the square plug connection of the receiver within the fan housing to ensure it is secure.

Problem: Fan Operates Intermittently or Incorrectly

- **Interference:** Other electronic devices or nearby remote controls might cause interference. Try

operating the fan from a different distance or checking for other active remotes.

- **Overload:** Ensure the fan motor and light wattage do not exceed the receiver's maximum load ratings (1.0A for motor, 100W incandescent / 60W LED for light).
- **Damaged Receiver:** If all other troubleshooting steps fail, the receiver may be faulty and require replacement.

Problem: Light Flickers or Does Not Turn On

- **Bulb Issue:** Check if the light bulb is properly screwed in or if it needs replacement.
- **Wattage Exceeded:** Ensure the light bulb wattage does not exceed the receiver's maximum rating (60W for LED, 100W for incandescent).
- **Wiring:** With power off, check the light wiring connection to the receiver.

If problems persist after following these steps, consult a qualified electrician or contact Anderic customer support.

SPECIFICATIONS

Feature	Detail
Model Name	MRAC06S1M
Manufacturer Model No.	MRAC06S1M-LD-F0
Brand	Anderic
Input Voltage	AC120V 60Hz
Max Load Motor	1.0A
Max Load Light (Incandescent)	100W
Max Load Light (LED)	60W
Operating Temperature (Ta)	40°C
Color	Black
Item Weight	3.36 ounces
Controller Type	Button Control (via compatible remote)
Special Feature	Plug-in-play, Must pair with TR214D remote (not included)
UPC	191713654939

WARRANTY AND SUPPORT

For warranty information and customer support regarding your Anderic MRAC06S1M Ceiling Fan Receiver, please contact Anderic directly or refer to their official website. Keep your purchase receipt as proof of purchase.

Anderic Official Website: www.anderic.com

For further assistance, you may also refer to the product page on Amazon: [Amazon Product Page](#)

Related Documents - MRAC06S1M

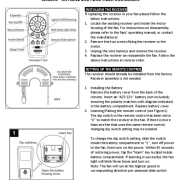
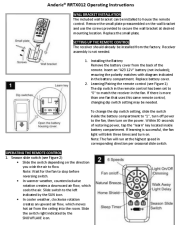
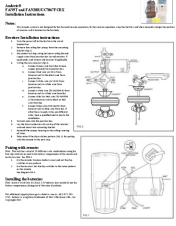
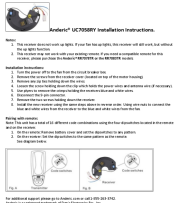
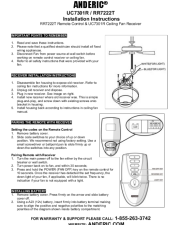
	<p>Anderic RRTX012 & FD40-H02R Ceiling Fan Remote Control Instructions</p> <p>Comprehensive guide for the Anderic RRTX012 and FD40-H02R ceiling fan remote controls, covering installation, setup, battery replacement, remote pairing, and detailed operation of fan speeds, lighting, timers, and special features like Home Shield and Walk Away Light Delay.</p>
	<p>Anderic RRTX012 Remote Control Operating Instructions</p> <p>Operating instructions for the Anderic RRTX012 ceiling fan remote control, covering wall bracket installation, remote setup, battery installation, pairing, and detailed operation of fan speeds, natural breeze, light functions, walk-away light delay, home shield, sleep timer, and power off memory.</p>
	<p>Anderic FAN9T and FAN28R/UC7067FCRX Installation Instructions</p> <p>Detailed installation guide for the Anderic FAN9T and FAN28R/UC7067FCRX ceiling fan remote control system, including receiver wiring, remote pairing, and battery installation.</p>
	<p>Anderic UC7058RY Ceiling Fan Receiver Installation Guide</p> <p>Detailed installation and pairing instructions for the Anderic UC7058RY ceiling fan receiver. Includes notes on compatibility with Anderic RR7078TR and RR7083TR remotes. Provides step-by-step guidance for setup and remote synchronization.</p>
	<p>Anderic UC7301R / RR7222T Ceiling Fan Remote & Receiver Installation Guide</p> <p>Step-by-step installation instructions for the Anderic UC7301R Ceiling Fan Receiver and RR7222T Remote Control, covering important safety points, receiver installation, remote pairing, and battery replacement.</p>

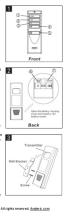

User manual for the ANDERIC® RRTX001R Remote Control, detailing battery installation, pairing instructions, product functions, and wall mount bracket installation.