



Manuals.plus /

› Pastigio /

› Pastigio Digital Frame Power Adapter User Manual (Models M15R2, Frame156, Frame157)

Pastigio M15R2, Frame156, Frame157

Pastigio Digital Frame Power Adapter User Manual

Models: M15R2, Frame156, Frame157

1. INTRODUCTION

Thank you for choosing the Pastigio Digital Frame Power Adapter. This adapter is designed to provide reliable power to your compatible digital picture frames, including Pastigio 15.6 inch models Frame156, M15R2, and Frame157. This manual provides essential information for safe and effective use, setup, operation, and maintenance of your power adapter.

Package Contents:

- 1x Pastigio Digital Frame Power Adapter (DC power cord)

Note: The digital picture frame device is not included.

2. SAFETY INFORMATION

Please read all safety instructions carefully before using this product. Failure to follow these instructions may result in electric shock, fire, or other hazards.

- **Indoor Use Only:** This adapter is designed for indoor use in dry locations. Do not expose to water, rain, or excessive humidity.
- **Proper Voltage:** Ensure the wall outlet voltage matches the adapter's input voltage range (100V-240V).
- **Avoid Overloading:** Do not overload electrical outlets or extension cords.
- **Secure Connection:** Always ensure the adapter is fully inserted into the wall outlet and the DC plug is securely connected to your device. A loose connection can cause overheating.
- **Handle with Care:** Do not drop, disassemble, or attempt to repair the adapter. Refer all servicing to qualified personnel.
- **Cable Integrity:** Regularly inspect the power cord for any damage. Do not use if the cord is frayed, cut, or otherwise damaged.

- **Keep Away from Children:** Store the adapter out of reach of children.
- **Unplug When Not in Use:** Disconnect the adapter from the power outlet when not in use for extended periods.

3. SETUP

Follow these steps to properly set up your Pastigio Digital Frame Power Adapter:

1. **Verify Compatibility:** Ensure your digital picture frame requires a 12V DC input and has a 4.0mm x 1.7mm DC plug port. This adapter is specifically designed for Pastigio 15.6 inch digital picture frames (Frame156, M15R2, Frame157).
2. **Connect to Device:** Insert the small DC plug end of the adapter into the power input port on your digital picture frame. Ensure a firm and secure connection.
3. **Connect to Power Outlet:** Plug the US standard two-prong plug of the adapter into a standard 100V-240V AC wall outlet. The adapter features polarized blades for a secure connection.

Universal DC Output Tip

(4.0 x 1.7mm universal DC port)

▲ DC tip polarity: inner positive+, outer negative-

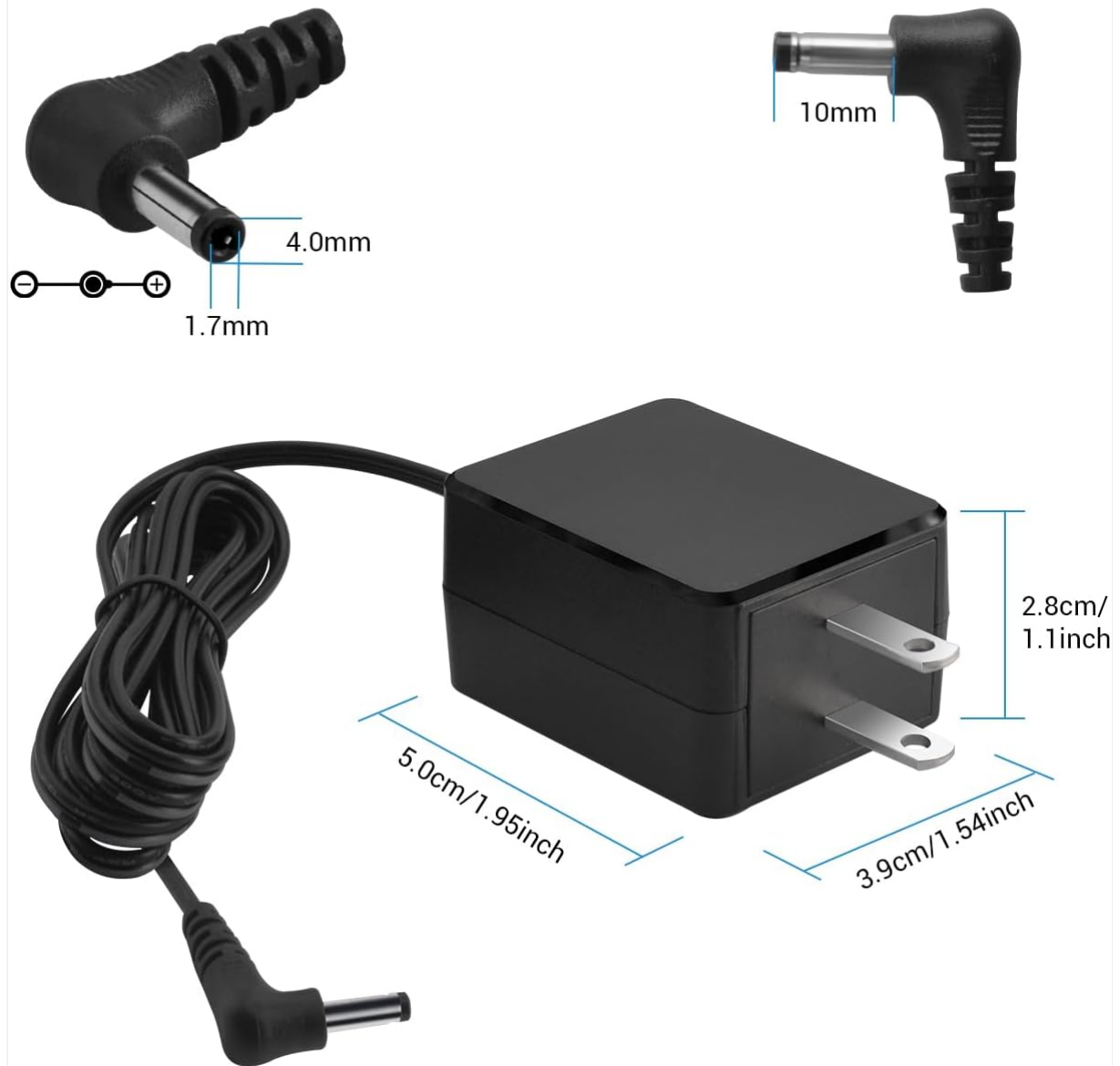

Image 1: Overview of the Pastigio Digital Frame Power Adapter, showing the DC output tip dimensions (4.0mm x 1.7mm) and the adapter's overall dimensions. The DC tip polarity is inner positive (+), outer negative (-).



Image 2: Close-up view of the US standard (Type A) plug on the Pastigio Digital Frame Power Adapter, featuring polarized blades for secure connection.

4. OPERATING INSTRUCTIONS

Once the adapter is properly connected to both your digital picture frame and a power outlet, it will begin supplying power. The adapter is designed for continuous operation with compatible devices.

- The adapter automatically converts the input voltage (100V-240V AC) to the required 12V DC output for your device.
- The extra-long 1.8-meter (5.9 ft) cable provides flexibility in device placement.
- Ensure the digital picture frame's power indicator (if available) illuminates, confirming power reception.

5. MAINTENANCE

Proper maintenance ensures the longevity and safe operation of your power adapter.

- **Cleaning:** Disconnect the adapter from the power outlet and your device before cleaning. Use a soft, dry cloth to wipe the exterior. Do not use liquid cleaners or abrasive materials.
- **Storage:** When not in use, store the adapter in a cool, dry place, away from direct sunlight and extreme temperatures. Avoid tightly coiling the cable to prevent damage.
- **Inspection:** Periodically inspect the adapter and cable for any signs of wear, cuts, or damage. If damage is found, discontinue use immediately and replace the adapter.

6. TROUBLESHOOTING

If you encounter issues with your power adapter, refer to the following common problems and solutions:

Problem	Possible Cause	Solution
Digital frame does not power on.	<ul style="list-style-type: none">• Adapter not properly plugged into outlet.• DC plug not fully inserted into frame.• Power outlet is not active.• Adapter or cable is damaged.• Digital frame issue.	<ul style="list-style-type: none">• Ensure the adapter is firmly plugged into a working wall outlet.• Verify the DC plug is securely connected to the digital frame's power port.• Test the outlet with another device to confirm it has power.• Inspect the adapter and cable for visible damage. If damaged, replace the adapter.• If the adapter is working, the issue might be with the digital frame itself.
Adapter feels warm during use.	Normal operation.	A slight warmth is normal during operation. If the adapter becomes excessively hot to the touch or emits a burning smell, unplug it immediately and discontinue use.

7. SPECIFICATIONS

Feature	Detail
Input Voltage	100V-240V AC (Universal)
Output Voltage / Current	12V DC / 1.5A (18W)
Connector Size	4.0mm x 1.7mm DC Plug
Cable Length	1.8 meters (5.9 ft)
Plug Type	US Standard (Type A), Polarized
Color	Black
Product Dimensions	4.3 x 2.9 x 0.99 inches (Adapter body)
Item Weight	3.2 ounces
Compatible Devices	Pastigio 15.6 inch Digital Picture Frames (Frame156, M15R2, Frame157)

8. WARRANTY AND SUPPORT

For warranty information and customer support, please refer to the documentation provided with your purchase or contact the seller directly. You can also visit the official Pastigio store on Amazon for more information: [Pastigio Store](#).

Please retain your proof of purchase for any warranty claims.