

[Manuals.plus](#) /

> [Roinvou](#) /

> Roinvou 6.8-inch Single Din Car Radio User Manual

Roinvou 2d214637-876e-49d6-bcc3-1b4563fe8da1

Roinvou 6.8-inch Single Din Car Radio User Manual

Model: 2d214637-876e-49d6-bcc3-1b4563fe8da1

[Introduction](#) [Package Contents](#) [Product Overview](#) [Installation](#) [Basic Operation](#) [Connectivity](#) [Audio](#)
[Features](#) [Advanced Features](#) [Specifications](#) [Troubleshooting](#) [Maintenance](#) [Warranty & Support](#)

1. INTRODUCTION

This manual provides detailed instructions for the installation, operation, and maintenance of your Roinvou 6.8-inch Single Din Car Radio. This unit features a high-definition IPS touchscreen, Wireless Apple CarPlay, Wireless Android Auto, Bluetooth 5.2, FM radio, EQ sound adjustment, and multiple connectivity options including USB and Type-C fast charging. Please read this manual thoroughly before use to ensure proper functionality and safety.



Image: Overview of the Roinvou 6.8-inch Single Din Car Stereo, showcasing its IPS touchscreen, Mirror Link, FM, Bluetooth, EQ, USB/Type-C, and 6.86-inch display.

2. PACKAGE CONTENTS

Verify that all items are present in the package before proceeding with installation.

- Single Din Car Stereo Unit

- Power Cable
- Horn Cable
- External Microphone
- D-Bus Cable
- Steering Wheel Control Cable
- Backup Camera (12 LED)
- Remote Control
- User Manual

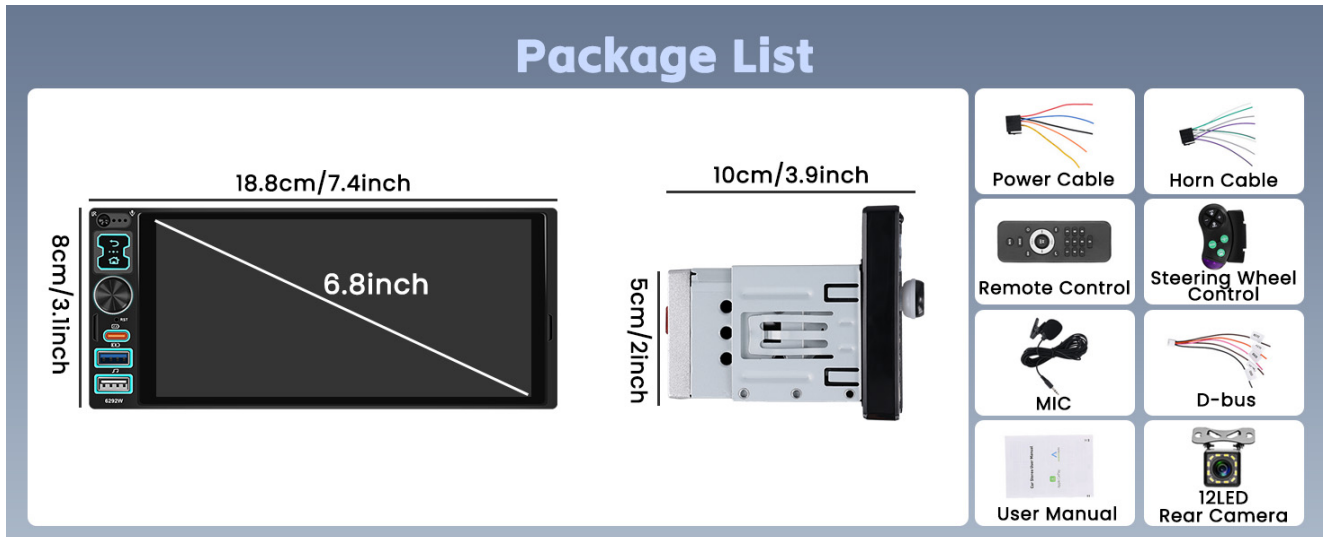

Image: Visual representation of the car stereo dimensions (18.8cm/7.4inch width, 8cm/3.1inch height, 10cm/3.9inch depth, 5cm/2inch height of the single din chassis) and the complete package list including cables, remote, microphone, and backup camera.

3. PRODUCT OVERVIEW

3.1 Front Panel Features

The front panel features a 6.8-inch IPS touchscreen display with a physical rotary knob for volume control and other functions. The highly responsive touch screen allows for smooth navigation between interfaces.

3.2 Rear Panel Connections

The rear panel provides various input and output ports for power, audio, video, and peripheral connections.

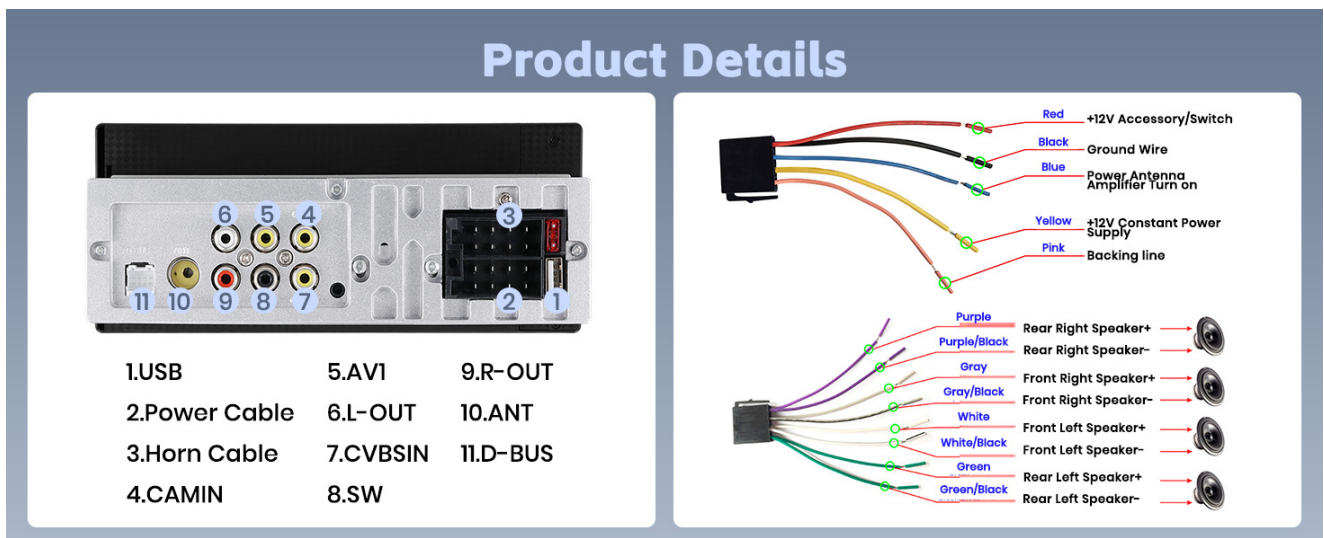

Image: Rear view of the Roinvou car stereo showing labeled ports (USB, Power Cable, Horn Cable, CAMIN, AVI, L-OUT, CVBSIN, SW, R-OUT, ANT, D-BUS) and a color-coded wiring harness diagram for power, speakers, and other connections.

4. INSTALLATION GUIDE

Professional installation is recommended. Ensure the vehicle's power is disconnected before starting installation.

4.1 Wiring Connections

1. **Power Cable:** Connect the yellow wire to the constant 12V supply, the red wire to the accessory/ignition switch, and the black wire to ground.
2. **Speaker Wires:** Connect the speaker wires (Purple, Gray, White, Green) to your vehicle's corresponding speaker outputs, ensuring correct polarity (+/-).
3. **Antenna:** Connect the car antenna to the ANT port.
4. **Backup Camera:** Connect the backup camera video input to the CAMIN port and the power/trigger wire as per the camera's instructions.
5. **Steering Wheel Control (SWC):** Connect the SWC wires to your vehicle's steering wheel control interface. Refer to your vehicle's manual for specific wiring.
6. **External Microphone:** Plug the external microphone into the dedicated MIC input for improved call quality.

4.2 Mounting the Unit

Secure the single din chassis into your vehicle's dashboard opening. Ensure the unit is firmly mounted to prevent vibrations and movement during driving.

5. BASIC OPERATION

5.1 Power On/Off

Press the power button (usually located on the front panel or via the physical knob) to turn the unit on or off. The unit will automatically power on when the vehicle's ignition is turned on.

5.2 Touchscreen Interface

The 6.8-inch IPS touchscreen operates like a smartphone. Tap icons to select functions, swipe to navigate menus, and use pinch-to-zoom gestures where applicable.



Image: Examples of the car stereo's user interface (UI) display, showing various application icons and settings menus. Below, a demonstration of the 7-color button backlight customization options.

5.3 Volume Control

Use the physical rotary knob on the front panel to adjust the volume. Turn clockwise to increase volume, counter-clockwise to decrease. Press the knob to mute/unmute.

6. CONNECTIVITY FEATURES

6.1 Wireless Apple CarPlay & Android Auto

Connect your iPhone or Android smartphone wirelessly to access navigation, music, calls, and messages directly from the car stereo's display. Siri or Google Assistant can be used for voice commands.

- Ensure Bluetooth and Wi-Fi are enabled on your smartphone.
- Select the CarPlay or Android Auto icon on the stereo's main menu.
- Follow the on-screen prompts to pair your device.

Wireless Carplay/Android Auto

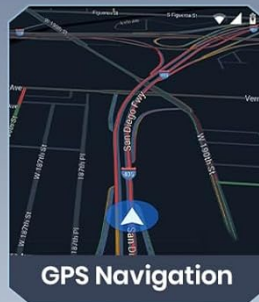
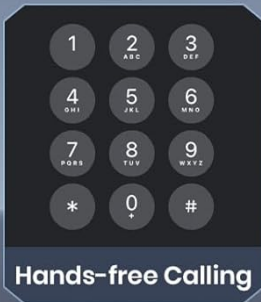

Android Auto



Carplay



Image: Display showing the Wireless CarPlay and Android Auto interfaces, highlighting features such as hands-free calling, online music streaming, GPS navigation, and access to various mobile applications.

Wireless Carplay & Android Auto



Image: A visual overview illustrating the seamless integration of Wireless CarPlay and Android Auto with the car stereo, displaying common app icons.

6.2 MirrorLink (iOS/Android)

MirrorLink allows you to display your smartphone's screen directly onto the car stereo. This feature supports both iOS and Android devices.

- Connect your phone via USB or Wi-Fi as prompted by the MirrorLink application on the stereo.
- Follow the instructions to enable screen mirroring.



Image: A visual comparison showing a car's interior before and after installation, with the car stereo displaying a mirrored smartphone screen via Mirror Link.



Image: Illustration of the Mirror Link function, showing a smartphone's display being mirrored onto the car stereo screen.

6.3 Bluetooth 5.2

The unit supports Bluetooth 5.2 for hands-free calling and audio streaming.

- Enable Bluetooth on your phone and search for available devices.
- Select "Roinvou Car Radio" (or similar name) from the list and pair.
- Once connected, you can make/receive calls and play music wirelessly.



Image: A driver using the Bluetooth hands-free calling feature, with the car stereo displaying a phone dialer interface.

7. AUDIO FEATURES

7.1 FM Radio

Access the FM radio function to listen to your favorite stations. The unit supports full-automatic, semi-automatic, and accurate manual tuning.

- Select the "FM" or "Radio" icon from the main menu.
- Use the on-screen controls to scan for stations or manually tune to a frequency.

7.2 EQ Adjustment

Customize your audio experience with the built-in equalizer. Adjust various frequency bands to match your preferences or select from preset sound modes (e.g., Jazz, Classic, Rock, Pop).



Image: The top panel shows the FM radio interface with frequency display and station presets. The bottom panel displays the EQ adjustment screen, allowing users to fine-tune audio frequencies and select sound presets.

8. ADVANCED FEATURES

8.1 Rear View Camera Support

The unit automatically displays the rear view camera feed when the vehicle is shifted into reverse, aiding in safe parking and maneuvering.

- Ensure the backup camera is correctly installed and connected to the CAMIN port.
- The display will switch automatically when reverse gear is engaged.

8.2 Steering Wheel Control (SWC)

Control essential functions of the car stereo directly from your vehicle's steering wheel buttons, enhancing convenience and safety.

- Access the SWC settings in the unit's menu.
- Follow the on-screen instructions to program your steering wheel buttons.



Image: The top panel shows the display of a rear view camera with parking guidelines. The bottom panel illustrates the Steering Wheel Control (SWC) setup menu, allowing users to program their vehicle's steering wheel buttons.

8.3 USB & Type-C Fast Charging

The unit includes dual USB inputs and a Type-C port, supporting media playback from USB devices and fast charging for compatible smartphones.

- Connect USB drives for audio/video playback.
- Use the Type-C port for fast charging your devices.

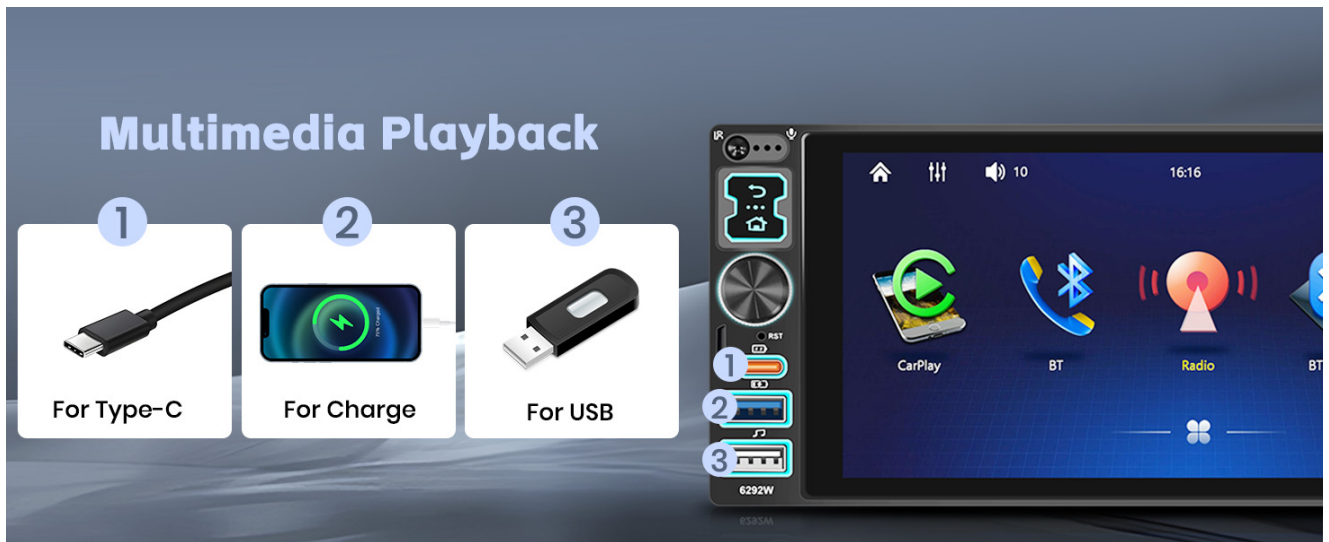

Image: Illustration of the multimedia playback capabilities, highlighting the Type-C port for connectivity, a dedicated port for charging, and a USB port for media input.

8.4 1080P Video Playback

The 1280x600 HD IPS screen supports 1080P video playback, offering a clear viewing experience for compatible video files.



Image: A visual demonstrating 1080P video playback on the car stereo's 1280x600 resolution screen, emphasizing the high-definition display quality.

9. SPECIFICATIONS

Feature	Detail
Display Size	6.8 inches
Screen Resolution	1280 x 600 IPS HD
Connectivity Technology	Bluetooth 5.2, USB, Type-C
Special Features	Wireless Apple CarPlay, Wireless Android Auto, FM Radio, EQ, Mirror Link, HD Video Playback, USB Charging, Dual USB Input, Type C Input, IPS Touch Screen, Twelve Color Button Light, Physical Knob

Feature	Detail
Compatible Devices	Smartphone
Audio Output Mode	Stereo
Surround Sound Channel Configuration	5.1
Video Encoding Support	AVI, MKV, MP4, RM, RMVB, 3GP
Output Power	180 Watts
Item Weight	2.09 pounds
Package Dimensions	8.46 x 5.63 x 4.41 inches
Model Number	2d214637-876e-49d6-bcc3-1b4563fe8da1

10. TROUBLESHOOTING

If you encounter issues, refer to the following common problems and solutions:

- **No Power:**

Check all power connections (yellow, red, black wires). Ensure the vehicle's ignition is on if connected to an accessory power source. Check vehicle fuses.

- **No Sound:**

Verify speaker connections. Check volume levels and mute settings. Ensure the correct audio source is selected.

- **Bluetooth Not Connecting:**

Ensure Bluetooth is enabled on both the stereo and your phone. Delete previous pairings and try pairing again. Restart both devices.

- **CarPlay/Android Auto Not Working:**

Ensure Wi-Fi and Bluetooth are active on your phone. Check for any software updates for your phone or the car stereo. Try restarting the phone and the stereo unit.

- **Rear Camera Not Displaying:**

Check the camera's video input connection (CAMIN) and ensure the reverse trigger wire is correctly connected and receiving power when in reverse gear.

- **Touchscreen Unresponsive:**

Try restarting the unit. If the issue persists, contact customer support.

11. MAINTENANCE

To ensure the longevity and optimal performance of your car radio, follow these maintenance guidelines:

- **Cleaning the Screen:** Use a soft, lint-free cloth to gently wipe the touchscreen. For stubborn smudges, slightly dampen the cloth with water or a screen-safe cleaner. Avoid harsh chemicals or abrasive materials.

- **General Cleaning:** Keep the unit free from dust and debris. Use a soft brush or compressed air to clean around buttons and ports.
- **Avoid Extreme Temperatures:** Do not expose the unit to extreme heat or cold for extended periods, as this can affect performance and lifespan.
- **Software Updates:** Periodically check the manufacturer's website or contact support for any available software updates to improve functionality and fix bugs.

12. WARRANTY AND SUPPORT

12.1 Warranty Information

Your Roinvou car radio is covered by a standard warranty. For specific details regarding warranty duration and coverage, please refer to the product documentation or contact Roinvou customer support. A 30-day refund/replacement policy is typically offered for eligible returns.

12.2 Customer Support

For technical assistance, troubleshooting, or warranty claims, please contact Roinvou customer support. You can typically find support contact information on the Roinvou store page or through the retailer where the product was purchased.

To contact Roinvou support:

1. Visit the Roinvou Store on Amazon.
2. Click on the 'Ask a question' link to send a message to the seller.



Image: Customer support guide showing how to contact Roinvou via their Amazon store page by clicking 'Ask a question'.