

## Tribesigns JW1273B

# Tribesigns 55-Inch Bar Table (Model JW1273B) Instruction Manual

Your guide to assembly, operation, and maintenance.

## INTRODUCTION

Thank you for choosing the Tribesigns 55-Inch Bar Table. This manual provides essential information for the safe assembly, proper use, and effective maintenance of your new bar table. Please read all instructions carefully before beginning assembly and retain this manual for future reference.

## SAFETY INFORMATION

- Always assemble the product on a soft, clean surface to prevent scratches.
- Ensure all parts are securely fastened before use. Periodically check and tighten all connections.
- Do not exceed the maximum weight recommendation of 350 pounds.
- Keep small parts away from children during assembly.
- Use only the provided hardware. Substituting parts may compromise stability.

## PACKAGE CONTENTS

Before assembly, verify that all components listed below are present and undamaged. If any parts are missing or damaged, please contact customer service.

**1 x Bar Height Table:** Main table unit.

**1 x Clear Instructions:** Detailed assembly guide.

**Assembly Tools:** All necessary tools are included.

*Note: The product may arrive in two separate boxes. Please ensure you have received all packages before starting assembly.*

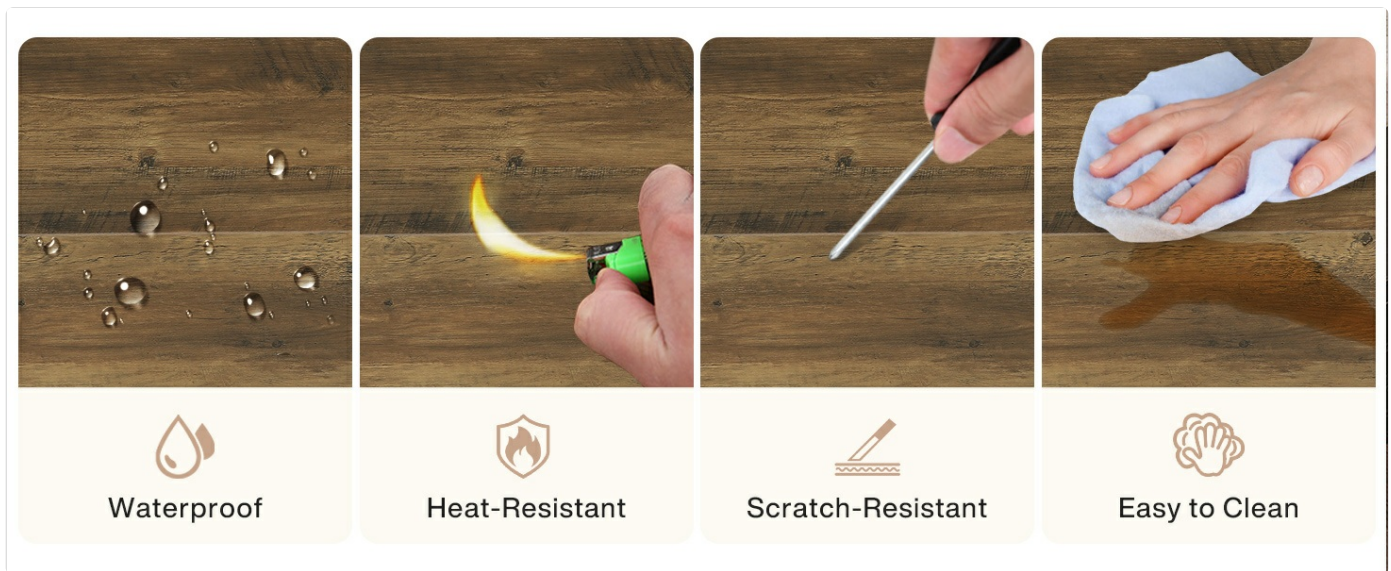

Image: Illustration showing two boxes and a delivery truck, indicating that packages may arrive separately.

## ASSEMBLY (SETUP)

---

Assembly is recommended for two people to ensure ease and safety. All required tools are included in the package. Please refer to the detailed "Clear Instructions" and "Assembly Guide" provided with your product for step-by-step visual instructions.

1. Unpack all components and lay them out on a clean, soft surface.
2. Identify each part using the labels provided in the assembly guide.
3. Follow the numbered steps in the assembly guide to connect the frame components.
4. Attach the tabletop securely to the assembled frame.
5. Install the storage shelves as indicated in the instructions.
6. Once assembled, gently move the table to its desired location and ensure it is stable.

# Large Worktop

31.5" D x 55.12" W top is roomy for lots of kitchen jobs



Image: Dimensional diagram of the bar table, illustrating overall size and internal shelf measurements.





## Thickened Tabletop

Superior stability and durability

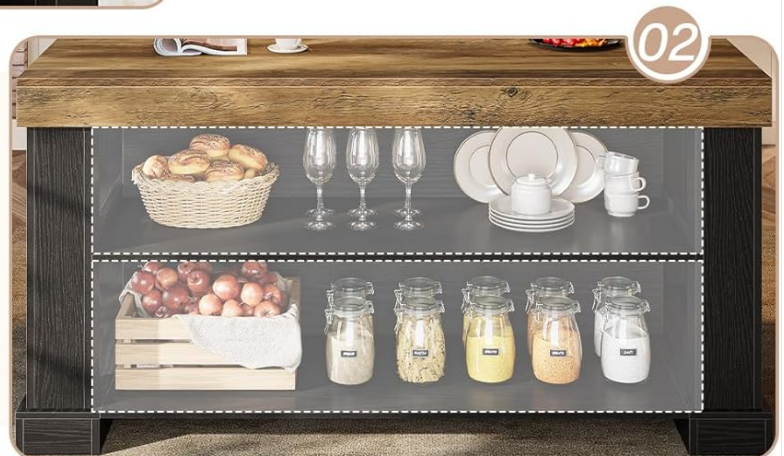

## Spacious Shelves

2-tier open shelves for easy access



## Bottom space

Cozy bottom room for leg rest

Image: Detailed view of key features: thickened tabletop, spacious shelves, and bottom legroom.

## Product Overview Video

Your browser does not support the video tag.

Video: A brief product show of the Tribesigns 55-Inch Bar Table with Storage Shelves, demonstrating its appearance and features.

## OPERATING INSTRUCTIONS

The Tribesigns Bar Table is designed for versatile use in various indoor settings. Its sturdy construction and spacious design make it suitable for multiple functions.

- **Dining Table:** Use as a counter-height dining table for meals.
- **Home Bar Unit:** Ideal for serving drinks and entertaining guests. The open shelves provide convenient storage for bottles, glasses, and bar accessories.
- **Kitchen Island:** Functions as an additional workspace or serving area in the kitchen.

- **Work Desk:** Can be utilized as a spacious work or study desk.



Image: Examples of multi-functional use: as a work desk, island bar, and bar table.

## MAINTENANCE

---

Proper care will extend the life and appearance of your Tribesigns Bar Table.

- **Cleaning:** The table surface is waterproof and stain-resistant. For general cleaning, wipe with a soft, damp cloth. For spills, wipe immediately with a soft, dry cloth. Avoid harsh chemicals or abrasive cleaners.
- **Protection:** While the surface is scratch-resistant, it is advisable to use coasters for drinks and placemats for hot dishes to prevent potential damage.
- **Stability Check:** Periodically check all screws and bolts to ensure they remain tight. Retighten as necessary.

# Quality Particleboard

3.94" thick particleboard is sturdy and durable



**Waterproof**



**Stain Resistant**



**Scratch Resistant**

Image: Visual representation of the table's durable properties: waterproof, heat-resistant, scratch-resistant, and easy to clean.

## TROUBLESHOOTING

If you encounter any issues with your Tribesigns Bar Table, please refer to the following common solutions:

- **Table Wobbles:**

- Ensure all screws and bolts are fully tightened.
- Check if the table is on an even surface. Adjust floor levelers if present.

- **Missing Parts:**

- Double-check all packaging materials.
- Contact customer service with the specific part number from the assembly guide.

- **Difficulty Assembling:**

- Review the assembly guide carefully, paying attention to diagrams.
- Ensure parts are oriented correctly.

- If possible, have a second person assist with assembly.

## SPECIFICATIONS

Brand	Tribesigns
Model Number	JW1273B
Product Dimensions (D x W x H)	31.5" x 55.12" x 35.43"
Item Weight	119.1 Pounds
Maximum Weight Recommendation	350 Pounds
Frame Material	Engineered Wood
Tabletop Thickness	3.94 Inches
Number of Racks	3
Color	Black and Brown
Indoor/Outdoor Usage	Indoor
Stain Resistant	Yes
Assembly Tools Included	Yes
Recommended People for Assembly	2

## WARRANTY AND SUPPORT

Tribesigns provides an 18-month manufacturer's warranty for this product. If you encounter any issues or are not satisfied with your purchase, please do not hesitate to contact our dedicated customer service team. We are committed to providing prompt assistance and support.

For warranty claims or support, please refer to the contact information provided at the point of purchase or on the official Tribesigns website.