

Manuals+

[Q & A](#) | [Deep Search](#) | [Upload](#)

manuals.plus /

- › [VCELINK](#) /
- › [VCELINK RJ45 Tool-Free Connector Instruction Manual](#)

VCELINK KJ22-C6-2P-AU

# VCELINK RJ45 Tool-Free Connector Instruction Manual

Model: KJ22-C6-2P-AU

<a href="#">Overview</a>	<a href="#">Package Contents</a>	<a href="#">Specifications</a>	<a href="#">Installation</a>	<a href="#">Operation</a>	<a href="#">Maintenance</a>
		<a href="#">Troubleshooting</a>	<a href="#">Warranty &amp; Support</a>		

## 1. PRODUCT OVERVIEW

The VCELINK RJ45 Tool-Free Connector is designed for effortless and reliable termination of CAT6/CAT5E Ethernet cables without the need for specialized crimping tools. Featuring gold-plated contacts and a robust design, it ensures high-speed data transmission and a stable connection for various networking applications.



Figure 1: VCELINK RJ45 Tool-Free Connectors

## 2. WHAT'S IN THE BOX

Your package should contain the following items:

- RJ45 Connector
- Load Bar
- Operating Instructions (this manual)

## 3. PRODUCT SPECIFICATIONS

Feature	Description
Product Dimensions	2.09 x 0.57 x 0.51 inches; 0.49 ounces
Model Number	KJ22-C6-2P-AU

Brand	VCELINK
Connector Type	Ethernet (RJ45)
Cable Type Compatibility	CAT6/CAT5E Ethernet cable 23-26AWG (Wire OD: 0.4-1.2mm)
Cable Jacket OD Support	6.0-7.6mm
Transmission Speed	Up to 1Gbps
Special Features	Tool-Free Installation, Gold-Plated Contacts, Nut-Type Strain Relief Boot, Reusable, Compact Size
Compatible Devices	Laptop, Modem, Personal Computer, Router, Server, Smart TV, Switch, Camera, TV Box

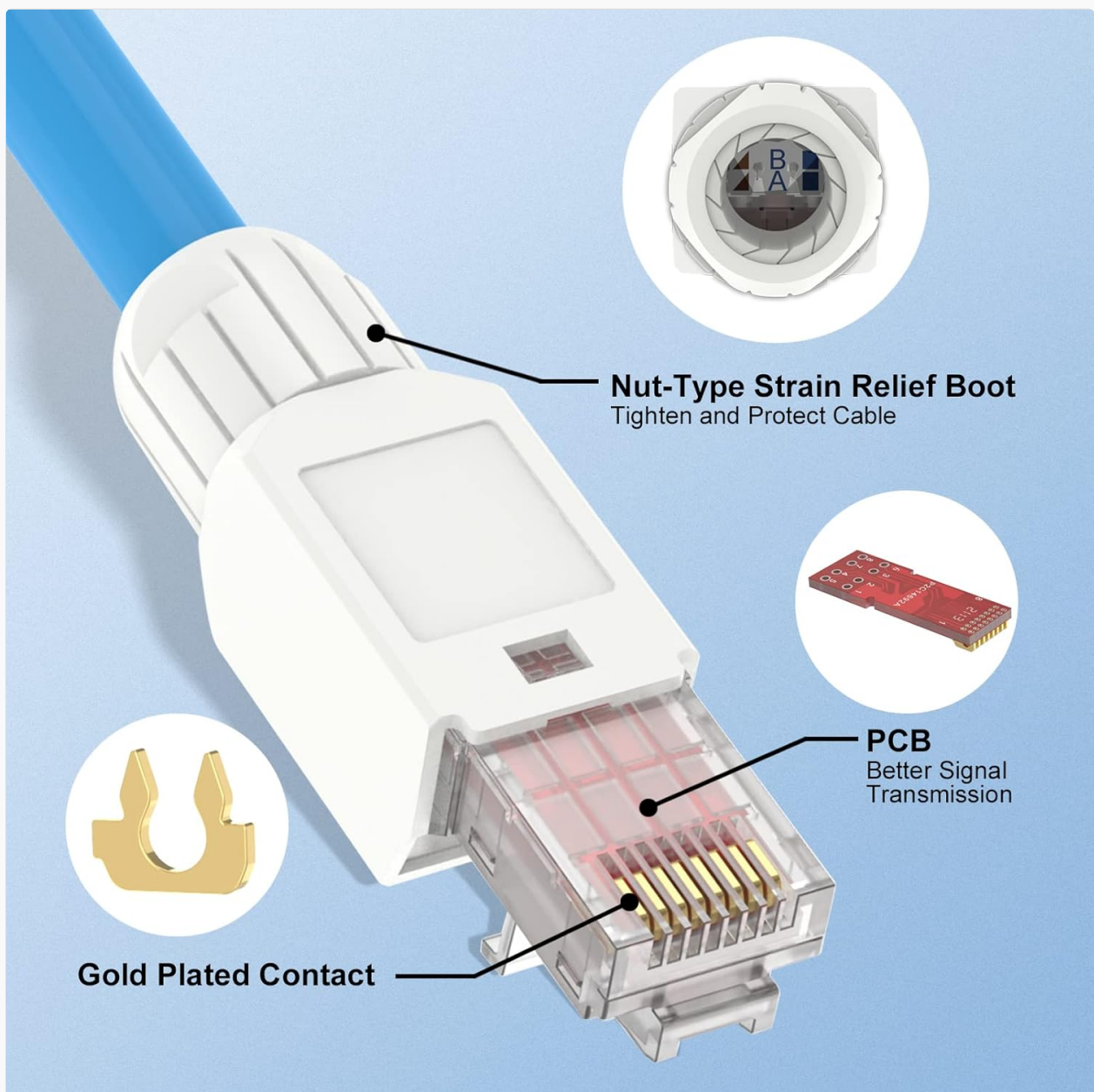

Figure 2: Connector Components



Figure 3: Compact Design for Side-by-Side Use

## 4. INSTALLATION GUIDE

This tool-free RJ45 connector simplifies the termination process. Follow these steps for a successful installation:

### 4.1 Required Tools (Not Included)

- Wire Stripper
- Wire Cutter
- Ethernet Cable (CAT6/CAT5E)
- Network Cable Tester (recommended for verification)

### 4.2 Wiring Standards (T568A & T568B)

Ensure you follow the correct wiring standard (T568A or T568B) for your network. The connector's load bar is color-coded for easy alignment.

**No Crimping Tools Required**

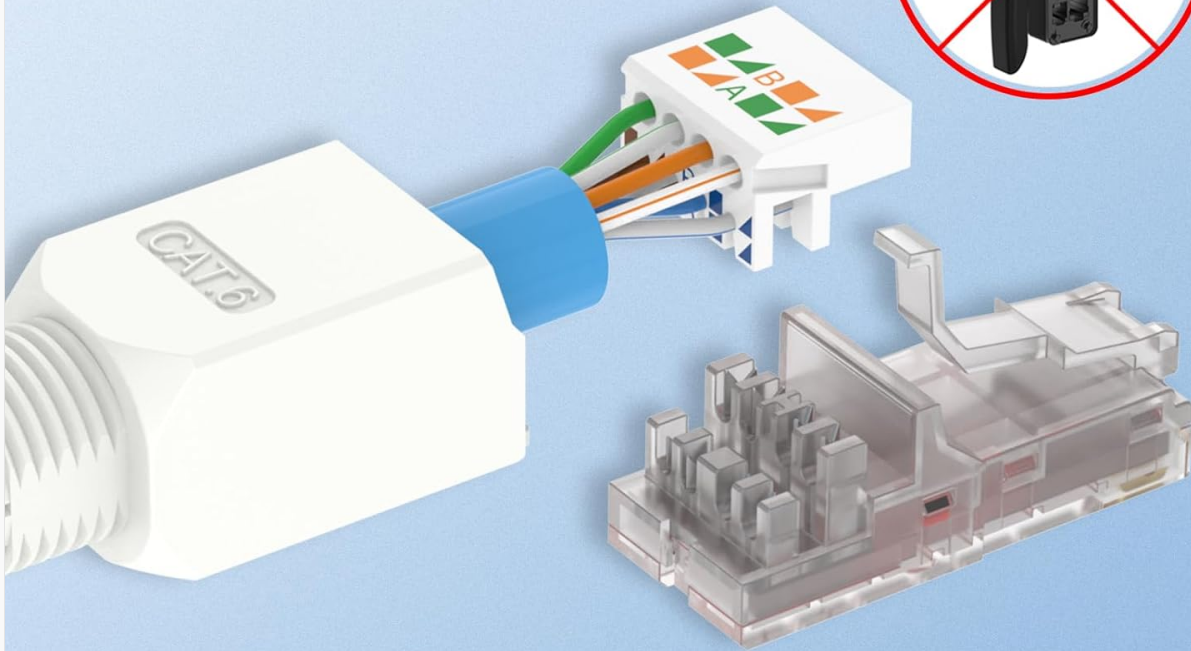

Figure 4: T568A and T568B Wiring Standards

### 4.3 Step-by-Step Installation

1. **Insert the Boot:** Slide the nut-type strain relief boot onto the Ethernet cable.
2. **Strip the Cable Jacket:** Carefully strip approximately 2cm (0.79 inches) of the outer cable jacket to expose the twisted pairs.
3. **Arrange and Straighten Wires:** Untwist and straighten the 8 individual wires.
4. **Thread Wires into Load Bar:** Following either the T568A or T568B color code (T568B is commonly used), thread each wire into the corresponding slot on the load bar. Ensure wires are fully seated.
5. **Cut Excess Wires:** Use a wire cutter to trim the excess wires flush with the load bar. The top and bottom rows of wires may need to be cut to varying lengths for proper seating.
6. **Align and Press:** Align the load bar with the grooves inside the connector housing and firmly press them together until they click into place.
7. **Close the Cover:** Close the clear cover of the connector.
8. **Tighten the Nut:** Slide the strain relief boot forward and tighten the nut onto the connector body to secure the cable.



9. **Complete:** The connector is now terminated and ready for use.

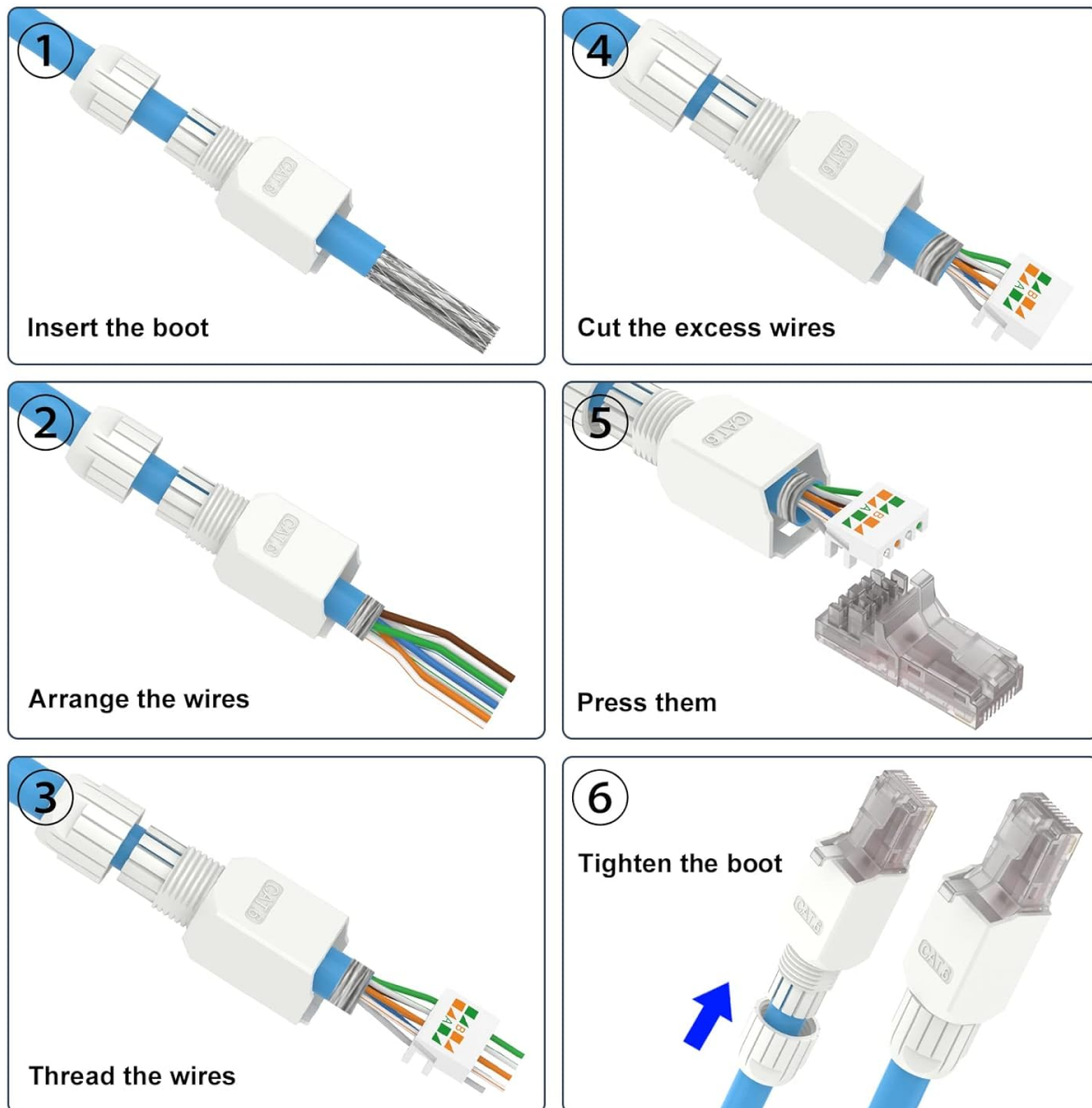

Figure 5: Step-by-Step Installation Process

Your browser does not support the video tag.

Video 1: How to install an Ethernet cable by yourself using the VCELINK tool-free connector.

## 5. OPERATING INSTRUCTIONS

Once terminated, the RJ45 connector functions as a standard Ethernet plug. Simply insert it into any compatible RJ45 socket on your network devices.

## Can be Used in Any Equipment with RJ45 Socket



Figure 6: Wide Compatibility with RJ45 Sockets

### 5.1 High-Speed Transmission

The gold-plated contacts ensure speedy and reliable signal transmission, supporting speeds up to 1Gbps for your CAT6/CAT5E network.

# UP to 1 Gbps



Figure 7: High-Speed Data Transmission

## 6. MAINTENANCE

- Keep connectors clean and free from dust and debris.
- Avoid excessive bending or pulling on the cable near the connector to prevent damage to the internal wires.
- Store unused connectors in a dry, cool place.

## 7. TROUBLESHOOTING

### 7.1 No Network Connection / Intermittent Connection

- **Check Wiring:** Verify that the wires are correctly threaded into the load bar according to the T568A or T568B standard. Ensure no wires are crossed or misplaced.
- **Inspect Wire Lengths:** Confirm that the trimmed wire ends are flush with the load bar and make proper contact with the connector's pins. Uneven cuts can lead to poor connection.



- **Test with Cable Tester:** Use a network cable tester to check for continuity and proper wiring. If the test fails, disassemble and re-install the connector.
- **Ensure Secure Connection:** Make sure the connector is fully seated in the device's RJ45 port and the strain relief boot is tightened.

Your browser does not support the video tag.

Video 2: The installation video also demonstrates how to test the cable with a network cable tester for signal integrity.

## 7.2 Reusability

One of the key features of this tool-free connector is its reusability. In case of an error or if you need to re-terminate, you can carefully disassemble the connector and re-install it.



Figure 8: Reusability Feature





## 8. WARRANTY AND SUPPORT

VCELINK products are designed for reliability and performance. For any issues or suggestions regarding your product, please do not hesitate to contact VCELINK customer support. Refer to the product packaging or the official VCELINK website for specific warranty details and contact information.

Customer experience is always our top priority.

© 2025 VCELINK. All rights reserved.  
For more information, visit [VCELINK Store](#)

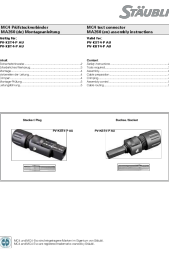
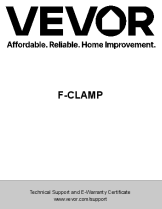
Related Documents - KJ22-C6-2P-AU

	<p><a href="#">Weichat EW-M19MF-XP IP68 Waterproof Connector   Male &amp; Female Self-Locking</a></p> <p>Discover the Weichat EW-M19MF-XP, a robust IP68 waterproof self-locking connector. Featuring PA66 housing, silicone seals, and copper alloy terminals, it's ideal for demanding applications. Available in 2, 3, 4, and 5 pin configurations with 450V rating and 3-year warranty.</p>
	<p><a href="#">Elektron C6 Sysex Tool User's Manual</a></p> <p>User manual for the Elektron C6 Sysex Tool, a software utility for transferring MIDI System Exclusive (Sysex) data and audio samples between Elektron music devices and a computer. Covers system requirements, setup, software functions, and file format.</p>
	<p><a href="#">Stäubli MA260 MC4 Test Connector Assembly Instructions</a></p> <p>Detailed assembly instructions for Stäubli MA260 MC4 test connectors, covering safety, tools, cable preparation, crimping, assembly control, and cable routing for PV-KST4-P AU and PV-KBT4-P AU.</p>
	<p><a href="#">VEVOR F-CLAMP Instruction Manual and Technical Specifications</a></p> <p>Comprehensive guide for VEVOR F-CLAMPS, including model details, assembly instructions, safety precautions, troubleshooting, maintenance, and warranty information.</p>
	<p><a href="#">SKROSS World to Europe USB Travel Adapter - Plug and USB Charger</a></p> <p>Explore the SKROSS World to Europe USB travel adapter, designed for international travelers. Features Schuko output, multiple input types (UK, US, AU, CH, IT, BR), and a built-in 2.4A USB port for charging devices worldwide. Includes safety precautions and warranty information.</p>

<div><p><b>Sonoff S20 Smart Plug</b></p><p><b>Smart Plug - Control Your Smart Home with Iplace</b></p><p><b>Product Description</b></p><p>The Sonoff S20 Smart Plug is a compact, white, rectangular device designed to be plugged into a standard wall outlet. It features a small, circular LED indicator light on the front face, which is currently illuminated. The device is labeled with the 'Iplace' logo and the model name 'S20'. Below the product image, there is a detailed description of the plug's features and specifications, including its compatibility with various smart home ecosystems and its ability to be controlled remotely via a smartphone app. The text is organized into sections such as 'Features', 'Specifications', and 'Usage Instructions', providing a comprehensive overview of the product.</p></div>	<p><a href="#">Sonoff S20 Smart Plug: Features, Specifications, and Usage Guide</a></p> <p>Explore the Sonoff S20 Smart Plug by Iplace, a WiFi-enabled device for seamless home automation. Discover its features including remote control, voice assistant compatibility with Amazon Alexa and Google Assistant, IFTTT integration, and detailed technical specifications.</p>
--	---