

Douk Audio NS-01G-MAX

Nobsound NS-01G-MAX 2-Channel 200W Bluetooth Amplifier User Manual

Model: NS-01G-MAX | Brand: Douk Audio

1. INTRODUCTION

The Nobsound NS-01G-MAX is a compact 2-channel Bluetooth 5.0 power amplifier designed for versatile audio applications. It delivers up to 100W per channel, suitable for driving passive speakers in home, desktop, car, or marine audio systems. This manual provides essential information for setting up, operating, and maintaining your amplifier.

2. PACKAGE CONTENTS

Verify that all items are present in the package:

- 1x Nobsound NS-01G-MAX Amplifier
- 1x DC 19V Power Adapter
- 1x 3.5mm AUX Cable
- 1x 3.5mm AUX to RCA Cable
- 1x User Manual

PACKING LIST

What's in the Box ?

Net Weight
125g/0.28lb

Package Weight
500g/1.10lb

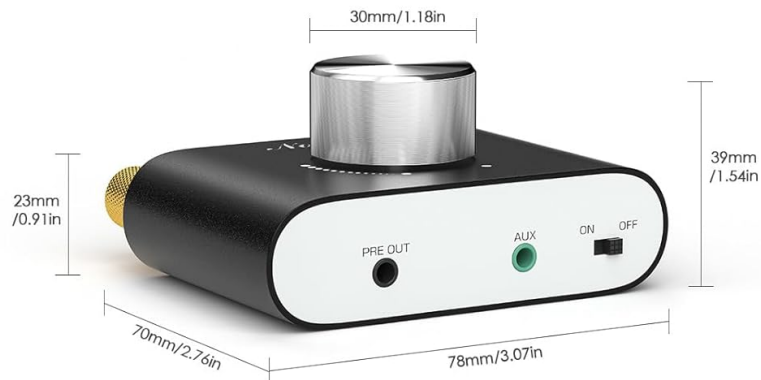

1*NS-01G MAX



1*DC 19V Power Adapter



1*AUX Cable



1*AUX to RCA Cable



1*User Manual

Figure 2.1: The Nobsound NS-01G-MAX amplifier and its included accessories, neatly packed in the box.

3. PRODUCT OVERVIEW

The NS-01G-MAX features a compact design with essential controls and connectivity options.

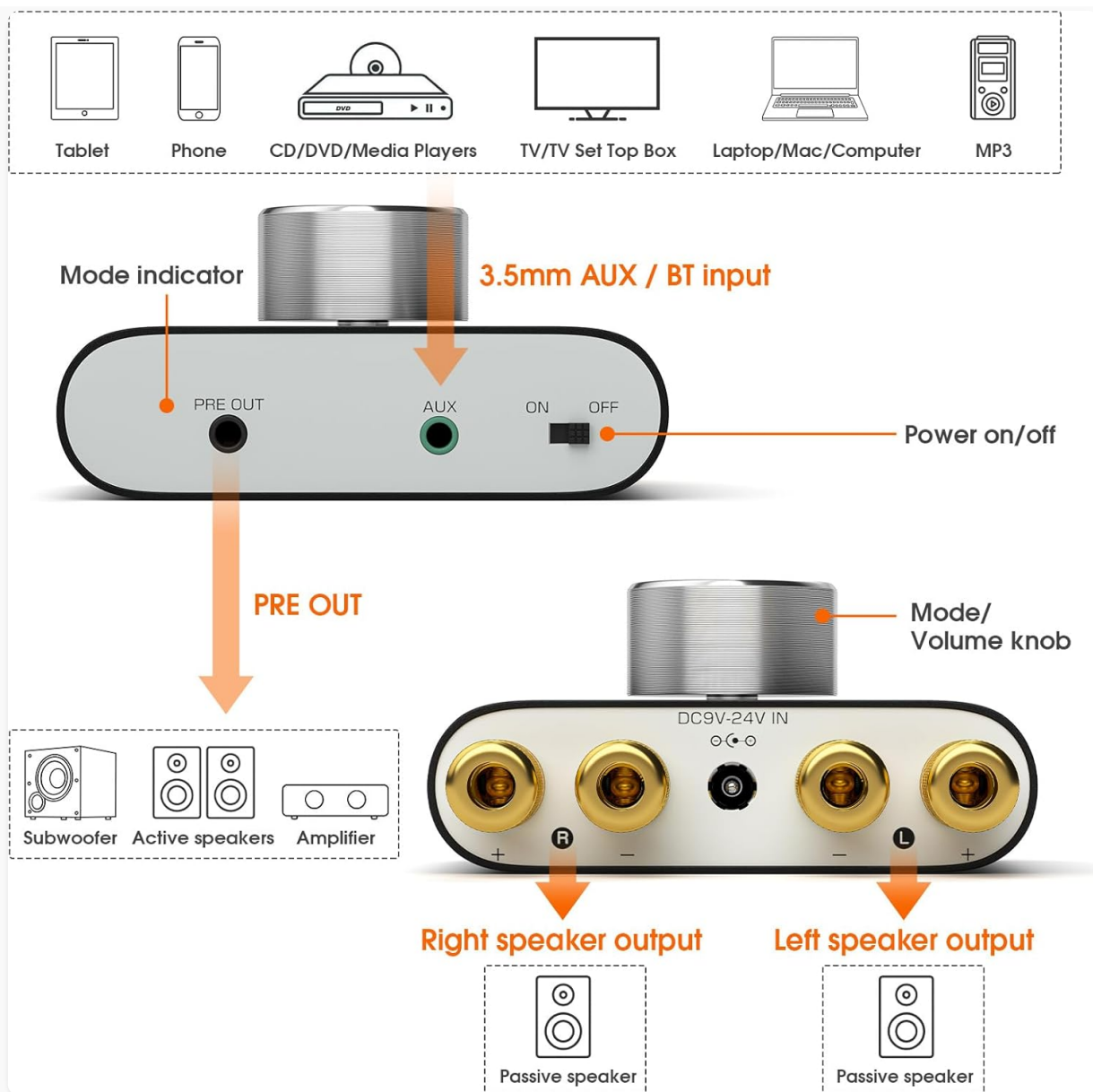

Figure 3.1: Front and rear panel overview of the Nobsound NS-01G-MAX amplifier, detailing input/output ports and controls.

Front Panel:

- **Mode Indicator:** LED light indicating current input mode.
- **PRE OUT:** 3.5mm output for active subwoofer or another amplifier.
- **AUX:** 3.5mm audio input.
- **ON/OFF Switch:** Power toggle for the unit.
- **Mode/Volume Knob:** Rotates to adjust volume and presses to switch input modes.

Rear Panel:

- **DC 9V-24V IN:** Power input port.
- **Right Speaker Output (R+, R-):** Connects to the right passive speaker.
- **Left Speaker Output (L+, L-):** Connects to the left passive speaker.

4. SETUP AND CONNECTIONS

4.1 Connecting Speakers

Connect your passive speakers (3-8Ω, 20-120W) to the speaker output terminals on the rear panel. Ensure correct

polarity (red to positive, black to negative) for each channel.

4.2 Connecting Power

Connect the included DC 19V power adapter to the 'DC 9V-24V IN' port on the rear panel, then plug the adapter into a power outlet. The amplifier supports 9-24V DC input for flexible power options.

4.3 Connecting Audio Sources

The amplifier supports both wired and wireless audio inputs:

- **Bluetooth 5.0:** For wireless streaming from devices like smartphones, tablets, or computers.
- **3.5mm AUX Input:** For wired connection to devices such as TVs, CD players, or PCs using the provided 3.5mm AUX cable or 3.5mm AUX to RCA cable.



Figure 4.1: The amplifier connected to a laptop via AUX and ready for Bluetooth pairing with a smartphone.

4.4 Subwoofer/External Amplifier Connection

Use the 3.5mm PRE OUT port to connect an active subwoofer for enhanced bass or to feed the audio signal to another amplifier or active speakers. This allows for easy expansion to a 2.1-channel system or multi-amp setups.



Figure 4.2: Connecting the amplifier's PRE OUT to an active subwoofer for a 2.1-channel audio system.

5. OPERATING INSTRUCTIONS

5.1 Power On/Off

Toggle the ON/OFF switch on the front panel to power the amplifier on or off. The mode indicator LED will illuminate when the unit is powered on.

5.2 Volume Control and Input Selection

Rotate the Mode/Volume knob to adjust the audio output level. Press the knob to cycle through available input modes (Bluetooth, AUX).

Fully functional yet Super Mini

With smooth volume control and real-time dual-color LED indicator



Figure 5.1: Adjusting the volume and selecting input mode using the front panel knob.

5.3 Bluetooth Pairing

When the amplifier is powered on and in Bluetooth mode (indicated by the LED), enable Bluetooth on your source device. Search for 'Nobsound NS-01G-MAX' in the list of available devices and select it to pair. A confirmation tone may sound upon successful pairing.

6. MAINTENANCE

To ensure optimal performance and longevity of your Nobsound NS-01G-MAX amplifier, follow these maintenance guidelines:

- **Cleaning:** Use a soft, dry cloth to clean the exterior of the amplifier. Avoid using liquid cleaners or solvents.
- **Ventilation:** Ensure the amplifier is placed in a well-ventilated area to prevent overheating. Do not block the ventilation holes.
- **Power Disconnection:** Disconnect the power adapter from the wall outlet when the amplifier is not in use for extended periods.
- **Environmental Conditions:** Avoid exposing the amplifier to extreme temperatures, humidity, or direct sunlight.

7. TROUBLESHOOTING

If you encounter issues with your amplifier, refer to the following common problems and solutions:

- **No Sound:**
 - Ensure the amplifier is powered on and the volume is not at minimum.
 - Verify that the correct input mode (Bluetooth/AUX) is selected.
 - Check all cable connections (power, speakers, audio source) for secure fit and correct polarity.
 - Confirm that your audio source device is playing and its volume is adequate.
- **Distorted Sound:**
 - Reduce the volume on both the amplifier and the audio source.
 - Ensure speaker impedance (3-8Ω) and wattage (20-120W) are compatible with the amplifier.
 - Check for loose speaker wire connections.
- **Bluetooth Pairing Issues:**
 - Ensure the amplifier is in Bluetooth mode.
 - Disable and re-enable Bluetooth on your source device.
 - Move the source device closer to the amplifier (within 10-15m / 32-49ft range).
 - If previously paired, try forgetting the device on your source and re-pairing.
- **White Noise/Hiss in USB Mode:**
 - This may be a characteristic of the USB audio input. If noticeable, consider using Bluetooth or AUX input for quieter operation.
- **Annoying Voice Announcements:**
 - The amplifier's voice announcements for mode changes are integrated and cannot be disabled.

8. SPECIFICATIONS

Feature	Specification
Model Number	NS-01G-MAX
Output Power	100W x 2 (into 4Ω)
Speaker Impedance	3-8Ω
Compatible Speakers	20-120W Passive Speakers
Bluetooth Version	5.0
Bluetooth Range	10-15m / 32-49ft
Input Options	Bluetooth, 3.5mm AUX
Output Options	Speaker Outputs, 3.5mm PRE OUT
Power Input	DC 9V-24V
THD	≤0.01%

SNR	≥98dB
Dimensions	2.76 x 3.07 x 1.54 inches
Item Weight	4.5 ounces



9. WARRANTY AND SUPPORT

Douk Audio products are warranted free from defects in material and workmanship for a specified period from the date of purchase. For warranty claims or technical support, please contact Douk Audio customer service. Refer to the product packaging or official website for specific warranty duration and contact information.

Built-in protection circuitry (overheat, overload, short-circuit) ensures stable, safe operation.

© 2025 Douk Audio. All rights reserved.

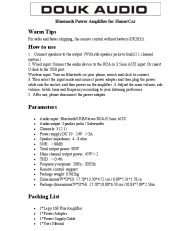
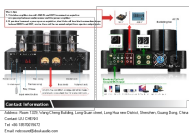
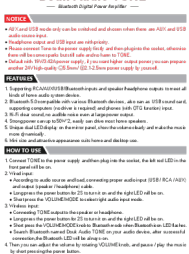
Related Documents - NS-01G-MAX

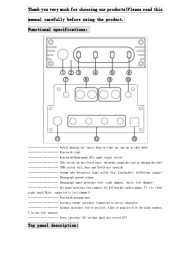
	<p>DOUK AUDIO Lepy 168 Plus Bluetooth Amplifier for Home & Car Hi-Fi Stereo USB/AUX/RCA</p> <p>Discover the DOUK AUDIO Lepy 168 Plus, a versatile 2.1 channel Bluetooth power amplifier designed for home and car use. This mini Hi-Fi stereo amplifier offers 90W total output, multiple inputs (USB, SD, AUX, RCA), and remote control functionality. Includes detailed specifications and usage instructions.</p>
	<p>DOUK AUDIO AV-889 HiFi Bluetooth 5.0 Tube Power Amplifier Specifications</p> <p>Explore the detailed specifications and usage tips for the DOUK AUDIO AV-889 HiFi Bluetooth 5.0 Tube Power Amplifier, a high-fidelity audio device with versatile connectivity options.</p>
	<p>Douk Audio TONE Bluetooth Amplifier User Manual and Specifications</p> <p>Comprehensive guide to the Douk Audio TONE Bluetooth amplifier, covering features, usage instructions, technical specifications, and connectivity options for home audio systems.</p>
	<p>Nobsound G3 Mini Bluetooth Digital Amplifier with Tone Control - Douk Audio User Manual</p> <p>User manual for the Nobsound G3 Mini Bluetooth Digital Amplifier by Douk Audio. Features include tone control, Bluetooth connectivity, and detailed specifications, functions, and troubleshooting.</p>
	<p>Douk Audio Vacuum Tube Amplifier User Manual</p> <p>User manual for the Douk Audio HiFi Stereo Bluetooth 5.0 Vacuum Tube Amplifier MM Phono Amp for Turntables 320W, covering specifications, operation, and troubleshooting.</p>

Douk Audio M1 Pro 320W Bluetooth 5.0 Stereo Amplifier 2.0 Channel Stereo Subwoofer Amp Music Player - DZ071

Use video player to watch MP3 or download MP3 file to your device. The video player will automatically download the MP3 file to your device.

Features:

- 320W Power Output: The Douk Audio M1 Pro is a powerful stereo amplifier with 320W power output, providing clear and loud sound.
- Bluetooth 5.0: Connect your smartphone or tablet to the Douk Audio M1 Pro via Bluetooth 5.0 for wireless music playback.
- USB Music Player: The Douk Audio M1 Pro features a USB port for playing music from your USB drive.
- RCA Input: The Douk Audio M1 Pro has RCA inputs for connecting to other audio sources.
- Subwoofer Output: The Douk Audio M1 Pro has a subwoofer output for connecting to a subwoofer.
- Remote Control: The Douk Audio M1 Pro comes with a remote control for easy operation.

Specifications:

- Model: M1 Pro
- Power Output: 320W
- Bluetooth Version: 5.0
- USB Port: 1x USB Type-A
- RCA Input: 1x RCA Input
- Subwoofer Output: 1x Subwoofer Output
- Remote Control: 1x Remote Control
- Dimensions: 100mm x 100mm x 100mm
- Weight: 100g

[Douk Audio M1 Pro 320W Bluetooth 5.0 Power Amplifier Stereo Subwoofer Amp USB Music Player - DZ071](#)

Discover the Douk Audio M1 Pro, a 320W Bluetooth 5.0 stereo subwoofer amplifier and USB music player (DZ071). Featuring TDA7498E chip, RCA and U-disk input, and enhanced bass output for home audio and theater systems. Compatible with phones, computers, TVs, and MP3 players.