

## CAMECHO 6.86-inch Wireless Carplay

# CAMECHO Car Radio User Manual

MODEL: 6.86-INCH WIRELESS CARPLAY

Brand: CAMECHO

## 1. Introduction

This manual provides detailed instructions for the installation, operation, and maintenance of your CAMECHO 1 Din Wireless Carplay Android Auto Bluetooth 5.2 Car Radio. Please read this manual thoroughly before using the product to ensure proper function and to prevent damage.

## 2. Safety Information

- Ensure the vehicle's power is disconnected before installation to prevent electrical shock or damage.
- Consult a qualified technician for installation if you are unsure about any steps.
- Do not operate the device in a way that distracts you from driving. Always prioritize road safety.
- Avoid exposing the unit to extreme temperatures, direct sunlight for prolonged periods, or excessive moisture.
- Use only specified voltage (DC 12V) for power supply.

## 3. Package Contents

Verify that all items listed below are included in your package:

- 1x Head Unit (Car Radio)
- 1x Power Cable
- 1x Microphone
- 1x Remote Control
- 1x User Manual
- 1x Horn Cable

# Package Included & Product Size

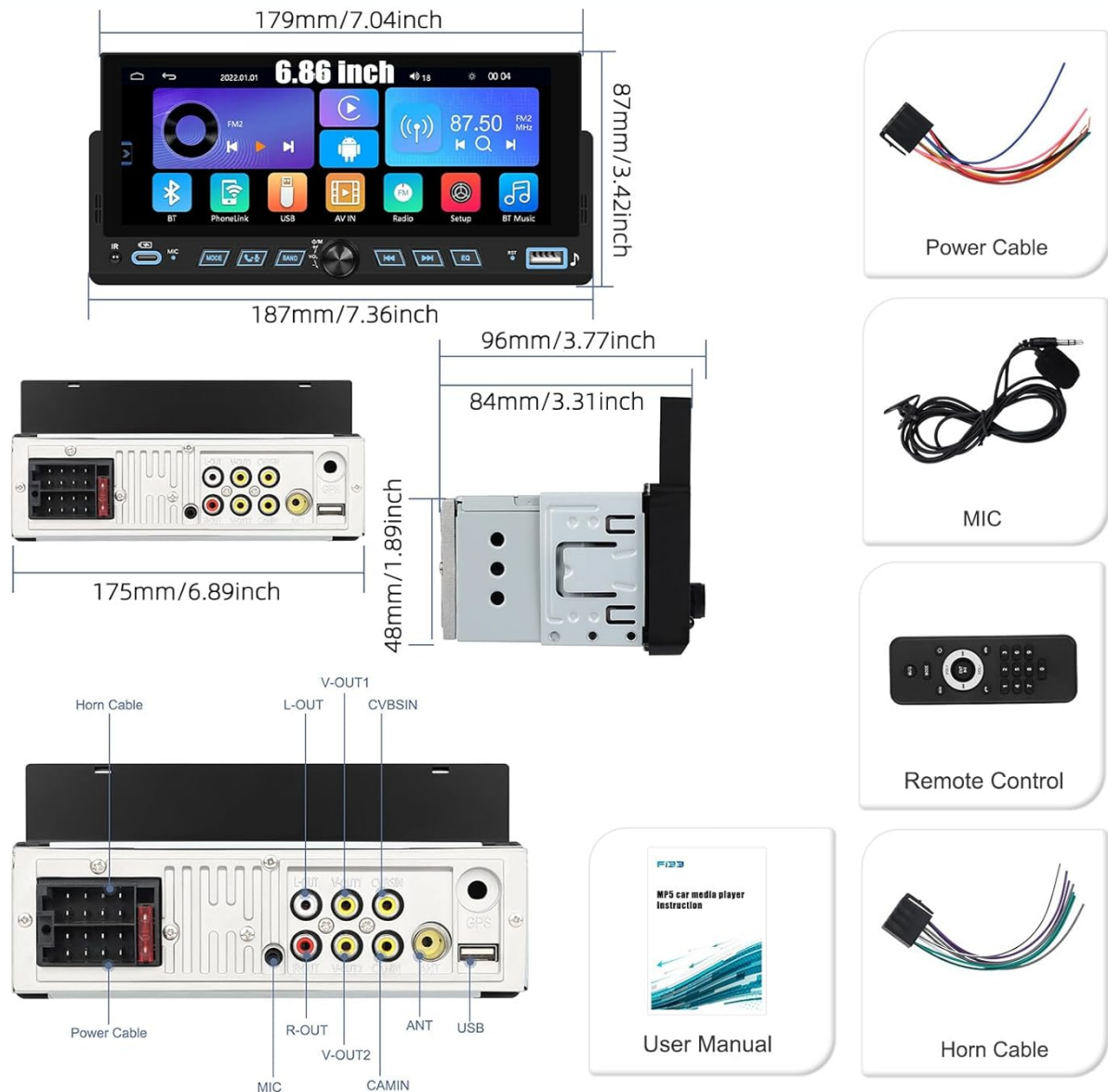

Image: Overview of the CAMECHO Car Radio package contents and product dimensions, including the head unit, power cable, microphone, remote control, user manual, and horn cable. Dimensions for the unit are also shown.

## 4. Setup and Installation

This unit is designed for 1-DIN installation. Professional installation is recommended.

### 4.1 Wiring Diagram

Refer to the provided wiring diagram for correct connections. Ensure all connections are secure to prevent malfunctions.

# Package Included & Product Size

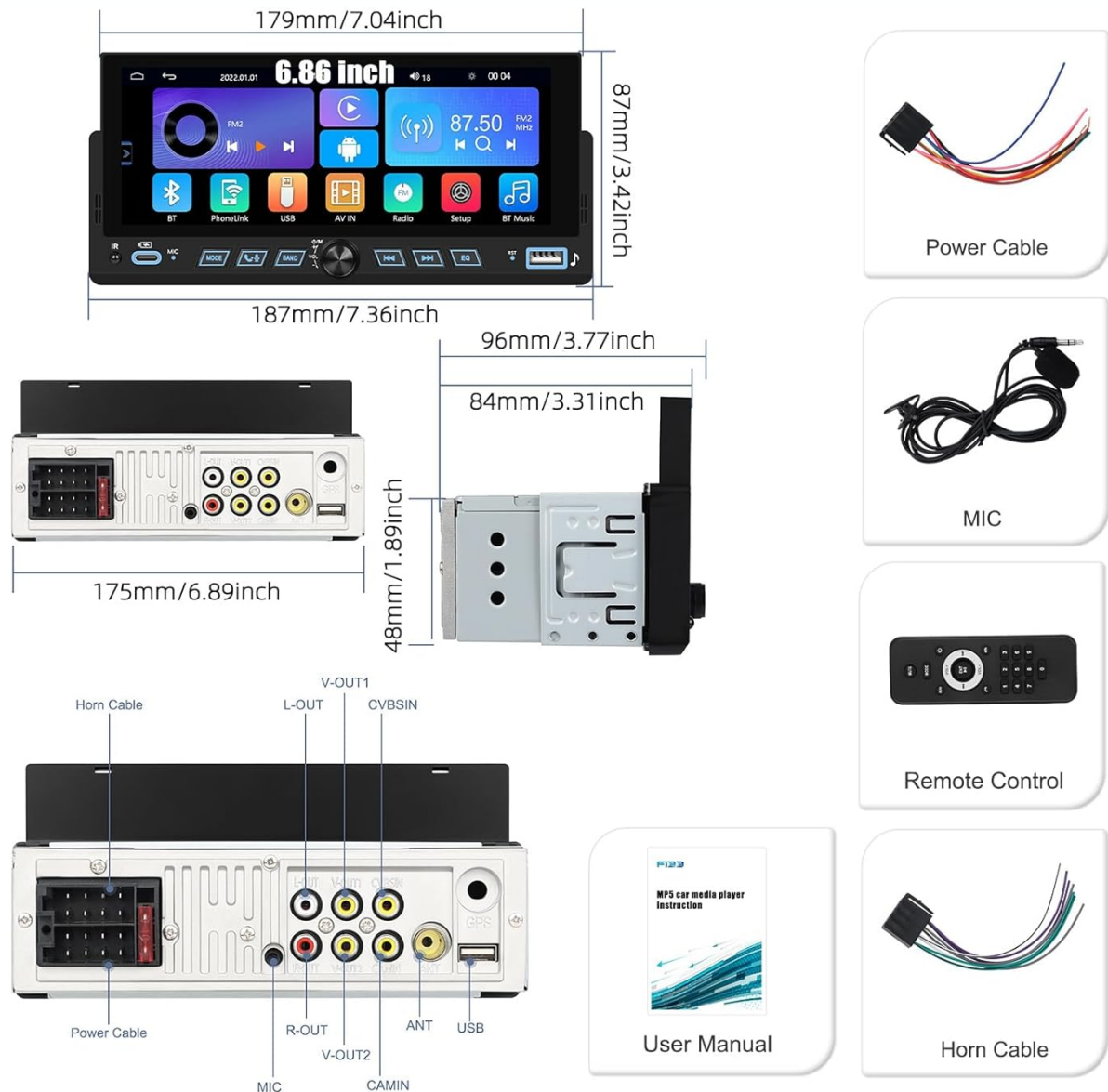

Image: Detailed wiring diagram for the CAMECHO Car Radio, showing connections for power, horn, microphone, video output (V-OUT1, V-OUT2), video input (CVBSIN), and camera input (CAMIN).

## 4.2 Physical Installation

Mount the head unit into your vehicle's 1-DIN slot. Secure it using the mounting hardware. Connect all necessary cables as per the wiring diagram. Test all functions before fully reassembling your dashboard.

## 5. Operating Instructions

### 5.1 Wireless CarPlay and Android Auto

Connect your smartphone wirelessly via Bluetooth to access CarPlay or Android Auto functionalities. This allows for hands-free calling, map navigation, music playback, and video streaming directly on the unit's display.

# Wireless Carplay Android Auto

You can use the BT connection to carplay or Android auto, support hands-free calling, map navigation, music, videos and more.



## Mirror link for IOS & Android



Image: Demonstrates the wireless CarPlay and Android Auto interfaces on the CAMECHO Car Radio, showing various applications like navigation, music, and communication tools. It also illustrates the Bluetooth connection process.

### 5.2 Bluetooth 5.2

The unit features Bluetooth 5.2 for stable and fast wireless connections. Use Bluetooth for hands-free calls and audio streaming from your mobile device.

## FM Radio



## Bluetooth 5.2



## EQ Lossless Sound



Image: Displays the Bluetooth 5.2 interface on the CAMECHO Car Radio, showing connection status and options for music playback. Also includes visuals for FM Radio and EQ settings.

### 5.3 Mirror Link for iOS & Android

The Mirror Link function allows you to display your smartphone's screen directly onto the car radio's display. Connect your device via USB for this feature.

# Wireless Carplay Android Auto

You can use the BT connection to carplay or Android auto, support hands-free calling, map navigation, music, videos and more.



## Mirror link for IOS & Android



Image: Illustrates the Mirror Link feature for both iOS and Android devices, showing a smartphone screen mirrored onto the car radio display via USB connection.

### 5.4 FM Radio

Access FM radio stations within the 87.5-108MHz frequency range. The unit supports storing up to 18 preset stations for quick access.

# FM Radio & EQ Settings



Image: Shows the FM Radio interface of the CAMECHO Car Radio, displaying frequency tuning and preset options. Also includes a visual representation of sound waves.

## 5.5 EQ Lossless Sound Settings

Customize your audio experience using the built-in equalizer. Choose from preset sound modes like Jazz, Classic, Rock, Pop, Flat, or create a custom user profile.

# FM Radio & EQ Settings



Image: Displays the EQ (Equalizer) settings interface on the CAMECHO Car Radio, showing adjustable frequency bands and various sound presets like Jazz, Classic, Rock, Pop, Flat, and User.

## 5.6 Steering Wheel Control

The unit supports steering wheel control integration, allowing you to manage basic functions without taking your hands off the wheel. Refer to the vehicle's manual for compatibility and setup.

# Steering wheel control



# Back-up camera input



Image: Shows the interface for setting up steering wheel controls on the CAMECHO Car Radio, with options to assign functions like volume, track skip, and mode selection.

## 5.7 Back-up Camera Input

The unit is equipped with a dedicated input for a back-up camera. When a compatible camera (purchased separately) is connected, the display will automatically switch to the camera view when the vehicle is in reverse.

## Steering wheel control



## Back-up camera input



Image: Illustrates the back-up camera input feature, showing a simulated view from a rear camera on the car radio display with parking guidelines. It indicates that the camera is optional.

### 5.8 Colorful Lantern (LED Lighting)

The unit features customizable LED lighting, referred to as 'Colorful Lantern'. You can select from a variety of colors to match your vehicle's interior or personal preference. This lighting can be synchronized with the vehicle's position/low beam lights.

# Colorful Lantern

A variety of colors for you to choose, so that you have a better experience



Image: Displays the 'Colorful Lantern' feature of the CAMECHO Car Radio, showing a spectrum of colors available for the unit's LED lighting and how it appears on the main menu.

## 6. Maintenance

- **Cleaning:** Use a soft, dry cloth to clean the screen and unit. Do not use abrasive cleaners or solvents.
- **Temperature:** Avoid leaving the unit in direct sunlight or extreme cold for extended periods, as this can affect performance and lifespan.
- **Software Updates:** Check the manufacturer's website periodically for any available software updates to ensure optimal performance and compatibility.

## 7. Troubleshooting

If you encounter issues with your CAMECHO Car Radio, refer to the following common problems and solutions:

- **No Power:** Check all power connections and the vehicle's fuse box. Ensure the unit is receiving the correct 12V DC power.

- **No Sound:** Verify speaker connections. Check volume levels and EQ settings. Ensure the unit is not muted.
- **Bluetooth Connection Issues:** Ensure Bluetooth is enabled on both the car radio and your smartphone. Delete previous pairings and attempt to reconnect.
- **Touchscreen Unresponsive:** Try restarting the unit. If the issue persists, a factory reset might be necessary (refer to settings menu).
- **Android Auto Compatibility:** Note that Android Auto does not support Huawei phones.
- **Mirror Link Compatibility:** Note that Mirror Link does not support Samsung models.

## 8. Specifications

Feature	Specification
Brand	CAMECHO
Model	6.86-inch Wireless Carplay
Part Number	A3467
Output Wattage	180 Watts
Number of Channels	4
Supported Internet Services	CarPlay, Android Auto
Product Dimensions	12.5 x 20.5 x 9.5 cm
Product Weight	670 g

## 9. Warranty and Support

For warranty information or technical support, please refer to the purchase documentation or contact CAMECHO customer service directly. Contact details can typically be found on the official CAMECHO website or through your retailer.