



Manuals.plus /

› Ycozy /

› Ycozy WiFi Fish Feeder Navi-BTS Instruction Manual

Ycozy Navi-BTS

Ycozy WiFi Fish Feeder Navi-BTS Instruction Manual

Model: Navi-BTS

1. INTRODUCTION

Thank you for choosing the Ycozy WiFi Fish Feeder Navi-BTS. This automatic fish feeder is designed to provide convenient and precise feeding for your aquarium fish, controlled remotely via a mobile application. It ensures your fish are fed regularly, even when you are away, and helps prevent overfeeding with its adjustable dispensing mechanism. Please read this manual carefully before use to ensure proper installation and operation.

2. PRODUCT OVERVIEW

The Ycozy WiFi Fish Feeder Navi-BTS features a compact design with essential components for reliable operation. Familiarize yourself with the parts below:



Image 2.1: Labeled diagram of the Ycozy WiFi Fish Feeder Navi-BTS components. Key parts include the humidity-resistant lid, food inlet, 200ml container, ventilation holes, power display, WiFi/manual configuration buttons, local time/feeding time display, USB Type-C port for power, and a 360° swivel support.

- **Humidity-Resistant Lid:** Protects food from moisture.
- **Food Inlet:** For easy refilling without disassembling the container.
- **200ml Container:** Holds a sufficient amount of fish food.
- **Ventilation Holes:** Helps maintain food freshness.
- **Power Display:** Indicates power status.
- **Configuration Buttons:** For WiFi setup and manual feeding.
- **LCD Screen:** Displays local time and feeding schedule.
- **USB Type-C Port:** For continuous power supply (the device is not rechargeable).
- **360° Swivel Support:** Adjustable clamp for secure mounting on aquariums up to 24mm thick.

3. SETUP

3.1 Installation Methods

The Ycozy WiFi Fish Feeder offers two installation options to suit different aquarium types:

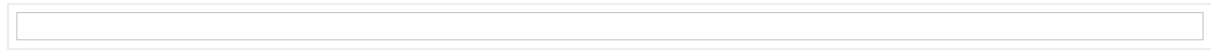

Image 3.1: Illustration of the two installation methods. On the left, the feeder is attached to a tank with a lid using adhesive tape. On the right, it is clamped to the edge of an open tank.

1. Clamp Installation (for open tanks):

Attach the adjustable clamp to the edge of your aquarium. Ensure the tank glass thickness is no more than 24mm (0.95 inches). Tighten the clamp securely to hold the feeder in place. The 360° swivel support allows you to adjust the feeder to the perfect feeding position.

2. Adhesive Tape Installation (for tanks with lids):

For aquariums with lids, use the provided reinforced acrylic double-sided adhesive tape. Clean the surface on the aquarium lid where you intend to mount the feeder. Apply the tape to the feeder's base and firmly press it onto the cleaned surface.

3.2 Power Connection

Connect the feeder using the provided USB-C cable and EU plug. The device requires continuous power to function. It is not battery-operated or rechargeable. Ensure it is always plugged into a power source.

4. CONNECTIVITY & APP SETUP

The Ycozy WiFi Fish Feeder is controlled via the "Smart Life" mobile application. Follow these steps to connect your device:



Image 4.1: Visual guide for connecting the Ycozy fish feeder to the Smart Life app, showing QR code for download, manual button press, device search, WiFi information input, and successful connection.

- 1. Download the "Smart Life" App:** Scan the QR code provided in the image or search for "Smart Life" on the App Store (iOS) or Google Play Store (Android).
- 2. Enter Pairing Mode:** Press the manual button on the feeder. Ensure the WiFi indicator light on the device starts blinking.
- 3. Add Device in App:** Open the "Smart Life" app. The app should automatically search for nearby devices. If not, select "Add Device" and choose the appropriate device type (e.g., "Small Home Appliances" > "Electric Heater (Wi-Fi)" or similar, or manually add).
- 4. Enter WiFi Information:** Select your 2.4GHz WiFi network and enter the password. The device will then connect to your home network.
- 5. Completion:** Once connected, the app will confirm that the device has been added successfully. You can now control your feeder remotely.

5. OPERATION

The Ycozy WiFi Fish Feeder offers both automatic and manual feeding options, all controllable via the Smart Life app.

5.1 Automatic Feeding Schedule

Use the Smart Life app to set up a customized feeding schedule:

NAVI-BTS WIFI DISTRIBUTEUR POISSON TÉLÉCOMMANDE

Nourrissez vos poissons d'une simple pression sur votre téléphone !



Image 5.1: The Smart Life app interface showing options for 'Switch', 'Manual Feed', 'Auto Feed', and 'Record'. It also displays scheduled feeding times and amounts, along with a graph of feeding activity.

1. Open the Smart Life app and select your Ycozy Fish Feeder.
2. Navigate to the "Auto Feed" section.
3. Set desired feeding times (e.g., AM 09:00, PM 05:48).
4. Adjust the feeding amount using the 15-level slider for precise control. This helps prevent overfeeding.
5. All settings are automatically synchronized between the app and the feeder.

5.2 Manual Feeding

For immediate feeding, you can use either the app or the physical button on the device:

- **Via App:** In the Smart Life app, select "Manual Feed" and choose the desired amount to dispense instantly.
- **Via Device:** Press the manual feed button on the feeder's LCD panel to dispense a single portion.

5.3 Feeding History Record

The app automatically records all feeding data, including exact quantities and times. This allows you to monitor your fish's feeding status anytime, anywhere, ensuring they are consistently fed.

ALIMENTATION À DISTANCE DES POISSONS PAR WIFI

Nourrissez vos poissons en un seul clic!

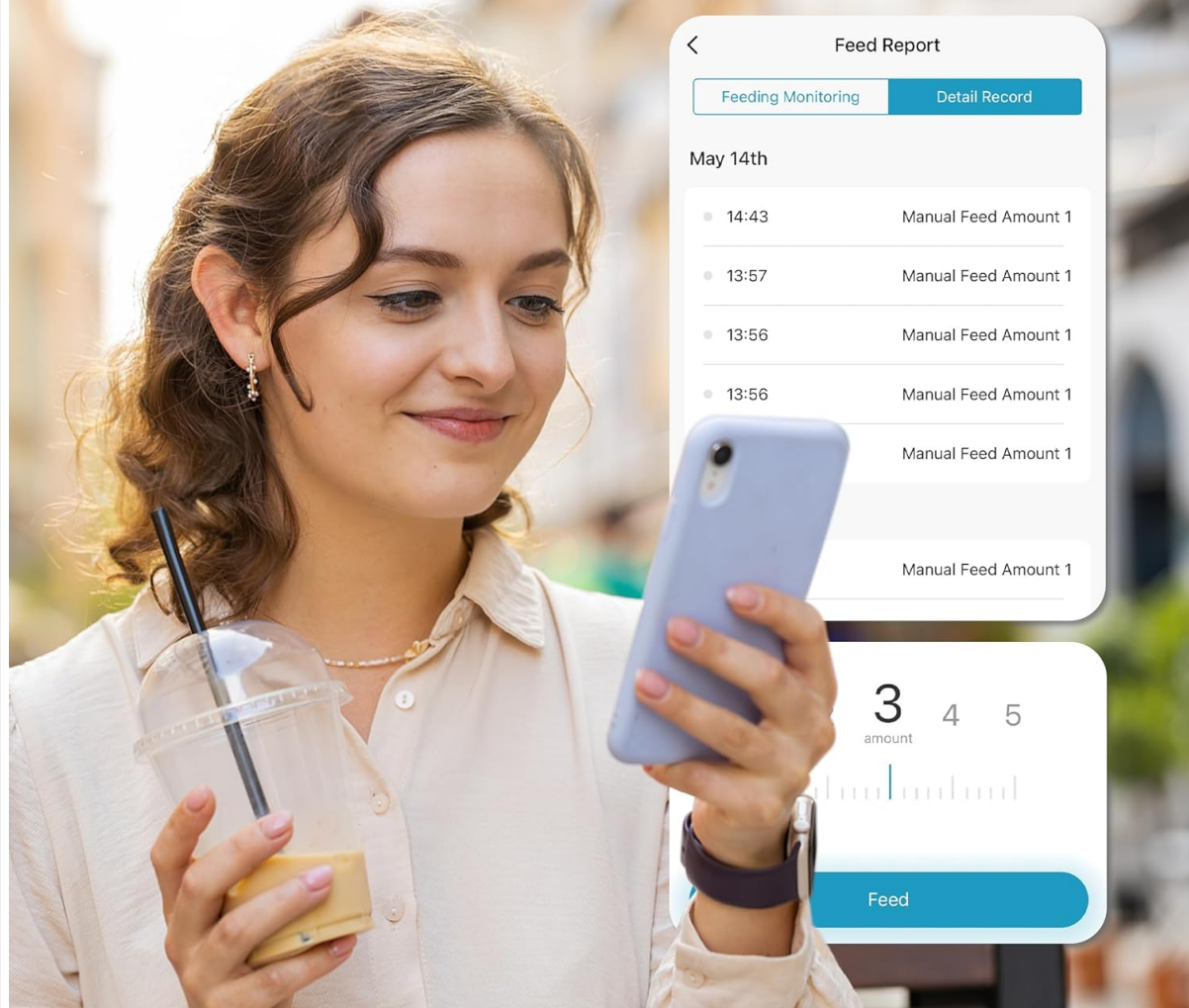

Image 5.2: A user checking the 'Feed Report' in the Smart Life app, which displays a detailed record of manual and automatic feeding events with timestamps.

5.4 Food Compatibility

The feeder is suitable for a variety of fish foods, including flakes, pellets, and crumbs.

6. MAINTENANCE

6.1 Refilling Food

Adding fish food is simple and convenient. You can add food from the top of the feeder without needing to remove the entire food container.

Ajoutez Facilement des Aliments



Grande Capacité



Résistant à L'humidité



Télécommande WiFi



Ultra Silencieux



Image 6.1: A hand refilling the feeder by pouring food directly into the top opening, demonstrating the ease of adding food without removal.

6.2 Humidity Control

The feeder is designed with an improved humidity-resistant container and lid. This feature reduces humidity penetration by over 90%, effectively preventing food agglomeration and deterioration, ensuring your fish food remains fresh and dry.

MÉTHODES DE CONNEXION



Télécharger l'application
"Smart Life"



Appuyez sur le bouton
manuel et assurez-vous que
le signe WiFi clignote.



Recherche d'un appareil à
proximité, en cas d'échec,
ajout manuel de l'appareil

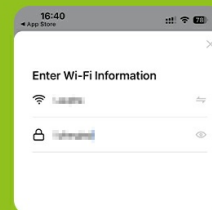

Saisir les informations
sur le WiFi

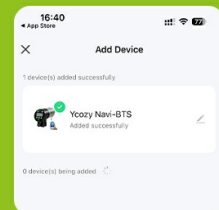

Fin

Image 6.2: A close-up view highlighting the humidity-resistant design of the food container, which protects the food from moisture.

7. TROUBLESHOOTING

If you encounter any issues with your Ycozy WiFi Fish Feeder, please refer to the following common solutions:

Problem	Possible Cause	Solution
Feeder is not turning on or responding.	Not continuously plugged in.	Ensure the USB-C cable is securely connected to a power source and the feeder. The device requires continuous power.
Cannot connect to WiFi or app.	Incorrect WiFi password; Feeder not in pairing mode; Router issues.	Double-check your WiFi password. Ensure the feeder's WiFi indicator is blinking during setup. Restart your router and try again. Confirm your WiFi is 2.4GHz.
Feeder stops working after a power outage.	Temporary power loss.	The feeder is designed to automatically reconnect to WiFi once power is restored. The app will send an offline notification during power loss and a reconnection notification when power returns.
Food is not dispensing or is clogged.	Food agglomeration; Dispensing mechanism obstruction.	Ensure the food container is dry and the humidity-resistant features are working. Check for any obstructions in the dispensing mechanism. Use appropriate food types (flakes, pellets, crumbs).
Time on feeder is incorrect.	Not synchronized with app.	The feeder automatically synchronizes time with your phone via the app once connected to WiFi. Ensure the app is connected and has the correct time zone.

8. SPECIFICATIONS

Here are the technical specifications for the Ycozy WiFi Fish Feeder Navi-BTS:

- **Model Number:** Navi-BTS
- **Dimensions (L x W x H):** 16.6 x 12 x 8.9 cm (6.5 x 4.7 x 3.5 inches)
- **Weight:** 290 grams (0.64 lbs)
- **Color:** Black
- **Food Container Volume:** 210 Milliliters
- **Power Source:** USB-C (requires continuous power, not battery-operated)
- **Special Features:** WiFi Remote Control, 15-level feeding adjustment, Humidity-resistant design
- **Material:** Acrylonitrile Butadiene Styrene (ABS)
- **Target Species:** Fish
- **Recommended Use:** Indoor
- **Operating Mode:** Automatic
- **Connectivity:** 2.4GHz WiFi

9. WARRANTY & SUPPORT

For warranty information, technical support, or any questions regarding your Ycozy WiFi Fish Feeder Navi-BTS, please refer to the product packaging or contact Ycozy customer support directly through their official website or the retailer where the product was purchased. Please have your model number (Navi-BTS) and purchase details ready when contacting support.