

[Manuals.plus](#) /

› [AWESAFE](#) /

› AWESAFE 10 Inch Car Radio Stereo User Manual for Chevy Silverado 2007-2013, Tahoe, GMC Sierra, Yukon with Wireless CarPlay Android Auto

AWESAFE B0FD3J3DNS

AWESAFE 10 Inch Car Radio Stereo User Manual

Model: B0FD3J3DNS

For Chevy Silverado (2007-2013), Tahoe, GMC Sierra, Yukon

1. INTRODUCTION

Thank you for choosing the AWESAFE 10 Inch Car Radio Stereo. This manual provides detailed instructions for installation, operation, and troubleshooting to ensure optimal performance and user experience. Please read this manual thoroughly before using the product and retain it for future reference.

Safety Information:

- Always operate the device responsibly and in accordance with local traffic laws.
- Do not attempt to install or repair the unit if you are not qualified. Seek professional assistance.
- Ensure all connections are secure before driving.

2. COMPATIBLE VEHICLE MODELS

This car radio stereo is designed for specific vehicle models and years:

- Chevy Silverado 1500 (2007-2013)
- Chevy Silverado 2500HD (2007-2013)
- Chevy Silverado 3500HD (2007-2013)
- Chevrolet Avalanche (2007-2011)
- Chevrolet Express Van (2008-2011)
- Chevrolet Impala (2006-2012)
- GMC Acadia (2007-2012)
- GMC Savana (2008-2013)
- GMC Sierra (2007-2011)
- GMC Yukon (2007-2013)

3. PACKAGE CONTENTS

Verify that all items listed below are included in your package:

Packing List

			
 RCA cable	 Power Cable	 Power Cable	 Can Bus
 Crowbar	 Reversing line	 Antenna	 Screwdriver
 Back videoin	 USB cable *2	 Microphone	 Speaker

Image: Package Contents Diagram

- 10.1 Inch Car Radio Unit
- Power Cable (x2)
- RCA Cable
- Reversing Line
- Antenna & Back Video-in Cable
- Can Bus Decoder
- USB Cable (x2)
- Crowbar (Installation Tool)
- Screwdriver
- Speaker
- Microphone

4. INSTALLATION GUIDE

Professional installation is recommended. If you choose to install it yourself, proceed with caution. Always disconnect the vehicle's battery before starting installation.

4.1. Wiring Diagram



Image: Wiring Diagram

Refer to the wiring diagram for proper connection of all cables. Ensure each cable is connected to its corresponding port on the car radio and the vehicle's harness.

1. **Power Cable:** Connect to the vehicle's power harness.
2. **RCA Cable:** For audio/video input/output, including AMP control, AUX, and subwoofer output.
3. **Rear Camera Input Cable:** Connect the backup camera.
4. **Can Bus Cable:** For integrating with vehicle's CAN-BUS system (e.g., steering wheel controls).
5. **Radio Antenna:** Connect the vehicle's radio antenna.
6. **GPS Antenna:** Position in a location with clear sky view for optimal signal.
7. **USB Cables:** For connecting USB devices or charging.
8. **Microphone:** For hands-free calling.

4.2. General Installation Steps

1. Carefully remove the factory radio and trim using the provided crowbar tool.
2. Connect the new AWESAFE car radio to the vehicle's wiring harness according to the wiring diagram.
3. Install the GPS antenna in a suitable location, typically on the dashboard or under the windshield, ensuring it has a clear view of the sky.
4. Mount the backup camera (if included and desired) and route its cable to the radio unit.
5. Secure the main unit in the dashboard.
6. Reconnect the vehicle's battery and test all functions before fully reassembling the dashboard trim.

5. SETUP AND BASIC OPERATION

5.1. Initial Power On

After installation, turn on your vehicle's ignition. The unit should power on automatically. Follow any on-screen prompts for initial setup, such as language selection and time zone.

5.2. Touch Screen Interface



Image: Main Display with CarPlay Interface

The unit features a responsive 10-inch capacitive touchscreen. Navigate through menus and applications by tapping, swiping, and pinching (where applicable).

5.3. System Memory



Image: System Memory Overview

The unit is equipped with a 4-core processor, 2GB RAM, and 32GB ROM, providing sufficient performance for applications and storage.

6. OPERATING INSTRUCTIONS

6.1. Wireless CarPlay & Android Auto

Wireless CarPlay/Android Auto

connect your phone through Bluetooth, you can access to your maps, music, phone call and messages.



Image: Wireless CarPlay and Android Auto

Connect your iPhone or Android phone wirelessly via Bluetooth to access CarPlay or Android Auto. This allows for navigation, calls, messages, and music playback directly from your phone's interface on the car stereo screen.

- **Pairing:** Go to the Bluetooth settings on the car stereo and your phone. Select the car stereo's Bluetooth name on your phone to pair.
- **Activation:** Once paired, CarPlay or Android Auto should launch automatically or can be selected from the main menu.

6.2. GPS Navigation

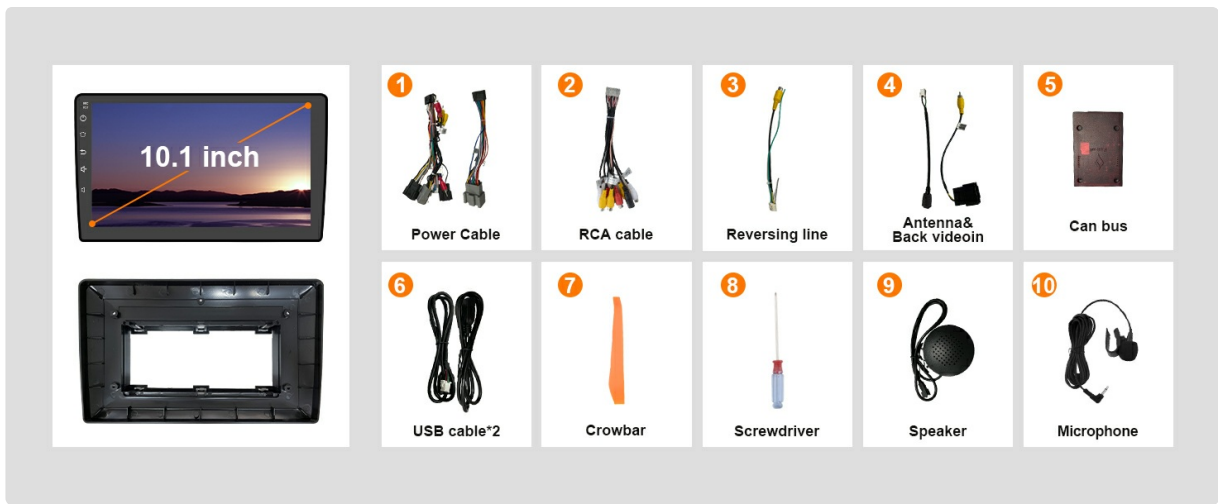

Image: GPS Navigation Interface

The unit supports online GPS navigation. Connect to a Wi-Fi network to download maps and receive real-time traffic updates. You can use pre-installed navigation apps or download others from the application store.

6.3. Bluetooth Connectivity



Image: Bluetooth Calling and Music

Connect your phone via Bluetooth for hands-free calling and wireless music streaming. The built-in microphone ensures clear communication.

- **Making Calls:** Access the phone application on the stereo to dial numbers or select contacts.
- **Music Playback:** Use the music application to control playback from your paired device.

6.4. FM/AM Radio

Wiring Diagram

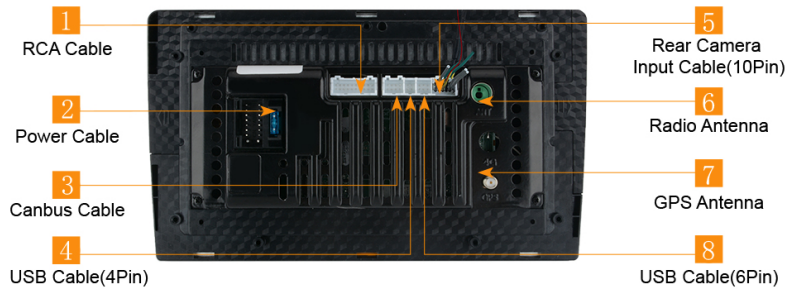

RCA Cable

- 1 AMP Control Cable
- 2 AUX LIN,Audio Input Left
- 3 AUX RIN,Audio Input Right
- 4 RCA FL,Audio Output Left
- 5 RCA FR,Audio Output Right
- 6 AUX Out,Video Output
- 7 AUX VIN,Video Input
- 8 AUX VIN2,Video Input
- 9 Sub,Subwoofer Output
- 10 Mic,Microphone Port

Image: FM/AM Radio Interface

Access the built-in FM/AM tuner for local radio stations. The unit supports automatic and manual station searching, as well as saving preset stations.

6.5. Split Screen Functionality

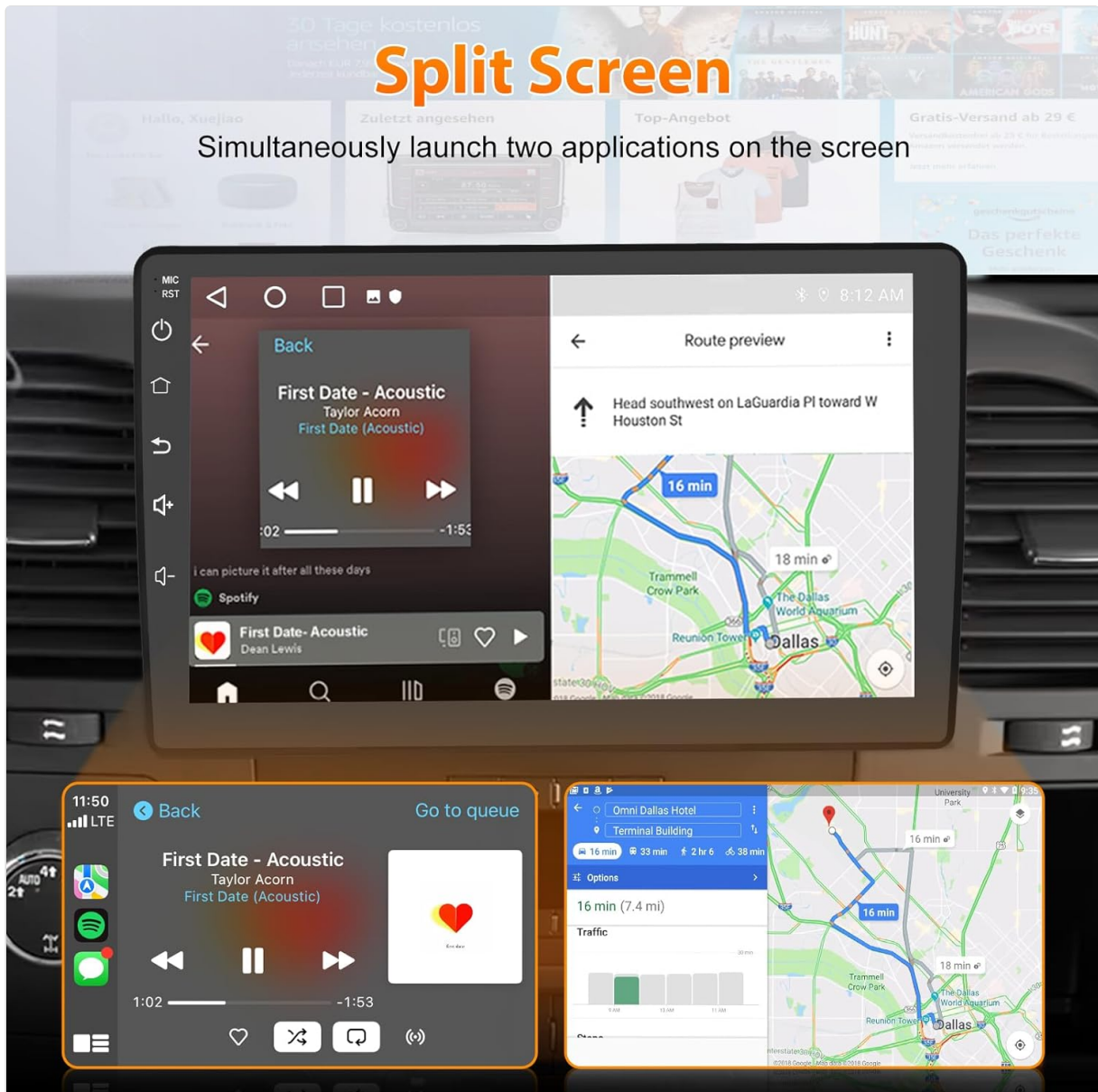

Image: Split Screen Display

The split-screen feature allows you to run two applications simultaneously, such as navigation and music

playback, for enhanced multitasking.

- **Activation:** Typically, long-press an app icon or use a dedicated split-screen button (if available) to activate.

6.6. Steering Wheel Control (SWC)



Image: Steering Wheel Control Setup

Maintain control of your stereo without taking your hands off the wheel. The Steering Wheel Control feature allows you to adjust volume, change tracks, and manage calls effortlessly. Refer to the system settings for SWC learning and configuration.

6.7. DSP Sound System

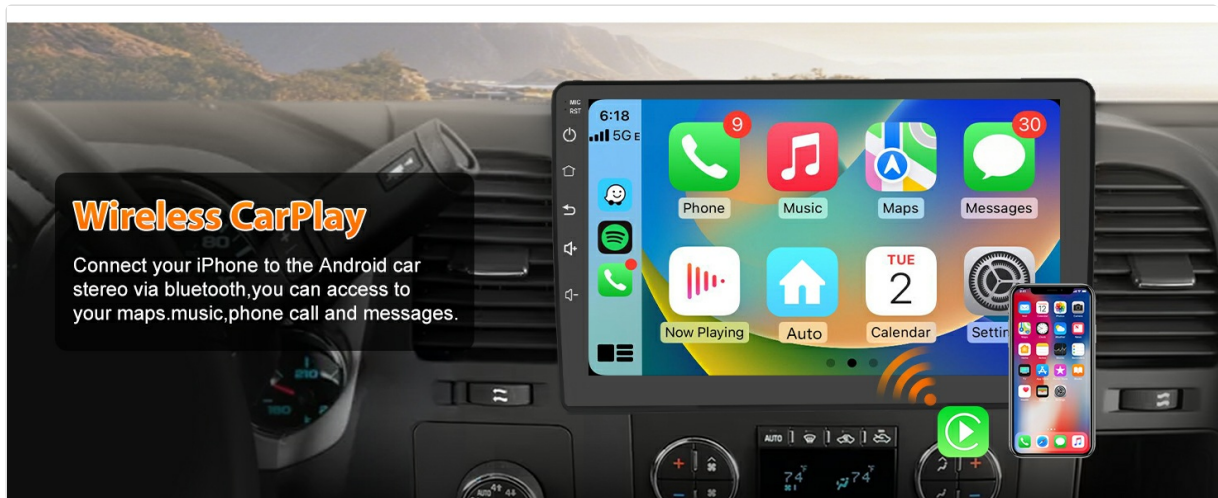

Image: DSP Sound System

Equipped with a Digital Sound Processor (DSP) and 36-band equalizer, the unit allows for fine-tuning of audio output to suit your preferences, offering various sound modes like Normal, Jazz, Pop, Classical, and Rock.

6.8. 5GHz WiFi Connectivity

5GHz WiFi

Equipped with 5G Wifi to ensure faster speeds, after connected to WiFi, you can use GPS Navigation at anywhere.



Image: 5GHz WiFi Connectivity

The unit supports 5GHz Wi-Fi, providing faster data transmission speeds for online applications, streaming, and map downloads.

6.9. Backup Camera

When the vehicle is shifted into reverse, the display will automatically switch to the backup camera view, providing parking assistance with guidelines.

7. MAINTENANCE

To ensure the longevity and optimal performance of your car radio stereo, follow these simple maintenance guidelines:

- **Cleaning:** Use a soft, dry cloth to clean the screen and exterior. For stubborn smudges, a slightly damp cloth with a mild, non-abrasive cleaner can be used. Avoid harsh chemicals.
- **Temperature:** Avoid exposing the unit to extreme temperatures, both hot and cold, for extended periods.
- **Software Updates:** Periodically check for available software updates to ensure the system runs efficiently and has the latest features.

8. TROUBLESHOOTING

If you encounter issues, refer to the following common problems and solutions:

Problem	Possible Cause	Solution
Unit does not power on.	Incorrect wiring, blown fuse, vehicle battery issue.	Check power connections, inspect vehicle fuses, ensure battery is charged.
No sound.	Volume too low, speaker wires disconnected, incorrect audio settings.	Increase volume, check speaker wiring, verify audio output settings.
Bluetooth connection issues.	Device not paired, Bluetooth off, interference.	Ensure Bluetooth is enabled on both devices, re-pair the device, move closer to the unit. Note: Initial connection may take 20-30 seconds.
GPS signal weak or inaccurate.	GPS antenna obstructed or improperly placed.	Relocate GPS antenna to a position with a clear view of the sky.
Steering Wheel Controls not working.	Incorrect wiring, SWC not configured.	Verify CAN-BUS or SWC wiring. Access system settings to perform SWC learning/configuration.
Backup camera not displaying.	Camera wiring issue, reverse trigger not connected.	Check camera connections and ensure the reverse trigger wire is correctly connected.

If the problem persists, please contact customer support.

9. SPECIFICATIONS

Feature	Detail
Display Size	10 Inches
Display Type	Capacitive Touch Screen
Processor	4 Core
RAM	2GB
ROM	32GB
Connectivity	Bluetooth, 5GHz WiFi
Special Features	Wireless CarPlay, Android Auto, GPS Navigation, DSP Sound System, Split Screen, Backup Camera Support, Steering Wheel Control
Map Type	North America (Online)
Item Weight	4.27 pounds (1.94 Kilograms)

Feature	Detail
Package Dimensions	11.57 x 7.8 x 5.12 inches

10. WARRANTY AND SUPPORT

10.1. Warranty Information

This AWESAFE product comes with a **1-year warranty** from the date of purchase, covering manufacturing defects. Please retain your proof of purchase for warranty claims.

10.2. Customer Support



Image: Customer Support

For technical assistance, troubleshooting, or warranty inquiries, please contact AWESAFE customer support:

Email: AWESAFE-US@outlook.com

24 Hours Customer Support