

## Manuals+

[Q & A](#) | [Deep Search](#) | [Upload](#)

manuals.plus /

- › [Creality](#) /
- › [Creality Falcon A1 10W Laser Engraver User Manual](#)

## Creality Falcon A1 10W

# Creality Falcon A1 10W Laser Engraver User Manual

Model: Falcon A1 10W

Brand: Creality

## 1. INTRODUCTION

---

This manual provides essential information for the safe and effective operation of your Creality Falcon A1 10W Laser Engraver and its accompanying Smoke Purifier. Please read this manual thoroughly before operating the device to ensure proper usage and to prevent damage or injury.

### Product Overview

The Creality Falcon A1 10W is an enclosed laser engraving and cutting machine designed for precision work on various materials. It features a 10W (10000mW) laser with an ultra-fine 0.06 x 0.08 mm spot, enabling detailed photo-realistic engravings and efficient cutting. The system includes a Class 1 safety certification, an enclosed design for smoke and noise reduction, and an integrated smoke purifier for a clean working environment.



Figure 1: Creality Falcon A1 10W Laser Engraver and Smoke Purifier. The image shows the main laser engraver unit with its enclosed design and the separate smoke purifier unit, along with various materials that can be engraved.

## 2. SAFETY INFORMATION

---

Operating a laser engraver involves potential hazards. Adhere to all safety guidelines to prevent injury or damage.

### Class 1 Safety Certification

The Falcon A1 is a Class 1 laser product, meaning it is safe under all conditions of normal use. This is achieved through its enclosed design and protective features.

- **Protective Covers:** The two protective covers filter 99% of laser light, eliminating the need for external goggles during operation.
- **Enclosed Design:** The enclosed structure blocks smoke and reduces operational noise, contributing to a safer and more comfortable workspace.
- **Emergency Stop:** An emergency stop button is provided for immediate shutdown in critical situations.
- **Lid-Open Stop Feature:** The machine automatically stops operation if the lid is opened during engraving or cutting.

# Smarter Camera, Easier Operations

Better for alignment and support for batch engraving or cutting



Camera

No Camera

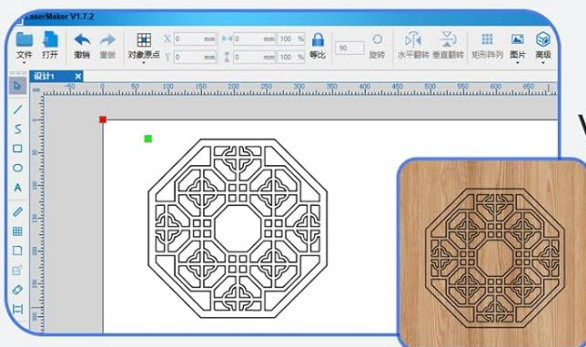

VS

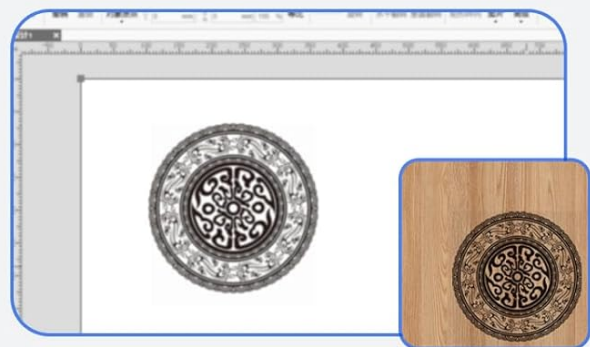

Get What U See

Get What U Guess

Figure 2: Class 1 Safety Certified features. This image highlights the anti-laser baffles (above and side), the automatic stop when the flap is lifted, and the high visibility of the work in progress through the protective cover.

## General Safety Precautions

- Ensure the device is placed on a stable, level surface.
- Do not operate the laser engraver unattended.
- Keep flammable materials away from the operating area.
- Ensure proper ventilation, especially when using the smoke purifier.
- Do not attempt to bypass safety mechanisms.

## 3. SETUP

### Unpacking and Initial Inspection

Carefully remove all components from the packaging. Inspect for any signs of damage during transit. Report any damage to the retailer immediately.

## Assembly

The Creativity Falcon A1 is largely pre-assembled, allowing for quick setup. Minimal assembly may be required for certain components or accessories.

# Ready to Use out of the Box

✓ 0S Pre-assembled

✗ 30S Assembly required

1. Choose a design

2. Materials auto recognized

3. Push and done

Figure 3: Ready to Use out of the Box. The image shows the pre-assembled unit and indicates minimal assembly is required, contrasting with a typical assembly process.

## Connecting the Smoke Purifier

The included Falcon Smoke Purifier is designed to work seamlessly with the A1 engraver. Connect the exhaust hose from the engraver to the purifier. The purifier supports dual-size exhaust pipes: 63mm for the A1 and 76mm for other Creativity Falcon series machines or protective covers.

# Class 1 Safety Certified

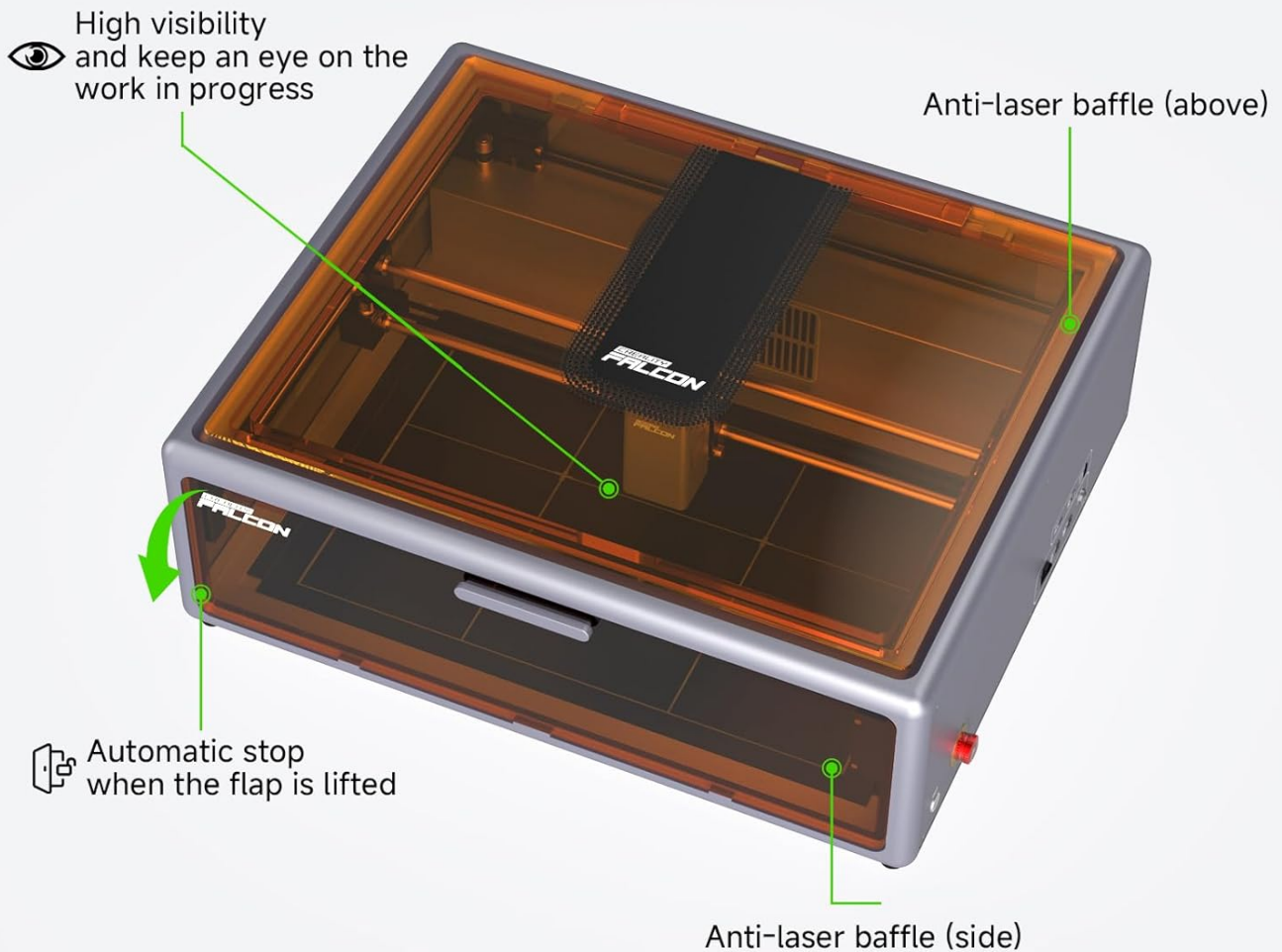

Figure 4: Falcon A1 connected to the Smoke Purifier. This image illustrates the connection between the laser engraver and the smoke purifier, highlighting the compatible exhaust pipe sizes.

## Power Connection

Connect the power adapter to the engraver and then to a suitable power outlet. Ensure the power switch is in the OFF position before connecting.

## 4. OPERATING INSTRUCTIONS

---

### Software Compatibility

The Creality Falcon A1 is compatible with Creality Falcon Design Space software, which offers an intuitive platform for design and operation. It also supports mainstream software such as LightBurn and LaserGRBL.



Figure 5: Software compatibility and key features. This image shows the Creadity Falcon Design Space and LightBurn software interfaces, along with details on the compressed laser spot size and cutting capabilities for acrylic and wood.

## Engraving and Cutting Process

1. **Choose a Design:** Select or create your desired pattern using the compatible software.
2. **Place Material:** Position the material to be engraved or cut on the work area. The machine features automatic material recognition.
3. **Preview and Engrave:** Utilize the software's preview function to ensure correct placement and settings. Pre-tested optimal parameter settings are available for various materials. Initiate the engraving or cutting process.

# Ready to Use out of the Box

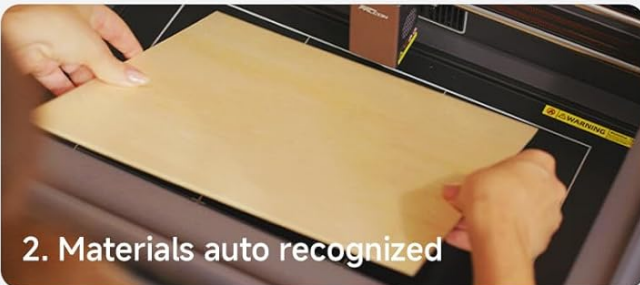
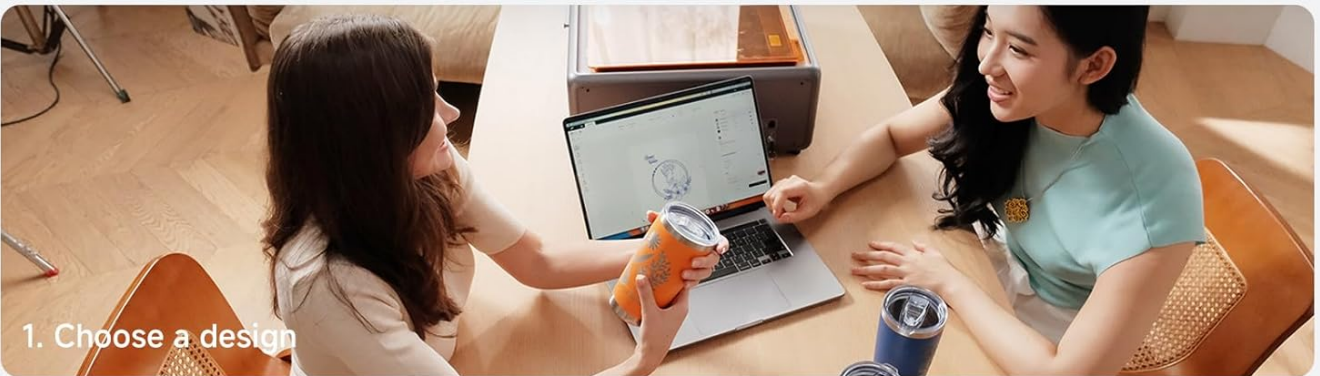
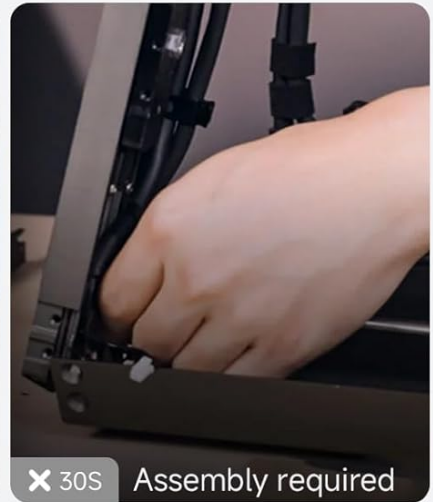

Figure 6: Operational workflow. This image illustrates the three main steps: choosing a design, automatic material recognition, and initiating the engraving process.

## Material Compatibility

The Falcon A1 10W laser engraver can process a wide range of materials, including:

- Wood (cuts up to 6mm)
- Acrylic (cuts up to 10mm)
- Stainless Steel
- Leather
- Rock
- Glass
- Cork
- Silicon
- Gold
- Silver

- Platinum
- Aluminum
- Titanium
- Brass
- Plastic

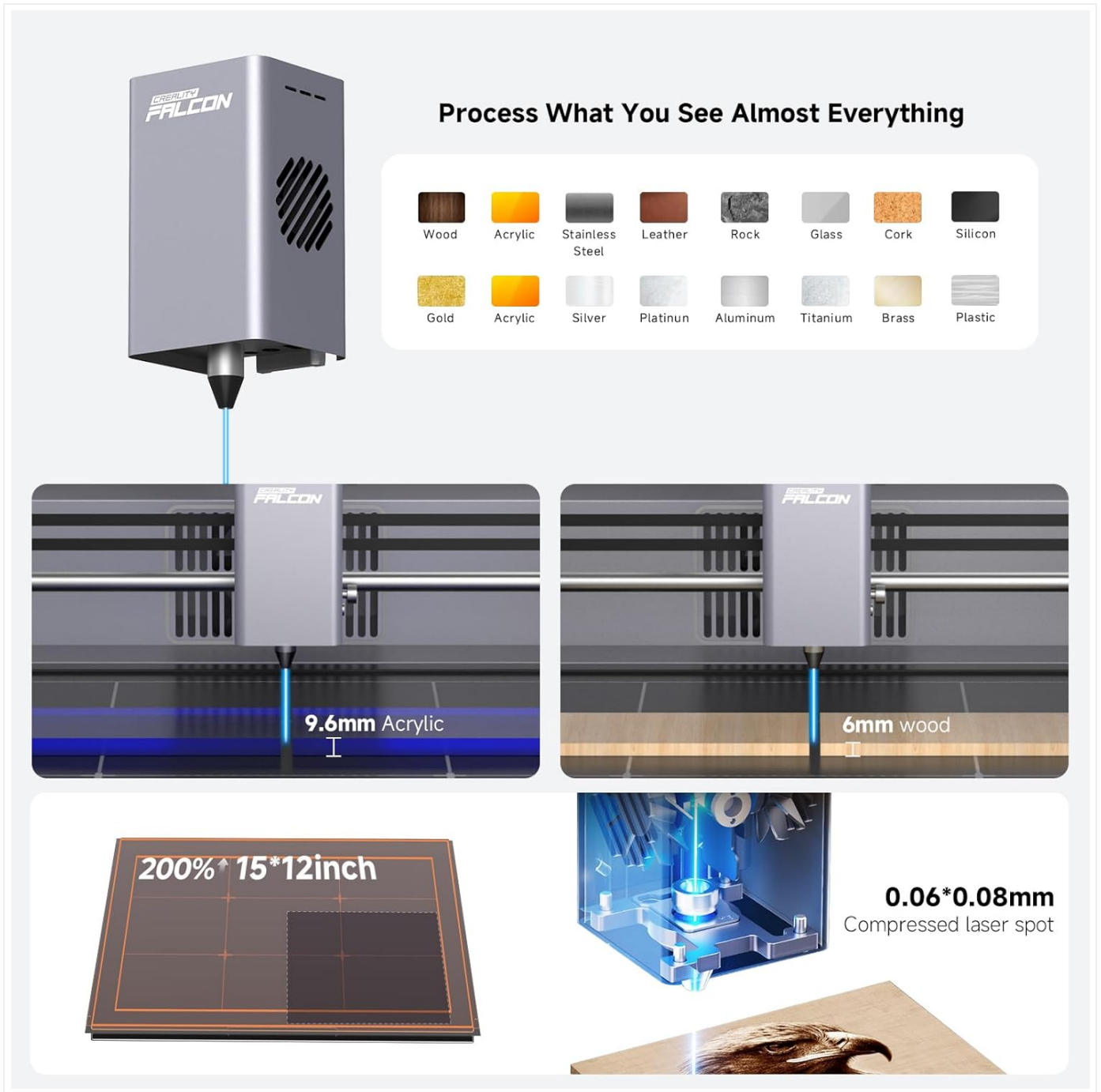

Figure 7: Material processing capabilities. This image displays a variety of materials that can be engraved or cut, including wood, acrylic, stainless steel, leather, and more, along with examples of cutting depth for acrylic and wood.

## Camera Functionality

The integrated high-definition camera assists with alignment and supports batch engraving or cutting, providing a "What You See Is What You Get" experience for precise positioning.

# Perfectly Compatible with Falcon A1



Equipped with Interfaces to Support Dual  
Size Exhaust Pipes **63mm** Fits A1  
**76mm** fits Creality Falcon series machine  
and Creality Falcon series Protectcover

Figure 8: Integrated camera for precise operations. This image shows the laser engraver with its lid open, highlighting the camera and demonstrating how it aids in accurate design placement compared to operating without a camera.

## 5. MAINTENANCE

### Smoke Purifier Filter Replacement

The Falcon Smoke Purifier utilizes a 2-layer filtration system, including a pre-filter and an activated carbon filter, to achieve 99.97% purification. Regular replacement of these filters is crucial for maintaining optimal performance and air quality.



Figure 9: Pre-filter for the smoke purifier. This filter captures larger visible particles like dust.



Figure 10: Activated Carbon Filter for the smoke purifier. This filter absorbs harmful gases and unpleasant odors.

Refer to the purifier's specific manual for detailed instructions on filter access and replacement frequency.

## Cleaning the Engraver

- Ensure the engraver is powered off and unplugged before cleaning.
- Use a soft, dry cloth to wipe down the exterior surfaces.
- Periodically clean the work area and laser lens according to the detailed cleaning instructions in the full product manual.

## 6. TROUBLESHOOTING

This section addresses common issues you might encounter. For more complex problems, contact customer support.

Problem	Possible Cause	Solution
Laser not firing	Lid open, emergency stop engaged, power issue, software error.	Ensure lid is closed, check emergency stop button, verify power connection, restart software.
Poor engraving quality	Incorrect material settings, dirty lens, material not flat, laser focus incorrect.	Adjust power/speed settings, clean laser lens, ensure material is flat, check laser focus.
Smoke purifier not effective	Clogged filters, improper hose connection, fan speed too low.	Replace filters, check hose connections for leaks, increase fan speed.

## 7. SPECIFICATIONS

Feature	Detail
Model	Falcon A1 10W
Laser Power	10W (10000mW)

Feature	Detail
Spot Size	0.06 x 0.08 mm
Cutting Capacity (Wood)	6mm (single pass)
Cutting Capacity (Acrylic)	10mm (single pass)
Safety Certification	Class 1
Material	Acrylic, Alloy Steel, Metal, Plastic
Color	White
Operation Mode	Manual
Smoke Purifier Size	L7.28*W7.28*H8.07 inches
Smoke Purifier Weight	8.3 lbs
Smoke Purifier Filtration	2-Layer (Pre-filter, Activated Carbon), 99.97% purification

## 8. CUSTOMER SUPPORT AND WARRANTY

---

### Warranty Information

The product comes with a return policy allowing for refund/replacement within 30 days. For detailed warranty terms and conditions, please refer to the official Creality website or contact your retailer.

### Contact Information

For technical assistance, troubleshooting, or warranty claims, please visit the official Creality website or contact their customer service department. You can also refer to the [Creality Store on Amazon](#) for additional resources.

