

## Deako DS-MSMM-WHMC-UCX

# Deako Smart Light Switch (Gen 2) Instruction Manual

Model: DS-MSMM-WHMC-UCX | Brand: Deako

## 1. INTRODUCTION

The Deako Smart Light Switch (Gen 2) provides advanced control over your home lighting. This smart switch supports single-pole, 3-way, and 4-way circuits, integrating seamlessly with your 2.4 GHz Wi-Fi network for remote access and automation. Key features include:

- **Remote Control:** Manage your lights from anywhere using the Deako App.
- **Voice Control:** Compatible with popular smart home assistants like Alexa and Google Assistant.
- **Magic Linking Technology:** Simplifies multi-way lighting setups without complex wiring or programming.
- **Beacon LED Light Bar:** A customizable light bar that indicates light status or helps locate the switch in the dark.
- **Programmable Features:** Create schedules, timers, groups, and scenes for automated lighting.

This manual provides detailed instructions for installation, setup, and operation to ensure optimal performance of your Deako Smart Light Switch.



Image 1.1: Front view of the Deako Smart Light Switch (Gen 2).

## 2. SAFETY INFORMATION

Before beginning installation, read and understand all instructions. Improper installation can result in electric shock or fire. Always follow local electrical codes.

- **Turn Off Power:** Always disconnect power at the circuit breaker or fuse box before installing or servicing the switch.
- **Neutral Wire Required:** A neutral wire connection is essential for the Deako Smart Light Switch to function. Ensure your electrical box has a neutral wire.
- **Qualified Electrician:** If you are unsure about any part of the installation process, consult a qualified electrician.
- **Indoor Use Only:** This device is designed for indoor use in dry locations.
- **Operating Voltage:** Ensure the switch is installed in a 120 Volts (AC) circuit.

## 3. WHAT'S IN THE BOX

Your Deako Smart Light Switch package includes:

- Deako Smart Light Switch (Gen 2)
- Instruction Booklet (this manual)

## 4. SPECIFICATIONS

Feature	Detail
Model Number	DS-MSMM-WHMC-UCX
Product Dimensions	1.77 x 1.67 x 3.2 inches
Weight	2.89 ounces
Current Rating	15 Amps
Operating Voltage	120 Volts (AC)
Load Compatibility	11A resistive/general use, 1000W incandescent, 600W LED/MLV/ELV, or 1/2 HP loads
Switch Type	Push Button
Connectivity	2.4 GHz Wi-Fi
Material	Thermoplastic
Required Wiring	Neutral Wire

## 5. INSTALLATION

The Deako Smart Light Switch is designed for straightforward installation, especially when replacing an existing Deako switch. A Deako backplate with a neutral wire connection is required for installation. The switch works on single-pole, 3-way, and 4-way circuits.

### 5.1 Installation Steps

1. **Power Off:** Before starting, turn off the power to the light switch at your circuit breaker. Verify the power is off using a voltage tester.
2. **Remove Original Switch:** Carefully remove your existing light switch and faceplate from the wall box. If you are replacing a non-Deako switch, ensure a Deako backplate is installed and wired correctly, including a neutral wire connection.
3. **Plug-in Deako Smart Switch:** Align the Deako Smart Light Switch with the Deako backplate and firmly push it into place until it clicks.
4. **Install Faceplate:** Attach the Deako faceplate over the installed smart switch.
5. **Restore Power:** Turn the power back on at the circuit breaker. The switch's Beacon LED light bar should illuminate, indicating it is powered.



Adjust multiple lights without getting up.

Image 5.1: Visual guide for the four-step installation process: 1. Power off, 2. Remove original, 3. Plug-in, 4. Enjoy.

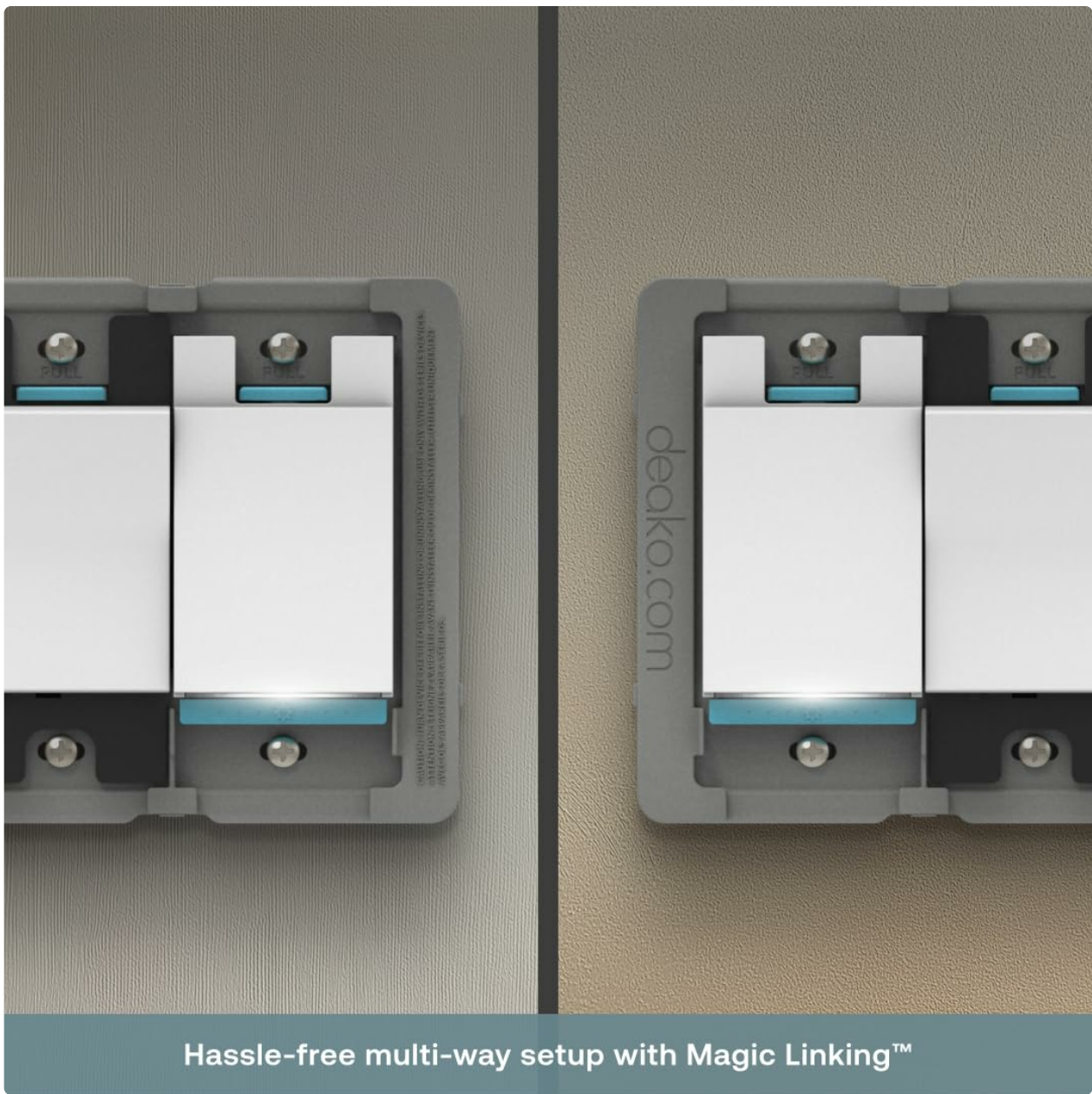

Image 5.2: Exploded view illustrating the plug-and-play installation of the Deako Smart Switch with its backplate and faceplate.

## 5.2 Magic Linking Technology

Deako's exclusive Magic Linking technology simplifies multi-way lighting setups. When multiple Deako Smart Switches are installed in a multi-way circuit, they automatically detect and configure themselves without requiring manual programming or additional wiring. This ensures a hassle-free setup for controlling a single light fixture from multiple locations.

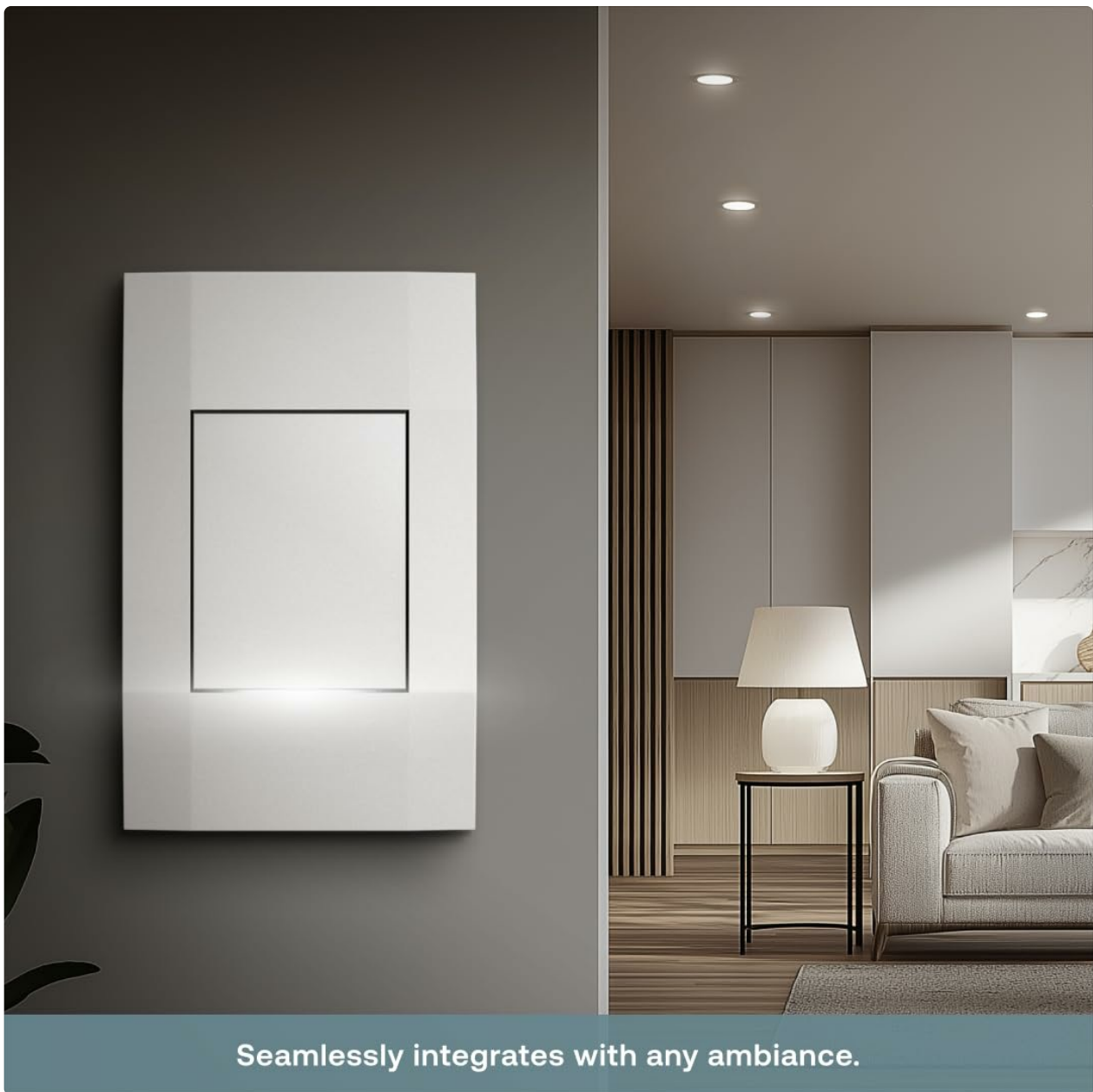

Image 5.3: Visual representation of Magic Linking, showing two Deako Smart Switches automatically connecting for multi-way control.

Your browser does not support the video tag.

Video 5.1: An introductory video showcasing the Deako Smart Switch (Gen 2), highlighting its effortless installation with Magic Linking, voice control capabilities, and the Beacon light bar feature.

## 6. SETUP

After physical installation, set up your Deako Smart Light Switch using the Deako App to unlock its full smart capabilities.

### 6.1 Deako App Installation and Wi-Fi Connection

1. **Download the Deako App:** Search for "Deako" in your smartphone's app store (iOS or Android) and download the application.
2. **Create an Account:** Open the app and follow the on-screen instructions to create a new Deako account or log in to an existing one.
3. **Add Device:** In the Deako App, select the option to add a new device. The app will guide you through connecting your Smart Switch to your home's 2.4 GHz Wi-Fi network. Ensure your phone is connected to the 2.4 GHz band of your Wi-Fi during setup.



4. **Device Naming:** Assign a descriptive name to your switch (e.g., "Kitchen Lights," "Living Room Lamp") for easy identification and voice control.

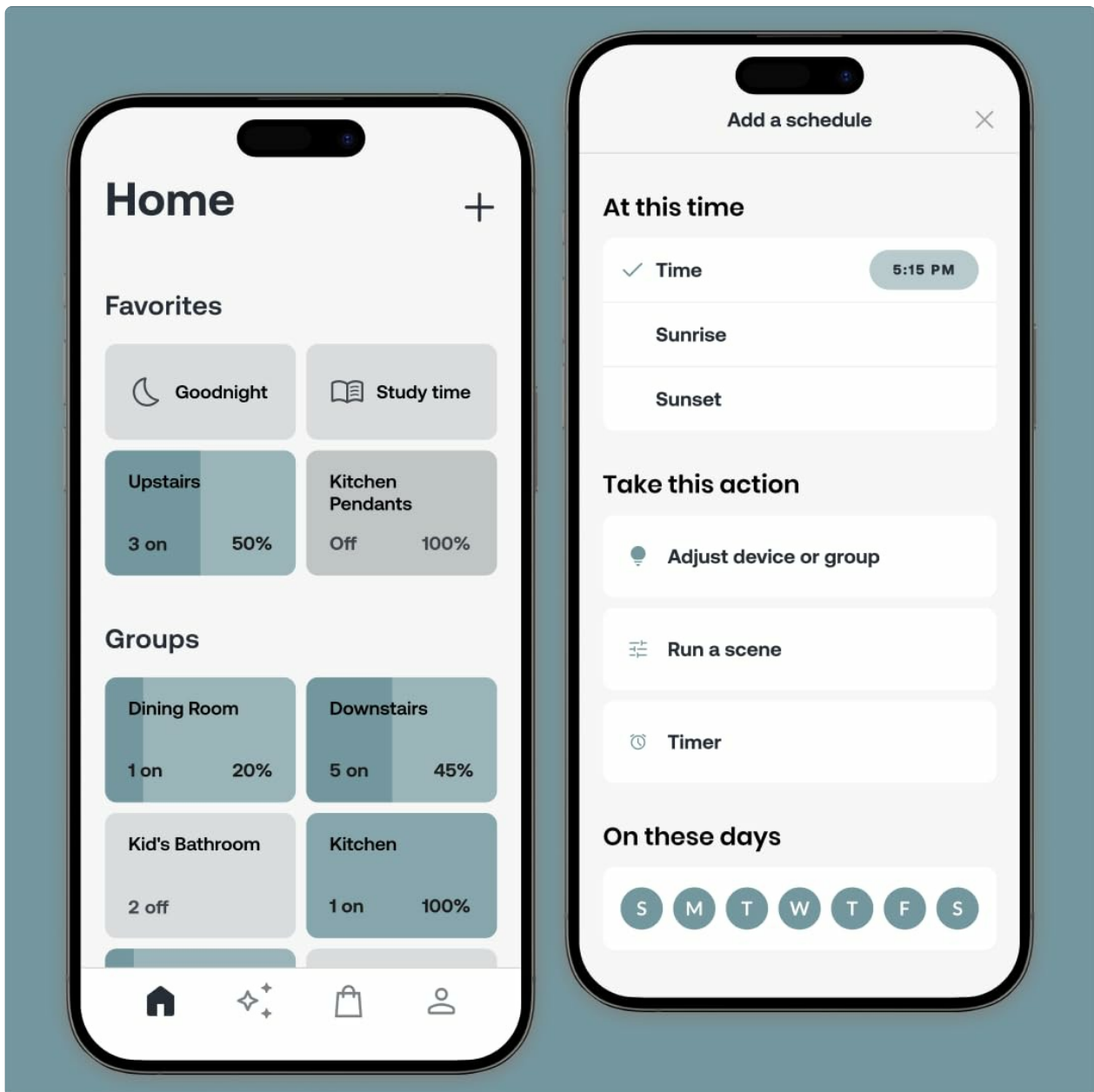

Image 6.1: Screenshots of the Deako App interface, demonstrating the home screen with device groups and scheduling features.

## 6.2 Smart Home Integration

The Deako Smart Light Switch integrates with various smart home platforms for enhanced control:

- Amazon Alexa
- Google Home / Google Assistant
- Samsung SmartThings
- Alarm.com
- Home Assistant
- Control4
- Clare

Refer to the respective smart home platform's instructions for connecting Deako devices. Typically, this involves enabling the Deako skill or service within the platform's app and linking your Deako account.

## Seamlessly integrate your smart home

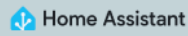

Image 6.2: Compatible smart home platforms for seamless integration with Deako devices.

## 7. OPERATION

Control your Deako Smart Light Switch using the physical button, the Deako App, or voice commands.

### 7.1 Manual Control

Press the switch button to toggle the connected lights on or off. The physical button provides immediate control regardless of smart home connectivity.

### 7.2 Deako App Control

The Deako App allows comprehensive control and customization:

- **On/Off Control:** Tap the switch icon in the app to turn lights on or off.
- **Schedules & Timers:** Set specific times for lights to turn on or off automatically.
- **Groups:** Combine multiple Deako switches to control them simultaneously.
- **Scenes:** Create custom lighting presets (e.g., "Movie Night" scene that dims lights).
- **Routines:** Automate actions based on various triggers.



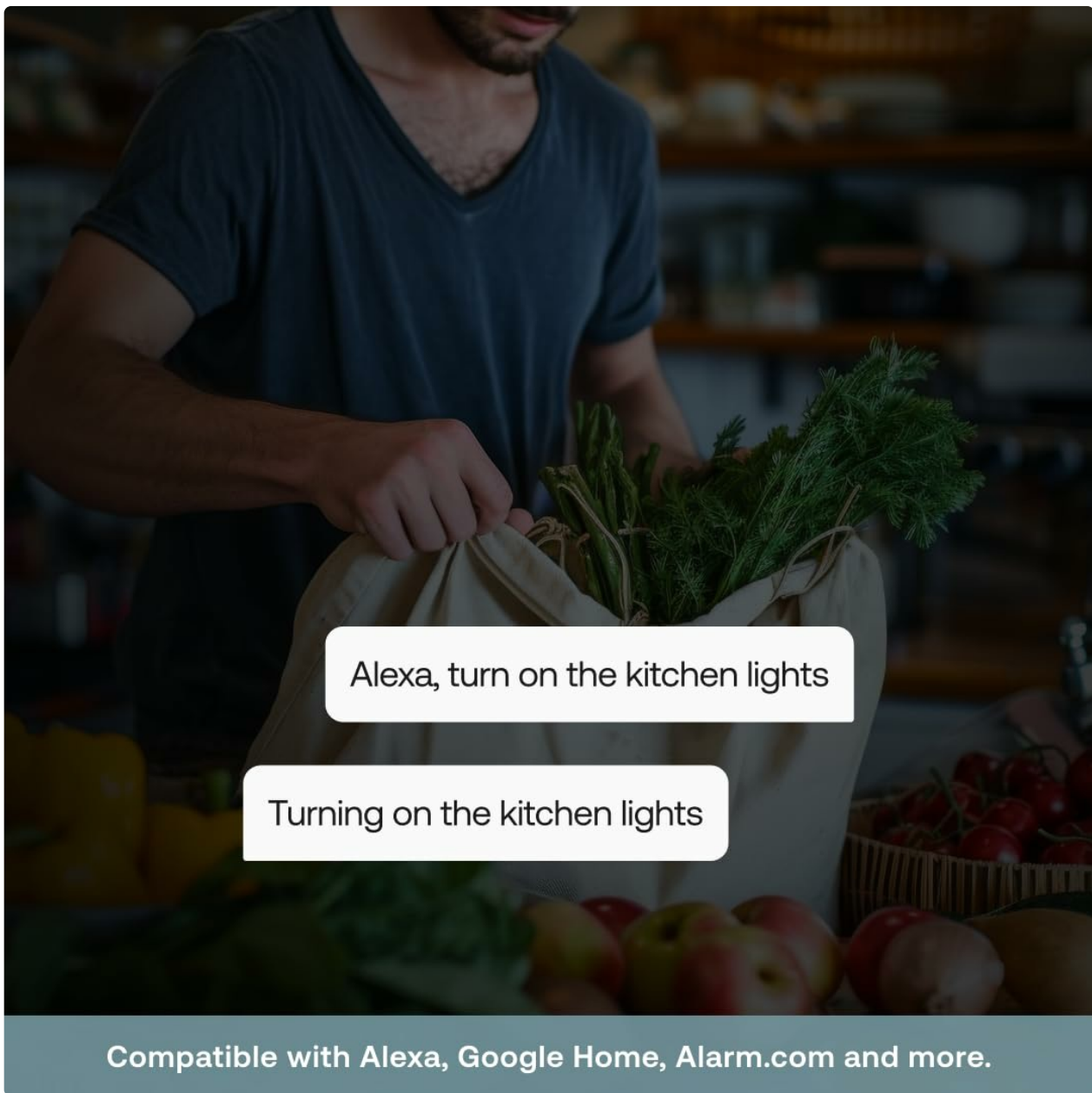

Image 7.1: A user adjusting multiple lights simultaneously using the Deako mobile application.

### 7.3 Voice Control

Once integrated with a voice assistant, use simple voice commands to control your lights:

- "Alexa, turn on the kitchen lights."
- "Hey Google, dim the living room to 50%."

## EFFORTLESS INSTALL



1. Power off



2. Remove the original



3. Plug-in



4. Enjoy

Image 7.2: Example of voice command interaction with a smart assistant to control lighting.

### 7.4 Beacon LED Light Bar

The Beacon LED light bar on your Deako Smart Switch offers two modes:

- **Locator Mode:** The light bar emits a soft glow when lights are off, helping you easily find the switch in the dark.
- **Indicator Mode:** The light bar indicates whether the connected lights are currently on or off.

You can customize the Beacon light bar settings through the Deako App.

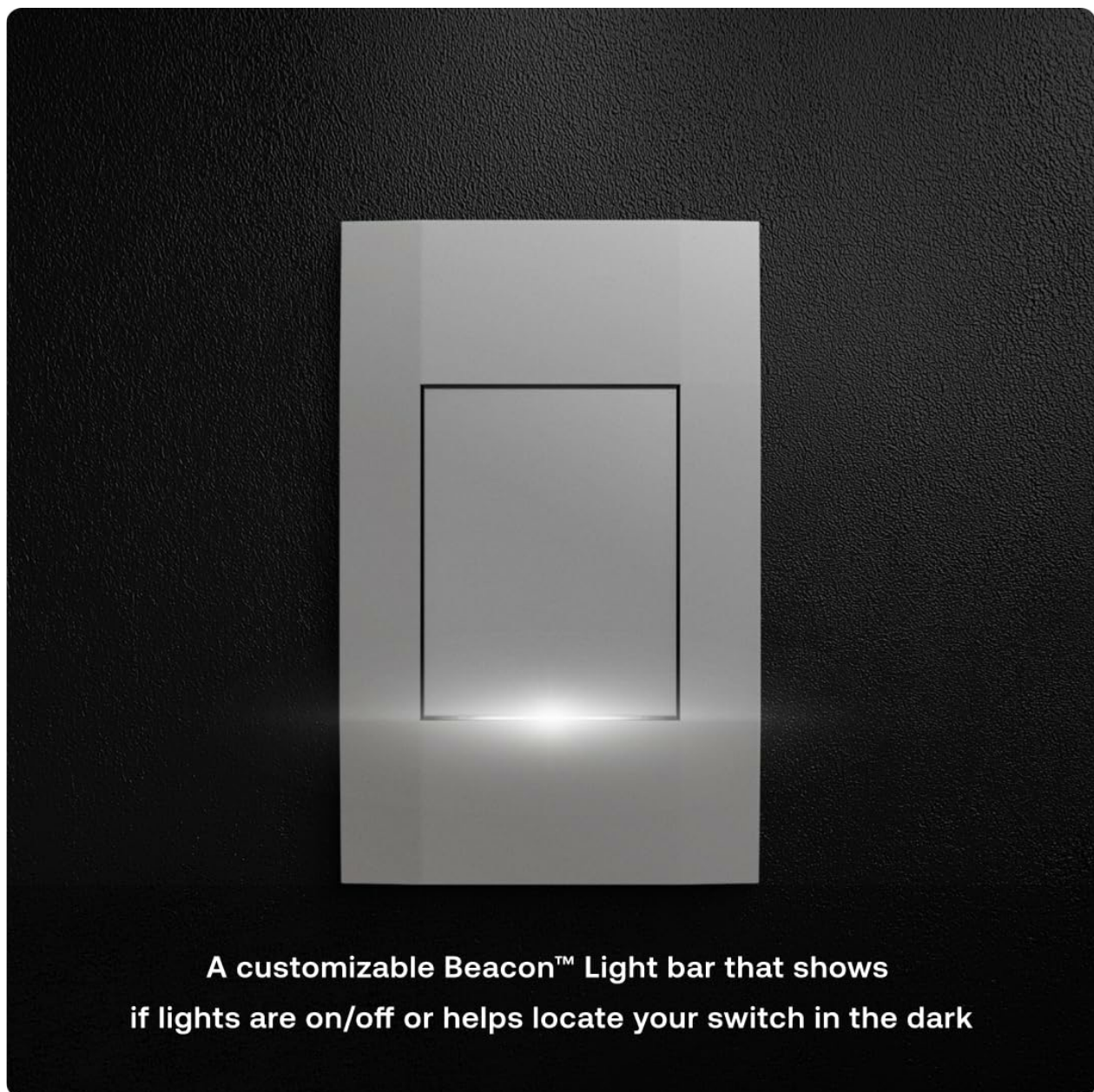

**A customizable Beacon™ Light bar that shows  
if lights are on/off or helps locate your switch in the dark**

Image 7.3: The Beacon LED light bar on the Deako Smart Switch, providing visual feedback or acting as a locator.

## 8. MAINTENANCE

The Deako Smart Light Switch requires minimal maintenance.

- **Cleaning:** Wipe the switch and faceplate with a soft, damp cloth. Avoid using harsh chemicals or abrasive cleaners.
- **Firmware Updates:** Deako may release firmware updates to improve performance or add new features. These updates are typically managed through the Deako App. Ensure your app is up-to-date and follow any prompts for firmware updates.

## 9. TROUBLESHOOTING

If you encounter issues with your Deako Smart Light Switch, try the following troubleshooting steps:

- **No Power/Light Not Responding:**
  - Check the circuit breaker to ensure power is on.
  - Verify the switch is fully seated in the Deako backplate.
  - Confirm a neutral wire is connected to the backplate.

- **Wi-Fi Connectivity Issues:**

- Ensure your Wi-Fi router is operating on the 2.4 GHz band.
- Move the switch closer to your Wi-Fi router if possible, or consider a Wi-Fi extender.
- Restart your Wi-Fi router.
- In the Deako App, try to re-add or reconnect the device.

- **App Control Not Working:**

- Check your phone's internet connection.
- Ensure the Deako App is updated to the latest version.
- Log out and log back into the Deako App.

- **Voice Control Not Responding:**

- Verify the Deako skill/service is enabled and linked in your voice assistant's app.
- Ensure the device name used in the voice command matches the name in the Deako App and voice assistant app.
- Check the internet connection of your voice assistant device.

- **Resetting the Switch:** If issues persist, you may need to perform a factory reset. Refer to the Deako support website for specific instructions on how to reset your Smart Switch, as this may vary.

For further assistance, visit the official Deako support website or contact their customer service.

## 10. WARRANTY AND SUPPORT

Deako products are covered by a manufacturer's warranty. For detailed warranty information, including terms, conditions, and how to make a claim, please refer to the official Deako website. Keep your proof of purchase for warranty purposes.

For technical support, frequently asked questions, and additional resources, please visit the Deako support page:

[www.deako.com/support](https://www.deako.com/support)

You can also find more information and contact details on the [Deako Amazon Store](#).