

[Manuals.plus](#) /

> [HOMCOM](#) /

> HOMCOM 68-inch Kitchen Pantry Cabinet with Charging Station - Model 83A-142V80WT

HOMCOM 83A-142V80WT

HOMCOM 68-inch Kitchen Pantry Cabinet with Charging Station

Model: 83A-142V80WT

1. INTRODUCTION AND PRODUCT OVERVIEW

This manual provides essential information for the safe assembly, operation, and maintenance of your HOMCOM 68-inch Kitchen Pantry Cabinet. This versatile storage solution is designed to enhance your kitchen or dining area with its functional features and elegant design.

Key features include a built-in charging station, dual tilt-out cabinets suitable for 10-gallon trash cans or laundry baskets, spacious drawers, adjustable shelving behind glass doors, and a generous countertop space.



Image 1.1: The HOMCOM 68-inch Kitchen Pantry Cabinet in a typical kitchen environment, showcasing its storage and countertop use.

Your browser does not support the video tag.

Video 1.1: An overview of the HOMCOM Kitchen Pantry Cabinet, demonstrating its features and functionality.

2. SAFETY INFORMATION

Please read and understand all safety warnings before assembly and use. Failure to follow these instructions may result in injury or product damage.

- **Anti-Tipping Device:** Always secure the cabinet to the wall using the provided anti-tipping hardware to prevent accidental tipping. This is crucial for safety, especially in households with children or pets.
- **Assembly:** Follow the assembly instructions carefully to ensure safe and proper installation. Do not skip steps or use unauthorized parts.
- **Placement:** Keep the cabinet away from direct heat sources, open flames, and excessive moisture.
- **Weight Capacity:** Do not overload the shelves or countertop. Refer to the 'Specifications' section for maximum weight capacities to prevent structural damage or collapse.
- **Charging Station:** Always unplug the charging station when not in use or during cleaning. Do not use the charging station with damaged cords or if it is wet. Ensure appliances connected do not exceed the rated power output.
- **Maintenance:** Regularly check all fasteners and connections to ensure they remain tight.



Image 2.1: Illustration of the anti-tipping design, showing how the cabinet should be secured to the wall for stability.

3. PACKAGE CONTENTS

Before beginning assembly, verify that all parts listed in the assembly guide (provided separately with the product) are present and undamaged. The package typically includes:

- Cabinet panels (particleboard and painted MDF)
- Glass doors
- Drawers and their components
- Handles (metal)
- Adjustable shelves
- Charging station unit (2 AC outlets, 2 USB ports)
- Anti-tipping hardware
- Assembly hardware (screws, dowels, cam locks, etc.)
- Assembly instruction manual

If any parts are missing or damaged, please contact customer support immediately.

4. SETUP AND ASSEMBLY

Assembly is required for this product. Please refer to the detailed assembly instructions included in your product packaging for step-by-step guidance. Ensure you have adequate space and the necessary tools (e.g., screwdriver, hammer) before starting.

Key Assembly Steps:

1. **Unpack and Identify Parts:** Lay out all components and hardware. Compare them against the parts list in the assembly manual.
2. **Assemble Base and Side Panels:** Follow the diagrams to connect the main structural elements.
3. **Install Drawers:** Assemble the drawer boxes and install the metal sliding rails.
4. **Attach Tilt-Out Cabinet Doors:** Secure the tilt-out mechanisms for the trash can cabinets.
5. **Install Upper Hutch:** Mount the upper cabinet section onto the base.
6. **Insert Adjustable Shelves:** Place the shelf pins at desired heights and insert the shelves.
7. **Install Glass Doors:** Attach the glass doors using the adjustable hinges. Adjust hinges as needed to ensure proper alignment and flush closure.
8. **Install Charging Station:** Integrate the charging station into its designated slot.
9. **Secure Anti-Tipping Device:** This is a critical safety step. Attach the anti-tipping hardware to the back of the cabinet and securely fasten it to a wall stud.



CHARGING STATION

Featuring 2 AC outlets and 2 USB ports to power kitchen appliances

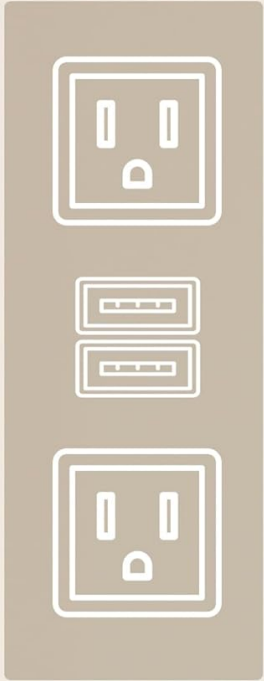

Image 4.1: Product dimensions for planning placement and assembly.



Image 4.2: Guide for adjusting cabinet door hinges to achieve proper alignment.

5. OPERATING INSTRUCTIONS

5.1. Using the Charging Station

The integrated charging station provides convenient power for your kitchen appliances. It features 2 AC outlets and 2 USB ports.

- **Connection:** Plug the cabinet's power cord into a standard wall outlet.
- **Appliance Use:** Connect your microwave, coffee maker, toaster, or other small kitchen appliances to the AC outlets. Use the USB ports to charge compatible devices.
- **Safety:** Do not exceed the maximum power rating of the charging station. Unplug when not in use.



LARGE STORAGE CAPACITY

Fits **10-gallon** Trash Cans
(NOT INCLUDED)

Say goodbye to unsightly trash cans and unpleasant odors with the outward tilting trash cabinets



Image 5.1: The built-in charging station, ready for use with kitchen appliances.

5.2. Utilizing Storage Areas

The cabinet offers diverse storage options:

- **Upper Cabinets:** Use the enclosed space with glass doors and adjustable shelves for dishes, pantry items, or decorative pieces. Adjust shelf height as needed by repositioning the shelf pins.
- **Open Shelves/Countertop:** Ideal for frequently used items, small appliances, or decor.
- **Drawers:** Two large drawers provide concealed storage for utensils, linens, or other kitchen essentials.
- **Tilt-Out Cabinets:** The dual tilt-out cabinets are designed to discreetly house 10-gallon trash cans or laundry baskets, keeping them out of sight.

ADJUSTABLE SHELVES



1.3" (3.2 cm)



Image 5.2: Demonstrating the large storage capacity, including the tilt-out cabinets for trash cans.

ADJUSTABLE HINGE

Adjust the hinges so that your door gaps can be flush

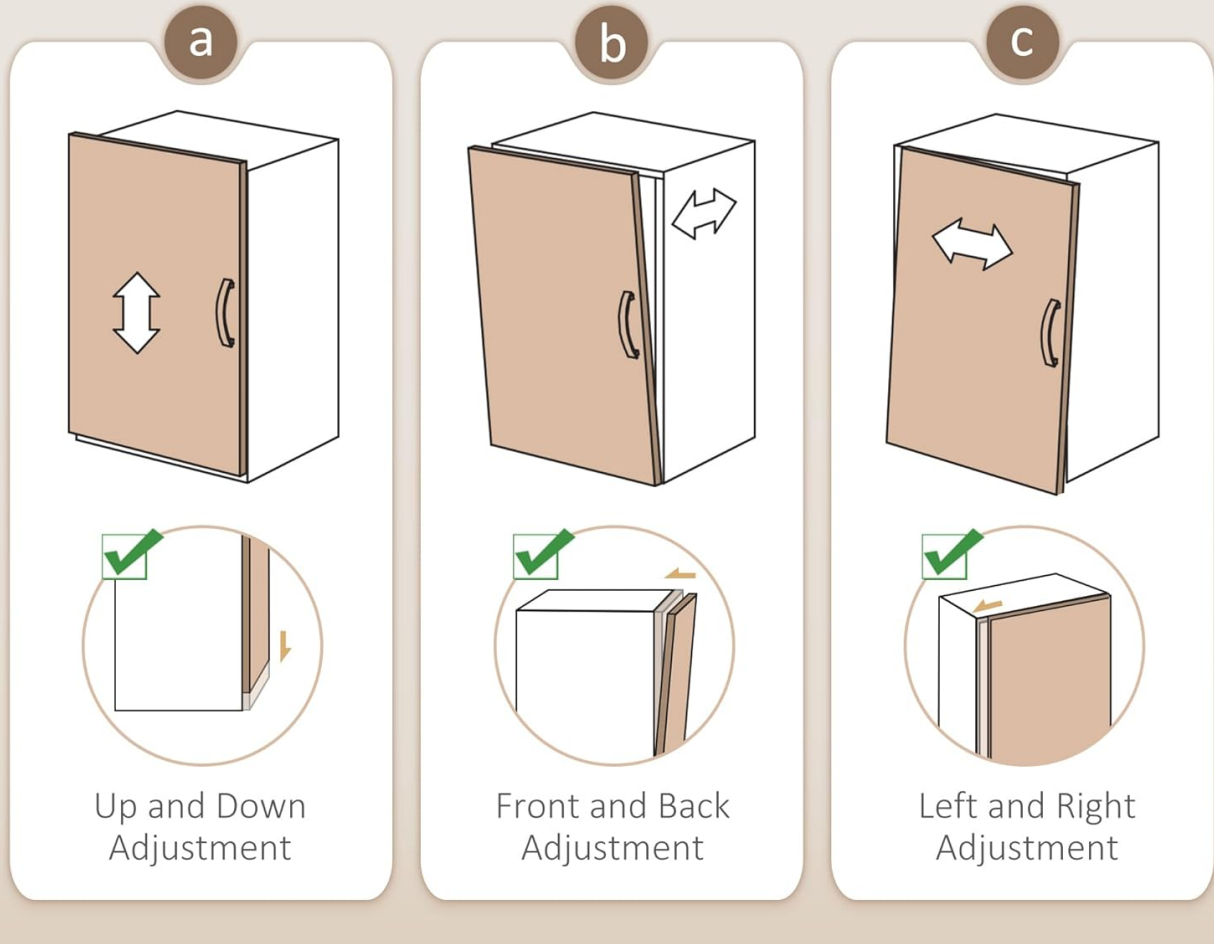
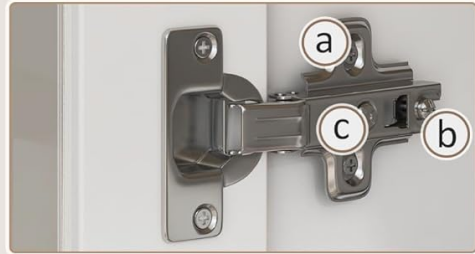

Image 5.3: Adjustable shelves allow for customized storage configurations.

6. MAINTENANCE

Regular maintenance will help prolong the life and appearance of your cabinet.

- **Cleaning:** Wipe surfaces with a soft, damp cloth. Avoid harsh chemicals or abrasive cleaners, which can damage the finish. For glass doors, use a standard glass cleaner.
- **Spills:** Clean up spills immediately to prevent staining or moisture damage to the engineered wood.
- **Hardware:** Periodically check all screws, bolts, and connections to ensure they are tight. Retighten if necessary.
- **Charging Station:** Keep the charging station free of dust and debris. Do not attempt to disassemble or repair the electrical components yourself.

7. TROUBLESHOOTING

If you encounter any issues with your cabinet, refer to the following common troubleshooting tips:

- **Wobbly Cabinet:** Ensure the cabinet is placed on a level surface. Check all assembly fasteners and

tighten them. Verify the anti-tipping device is securely installed to the wall.

- **Doors/Drawers Not Closing Properly:** Check for obstructions. For doors, adjust the hinges as shown in the assembly guide (Image 4.2). For drawers, ensure the sliding rails are correctly installed and free of debris.
- **Charging Station Not Working:** Ensure the cabinet's power cord is securely plugged into a functional wall outlet. Check if the appliance or device you are trying to power is working correctly when plugged directly into a wall outlet. Do not overload the charging station.
- **Missing Parts:** If you discover missing parts during assembly, do not proceed. Contact customer support for assistance.

8. SPECIFICATIONS

Feature	Detail
Brand	HOMCOM
Model Number	83A-142V80WT
Color	White
Material	Engineered Wood
Overall Dimensions (W x D x H)	39.4" x 13.8" x 67.7" (100 cm x 35 cm x 172 cm)
Max Weight Capacity	253 lbs (115 kg)
Number of Doors	2 (Glass Front)
Number of Drawers	2
Number of Shelves	4 (Adjustable)
Tilt-Out Cabinets	2 (Fits up to 10-gallon trash cans)
Charging Station	2 AC Outlets, 2 USB Ports
Additional Features	Anti-Tipping, Scratch Resistant, Stain Resistant
Assembly Required	Yes



Image 8.1: Design elements and construction details of the cabinet.

9. WARRANTY AND SUPPORT

For warranty information, please refer to the documentation included with your purchase or visit the official HOMCOM website. If you require technical support, have questions about assembly, or need to report missing/damaged parts, please contact HOMCOM customer service directly. Contact details can typically be found on the product packaging or the manufacturer's website.

Manufacturer: Aosom LLC