

UNITOPSCI UNITOPSCI Android Car Stereo for Honda Accord 9th Gen (2013-2017)

UNITOPSCI Android Car Stereo User Manual for Honda Accord 9th Gen (2013-2017)

Model: B0FCRR1TVJ

1. INTRODUCTION

This manual provides comprehensive instructions for the installation, operation, and maintenance of your UNITOPSCI 10.1-inch Android Car Stereo. This unit is specifically designed for Honda Accord 9th Generation 2.0L models manufactured between 2013 and 2017. Please read this manual thoroughly before using the product to ensure proper functionality and safety.



Figure 1.1: UNITOPSCI Android Car Stereo with backup camera, microphone, and smartphone mirroring icons.

2. SAFETY INFORMATION

- Do not operate the system in a way that distracts you from driving safely. Always prioritize road safety.
- Ensure all wiring is correctly connected to prevent short circuits or damage.

- Avoid exposing the unit to extreme temperatures, direct sunlight for prolonged periods, or excessive moisture.
- Professional installation is recommended to ensure correct wiring and functionality.
- Keep the volume at a level that allows you to hear external traffic sounds.

3. PRODUCT OVERVIEW

3.1 Key Features

- 10.1-inch Touchscreen Display (1024*600 resolution)
- Android Operating System (2GB RAM + 64GB ROM)
- Wireless/Wired Apple CarPlay and Android Auto
- Dual Mirror Link for Android/iOS phones
- Built-in GPS Navigation with offline map support (HERE WE GO preloaded)
- WiFi Connectivity
- Bluetooth with A2DP/Hands-Free/Phone Book functions
- FM/RDS Radio with 18 preset stations
- Backup Camera Input with automatic display switching
- Steering Wheel Control (SWC) support
- Split Screen Functionality
- Built-in Equalizer System
- Multiple UI Themes (26 options)

3.2 Package Contents

- UNITOPSCI Android Car Stereo Unit
- Wiring Harnesses
- GPS Antenna
- USB Cables (Double USB interface)
- External Microphone
- Backup Camera
- User Manual (this document)

4. SETUP AND INSTALLATION

4.1 Compatibility Check

This car stereo is compatible with Honda Accord 9th Generation 2.0L models from 2013 to 2017 (basic version). It is not compatible with high-end versions that include a large OEM screen or navigation system. Please verify your vehicle's center console and compare it with the provided installation frame images to ensure compatibility.

For Honda Accord 2.0L (left-hand drive) 2013-2017 Low - end version w/o OEM Navi Screen

NOTE: If you got OEM Radio with a Center Navi Screen, you need to contact us to buy extra Wiring Kits (pls let us know your specific vehicle model)



Figure 4.1: Dashboard compatibility for Honda Accord 9th Gen (2013-2017) 2.0L low-end version. Note: Not suitable for models with existing OEM Navi Screen.

4.2 Installation Steps

1. **Preparation:** Disconnect the vehicle's battery to prevent electrical damage.
2. **Remove OEM Unit:** Carefully remove the existing car radio and dashboard trim. Refer to your vehicle's service manual for specific instructions.
3. **Connect Wiring:** Connect the provided wiring harness to the car stereo and the vehicle's existing wiring. Ensure all connections are secure. Connect the GPS antenna, external microphone, and backup camera cables.
4. **Test Functionality:** Before fully reassembling the dashboard, temporarily connect the battery and power on the unit to test basic functions like power, audio, and display.
5. **Secure Unit:** Mount the new car stereo into the dashboard opening and secure it with screws.
6. **Reassemble:** Reinstall all dashboard trim pieces.
7. **Final Connection:** Reconnect the vehicle's battery.

Note: If your vehicle has an OEM Radio with a Center Navi Screen, additional wiring kits may be required. Contact customer support for assistance.

5. OPERATING INSTRUCTIONS

5.1 Power On/Off

The unit will typically power on automatically when the vehicle's ignition is turned on. To manually power off or restart, press and hold the power button on the unit or use the software controls.

5.2 Wireless CarPlay & Android Auto

This unit supports both wireless and wired Apple CarPlay and Android Auto. Connect your smartphone via Bluetooth/WiFi for wireless functionality or use a USB cable for a wired connection. Once connected, you can access phone calls, navigation, music, and other compatible apps directly from the stereo's touchscreen.

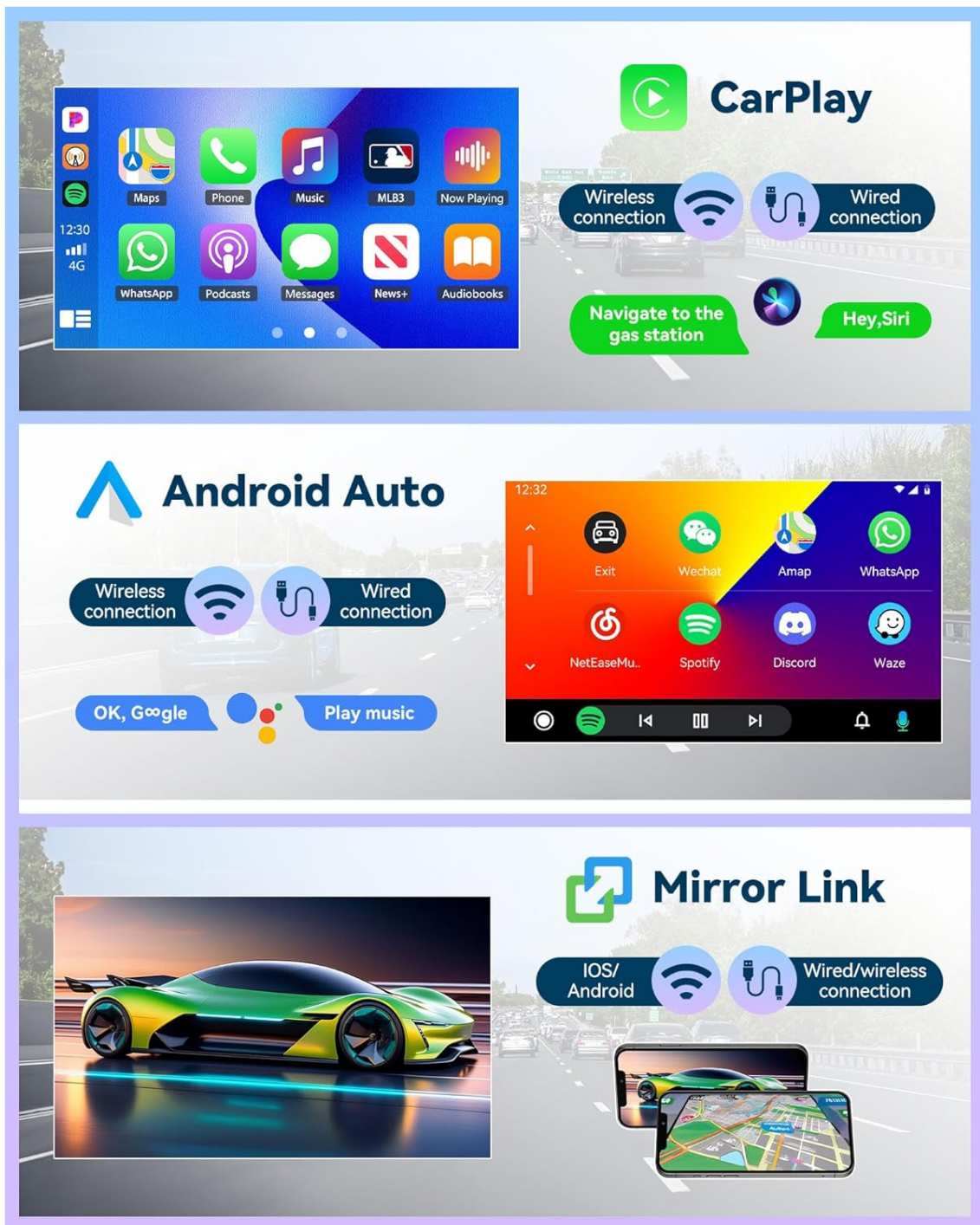

Figure 5.1: Wireless CarPlay, Android Auto, and Mirror Link interfaces.

5.3 GPS Navigation

The stereo has built-in GPS and supports both online and offline navigation. The HERE WE GO map application is preloaded. To use offline maps, download the necessary map data via a WiFi connection. For online navigation, ensure the unit is connected to WiFi or a mobile hotspot.

GPS Navigation

Built-in GPS for using online and offline maps directly.
(Tips: free offline map data needs to be downloaded from Here We Go)

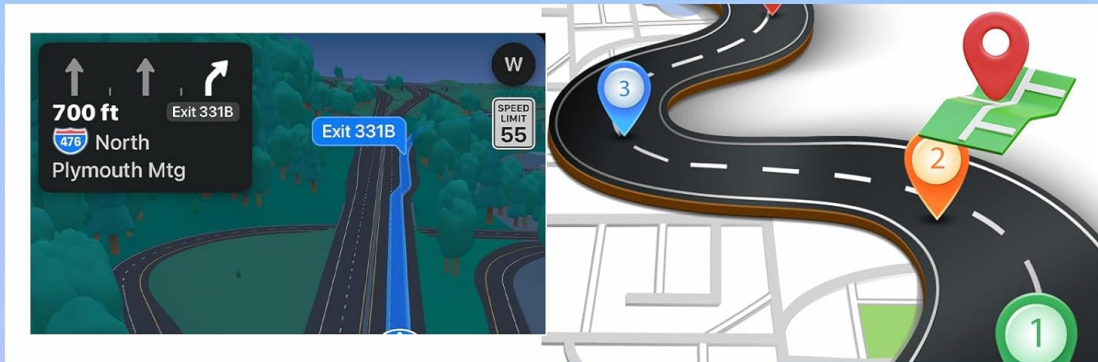

Support WiFi or Hotspot

After connecting to WiFi or Hotspot, you can use access to online function, install apps, watch videos and online map navigate

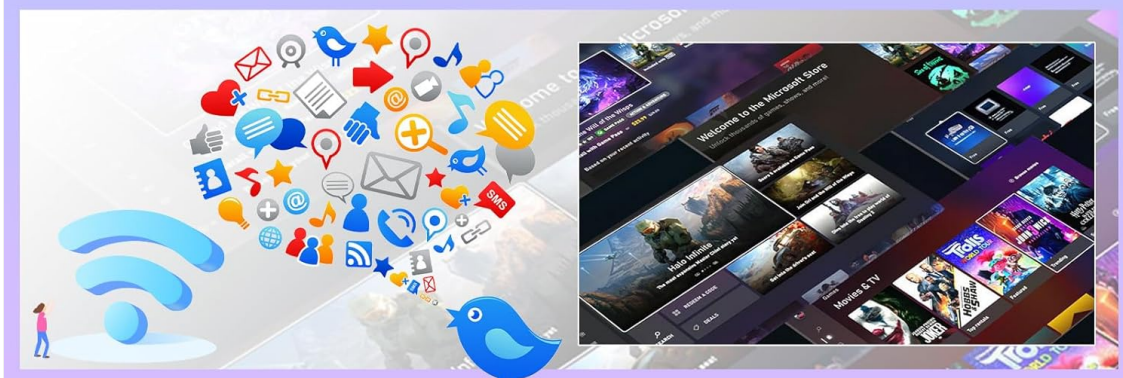

Figure 5.2: GPS Navigation interface and WiFi connection options.

5.4 Bluetooth & FM/RDS Radio

Bluetooth: Pair your smartphone via Bluetooth for hands-free calling, music streaming (A2DP), and automatic phone book download. This enhances safety by allowing you to manage calls without holding your phone.

FM/RDS Radio: Access FM radio stations with 18 preset options. The RDS (Radio Data System) feature displays station information where available. Use the tuner to find news, music, and sports broadcasts.

FM/RDS Radio

You can listen to radio, weather forecast, songs...



Bluetooth Hands-free

After connecting bluetooth, you can use bluetooth calls and bluetooth music, more convenient.

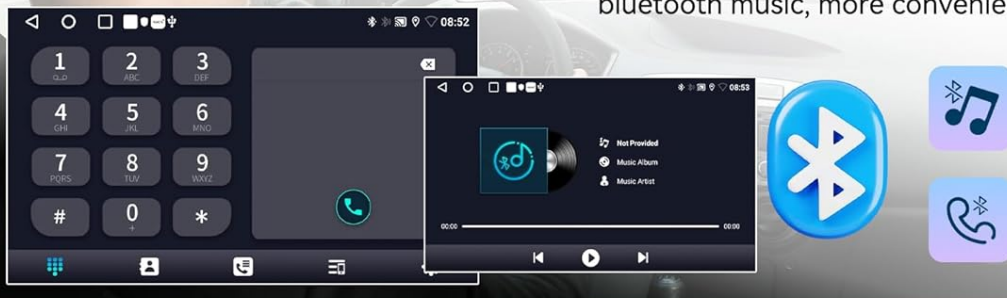

Built-in Equalizer System

Support EQ audio adjustment, and enjoy high-quality music anytime, anywhere



Figure 5.3: FM/RDS Radio, Bluetooth interface, and Equalizer settings.

5.5 Mirror Link

The Mirror Link function allows you to display your Android or iOS phone's screen directly onto the 10.1-inch head unit. This can be achieved via a wired or wireless connection, enabling you to view videos or maps from your phone on the larger screen.

5.6 Steering Wheel Control (SWC)

The unit supports your vehicle's existing steering wheel controls. This allows you to adjust volume, change tracks, answer calls, and switch modes without taking your hands off the steering wheel, improving driving safety and convenience. The system includes a learning function for SWC configuration.

5.7 Backup Camera Input

When the vehicle is shifted into reverse gear, the stereo automatically displays the view from the connected AHD backup camera on the 10.1-inch screen. This assists with safe parking and maneuvering.

Steering Wheel Control

Easily switch radio songs, calls, volume, you can be safer and convenient while driving!

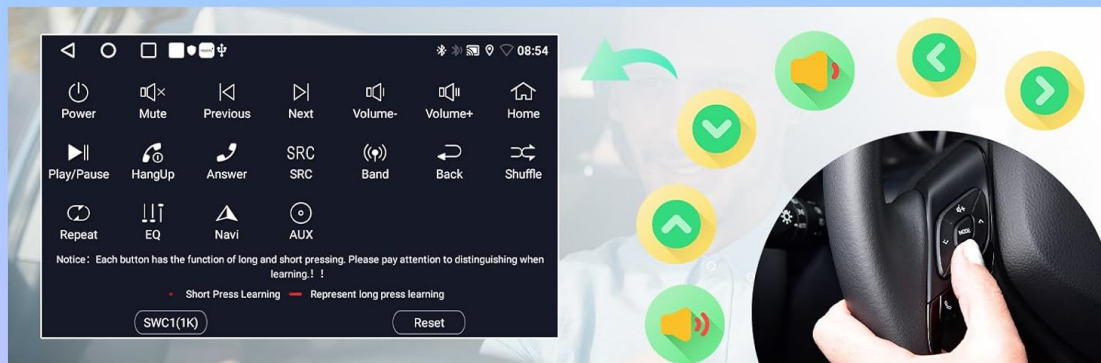

AHD Rear View Camera

AHD backup camera included, the radio will automatically switch to clear reversing image when you put the car in reverse gear.



Figure 5.4: Steering Wheel Control interface and backup camera view with guidelines.

5.8 Split Screen & UI Themes

Split Screen: The split-screen feature allows you to run two applications side-by-side on the display, for example, navigation on one side and music playback on the other.

UI Themes: The Android radio offers 26 different user interface themes. You can customize the look of your desktop by long-pressing the main interface and selecting your preferred theme.

2.5D HD Screen & Split Screen

High Temperature protection / Scratch-Resistant / Anti-Knock

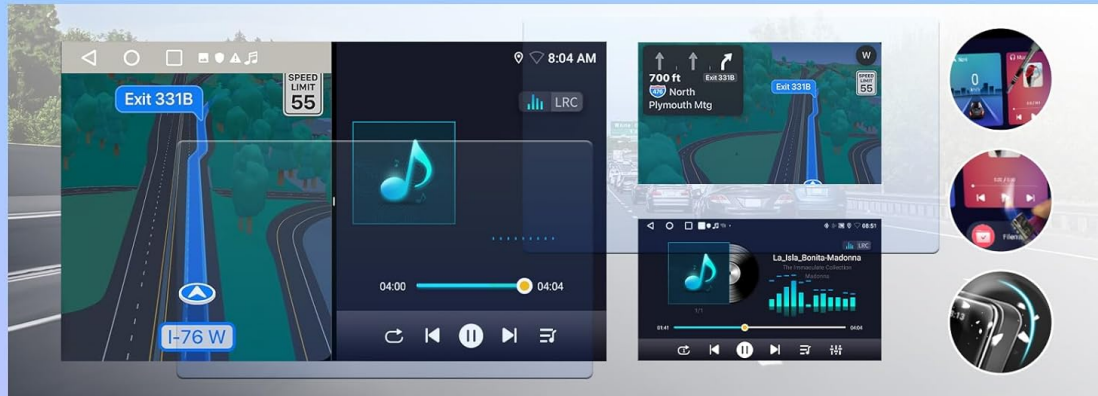

26UI Desktop Themes

Long press the main interface to switch 26UI themes.



Figure 5.5: Split screen view and examples of different UI desktop themes.

6. MAINTENANCE

- **Cleaning:** Use a soft, dry cloth to clean the screen and unit. Avoid abrasive cleaners or solvents.
- **Software Updates:** Periodically check for available software updates to ensure optimal performance and access to new features.
- **Temperature:** Do not leave the unit in direct sunlight for extended periods, especially in hot weather, as this can affect its lifespan.

7. TROUBLESHOOTING

Problem	Possible Cause	Solution
Unit does not power on	Incorrect wiring, blown fuse, vehicle battery issue	Check power connections, inspect vehicle fuses, ensure battery is charged.
No sound	Volume too low, incorrect audio settings, speaker wiring issue	Increase volume, check audio output settings, verify speaker connections.
GPS signal lost or inaccurate	GPS antenna obstructed or disconnected, poor satellite coverage	Ensure GPS antenna is properly installed and has a clear view of the sky. Check antenna connection.
Bluetooth connection issues	Device not paired, Bluetooth off on phone or stereo	Ensure Bluetooth is enabled on both devices. Re-pair the device.

Problem	Possible Cause	Solution
Touchscreen unresponsive	Temporary software glitch	Restart the unit. If issue persists, perform a factory reset (Factory setting keyword: 000000).

If you encounter issues not listed here or if troubleshooting steps do not resolve the problem, please contact UNITOPSCI customer support.

8. SPECIFICATIONS

Feature	Specification
System	Android
Chipset	8227L-DEMO
Screen Size	10.1 inches
Memory (RAM+ROM)	2GB RAM + 64GB ROM
Screen Resolution	1024*600
Radio Chip	MT6625
Power Output	4*45W
Work Temperature	-20°C to 75°C (-4°F to 167°F)
Power Amplifier Chip	TDA7388
Radio Band	FM/RDS
Video Output	Support
External Microphone	Support
Split Screen	Support
Maps	Built-in offline maps (requires internet to download data)
WIFI	Support
USB	Double USB interface
Audio Format Support	APE/FLAC/WAV/MP3/WMA etc.
Video Format Support	MKV/RMVB/AVI/MP4/MDV etc.
Picture Format Support	PNG/JPEG/JPG/GIF/WBMP/BNP etc.
Factory Setting Keyword	000000

Feature	Specification	
Languages	Chinese/English/French/Italian/Korean/Japanese/Arabic/Spanish/Portuguese/Russian/Turkish/Vietnamese/Hebrew/Polish	
Item Weight	3.08 pounds	
Package Dimensions	17.13 x 7.8 x 4.06 inches	

9. WARRANTY AND SUPPORT

Your UNITOPSCI Android Car Stereo comes with a 12-month warranty. Replacement is available within 24 months for qualifying issues. We offer lifetime after-sales consultation and technical support.

For any inquiries, technical assistance, or warranty claims, please contact us:



Email: UNITOPSCI@126.com



Figure 9.1: UNITOPSCI Customer Support Contact Information.

Related Documents - UNITOPSCI Android Car Stereo for Honda Accord 9th Gen (2013-2017)

	<p>MP5 Car Multimedia Player: Android Auto and CarPlay Function Manual</p> <p>A comprehensive manual for the MP5 car multimedia player, detailing the setup and usage of Android Auto and CarPlay functions. Learn how to connect your smartphone for enhanced in-car entertainment and navigation.</p>
	<p>UNITOPSCI 1 Din Car Stereo MP5 Player Instruction Manual</p> <p>Instruction manual for the UNITOPSCI 1 Din Car Stereo MP5 Player with FM Radio, Bluetooth, USB/Micro SD reader, and Rear View camera support. Includes installation, troubleshooting, and operation details.</p>
	<p>MP5 & FM Receiver 7.0 inch TFT LCD Instruction Manual</p> <p>Instruction manual for the MP5 & FM Receiver with a 7.0 inch TFT LCD, covering installation, precautions, wiring diagrams, specifications, features, and troubleshooting.</p>
	<p>Ford Focus 2012-2017 Android Car Stereo User Manual</p> <p>Comprehensive user manual for the Android 10.1 car stereo designed for Ford Focus models 2012-2017, covering installation, features, settings, and troubleshooting.</p>

	<p>Android Car Stereo Installation and Operation Guide for Honda Accord (2003-2007)</p> <p>Comprehensive guide for installing and operating an Android car stereo system designed for the Honda Accord 7th generation (2003-2007). Covers installation steps, wiring diagrams, safety precautions, basic functions, troubleshooting, and connecting CarPlay/Android Auto.</p>
	<p>Android Car Stereo for Ford Focus 2012-2018: Installation and User Guide</p> <p>Comprehensive guide for installing and operating an Android car stereo system in a Ford Focus (2012-2018). Covers wiring, setup, Carplay, Android Auto, and troubleshooting.</p>