



[Manuals.plus](#) /

> [Reyke](#) /

> Reyke Slim Wallet Tracker Card User Manual

Reyke Slim Wallet Tracker Card

Reyke Slim Wallet Tracker Card User Manual

Model: Slim Wallet Tracker Card

INTRODUCTION

Thank you for choosing the Reyke Slim Wallet Tracker Card. This device is designed to help you locate your valuable items such as wallets, bags, phones, and passports using the Google Find My App on compatible Android devices. This manual provides detailed instructions for setup, operation, maintenance, and troubleshooting to ensure optimal performance and longevity of your tracker card.

PRODUCT OVERVIEW

The Reyke Slim Wallet Tracker Card is an ultra-thin, rechargeable, and waterproof tracking device. It integrates seamlessly with the Google Find My App for Android users, offering precise location tracking and a loud alarm function.

Key Features:

- **Ultra-Slim Design:** At just 1.6mm thick, it fits discreetly into any wallet or card holder.
- **Google Find My App Integration:** Compatible with Android 9+ devices for quick item location.
- **Loud Alarm:** Emits a sound up to 100 dB within a 50-meter Bluetooth range.
- **Lost Mode:** Track the last known location and enable anonymous contact for finders.
- **Multi-User Sharing:** Share tracking access with up to 4 individuals.
- **Long Battery Life & Wireless Charging:** Up to 5 months on a single charge, rechargeable via wireless charging.
- **IP68 Waterproof & Dust Resistant:** Durable for outdoor use and protection against elements.
- **Privacy Protection:** Encrypted and anonymized location data with no subscription fees.

Android Ultra-thin Tracker Card

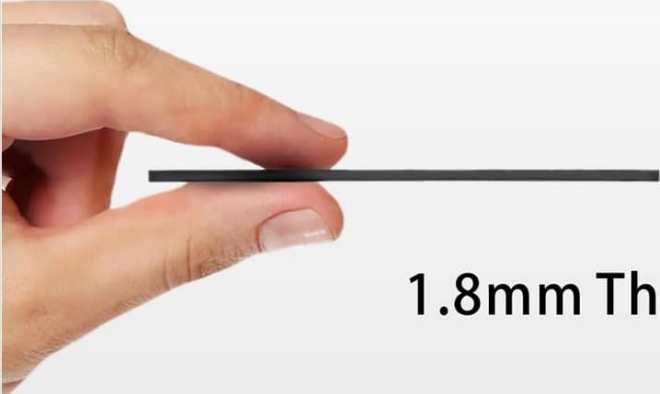

1.8mm Th



90–100dB
Loud Sound



IP68
Waterproof



Up to 160ft/50m
Bluetooth Range



Wireless
Charging



Image: The Reyke Slim Wallet Tracker Card showcasing its ultra-thin profile and key specifications like sound level, waterproofing, Bluetooth range, and wireless charging capability.

SETUP

1. Charging the Tracker Card

Before initial use, ensure your Reyke Slim Wallet Tracker Card is fully charged. The device supports wireless charging.

1. Place the tracker card on a compatible wireless charging pad.
2. A red LED light will indicate that the card is charging.
3. The LED light will turn blue when the battery is fully charged. A full charge can last up to 5 months.

Wireless Charge

Can last up to 5 months on a single charge.



Rechargeable & Reusable

No need for repeated purchases,
more cost-effective.

Image: The Reyke Slim Wallet Tracker Card undergoing wireless charging, showing the red charging indicator.

2. Pairing with Google Find My App (Android Only)

The Reyke Slim Wallet Tracker Card is designed to work exclusively with the Google Find My App on Android devices (Android 9+ required). It is not compatible with iOS devices.

1. Ensure your Android device has Bluetooth enabled and is running Android 9 or a newer version.
2. Download and install the Google Find My Device app from the Google Play Store if you don't already have it.
3. Open the Google Find My Device app and follow the on-screen instructions to add a new device.
4. Press and hold the power button on the Reyke Tracker Card until it enters pairing mode (refer to the card's LED indicator for specific pairing signals, usually a blinking light).
5. Select the "Smart Card" or similar name when it appears in the app's device list to complete the pairing process.

OPERATING INSTRUCTIONS

1. Locating Your Items with Sound

When your item is within Bluetooth range (up to 50 meters), you can use the app to make the tracker card emit a loud sound.

1. Open the Google Find My Device app on your Android smartphone.
2. Select your "Smart Card" from the list of devices.
3. Tap the "Play Sound" option. The tracker card will emit a sound up to 100 dB, guiding you to its location.
4. Tap "Stop Sound" once you have located your item.



Image: The Google Find My Device app interface demonstrating the "Locate with Sound" feature, showing the tracker card playing an alert sound.

2. Activating Lost Mode

If your item is lost or out of Bluetooth range, you can activate Lost Mode to leverage the Google Find My network.

1. In the Google Find My Device app, select your "Smart Card".
2. Choose the "Mark as lost" or "Lost Mode" option.
3. The app will display the last known location of your tracker card.

4. You can also enter contact information that will be displayed to anyone who finds your item and scans the tracker, allowing them to contact you anonymously.

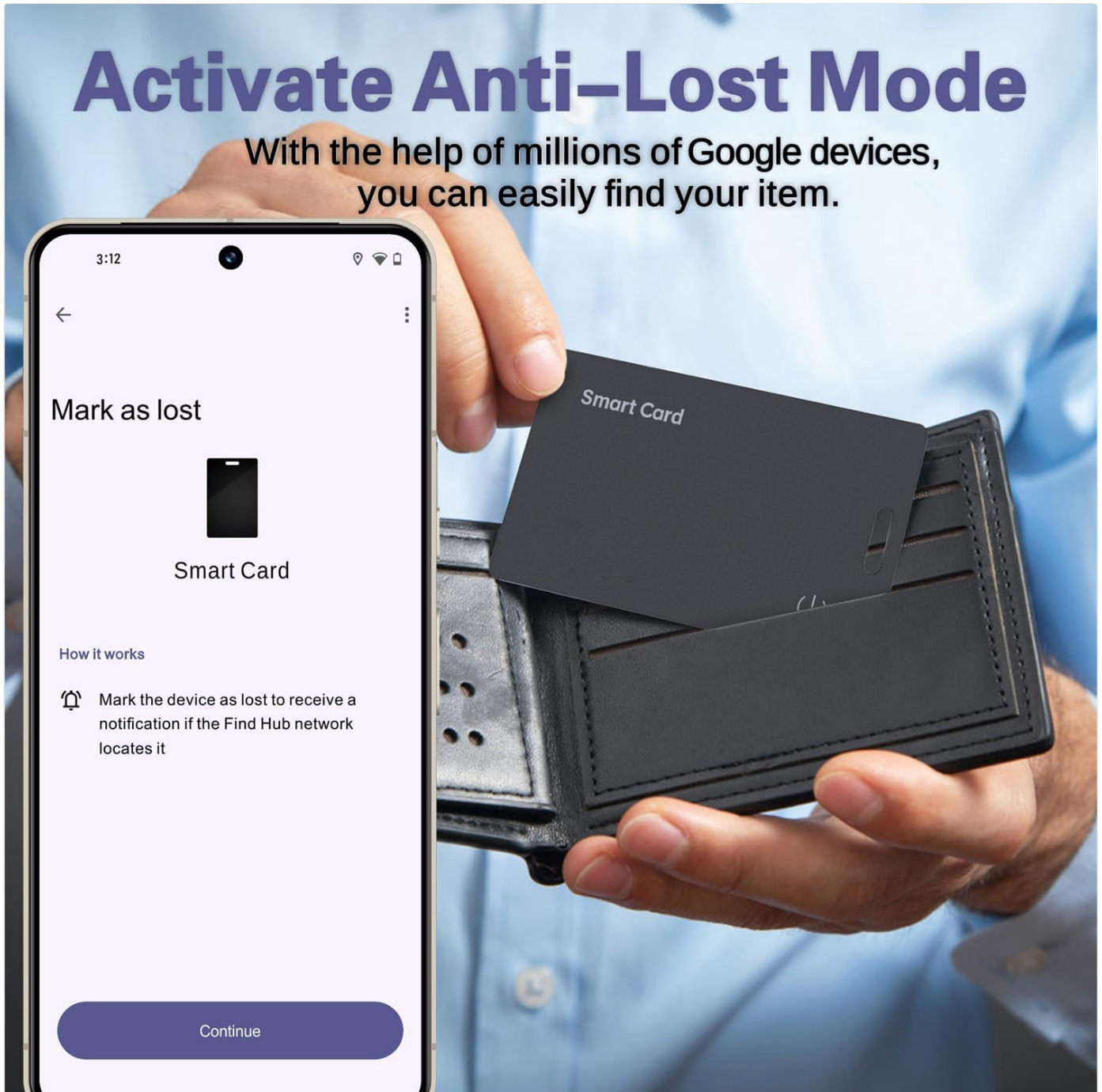

Image: The "Activate Anti-Lost Mode" screen on a smartphone, showing how to mark the tracker card as lost within the Google Find My Device app.

3. Sharing Your Tracker Card

You can share access to your Reyke Slim Wallet Tracker Card with up to 4 other individuals, making it ideal for shared items like office keys or family luggage.

1. In the Google Find My Device app, select your "Smart Card".
2. Look for a "Share device" or similar option.
3. Follow the prompts to generate a sharing link or invite other Google accounts.
4. The invited users will then be able to view the tracker's location.

Share the Card location with family/friends



Image: The "Share the Card location" feature demonstrated across two smartphones, illustrating how to share tracking access with family or friends.

MAINTENANCE

Charging

To maintain optimal performance, regularly charge your Reyke Slim Wallet Tracker Card. The card supports wireless charging and a single charge can last up to 5 months. Monitor the battery level through the Google Find My Device app.

Cleaning

Wipe the tracker card with a soft, dry, or slightly damp cloth. Avoid using harsh chemicals or abrasive materials, as these may damage the device's surface or internal components.

TROUBLESHOOTING

- Tracker not connecting to app:

- Ensure Bluetooth is enabled on your Android device.
 - Verify your Android device is running Android 9 or higher.
 - Make sure the tracker card is charged.
 - Restart your Android device and try pairing again.
 - Ensure the tracker card is within Bluetooth range of your device.
- **Sound alarm not working:**
 - Check if the tracker card is within Bluetooth range of your Android device.
 - Ensure the tracker card has sufficient battery.
 - Verify that the volume on your Android device is not muted or too low.
- **Inaccurate location:**
 - Location accuracy depends on the Google Find My network. Ensure your Android device has a stable internet connection and location services enabled.
 - For precise location, ensure the tracker is within Bluetooth range of your device.
- **Battery draining quickly:**
 - Ensure the card is fully charged using a compatible wireless charger.
 - Frequent use of the sound alarm or constant searching can consume more battery.

SPECIFICATIONS

Brand	Reyke
Model	Slim Wallet Tracker Card
Dimensions	Approximately 1.6mm - 1.8mm thickness
Material	Plastic
Battery Type	1 Lithium Ion (included)
Battery Life	Up to 5 months on a single charge
Charging	Wireless Charging
Water Resistance	IP68 (Waterproof and Dust Resistant)
Bluetooth Range	Up to 50 meters (160 feet)
Alarm Volume	Up to 100 dB
Compatibility	Android Smartphones (Android 9+ required). Not compatible with iOS.

WARRANTY AND SUPPORT

For warranty information and customer support, please refer to the documentation included with your purchase or visit the official Reyke website. Keep your proof of purchase for warranty claims.

For further assistance, please contact Reyke customer service.



