

Reyke K2

Reyke Wallet Tracker Android Card User Manual

Model: K2

INTRODUCTION

The Reyke Wallet Tracker Android Card is a compact, rechargeable device designed to help you locate your valuables using the Google Find My Device network. Its ultra-thin profile allows it to fit seamlessly into wallets, bags, or attached to keys, providing peace of mind for your essential items. This manual provides detailed instructions for setup, operation, maintenance, and troubleshooting to ensure optimal performance of your device.

SETUP

Initial Charging

Before first use, ensure your Reyke Wallet Tracker is fully charged. The device supports wireless charging. Place the card on a compatible wireless charging pad with the side containing the power icon facing downwards. A red LED indicator will illuminate during charging and turn off when fully charged. A full charge can last up to 5 months.



Image Description: This image illustrates the correct and incorrect ways to place the Reyke Wallet Tracker on a wireless charging pad. The correct method shows the card with its power icon facing down on the charger, indicated by a green checkmark and a red

charging light. Incorrect methods show the card face up or with the wrong side down, marked with red crosses.

Pairing with Google Find My Device

The Reyke Wallet Tracker is designed to work exclusively with Android devices running Android 9 or above, utilizing the Google Find My Device network. It is not compatible with iOS or Huawei devices.

1. Step 1: Power On

Press the power button on the Reyke Wallet Tracker once to turn it on and enter pairing mode.

2. Step 2: Connect via App

Open the Google Find My Device app on your Android phone. A connection page for the 'Smart Card' should automatically pop up. Tap 'Connect'.

3. Step 3: Open App

Once prompted, click 'Open app' to finalize the connection within the Google Find My Device application.

4. Step 4: Connection Complete

The connection is now complete, and your Reyke Wallet Tracker is ready for use. You can rename the device within the app if desired.

Charging Tips

When charging, please make sure that the side with the icon is facing downward.



Image Description: This image displays a four-step visual guide for connecting the Reyke Wallet Tracker to an Android phone via the Google Find My Device app. Each step shows a phone screen with corresponding instructions for pressing the power button, connecting, opening the app, and confirming the connection.

OPERATING INSTRUCTIONS

Locating with Sound

When your Reyke Wallet Tracker is within Bluetooth range (up to 180 ft or 50 meters), you can use the Google Find My Device app to make the card emit a sound. This feature is useful for locating items nearby, such as a wallet misplaced within your home.

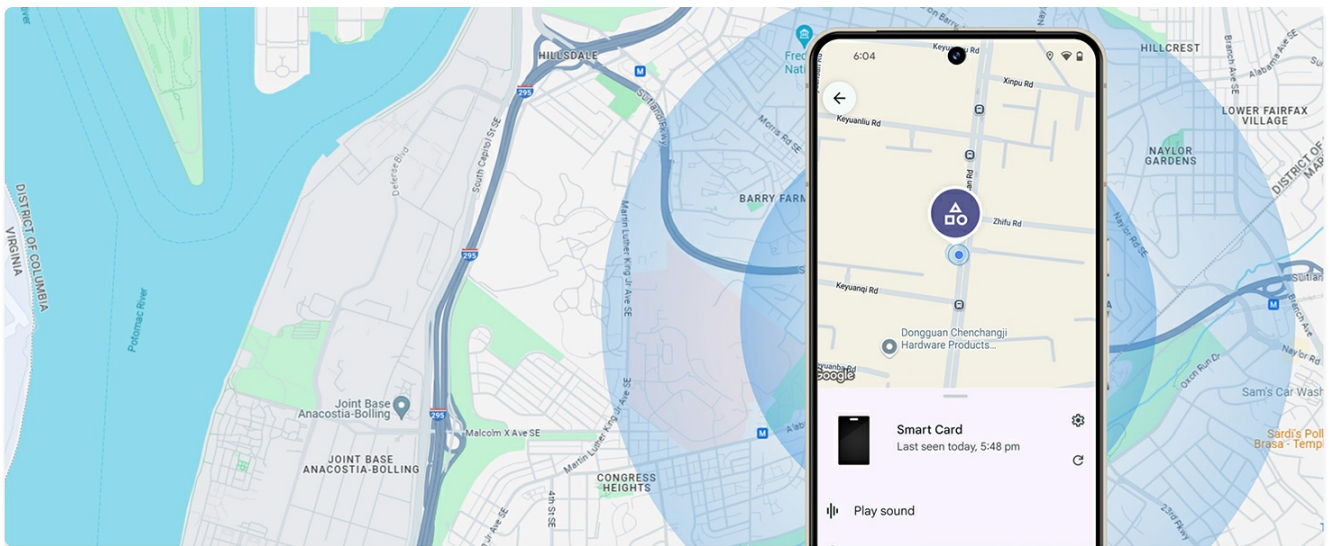

Image Description: This image demonstrates the 'Locate with Sound' feature. A phone screen shows the 'Play sound' option within the Find My Device app, with a visual representation of sound waves emanating from a wallet containing the tracker card, indicating its location.

Global Tracking (Google Find My Network)

If your Reyke Wallet Tracker is out of Bluetooth range, its location will be updated on the map within the Google Find My Device app via the extensive Google network. Millions of Android devices anonymously detect the tracker's signal and report its location, allowing you to see its last known position on a map.

Global Tracking



Image Description: This image depicts the global tracking functionality, showing the Reyke Wallet Tracker and a smartphone overlaid on a world map, with location pins indicating its use for tracking various items like wallets, bags, and keys.

Lost Mode

If your item is lost, you can activate 'Lost Mode' in the Google Find My Device app. This will leverage the Google network to help locate your tracker. You will receive alerts when your tracker is detected by other Android devices. No subscription is required for this feature.

Activate Anti-Lost Mode

With the help of millions of Google devices, you can easily find your item.

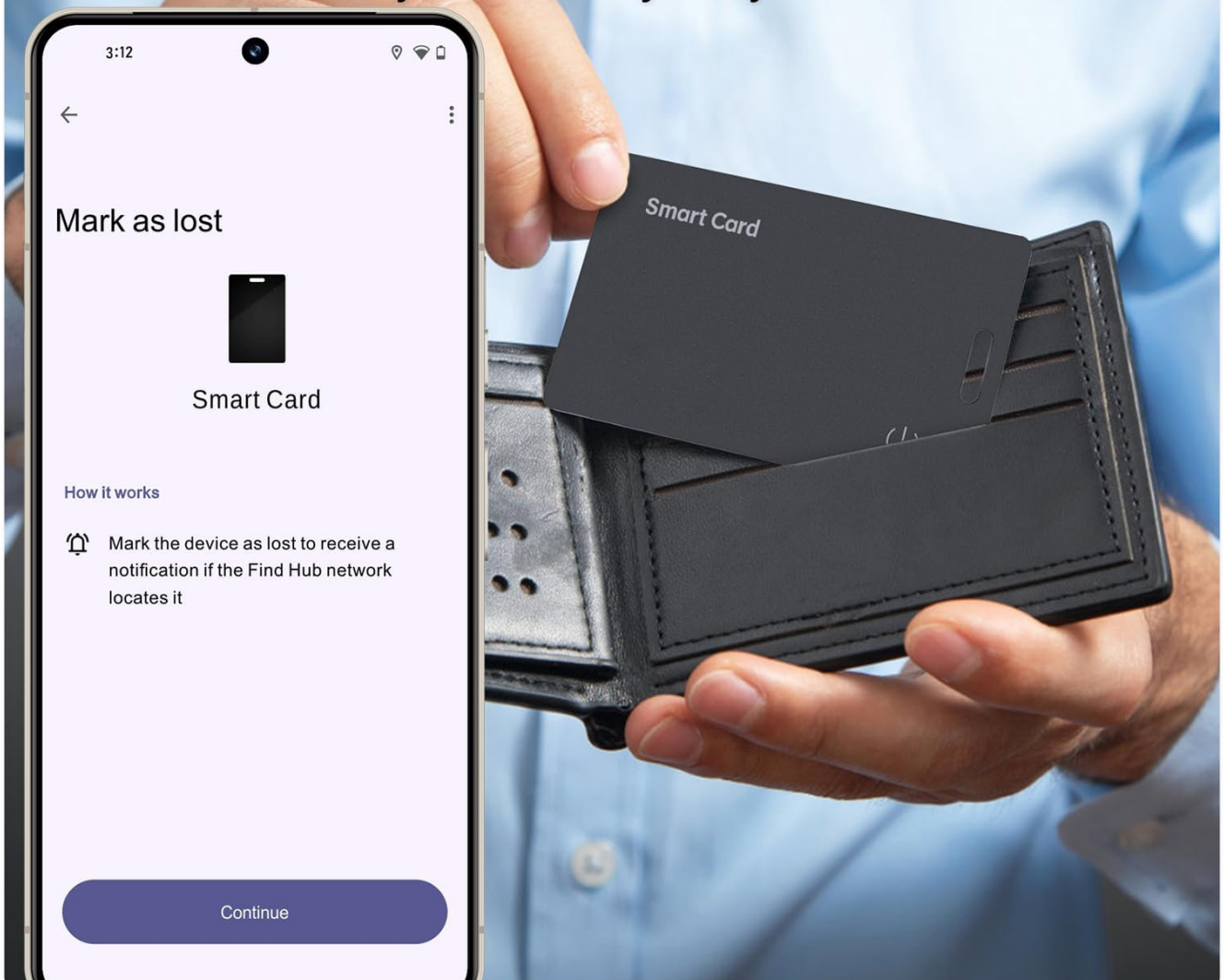

Image Description: This image shows a smartphone screen displaying the 'Mark as lost' option within the Find My Device app, with the Reyke Wallet Tracker being placed into a wallet, illustrating the use case for activating lost mode.

Sharing Device Location

The Reyke Wallet Tracker allows you to share its location with up to 4 other individuals through the Google Find My Device app. This is beneficial for shared items like family wallets, communal bags, or office keys.

Share the Card location with family/friends



Image Description: This image illustrates the device sharing feature, showing two smartphones and the Reyke Wallet Tracker, with a dotted line connecting them, symbolizing the sharing of the tracker's location between users.

Versatile Applications

The ultra-thin design of the Reyke Wallet Tracker allows it to be used in various scenarios for tracking different items:

- **Wallet:** Fits easily into any wallet slot.
- **Keys:** Can be attached to a keychain or placed in a key holder.
- **Luggage:** Ideal for placing inside suitcases or travel bags.
- **Backpack:** Can be slipped into a backpack pocket.
- **Laptop Bag:** Provides tracking for your laptop and accessories.
- **Camera Bag:** Helps keep track of valuable camera equipment.
- **ID Card Holder:** Can be used to track important identification.

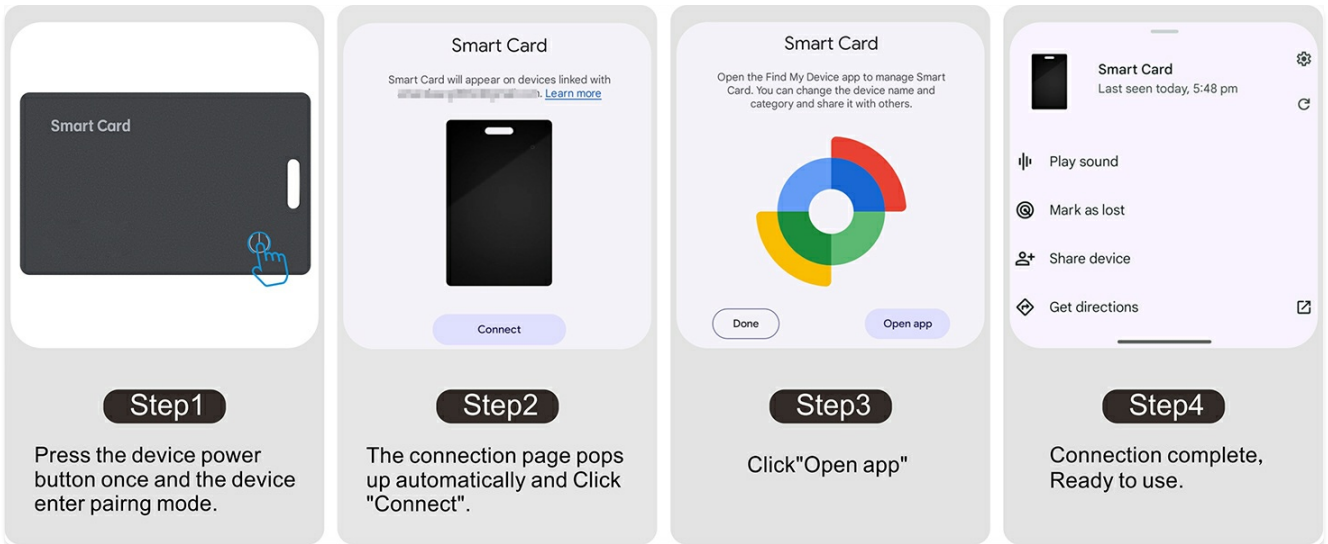

Image Description: This collage displays six different scenarios where the Reyke Wallet Tracker can be used: inside a camera bag, as an ID card, in a wallet, in a laptop bag, in a backpack, and in luggage, highlighting its versatility.

MAINTENANCE

Charging

Recharge the device when the battery level is low. The Reyke Wallet Tracker uses wireless charging technology. Place it on a Qi-compatible wireless charger. The LED indicator will show charging status. Avoid over-discharging the battery for optimal lifespan.

Cleaning and Care

The Reyke Wallet Tracker is IP68 rated, meaning it is resistant to dust and water. You can wipe it clean with a soft, damp cloth. Do not use harsh chemicals or abrasive materials. Ensure the device is dry before charging.



Image Description: This image features two Reyke Wallet Tracker cards with water splashing around them, visually representing the device's IP68 waterproof and dustproof rating.

TROUBLESHOOTING

Problem	Possible Cause	Solution

Problem	Possible Cause	Solution
Device not connecting to phone.	Bluetooth is off; device battery is low; device not in pairing mode; incompatible phone OS.	Ensure Bluetooth is enabled on your phone. Charge the device. Press the power button to enter pairing mode. Verify your Android phone is running Android 9 or above.
Cannot hear the sound from the tracker.	Device is out of Bluetooth range; sound is muffled by surroundings.	Move closer to the device. Remove the device from enclosed spaces (e.g., deep inside a bag or wallet) to improve sound audibility.
Location not updating on map.	Device is out of range of the Google Find My network; device battery is dead.	Ensure the device is charged. The Google Find My network relies on other Android devices being nearby to update location; updates may take time in less populated areas.
Device not charging wirelessly.	Incorrect placement on charger; charger not powered; charger incompatible.	Ensure the card is placed with the power icon facing downwards on the center of the wireless charger. Verify the wireless charger is powered on and compatible with Qi standard.

SPECIFICATIONS

- **Model:** K2
- **Dimensions:** 3.35 x 2.13 x 0.06 inches (8.5 x 5.4 x 0.15 cm)
- **Weight:** 1.06 ounces (30 grams)
- **Material:** Plastic
- **Battery:** 1 Lithium Ion battery (included), rechargeable
- **Battery Life:** Up to 5 months on a single charge
- **Charging:** Wireless (Qi-compatible)
- **Bluetooth Range:** Up to 180 ft (50 meters)
- **Sound Level:** 90-100dB
- **Waterproof Rating:** IP68
- **Compatibility:** Android 9 and above (not compatible with iOS or Huawei)

Android Ultra-thin Tracker Card

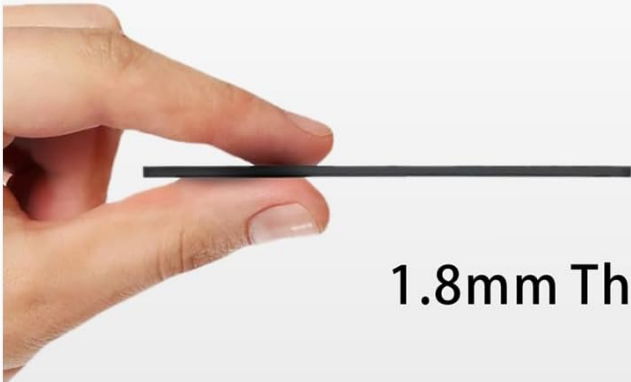

1.8mm Th



Image Description: This image highlights the Reyke Wallet Tracker's ultra-thin profile (1.8mm) and lists its key specifications: 90-100dB loud sound, IP68 waterproof rating, up to 160ft/50m Bluetooth range, and wireless charging capability.

SAFETY INFORMATION

- Do not attempt to disassemble, repair, or modify the device.
- Keep the device away from extreme temperatures, direct sunlight, and open flames.
- Avoid dropping or subjecting the device to severe impacts.
- Dispose of the device and its battery responsibly according to local regulations.

WARRANTY AND SUPPORT

For warranty information and technical support, please refer to the product packaging or contact Reyke customer service through the retailer where the product was purchased. Keep your proof of purchase for warranty claims.

