



[Manuals.plus](#) /

› [ATOTONA](#) /

› ATOTONA Drive Chat AI Smart Car Stereo User Manual

## ATOTONA A6G110PF-S01

# ATOTONA Drive Chat AI Smart Car Stereo User Manual

Model: A6G110PF-S01

## INTRODUCTION

The ATOTONA Drive Chat AI Smart Car Stereo (Model A6G110PF-S01) is an advanced in-car entertainment and navigation system designed to enhance your driving experience. Featuring a 10.1-inch QLED display with flexible adjustment, it integrates wireless CarPlay and Android Auto, a powerful DSP with 36-band EQ for superior audio, dual Bluetooth connectivity, and AI-powered voice commands. This manual provides essential information for installation, operation, and maintenance of your new car stereo.



Image: The ATOTONA Drive Chat AI Smart Car Stereo unit with its 10.1-inch display and an included rear view camera. The screen shows a user interface with various app icons.

## PACKAGE CONTENTS

Verify that all items listed below are present in your package:

- Smart Car Stereo Unit
- Rear View Camera (AC-HD01LR-A)
- 20-Pin Wire Harness
- 2-in-1 USB Cable (for external storage & phone link)
- 2-in-1 Antenna (WiFi/GPS)
- Mounting Brackets
- Mounting Screws
- DIN Pocket
- DIN Sleeve 1
- DIN Sleeve 2
- External Microphone

- RCA Cable
- Online Resources Quick Guide
- Product Care Online Support Information

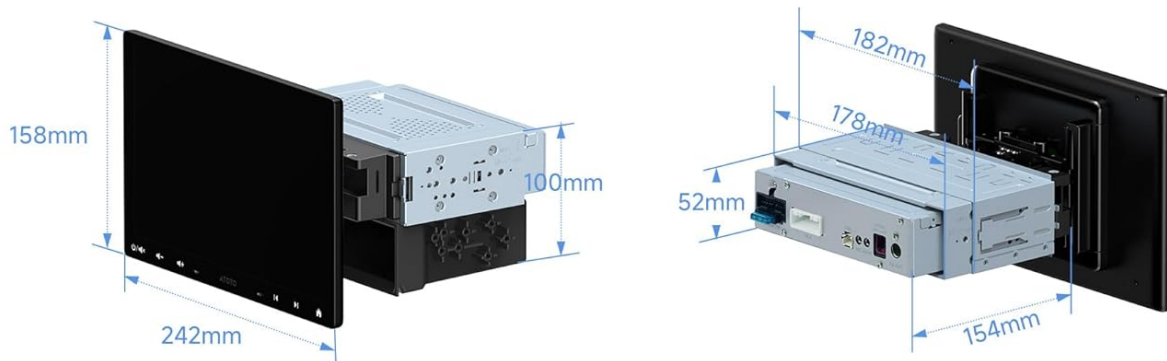

**Note:** Dimensions may vary slightly ( $\pm 1\text{mm}$ ) due to manual measurement.

## Package Contents



Car Stereo



AC-HD01LR-A  
Rearview Camera



20-Pin Wire Harness



2-in-1 USB Cable  
(External Storage & Phone Link)



2-in-1 Antenna  
(WiFi/GPS)



Mounting Brackets



Mounting Screws



DIN Pocket



DIN Sleeve 1



DIN Sleeve 2



External Microphone



RCA Cable



Online Resources  
Quick Guide



Product Care  
Online Support

Image: A visual representation of all components included in the product package, such as the car stereo, rearview camera, various cables, mounting hardware, and documentation.

## INSTALLATION

### Physical Installation and Dimensions

Before installation, ensure the unit's size and adjustment range are compatible with your vehicle's dashboard to avoid blocking vents or controls. A vehicle-specific harness or dash kit may be required and is not included.

# 10.1" Display, Adjustable Angles, Tailor Your View

9-Way Adjustable

FlexView Pro Design

QLED 1280x800 QLED Display



Image: This diagram details the FlexView Pro structure, showing the 10.1-inch QLED screen's 9-way adjustability, including 27mm vertical, 24mm horizontal, 18mm front, 30° swivel, and 10° tilt adjustments. These adjustments are primarily for installation and should be secured afterward.

## Navigate Up Front, Cartoons in the Back

Happy Kids, Focused Drive

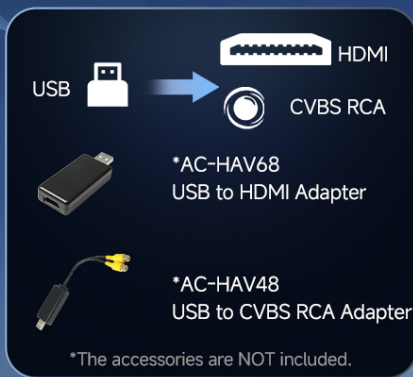

Image: An installation reminder graphic showing the maximum left/right slide (24mm), up/down slide (27mm), and forward/backward slide (18mm) of the display, along with overall unit dimensions (242mm width, 158mm height) and the reachable gap for controls.

### Wiring Diagram

Refer to the following diagram for proper wiring connections. Ensure all connections are secure before powering on the unit.

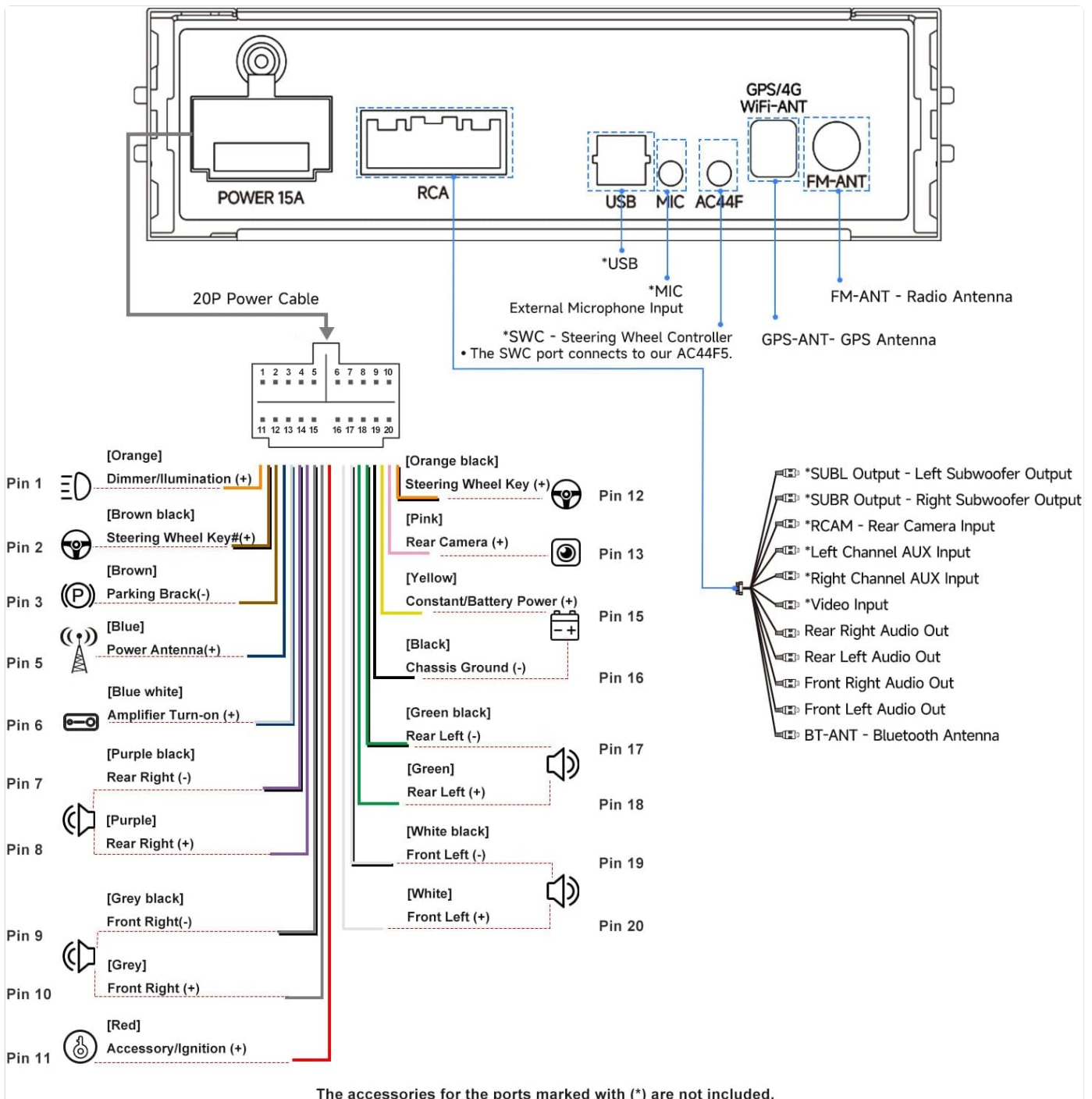

Image: A comprehensive wiring diagram illustrating the 20-pin power cable connections, RCA outputs, USB, microphone input, and antenna connections (GPS/4G WiFi and FM). It details connections for dimmer, steering wheel key, parking brake, power antenna, amplifier turn-on, speaker outputs, subwoofer outputs, video input, and auxiliary inputs.

## OPERATING INSTRUCTIONS

### Display and User Interface

The 10.1-inch 1280x800 QLED screen provides a clear and vibrant display. The unit runs on Android OS, offering a customizable theme and access to various applications.

# Open Your Drive to Endless Possibilities

Android OS, AI Insights, And More



Android OS



3-Way Internet Access  
(WiFi hotspot, BT, USB)



ChatGPT AI



Firmware Updates



Advanced Audio



Customizable Theme



Bluetooth Screen Lock



BLE Connectivity

## Why Three Ways to Connect?

### Conventional



WiFi Hotspot



Bluetooth Tethering



CarPlay Android Auto



No Internet Access

### Ours



WiFi Hotspot



Bluetooth Tethering



USB Tethering



CarPlay Android Auto

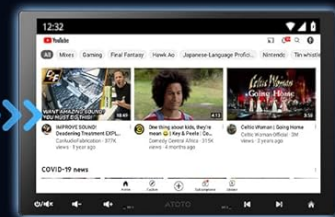

Use USB Tethering During Wireless CP/AA – Keeps Apps Online

Image: This graphic highlights the core features of the system, including Android OS, 3-way internet access (WiFi hotspot, Bluetooth, USB), ChatGPT AI integration, firmware updates, advanced audio settings, customizable themes, and BLE connectivity.

## Smart Assistant and AI Features

DriveChat AI enables voice commands and in-car chat, powered by ChatGPT for smarter responses. The system also supports various intelligent driving modes.

- **Road View Mode:** Provides live road alerts.
- **Cabin View Mode:** Designed for backseat awareness.
- **OBD Monitor Mode:** Allows for car health checks when connected to an OBD2 scanner.

# DriveChat GenAI Assistant



Powered by ChatGPT | Smarter responses. Simpler driving



## Beyond Voice Commands

Smarter agents are on the road ahead



### Road View Mode

Live Road Alerts



### Cabin View Mode

For Backseat Awareness



### OBD Monitor Mode

Car Health Check

More features to come...

Image: This image showcases the DriveChat GenAI Assistant, demonstrating its ability to provide smart responses and integrate with various chatbots. It also illustrates Road View Mode, Cabin View Mode, and OBD Monitor Mode.

## Connectivity: CarPlay, Android Auto, MirrorLink & Bluetooth

Enjoy seamless integration with your smartphone through wireless CarPlay and Android Auto. MirrorLink expands app options, and dual Bluetooth modules provide versatile connections.

- **Wireless CarPlay/Android Auto:** Connect via Bluetooth for quick access to maps, calls, and music.
- **MirrorLink:** Allows mirroring of your phone's screen to the stereo.
- **Dual Bluetooth (BT1 & BT2):**
  - **BT1:** Supports hands-free calls, music streaming, and Bluetooth-based auto screen lock for privacy.
  - **BT2 (with BLE):** Connects to OBD2 scanners, LED signs, ambient lights, and other compatible devices, allowing direct control from the stereo screen.

# Dual Bluetooth, Smarter Connections

Stay Connected: Chat, Stream, and Control — All at Once

## BT1 Screen Auto Lock/Unlock

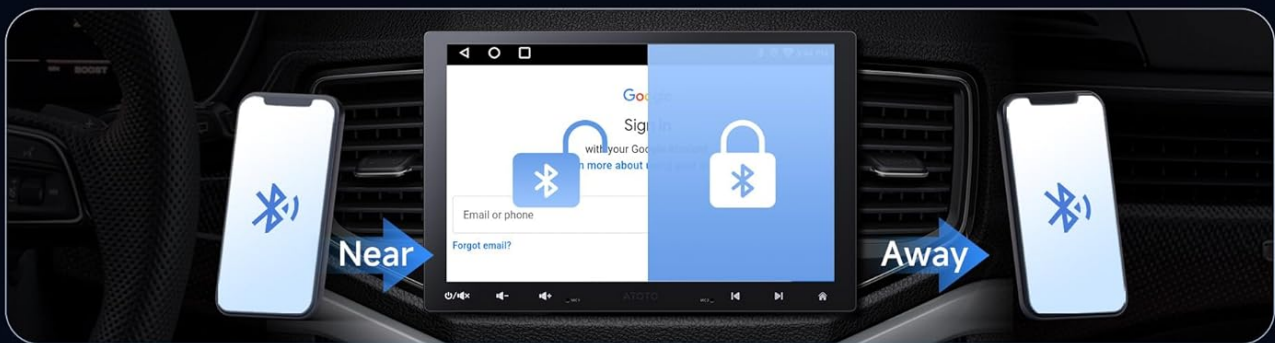

Calls



Music



Internet

## BT2 Connection



OBD Scanner



AI Interactive LED Sign



Ambient Light

More...

Image: This graphic illustrates the dual Bluetooth capabilities. BT1 supports screen auto lock/unlock based on proximity, hands-free calls, music, and internet. BT2 enables connections to OBD scanners, AI interactive LED signs, and ambient lights. For internet access, the unit supports Wi-Fi Hotspot, Bluetooth Tethering, and USB Tethering.

## Audio Features

The integrated Digital Signal Processor (DSP) and 36-band Equalizer (EQ) allow for precise audio customization. Features include:

- **36-band EQ:** Shape audio to fit your space and style with 8 presets.
- **Time Alignment:** Ensures sound reaches you at the optimal time for a balanced listening experience.
- **SCVC (Speed Compensated Volume Control):** Automatically adjusts volume to reduce road noise as you speed up.
- **Built-in Amplifier:** Delivers clear highs, deep lows, and strong output.

# Turn Up Your Vibes Feel the Sound of Your Drive



Image: This visual highlights the audio capabilities, showing the 36-band EQ interface, Time Alignment for centered sound, SCVC (Speed Compensated Volume Control) that boosts volume at 40mph, and the built-in amplifier for dynamic sound.

## Rear View Camera and GPS Tracking

The included AHD 720P RearView Camera (AC-HD01LR-A) provides enhanced visibility. The system also features integrated GPS tracking.

- **Live Rear View (LRV):** Access real-time rear view via the RCAM app, even while driving forward.
- **RearView Guideline:** Assists with parking and maneuvering.
- **Night Vision:** Improved visibility in low-light conditions.
- **TrackHU GPS Tracking:** Tracks vehicle location and routes with flexible refresh rates (2min), accurate positioning (GPS, GLONASS, Galileo, Beidou), instant geofence alerts, and track playback with speed control.

# AHD 720P RearView Camera



**AC-HD01LR-A**  
(Included)

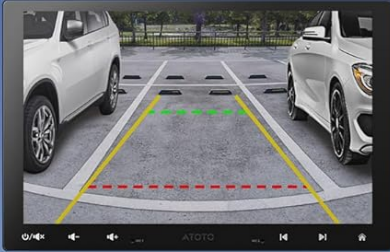

**RearView Guideline**



**Live Rear View (LRV)**

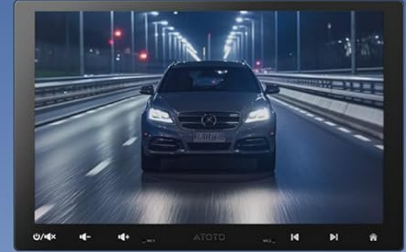

**Night Vision**



## TrackHU

Track Your Vehicle

No Extra GPS Tracker Needed



**Flexible Refresh Rate**  
(2min)



**Accurate Positioning**  
(GPS, GLONASS, Galileo, Beidou)



**Instant Alerts**  
for Geofence



**Track Playback**  
with Speed Control



## FindApps

APK Downloader

Access featured apps  
that you might not find on G00gle Play.



Can't find the app you need? Let us know — we're working to broaden the selection in FindApps.

Image: This graphic displays the AHD 720P RearView Camera (AC-HD01LR-A) and its functionalities: RearView Guideline, Live Rear View (LRV), and Night Vision. It also details the TrackHU Smart GPS Tracking features and the FindApps APK Downloader for accessing additional applications.

## App Management

The FindApps APK Downloader allows access to featured apps that may not be available on Google Play, expanding your entertainment and utility options.

## Control Methods

The stereo can be controlled via touchscreen, app, or voice commands through DriveChat AI. It also supports steering wheel controls (requires adapter, not included) and an optional wireless remote (AC-44F5, not included).

## MAINTENANCE

To ensure the longevity and optimal performance of your ATOTONA Smart Car Stereo, follow these general maintenance guidelines:

- **Cleaning:** Use a soft, dry cloth to clean the display and unit. Avoid abrasive cleaners or solvents.
- **Software Updates:** Regularly check for and install firmware updates to ensure the system runs efficiently and has the latest features. Refer to the online manual for update procedures.
- **Environmental Conditions:** Avoid exposing the unit to extreme temperatures, direct sunlight for prolonged periods, or excessive moisture.
- **Cable Connections:** Periodically check all wiring connections to ensure they remain secure and free from damage.

## TROUBLESHOOTING

This section addresses common issues you might encounter. For more detailed troubleshooting or issues not listed here, please refer to the online manual or contact customer support.

Problem	Possible Cause	Solution
Unit does not power on.	Loose power connection, blown fuse, incorrect wiring.	Check power cables and fuse. Verify wiring against the diagram.
No sound from speakers.	Speaker wires disconnected, volume too low, incorrect audio settings.	Ensure speaker wires are connected. Increase volume. Check DSP/EQ settings.
Wireless CarPlay/Android Auto not connecting.	Bluetooth not enabled, phone not paired, software glitch.	Ensure Bluetooth is on for both devices. Re-pair the phone. Restart the stereo and phone.
Rear view camera not displaying.	Camera cable loose, incorrect camera input selected, camera malfunction.	Check camera connections. Ensure the RCAM app is active or correct input is selected.

## SPECIFICATIONS

Feature	Detail
Model Number	A6G110PF-S01
Display Size	10.1 Inches
Display Resolution	1280x800 QLED
Operating System	Android OS
Connectivity Technology	Bluetooth (Dual), Wi-Fi, USB
Compatible Devices	Smartphone (Wireless CarPlay & Android Auto, MirrorLink)
Audio Output Mode	Stereo
Special Features	Touchscreen, DriveChat AI, TrackHU GPS Tracking, DSP, 36-Band EQ, FlexView Pro Structure, Live Rear View
Item Weight	8.05 pounds
Package Dimensions	11.65 x 9.65 x 8.46 inches
Manufacturer	Shenzhen Yufengzhixing Electronics Tech Co Ltd
Date First Available	June 8, 2025

## WARRANTY AND SUPPORT

---

Your ATOTONA Smart Car Stereo comes with a **12-month product care warranty** from the date of purchase. You can receive an additional 6 months of product care by contacting ATOTONA customer support.

For any inquiries, technical assistance, or warranty claims, please contact our customer care team. They respond around the clock during workdays.

Please refer to the online manual for the most up-to-date information and detailed support resources.