

**Manuals+**

[Q & A](#) | [Deep Search](#) | [Upload](#)

manuals.plus /

› [BENTSAI](#) /

› [BENTSAI BT-HH6105B2 Handheld Inkjet Printer User Manual](#)

**BENTSAI BT-HH6105B2**

# BENTSAI BT-HH6105B2 Handheld Inkjet Printer User Manual

Model: BT-HH6105B2

## 1. PRODUCT OVERVIEW

---

The BENTSAI BT-HH6105B2 is a versatile handheld inkjet printer designed for efficient and high-quality printing on a wide range of surfaces. It is ideal for coding dates, batch numbers, QR codes, logos, and text.



Image: The BENTSAI BT-HH6105B2 handheld inkjet printer shown with two BB22B black ink cartridges. The printer features a color touchscreen display.

This printer offers a maximum print height of 1/2 inch (12.7mm) and supports 600 DPI high-resolution printing. Its quick-drying ink ensures clear and durable prints on various materials.

## 2. SAFETY INFORMATION

- Always keep the printer and ink cartridges out of reach of children.
- Do not expose the printer to extreme temperatures, direct sunlight, or high humidity.
- Avoid direct contact with ink. If contact occurs, wash thoroughly with soap and water.
- Use only genuine BENTSAI ink cartridges to ensure optimal performance and prevent damage.
- Do not attempt to disassemble or repair the printer yourself. Refer to qualified service personnel.
- Ensure the power adapter is compatible with your local voltage and always unplug the printer before cleaning or maintenance.

## 3. PACKAGE CONTENTS

---

Upon opening the package, verify that all the following items are included:

- 1 x BENTSAI BT-HH6105B2 Portable Handheld Mobile Inkjet Printer
- 2 x Original BENTSAI BB22B Black Ink Cartridges
- 1 x Power Adapter
- 1 x USB Flash Disk
- 1 x Photoelectric Sensor
- 1 x Metal Positioner Template
- 1 x Roller Guide (for stable and smooth printing)
- 1 x User Manual (this document)

## **4. SETUP**

---

### **4.1 Ink Cartridge Installation**

Follow these steps to properly install the ink cartridge into your BENTSAI printer:

# Wide Range of Formats

Printed Content: text, date and time, QR codes, barcodes, pictures and variable codes.  
Printed content can be customized

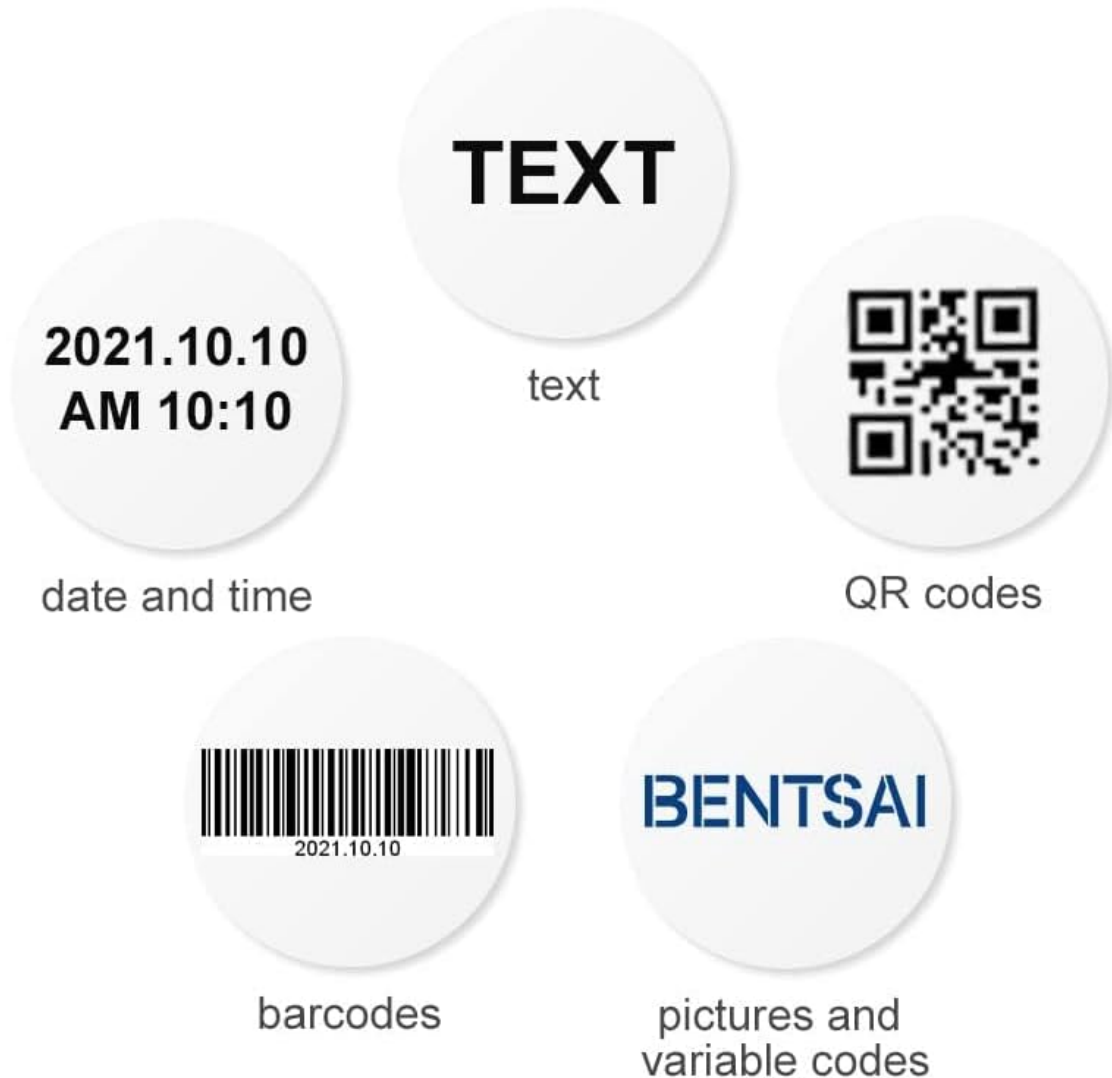

Image: Visual guide demonstrating the four steps for ink cartridge installation.

1. **Step 1:** Press the ink cartridge release button to open the ink cartridge holding area.
2. **Step 2:** Carefully remove the protective plastic cover from the ink cartridge nozzle.
3. **Step 3:** Insert the ink cartridge into the designated slot, ensuring it is seated firmly.
4. **Step 4:** Firmly close the ink cartridge cover until it clicks into place.

After installation, the printer is ready for operation. Ensure the power adapter is connected for initial setup and charging.

## 5. OPERATION

### 5.1 Screen Interface

The BENTSAI BT-HH6105B2 features a 4.3-inch HD touch screen for easy operation and navigation. The

interface provides access to various functions including editing, management, settings, and maintenance.

## 4.3" Large HD Screen Interface

Touch Screen Operation, High Sensitivity,  
Easy and Convenient











 450g (Palm-size and Lightweight)	 4.3" (HD Touch Screen)	 8 hours (Long Battery Life)	 0.5in/12.5mm (Print height)
 600 DPI (High Resolution)	 Plugged In Ink Cartridges	 2 Ways (Off wires Operation/ Production Lines)	 Endless (Printing Possibilities)

Image: Detailed view of the printer's 4.3-inch HD touchscreen, showing icons for Edit, Management, Setting, Maintenance, U-Disk, and Device Info.

### 5.2 Printing on Various Surfaces

This handheld inkjet printer is designed to print on a wide array of materials, both porous and non-porous. This includes, but is not limited to:

# Print on Thousands of Materials

Apply on almost 95% of the common materials



Image: Illustration showing the printer's capability to print on diverse materials such as cardboard boxes, wood, glass, fabric, cutlery, aluminum foil, PVC, and aluminum.

- Cardboard
- Wood
- Fabric
- Cement
- Plastic
- Metal
- Aluminum
- Glass
- Leather
- Ceramic

The printer handles both flat and curved surfaces effectively.

## 5.3 Content Formats

The printer supports various content formats, allowing for flexible coding and marking applications:

# Easy Installation:



Image: Visual representation of supported print formats including plain text, date and time (e.g., 2021.10.10 AM 10:10), QR codes, barcodes, and custom images/variable codes.

- Text
- Date and Time
- QR Codes
- Barcodes (6 types supported)
- Logos and Pictures
- Variable Codes

All printed content can be customized via the printer's interface or by loading files from the USB flash disk.

## 6. MAINTENANCE

### 6.1 Ink Cartridge Care

Proper care of the ink cartridge is crucial for maintaining print quality and extending the life of your printer. The

ink is quick-drying, so attention to the nozzle is important.

# Cost Effective

Incredible and affordable

\*Total ink point per cartridge=1140000

Printing content	Printing size	Required Ink point	Printable quantity	Cost/unit
	12.7mm*12.7mm	11	103636	\$0.001351
	12.7mm*50mm	32	35625	\$0.003930
Hello	12.7mm	10	114000	\$0.001228
	2.5mm	0.5	2280000	\$0.000061
Bye	12.7mm	6	190000	\$0.000737
	2.5mm	0.4	2850000	\$0.000049
2024/4/03	2.5mm	1	1140000	\$0.000123
	4.2mm	1.1	1036363	\$0.000135
	7.6mm	5	228000	\$0.000614

Image: Visual guide illustrating four key maintenance tips for the ink cartridge, including covering the nozzle, cleaning, removing for long pauses, and addressing print issues.

- Ink Properties:** The ink is waterproof but not permanent and may fade after multiple washes or prolonged friction.
- After Use:** Always clean any residual ink and cover the protective cap on the ink cartridge nozzle immediately after use to prevent the ink from drying out.
- Long Pauses:** If the printer will not be used for more than 10 minutes, remove the ink cartridge from the printer and cover the nozzle with its protective cap. This prevents air from entering and damaging the ink cartridge.
- Print Quality Issues (Missed Prints/Banding):** If prints appear partly missed or show banding, try the following:
  - Cover the ink cartridge nozzle with a tissue and gently shake the ink cartridge vigorously up and down.
  - Gently wipe the nozzle with an alcohol wipe to clear any blockage.

## 7. TROUBLESHOOTING

This section addresses common issues you might encounter with your BENTSAI BT-HH6105B2 printer.

<b>Problem</b>	<b>Possible Cause</b>	<b>Solution</b>
No print output or faint print	Ink cartridge nozzle is dry or clogged.	Ensure the protective cap was removed from the nozzle. Gently wipe the nozzle with an alcohol wipe. Cover the nozzle with a tissue and shake the cartridge vigorously. Check if the ink cartridge is properly seated.
Prints show banding or missing lines	Partial nozzle blockage or air in cartridge.	Perform the shaking and wiping procedure as described in Section 6.1. Ensure the cartridge is not left uncapped for extended periods.
Printer not turning on	Low battery or power connection issue.	Connect the power adapter and charge the printer. Ensure the power adapter is securely connected to both the printer and a working power outlet.
Ink dries too quickly on nozzle	Nozzle left exposed.	Always cover the nozzle with the protective cap immediately after use. Remove the cartridge and cap it if pausing printing for more than 10 minutes.

## 8. SPECIFICATIONS

---

Key technical specifications for the BENTSAI BT-HH6105B2 Handheld Inkjet Printer:

# 4.3" Large HD Screen Interface

Touch Screen Operation, High Sensitivity,  
Easy and Convenient











 450g (Palm-size and Lightweight)	 4.3" (HD Touch Screen)	 8 hours (Long Battery Life)	 0.5in/12.5mm (Print height)
 600 DPI (High Resolution)	 Plugged In Ink Cartridges	 2 Ways (Off wires Operation/ Production Lines)	 Endless (Printing Possibilities)

Image: Visual summary of key specifications for the BENTSAI printer.

- **Model:** BT-HH6105B2
- **Print Height:** Maximum 1/2 inch (12.7mm)
- **Print Resolution:** 600 DPI (High Resolution)
- **Ink Cartridge Type:** BB22B Original Solvent Fast Dry Black Ink Cartridge
- **Ink Capacity:** 42ml per cartridge
- **Ink Yield:** Approximately 2,000,000 characters at 2.5mm font size per 42ml cartridge.
- **Drying Time:** 2-5 seconds (quick-drying)
- **Screen:** 4.3-inch HD Touch Screen
- **Weight:** Approximately 450g (Palm-size and Lightweight)
- **Battery Life:** Up to 8 hours of continuous operation
- **Connectivity:** USB Flash Disk support
- **Operation Modes:** Off-wires operation / Production lines

## 8.1 Cost-Effective Printing

The BENTSAI printer is designed for cost-effective operation. The following table illustrates the approximate print quantity and cost per unit for various content types based on a 42ml ink cartridge (total ink point per cartridge = 1140000):

## ! Warm Tips

1. Ink is waterproof but not permanent and may fade after multiple washes and prolonged friction.

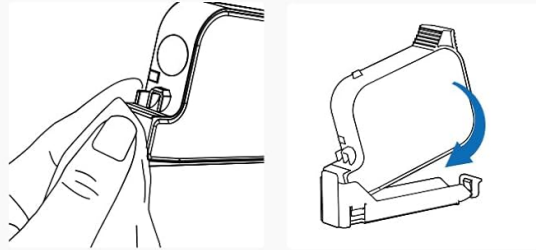

2. Clean the residual ink and cover the protection cap after using the ink cartridge to prevent ink nozzle from drying out.

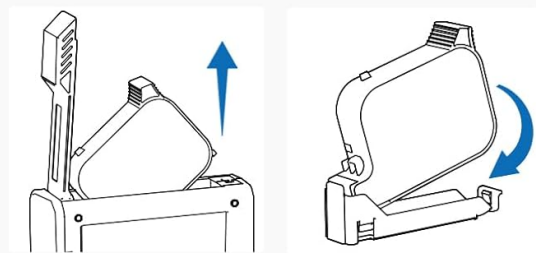

3. If the printer is not used for more than 10 minutes, please take out the ink cartridge from the printer and protect the ink nozzle with the cartridge protection cap. Otherwise, air may enter to damage the ink cartridge.

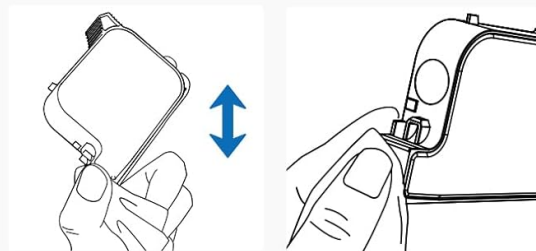

4. If the prints is missed partly or banding, please try the method below to solve:

- Cover the ink cartridge nozzle with a tissue and shake the ink cartridge vigorously up and down.
- Gently use a tissue with alcohol to wipe and clean the ink cartridge nozzle.

Image: Table detailing the printing quantity and cost per unit for various content types (QR code, barcode, text, date) at different print sizes.

Printing Content	Printing Size	Required Ink Point	Printable Quantity	Cost/Unit
QR Code	12.7mm*12.7mm	11	103636	\$0.001351
Barcode	12.7mm*50mm	32	35625	\$0.003930
Hello	12.7mm	10	114000	\$0.001228
	2.5mm	0.5	2280000	\$0.000061
Bye	12.7mm	6	190000	\$0.000737
	2.5mm	0.4	2850000	\$0.000049
2024/4/03	2.5mm	1	1140000	\$0.000123
	4.2mm	1.1	1036363	\$0.000135
	7.6mm	5	228000	\$0.000614

---

BENTSAI products are manufactured to high-quality standards. For warranty information, technical support, or service inquiries, please contact BENTSAI customer support through their official website or the contact information provided with your purchase documentation.

For further assistance, you may visit the official BENTSAI store on Amazon:[BENTSAI Store](#)