

Manuals+

[Q & A](#) | [Deep Search](#) | [Upload](#)

manuals.plus /

- › [eitton](#) /
- › [eitton BL20 Pro Robot Vacuum and Mop Instruction Manual](#)

eitton BL20 Pro

eitton BL20 Pro Robot Vacuum and Mop Instruction Manual

Model: BL20 Pro | Brand: eitton

1. PRODUCT OVERVIEW

The eitton BL20 Pro is an advanced 4-in-1 robotic vacuum cleaner designed to sweep, vacuum, mop, and self-empty, providing a comprehensive and hands-free cleaning solution for your home. Equipped with 5000Pa super suction power and 360° LiDAR precise mapping technology, it efficiently navigates and cleans various floor types, including hard floors and carpets. Its smart features, such as app control, no-go zones, and 60-day hands-free cleaning, simplify daily chores and enhance convenience.



Figure 1.1: The eiton BL20 Pro Robot Vacuum and Mop with its self-emptying station and app interface.

2. WHAT'S IN THE BOX

Carefully unpack all components and ensure all items are present before proceeding with setup.

- Robot Vacuum
- Charging Dock & 2-in-1 Dust Box
- 2-in-1 Dust & Water Bin
- Roller Brush
- User Manual
- Mop Board
- Mop Cloth
- Side Brush (x2)
- HEPA Filter
- Cleaning Brush

- Dust Bag (x2)

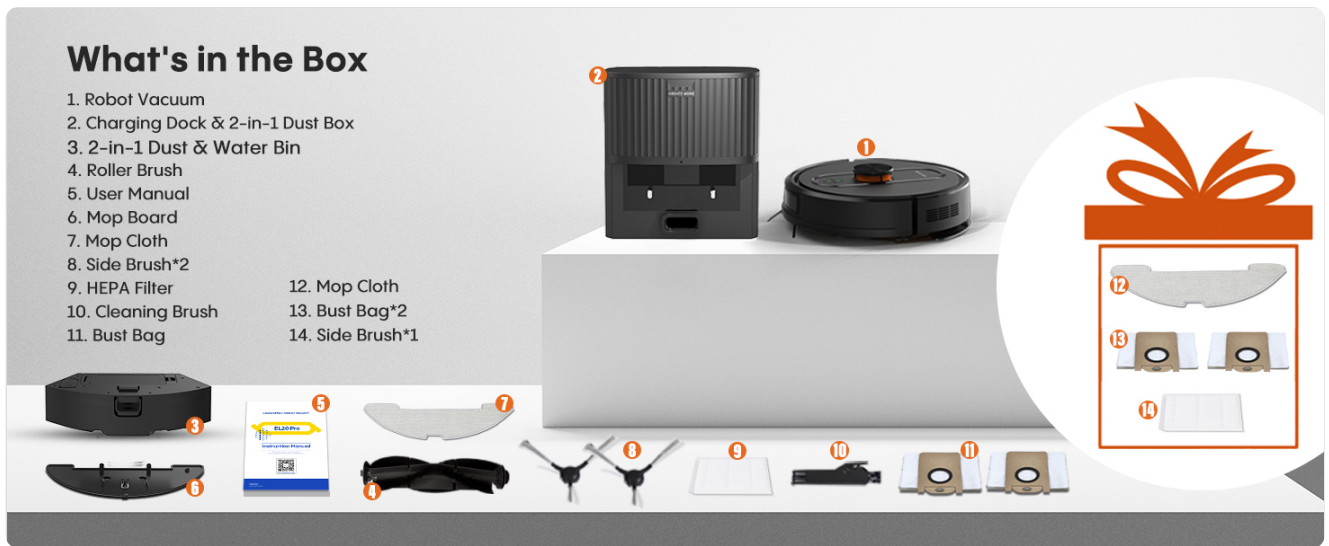

Figure 2.1: All components included in the eiton BL20 Pro packaging.

3. SETUP GUIDE

3.1 Initial Charging

Place the charging dock against a wall in an open area with good Wi-Fi signal. Ensure there are no obstacles within 1.5 meters (5 feet) in front and 0.5 meters (1.6 feet) on either side of the dock. Connect the power adapter to the charging dock and plug it into a power outlet. Place the robot vacuum onto the charging pins of the dock. The indicator light on the robot will show charging status. Fully charge the robot before first use, which typically takes about 4-5 hours.

60 Days Hand-Free Cleaning



Figure 3.1: The robot vacuum automatically returns to its self-emptying station for charging and dust disposal, providing up to 60 days of hands-free cleaning.

3.2 App Installation and Connection

1. Download the official eiton app from your smartphone's app store (iOS or Android).
2. Register or log in to your account.
3. Follow the in-app instructions to add your BL20 Pro robot vacuum. Ensure your phone is connected to a 2.4GHz Wi-Fi network during the pairing process.
4. Once connected, you can control the robot, set cleaning schedules, and access advanced features.

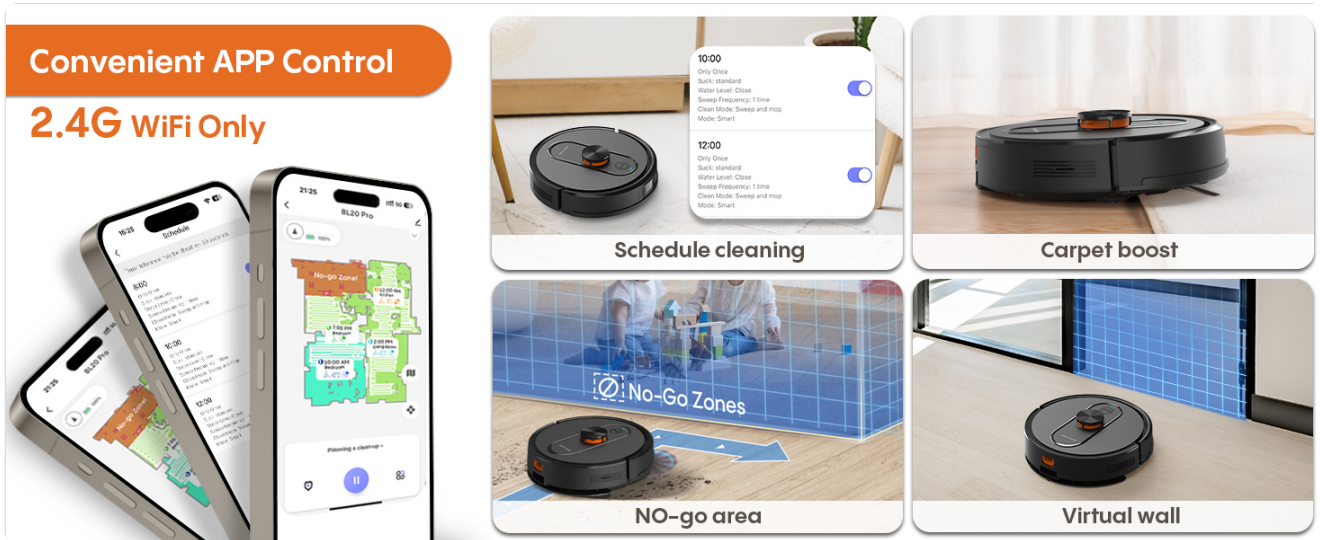

Figure 3.2: The convenient app control allows for scheduling, setting no-go zones, and adjusting cleaning preferences.

4. OPERATING INSTRUCTIONS

4.1 Starting a Cleaning Cycle

Press the power button on the robot or use the app to start a cleaning cycle. The robot will begin mapping its environment using LiDAR navigation and plan an efficient cleaning route.

Accurate Home Mapping

360° Intelligent Lidar Navigation

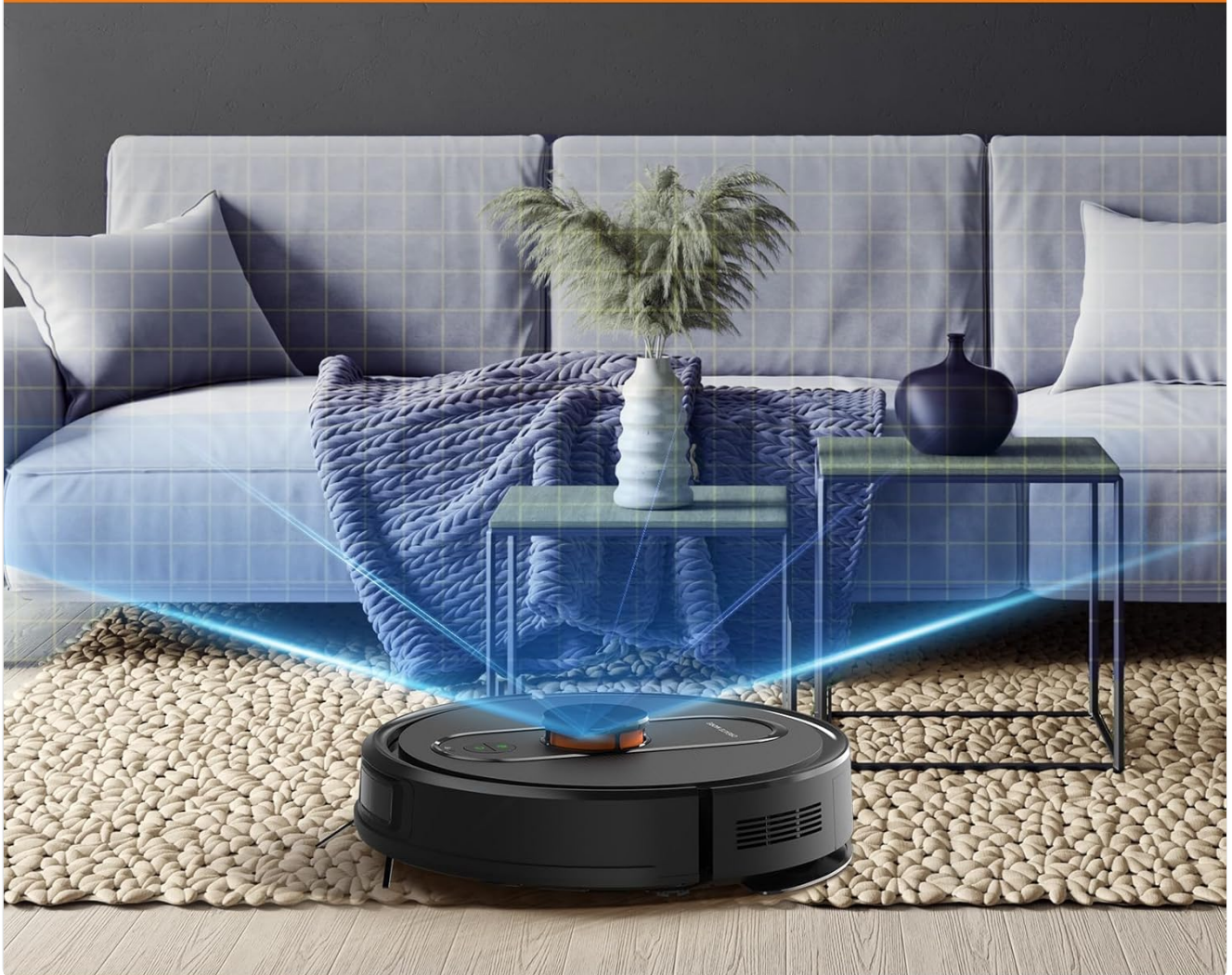

Figure 4.1: The BL20 Pro utilizes 360° LiDAR technology for precise home mapping and efficient navigation.

4.2 Cleaning Modes

The BL20 Pro offers multiple cleaning modes to suit various needs:

- **Auto Clean:** The robot intelligently cleans the entire mapped area.
- **Spot Clean:** Focuses on a specific dirty area for intensive cleaning.
- **Edge Clean:** Cleans along walls and furniture edges.
- **Manual Control:** Use the app to manually steer the robot.



Figure 4.2: The robot supports various cleaning modes including manual, edge, spot, and zigzag cleaning patterns.

4.3 Suction Power and Mopping

Adjust suction power (Quiet, Standard, Strong, Max) and water flow for mopping via the app to optimize cleaning for different floor types and debris levels. The 5000Pa suction effectively picks up dust, hair, and larger debris.

5000Pa Strong Suction Power

Picks up dust and pet hair easily



Figure 4.3: The 5000Pa strong suction power effectively picks up dust and pet hair.

3-in-1 Sweep, Vacuum and Mop



Figure 4.4: The BL20 Pro combines sweeping, vacuuming, and mopping functions for comprehensive cleaning.

4.4 Mapping and No-Go Zones

The robot creates and stores accurate maps of your home. Use the app to define specific cleaning areas, set virtual walls, or establish 'No-Go Zones' to prevent the robot from entering certain areas (e.g., pet bowls, delicate items, or areas with loose cables).

Meeting individual needs



Figure 4.5: The robot can be scheduled to clean specific rooms at different times, adapting to individual needs.

4 Editable Maps & No-Go Zones



Figure 4.6: Easily set up to 4 editable maps and define 'No-Go Zones' or 'Invisible Walls' through the app.

5. MAINTENANCE

Regular maintenance ensures optimal performance and extends the lifespan of your eiton BL20 Pro.

5.1 Self-Emptying Dust Collection

The BL20 Pro features a large-capacity dust collection station that automatically empties the robot's dustbin into a sealed dust bag. This allows for up to 60 days of hands-free cleaning. Replace the dust bag when full, typically indicated by the app or a light on the station.

Robot Vacuum Self-Emptying



Figure 5.1: The robot vacuum and its self-emptying station, along with included accessories for maintenance.

5.2 Cleaning the Dustbin and Filters

- Open the robot's top cover and remove the 2-in-1 dust & water bin.
- Empty the dust from the bin.
- Remove the HEPA filter and tap it gently to remove dust. Do not wash the HEPA filter with water.
- Rinse the dustbin with water if necessary, ensuring it is completely dry before reinstallation.
- Clean the filter screen with the provided cleaning brush.

5.3 Cleaning Brushes

- **Roller Brush:** Remove the main brush cover and lift out the roller brush. Use the cleaning tool to remove tangled hair and debris.
- **Side Brushes:** Periodically check and clean the side brushes. If they are worn or damaged, replace them with new ones.

5.4 Mopping Pad Maintenance

- After each mopping session, detach the mop cloth from the mop board.
- Wash the mop cloth thoroughly with water and mild detergent.
- Allow the mop cloth to air dry completely before reattaching it or storing.

5.5 Cleaning Sensors and Charging Contacts

Wipe the cliff sensors, wall sensors, and charging contacts on both the robot and the charging dock with a clean, dry cloth to ensure proper function and charging.

6. TROUBLESHOOTING

If you encounter issues with your eiton BL20 Pro, refer to the following common problems and solutions:

Problem	Possible Cause	Solution
Robot does not start or respond.	Low battery; Power switch off; Robot stuck.	Charge the robot; Ensure power switch is ON; Clear any obstructions.
Robot cannot return to charging dock.	Dock obstructed; Robot too far from dock; Dirty charging contacts.	Clear area around dock; Manually place robot near dock; Clean charging contacts.
Poor cleaning performance.	Full dustbin; Clogged filter; Worn brushes.	Empty dustbin; Clean/replace filter; Clean/replace brushes.
Robot gets stuck frequently (e.g., "bumper is stuck").	Obstacles; Loose cables; Low furniture.	Clear obstacles; Tidy cables; Use no-go zones for problematic areas. Check if bumper is physically stuck and gently free it.
App connection issues.	Incorrect Wi-Fi password; Router issues; Robot not in pairing mode.	Verify Wi-Fi password; Restart router; Reset robot's Wi-Fi and re-pair. Ensure 2.4GHz network.

If the problem persists after trying these solutions, please contact customer support for further assistance.

7. SPECIFICATIONS

Feature	Detail
Brand	eiton
Model Name	BL20 Pro
Special Feature	60 Days Hands-Free
Color	Black
Product Dimensions	12.01"L x 12.01"W x 3.59"H

Feature	Detail
Item Weight	14.57 pounds
Filter Type	Hepa
Battery Life	120 minutes
Batteries Required	1 CR5 battery (included)
Navigation Type	LiDAR
Suction Power	5000Pa (Max)
Connectivity	Wi-Fi (2.4G), App, Alexa Control

8. WARRANTY AND SUPPORT

eitton provides a **2-year warranty** for the BL20 Pro Robot Vacuum and Mop, ensuring peace of mind for your purchase. We also offer **lifetime technical support** to assist you with any questions or issues you may encounter during the product's lifespan.

For warranty claims, technical assistance, or any other inquiries, please refer to the contact information provided in your product packaging or visit the official eitton support website.