

## UTRAI JS-30

# UTRAI JS-30 Car Battery Booster Jump Starter with Air Compressor and OBD II Diagnostic Tool User Manual

Model: JS-30 | Brand: UTRAI

## 1. INTRODUCTION

Thank you for choosing the UTRAI JS-30 Car Battery Booster Jump Starter. This versatile device combines a powerful jump starter, a 150PSI air compressor, a 2000-lumen multi-mode LED light, a portable power bank, and an OBD II diagnostic tool. Designed for convenience and safety, the JS-30 is an essential companion for roadside emergencies, outdoor adventures, and vehicle maintenance. Please read this manual thoroughly before use to ensure proper operation and to maximize the lifespan of your device.

## 2. IMPORTANT SAFETY INFORMATION

Always observe the following safety precautions to prevent injury or damage to the device and your vehicle.

- Read all instructions before using the product.
- Do not operate the device if it is damaged.
- Keep out of reach of children.
- Do not immerse the device in water.
- Do not expose the device to extreme temperatures (above 60°C / 140°F or below -20°C / -4°F).
- Ensure proper ventilation during use and charging.
- Wear eye protection and gloves when jump starting a vehicle.
- Do not connect the positive and negative clamps together.
- Do not attempt to jump start a frozen battery.
- Disconnect the device from the vehicle battery immediately after jump starting.
- The device contains a lithium polymer battery. Follow all local regulations for disposal.
- This device is designed for 12V vehicles only. Do not attempt to jump start other voltage systems.

The JS-30 is built with V0-rated flame-retardant material and intelligent safety chips, providing 10 layers of protection: over-discharge, reverse polarity, spark-proof, short-circuit, overcharge, overpower, overcurrent, overvoltage, overheating, and extreme temperature safeguards.

## 3. PRODUCT OVERVIEW AND PACKAGE CONTENTS

Familiarize yourself with the components of your UTRAI JS-30.



Image: The UTRAI JS-30 unit with jumper cables, air hose, OBD II scanner, and various nozzles.

### Package Contents:

- UTRAI JS-30 Car Jump Starter with Air Compressor (x1)
- Heavy Duty Smart Jumper Cables (x1)
- Detachable Air Hose (x1)
- 4 Valve Connectors / Inflation Nozzles (x1 set)
- USB-C Charging Cable (x1)
- DC Cigarette Lighter Adapter (x1)
- OBD II Scanner (x1)
- Insulated Gloves (x1 pair)
- EVA Protective Case (x1)
- User Manual (x1)



Image: A visual representation of all items included in the UTRAI JS-30 emergency kit.

## 4. SETUP AND INITIAL CHARGING

---

### 4.1 Initial Charging

Before first use, fully charge the UTRAI JS-30. It is recommended to charge the device at least once every three months to maintain optimal battery health, or more frequently in extreme weather conditions.

1. Connect the provided USB-C charging cable to the USB-C input port on the JS-30.
2. Connect the other end of the USB-C cable to a USB wall adapter (not included) or a car charger.
3. The digital display will show the charging progress. The device is fully charged when the battery indicator shows full.

### 4.2 Understanding the Display and Controls

The JS-30 features a clear digital display and intuitive controls for its various functions.





Image: The main unit showing the digital display with PSI/BAR/KPA units, battery level, and control buttons for mode, light, power, and pressure adjustment.

- **Digital Display:** Shows battery level, pressure readings (PSI, BAR, KPA), and input/output status.
- **Power Button:** Turns the device on/off.
- **Light Button:** Cycles through flashlight, strobe, SOS, and red warning flash modes.
- **Mode Button (M):** Selects inflation modes (car, motorcycle, bike, ball, custom). Long press to switch pressure units.
- **+/- Buttons:** Adjust target pressure for inflation.

## 5. OPERATING INSTRUCTIONS: JUMP STARTING A VEHICLE

The JS-30 can jump start all 12V vehicles, including gasoline engines (all sizes) and diesel engines up to 12L.

### 5.1 Standard Jump Start Procedure

1. Ensure the JS-30 is sufficiently charged (at least 50% battery).
2. Turn off your vehicle's ignition and all accessories.

3. Insert the smart jumper cable clamp plug firmly into the jump starter's EC5 port.
4. Connect the **red (+) clamp** to the vehicle's positive (+) battery terminal.
5. Connect the **black (-) clamp** to the vehicle's negative (-) battery terminal.
6. Once connected correctly, the smart clamp indicator light will turn solid green. If it flashes red/green or beeps, check connections.
7. Start your vehicle's engine.
8. Once the engine starts, immediately remove the black (-) clamp, then the red (+) clamp from the vehicle battery.
9. Disconnect the smart clamp plug from the jump starter.



Image: Step-by-step guide showing how to connect the jump starter to a car battery and start the engine.

## 5.2 BOOST Mode for Completely Dead Batteries

If your vehicle battery is completely dead and the smart clamp indicator does not turn solid green, use the BOOST mode:

1. Follow steps 1-5 from the Standard Jump Start Procedure.
2. If the smart clamp indicator does not turn green, press and hold the "BOOST" button on the smart clamp for 3-5 seconds until the indicator turns solid green.
3. Start your vehicle's engine within 30 seconds.
4. Immediately remove the black (-) clamp, then the red (+) clamp from the vehicle battery.
5. Disconnect the smart clamp plug from the jump starter.

**Caution:** Do not use BOOST mode unless necessary. Only use it when the smart clamp indicator does not activate in standard mode. Do not hold the BOOST button for more than 5 seconds.

## 6. OPERATING INSTRUCTIONS: AIR COMPRESSOR

---

The JS-30 features a 150PSI air compressor suitable for inflating car tires, motorcycle tires, bicycle tires, balls, and other inflatables.



Image: The UTRAI JS-30 connected to a car tire, displaying the pressure on its screen.

1. Screw the detachable air hose onto the air outlet port of the JS-30.
2. Attach the appropriate valve connector to the air hose and connect it to the item you wish to inflate.
3. Turn on the JS-30. The current pressure will be displayed.
4. Press the **Mode (M) button** to select the desired inflation mode (car, motorcycle, bike, ball, custom). Long press the M button to switch between PSI, BAR, and KPA units.
5. Use the **+/- buttons** to set your target pressure.
6. Press the inflation button (usually the power button or a dedicated inflation button, refer to device markings) to start inflation.
7. The compressor will automatically shut off once the preset pressure is reached.
8. Disconnect the air hose from the item and the JS-30.

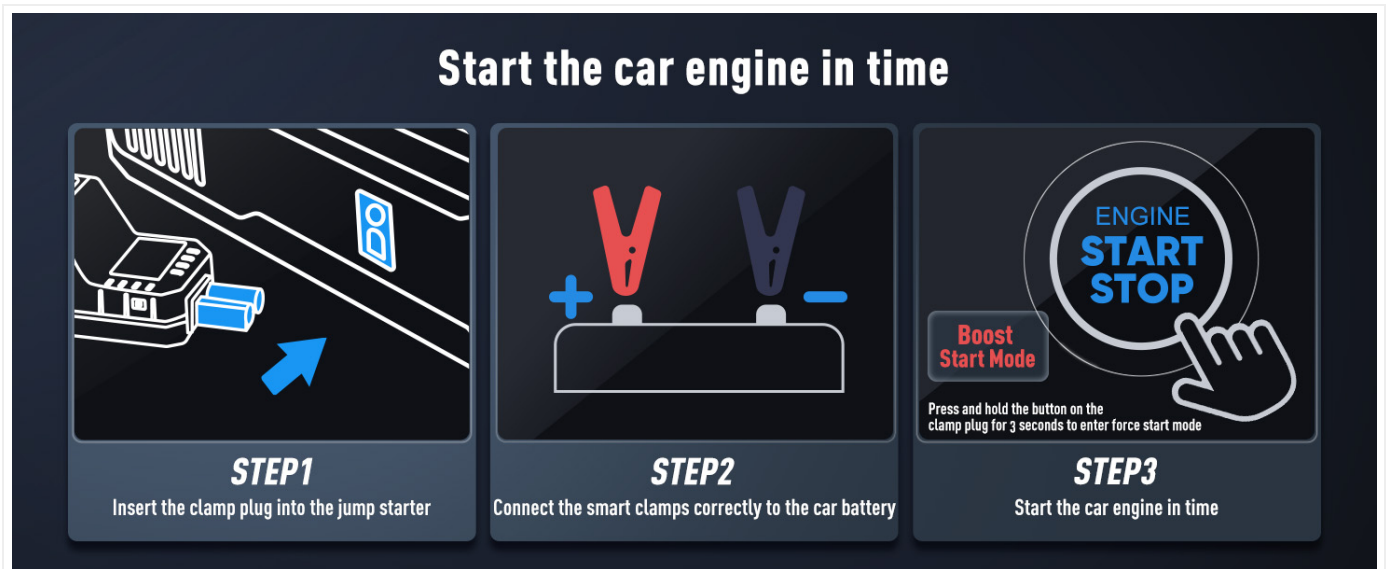

Image: A three-step visual guide on connecting the air hose, selecting mode/units, and adjusting pressure for inflation.

## 7. OPERATING INSTRUCTIONS: PORTABLE POWER BANK

The JS-30 can also serve as a portable power bank to charge your electronic devices or power 12V appliances.

### 7.1 USB Charging

- Connect your phone, tablet, or other USB-powered device to one of the dual USB output ports (USB-A Output 1:



5V/3A, 9V/2A, 12V/1.5A; USB-A Output 2: 5V/2.4A).

- The JS-30 will automatically begin charging your device.



Image: The JS-30 connected to various electronic devices like a smartphone, tablet, and earbuds for charging.

## 7.2 12V DC Output

- Connect the provided DC cigarette lighter adapter to the 160W DC output port on the JS-30.
- Plug your 12V appliance (e.g., car refrigerator, mini air pump, vacuum cleaner) into the cigarette lighter adapter.
- The JS-30 will power the appliance.



Image: The JS-30 connected to a portable car refrigerator, demonstrating its 160W DC output capability.

## 8. OPERATING INSTRUCTIONS: LED LIGHTS

The JS-30 features a powerful 2000-lumen rotatable floodlight and a spotlight for various illumination needs.



Image: The JS-30's LED light illuminating an outdoor area, showcasing its versatility.

- Press the **Light button** to cycle through the following modes:
  - **Flashlight:** For focused illumination.
  - **Strobe (White):** For signaling or attracting attention.
  - **SOS:** International distress signal.
  - **Red Warning Flash:** For roadside emergencies, enhancing visibility.
  - **Spotlight:** For close-up tasks like tire checks or engine inspection.
- The floodlight panel can be rotated 90° for adjustable illumination angles.



Image: The JS-30 displaying its red warning flash function for roadside safety.

## 9. OPERATING INSTRUCTIONS: OBD II DIAGNOSTIC TOOL

The included OBD II scanner allows you to diagnose vehicle issues by reading fault codes and monitoring key components.



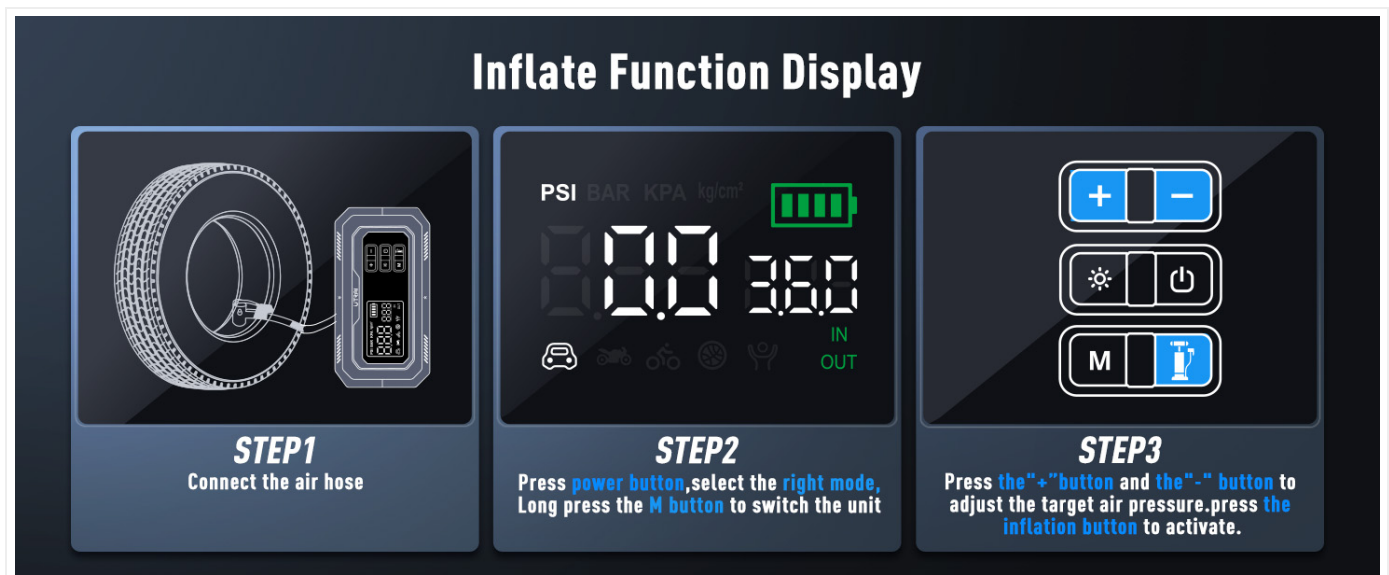

Image: Steps to download the YMOBD app, plug in the OBD II adapter, and connect via Bluetooth for diagnostics.

1. Download the "YMOBD" app from your smartphone's app store (scan the QR code on the OBD II scanner packaging or search directly).
2. Insert the OBD II scanner into your vehicle's OBD port (typically located under the dashboard on the driver's side).
3. Start your vehicle's engine.
4. Open the YMOBD app on your smartphone.
5. Turn on your phone's Bluetooth and location services.
6. Follow the in-app instructions to connect to the OBD II device via Bluetooth. The OBD II device indicator light will show blue when Bluetooth is connected.
7. Once connected, you can access various diagnostic functions:
  - **DTC Monitoring:** Reads and clears diagnostic trouble codes (DTCs).
  - **Real-time Data Stream:** Displays live sensor data from your vehicle.
  - **Battery Monitor:** Provides real-time monitoring of battery status.
  - **Fault Indicator Detection:** Checks the status of the malfunction indicator lamp.
  - **Freeze Frame:** Stores engine parameters at the moment a fault code was set.
  - **Diagnostic Ready Status:** Shows the status of various vehicle monitoring systems.
  - **Component/System Monitoring Results:** Accesses results of on-board diagnostic monitoring tests.
  - **Vehicle Information:** Displays vehicle-specific information.
  - **Trip Analysis:** Analyzes driving data for each trip.
  - **Vehicle Performance Testing:** Conducts performance tests.
8. Follow the app's prompts to add your vehicle information for accurate diagnosis.

**Note:** Some advanced functions within the YMOBD app may require specific product versions or in-app purchases. Ensure your phone's Bluetooth and location services are enabled for proper connection.

## 10. MAINTENANCE

- **Charging:** Recharge the JS-30 at least once every three months to maintain battery health. If stored for extended periods, ensure it is charged to at least 50%.
- **Cleaning:** Clean the device with a dry, soft cloth. Do not use harsh chemicals or abrasive materials.
- **Storage:** Store the device in a cool, dry place away from direct sunlight and extreme temperatures. Keep it in its protective EVA case when not in use.

- **Battery Care:** Avoid fully discharging the battery frequently. Lithium Polymer batteries perform best when kept between 20% and 80% charge.

## 11. TROUBLESHOOTING

Problem	Possible Cause	Solution
Device does not turn on.	Battery is completely discharged.	Charge the device fully using the provided USB-C cable.
Vehicle does not jump start.	Incorrect clamp connection; vehicle battery too dead; vehicle issue beyond battery.	Ensure clamps are connected correctly (red to +, black to -). Try BOOST mode if the battery is completely dead. If still unsuccessful, consult a mechanic.
Smart clamp indicator flashes red/green or beeps.	Reverse polarity, short circuit, or other connection error.	Disconnect clamps and re-connect carefully, ensuring correct polarity. Refer to safety protections.
Air compressor does not inflate or stops prematurely.	Air hose not securely connected; target pressure reached; battery low.	Ensure air hose is tightly screwed on. Check preset pressure. Recharge the device if battery is low.
OBD II scanner not connecting to app.	Bluetooth or location services off; app not installed; scanner not properly inserted.	Ensure phone's Bluetooth and location services are enabled. Verify app installation. Re-insert scanner firmly into OBD port.

## 12. SPECIFICATIONS

Feature	Detail
Model	JS-30
Peak Current	7000A
Vehicle Compatibility	All 12V gasoline engines, 12V diesel engines up to 12L
Air Compressor Pressure	Up to 150PSI
LED Light Brightness	2000 Lumens
Battery Capacity	16000mAh (Real Capacity)
USB-A Output 1	5V/3A, 9V/2A, 12V/1.5A (18W Max)
USB-A Output 2	5V/2.4A (12W Max)
USB-C Input	5V/3A, 9V/2A, 12V/1.5A (18W Max)

Feature	Detail
DC Output	12V-16V (160W Max)
Safety Protections	10 intelligent safety protections (over-discharge, reverse polarity, spark-proof, short-circuit, overcharge, overpower, overcurrent, overvoltage, overheating, extreme temperature)
Dimensions	25.8 x 12 x 17 cm
Weight	2.24 kg

### 13. WARRANTY AND SUPPORT

The UTRAI JS-30 comes with a 24-month worry-free warranty and lifetime technical support. For any questions, issues, or support needs, please contact UTRAI customer service through your purchase platform or the official UTRAI website.

**Manufacturer:** Ekoo Electronic Co., Ltd



#### Related Documents - JS-30

<div><div>UTRAI</div><div>Jump Starter &amp; Air Compressor JS-5</div><div>USER MANUAL</div><div>PDF 1024x1024</div></div>	<div><a href="#">UTRAI JS-5 Jump Starter &amp; Air Compressor User Manual</a></div> <div>Comprehensive user manual for the UTRAI JS-5 portable jump starter and air compressor. Includes instructions for jump starting vehicles, inflating tires, charging devices, safety precautions, specifications, and troubleshooting.</div>
<div><div>UTRAI</div><div>Jump Starter JS-Mini</div><div>USER MANUAL</div><div>PDF 1024x1024</div></div>	<div><a href="#">UTRAI Jump Starter JS-Mini User Manual</a></div> <div>User manual for the UTRAI JS-Mini Jump Starter, providing detailed instructions on its features, operation, specifications, and safety precautions for jump-starting vehicles and charging devices.</div>
<div><div>UTRAI</div><div>Jump Starter &amp; Air Compressor JS-5</div><div>USER MANUAL</div><div>PDF 1024x1024</div></div>	<div><a href="#">UTRAI JS-5 Jump Starter &amp; Air Compressor User Manual</a></div> <div>Comprehensive user manual for the UTRAI JS-5 Jump Starter and Air Compressor, detailing its features, operation, safety precautions, and troubleshooting. Includes jump starting, tire inflation, and device charging instructions.</div>



<div><div>T1 User Manual</div></div>	<div><div><a href="#">UTRAI T1 Jump Starter User Manual - Portable Car Battery Booster</a></div><div>Comprehensive user manual for the UTRAI T1 portable jump starter. Learn how to charge your car battery, charge devices, use the LED flashlight, and understand safety features.</div></div>
<div><div><div>UTRAI</div><div>Jump Starter JS-Mini</div><div>USER MANUAL</div></div></div>	<div><div><a href="#">UTRAI JS-Mini Jump Starter User Manual</a></div><div>Comprehensive user manual for the UTRAI JS-Mini portable car jump starter, covering specifications, operation, safety information, and customer support.</div></div>
<div><div><div>UTRAI</div><div>Jump Starter JS-1 Pro</div><div>USER MANUAL</div></div></div>	<div><div><a href="#">UTRAI JS-1 Pro Jump Starter User Manual: Features, Operation, and Safety</a></div><div>Comprehensive user manual for the UTRAI JS-1 Pro portable jump starter. Learn about its specifications, operation, charging, safety guidelines, and troubleshooting. Includes jump starting instructions and customer support.</div></div>