

## Tineco S30

# Tineco Pure ONE S30 Cordless Vacuum Cleaner User Manual

Model: S30

## 1. INTRODUCTION

---

Thank you for choosing the Tineco Pure ONE S30 Cordless Vacuum Cleaner. This manual provides essential information for the safe and efficient operation, maintenance, and troubleshooting of your new appliance. Please read it thoroughly before use and retain it for future reference.

The Tineco Pure ONE S30 is designed for versatile cleaning across various surfaces, featuring powerful suction and advanced filtration to ensure a clean and healthy home environment.

## 2. IMPORTANT SAFETY INSTRUCTIONS

---

To reduce the risk of fire, electric shock, or injury, always follow basic precautions when using your appliance, including the following:

- Read all instructions before using the appliance.
- Do not use outdoors or on wet surfaces.
- Do not allow to be used as a toy. Close attention is necessary when used by or near children.
- Use only as described in this manual. Use only manufacturer's recommended attachments.
- Do not use with damaged cord or plug. If appliance is not working as it should, has been dropped, damaged, left outdoors, or dropped into water, return it to a service center.
- Do not pull or carry by cord, use cord as a handle, close a door on cord, or pull cord around sharp edges or corners. Do not run appliance over cord. Keep cord away from heated surfaces.
- Do not unplug by pulling on cord. To unplug, grasp the plug, not the cord.
- Do not handle plug or appliance with wet hands.
- Do not put any object into openings. Do not use with any opening blocked; keep free of dust, lint, hair, and anything that may reduce airflow.
- Keep hair, loose clothing, fingers, and all parts of body away from openings and moving parts.
- Do not pick up anything that is burning or smoking, such as cigarettes, matches, or hot ashes.

- Use extra care when cleaning on stairs.
- Do not use to pick up flammable or combustible liquids, such as gasoline, or use in areas where they may be present.
- Do not pick up toxic material (chlorine bleach, ammonia, drain cleaner, etc.).
- Do not use in an enclosed space where vapors are present from oil base paint, paint thinner, mothproofing substances, flammable dust, or other explosive or toxic vapors.
- Do not use to pick up hard or sharp objects such as glass, nails, screws, coins, etc.
- Do not use without filter in place.
- Prevent unintentional starting. Ensure the switch is in the off-position before connecting to battery pack, picking up or carrying the appliance.
- Disconnect the battery pack from the appliance before making any adjustments, changing accessories, or storing appliance.

### 3. WHAT'S INCLUDED

Your Tineco Pure ONE S30 package includes the following components:

- Main Body
- Battery
- HEPA Filter
- Tube
- 2-in-1 Crevice Brush
- ZeroTangle Brush Head
- Dustbin (0.6L Capacity)
- Wall-mounted Dock

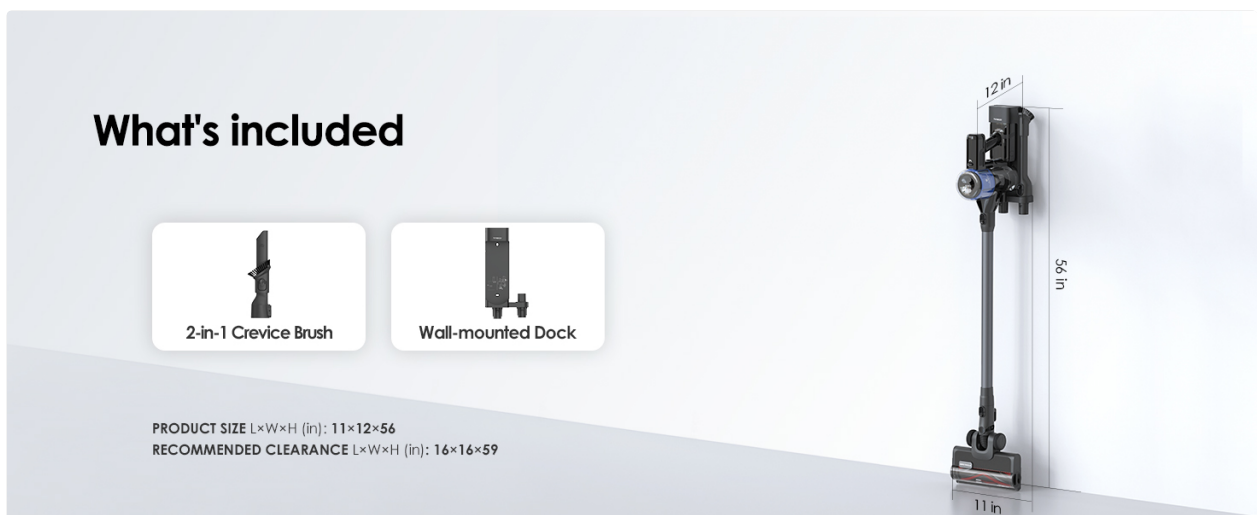

Figure 3.1: Overview of included components for the Tineco Pure ONE S30.

## Detachable Design

The battery, roller brush, dustbin, and filter are all detachable, making it convenient for users to replace and maintain.

- |              |                         |
|--------------|-------------------------|
| 1. Main Body | 5. 2-in-1 Crevice Brush |
| 2. Battery   | 6. Brush                |
| 3. HEPA      | 7. Dustbin              |
| 4. Tube      |                         |

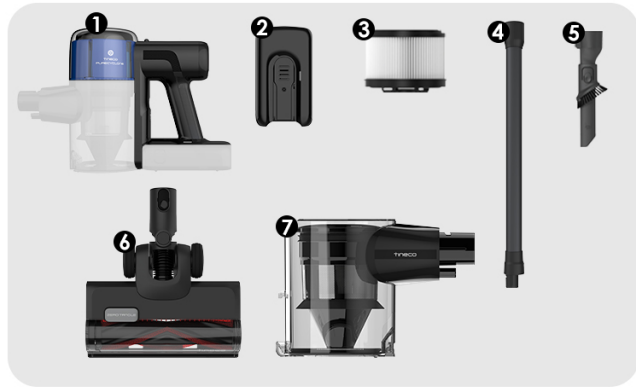

Figure 3.2: Detachable design of the vacuum for easy maintenance and versatility.

## 0.6L Dust Bin

Extend the cleaning time before emptying. No need to frequently empty the dust bin.



Figure 3.3: The 0.6L capacity dust bin, designed for extended cleaning sessions.

## 4. SETUP

---

### 4.1 Assembly

1. Connect the main body to the extension tube until it clicks into place.
2. Attach the desired brush head (e.g., ZeroTangle Brush) to the other end of the extension tube, ensuring it is securely fastened.
3. For handheld use, detach the extension tube and attach accessories directly to the main body.



Figure 4.1: Assembling the main body, extension tube, and brush head.

## 4.2 Charging

Before first use, fully charge the vacuum cleaner. The wall-mounted dock provides a convenient storage and charging solution.

1. Install the wall-mounted dock in a suitable location near a power outlet.
2. Place the vacuum cleaner onto the dock. Ensure the charging contacts align.
3. The indicator lights on the vacuum will show the charging status.

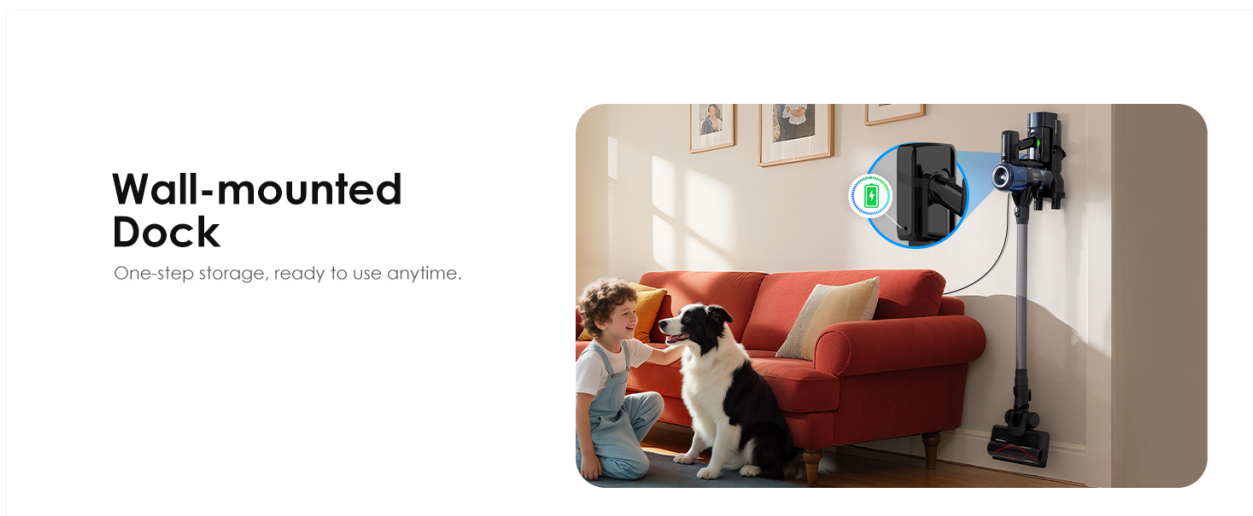

Figure 4.2: The wall-mounted dock for convenient storage and charging.

## 5. OPERATING INSTRUCTIONS

### 5.1 Power On/Off and Mode Selection

Press the power button to turn the vacuum on or off. The Tineco Pure ONE S30 offers multiple cleaning modes, typically including Eco and Max, which can be selected via the control panel on the main body.

### 5.2 Cleaning Surfaces

The vacuum is suitable for both carpets and hard floors. The ZeroTangle Brush is designed to effectively tackle hair messes and capture pet fur without tangling, ensuring a smooth and efficient cleaning experience.



Figure 5.1: The ZeroTangle Brush effectively cleans pet hair from carpets.



Figure 5.2: The ZeroTangle Brush significantly reduces hair tangles compared to conventional brushes.



Figure 5.3: The 150AW powerful suction efficiently picks up various types of debris.

### 5.3 LED Headlight

The integrated LED headlight illuminates dark areas, making hidden dust and debris visible for thorough cleaning.



## LED HeadLight

Illuminates dark areas to effectively remove hidden dust, ensuring no corners are missed in whole-house cleaning.

Figure 5.4: LED Headlight reveals hidden dust for comprehensive cleaning.

## 5.4 Runtime

The Tineco Pure ONE S30 offers an extended runtime, allowing for whole-house cleaning without interruption. Up to 65 minutes in Eco Mode with the 2-in-1 Crevice Brush, and up to 45 minutes with the ZeroTangle Brush.



Figure 5.5: Extended runtime for cleaning multiple areas of your home.

## 5.5 Using Multiple Attachments

Switch between various attachments to clean different areas and tackle specific tasks, such as high places, desks, and crevices.

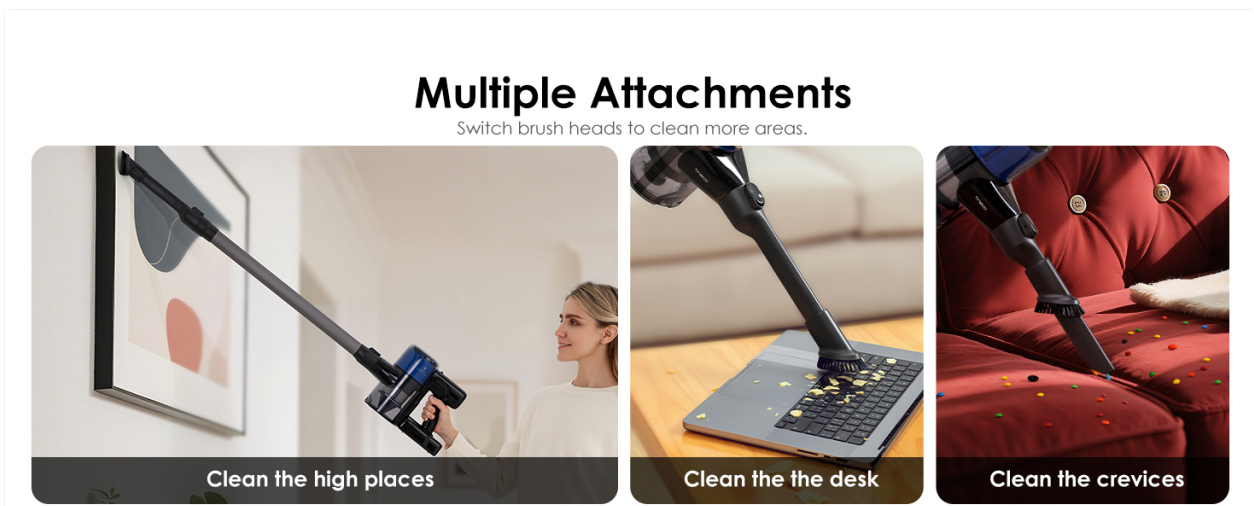

## Multiple Attachments

Switch brush heads to clean more areas.

Clean the high places

Clean the the desk

Clean the crevices

Figure 5.6: Versatile attachments for comprehensive cleaning.

## 5.6 Official Product Video

Video 5.1: Official product overview of the Tineco Pure ONE S30 Cordless Vacuum Cleaner, demonstrating its features and usage.

## 5.7 Pet Owner Review Video

Video 5.2: A short preview video highlighting the Tineco Cordless Vacuum's effectiveness for pet owners, showcasing its ability to handle pet hair.

# 6. MAINTENANCE

## 6.1 Emptying the Dustbin

The 0.6L dustbin features a one-click disposal system for hygienic emptying without direct contact with debris.

1. Position the dustbin over a trash receptacle.
2. Press the release button on the dustbin to open the bottom flap and empty the contents.
3. Close the flap securely after emptying.

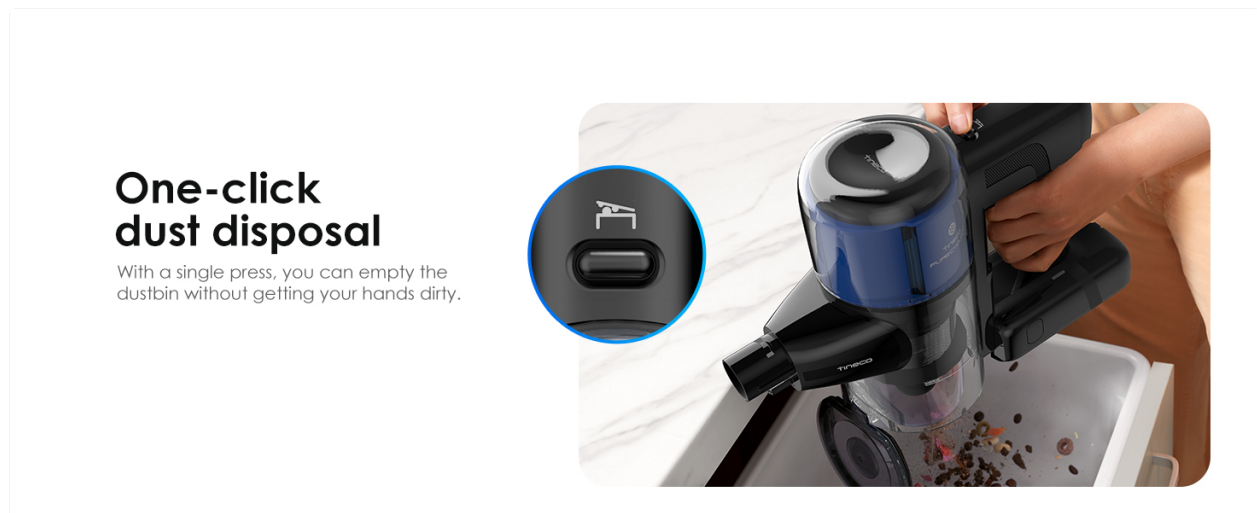

Figure 6.1: One-click dust disposal for easy and clean emptying.

## 6.2 Cleaning the Filtration System

The 6-stage filtration system, including a HEPA 13 filter, captures up to 99.99% of dust and debris as small as 0.3  $\mu\text{m}$ . Regular cleaning is crucial for maintaining optimal suction and air quality.

1. Remove the dustbin and separate the filter components (Main Cyclone, Mesh Filter, PureCyclone, Coarse Sponge, Fine Sponge, HEPA 13 Filter).
2. Tap off loose dust from each component.
3. Rinse washable components under running water. Ensure they are completely dry before reassembling.
4. Reassemble the filtration system and dustbin.

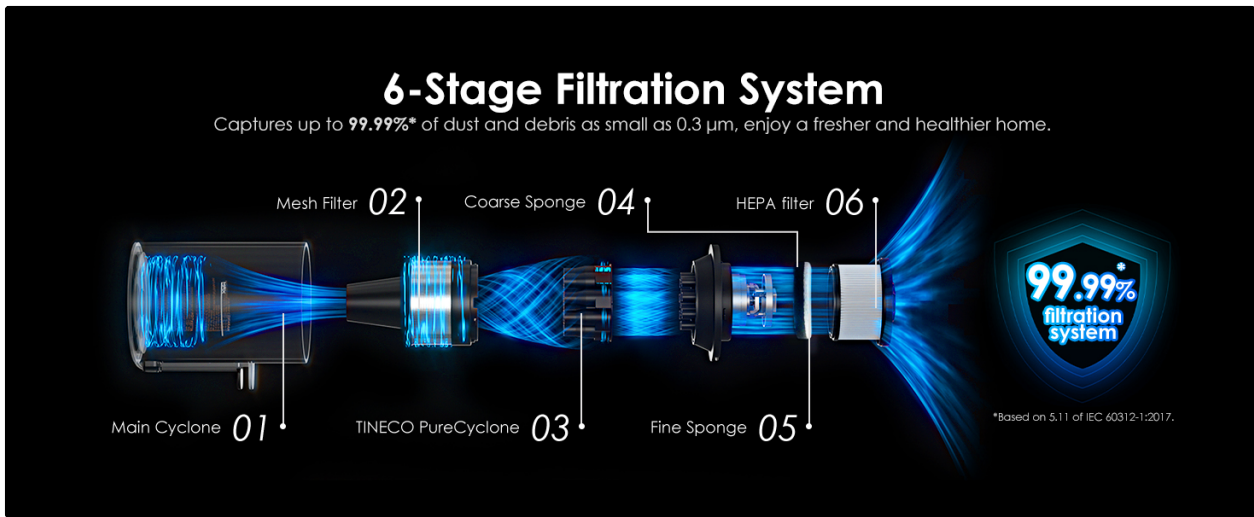

Figure 6.2: Detailed view of the 6-Stage HEPA Filtration System.

Tineco PureCyclone Technology ensures strong, long-lasting suction by effectively separating air and dust, which keeps the filter cleaner for an extended period.

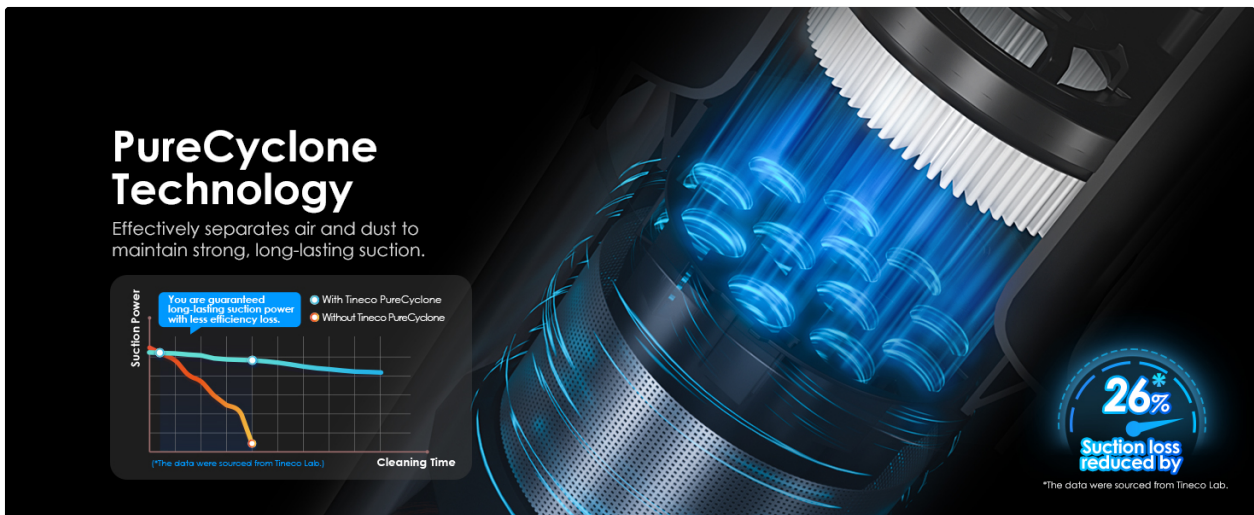

Figure 6.3: PureCyclone Technology maintains consistent suction power.

### 6.3 Cleaning the ZeroTangle Brush

Periodically inspect the ZeroTangle Brush for any accumulated debris. While designed to prevent tangles, occasional cleaning may be necessary.

1. Turn off the vacuum and detach the brush head.
2. Remove the brush roll from its housing.
3. Use scissors to cut away any stubborn hair or fibers.
4. Clean the brush roll and housing with a damp cloth if needed. Ensure all parts are dry before reassembly.

## 7. TROUBLESHOOTING

If you encounter issues with your Tineco Pure ONE S30, refer to the following common problems and solutions:

Problem	Possible Cause	Solution
---------	----------------	----------

Problem	Possible Cause	Solution
Vacuum does not turn on	Battery is not charged or not properly installed.	Ensure battery is fully charged and correctly inserted.
Reduced suction power	Dustbin is full, filters are clogged, or there is a blockage in the hose/brush head.	Empty dustbin, clean all filters, and check for/remove any blockages.
Brush roll not spinning	Hair or debris tangled in the brush roll, or brush head is not properly attached.	Clean the brush roll, remove any obstructions, and ensure the brush head is securely attached.
Short runtime	Battery not fully charged, or operating in Max mode continuously.	Ensure battery is fully charged. Use Eco mode for longer cleaning sessions.

## 8. SPECIFICATIONS

---

Key specifications for the Tineco Pure ONE S30 Cordless Vacuum Cleaner:

- **Brand:** Tineco
- **Model Name:** S Series-S30
- **Model Number:** Tineco Pure ONE S30
- **Power Source:** Battery Powered
- **Suction Power:** 150AW
- **Special Feature:** HEPA Filtration, ZeroTangle Brush
- **Filter Type:** HEPA Filter
- **Surface Recommendation:** Hard Floor, Carpet, Mattress, Pet Hair Removal, Stairs
- **Capacity:** 0.6 Liters (Dustbin)
- **Battery Life:** Up to 65 minutes (Eco Mode with 2-in-1 Crevice Brush)
- **Voltage:** 21.6 Volts
- **Item Weight:** 8.4 Pounds
- **Item Dimensions (L x W x H):** 28.98"L x 7.56"W x 13.98"H
- **Color:** Black
- **Manufacture Year:** 2025

## 9. WARRANTY AND SUPPORT

---

Tineco is committed to providing high-quality products and customer satisfaction. For any inquiries or support needs, please refer to the following:

### 9.1 Customer Support

Tineco offers a 24/7 Rapid Response Team to assist with any product-related questions or issues. You can contact them via hotline, email, or chat.

## 9.2 Protection Plans

Extended protection plans are available for your Tineco Pure ONE S30:

- **2-Year Protection Plan:** \$21.99 (one-time)
- **3-Year Protection Plan:** \$28.99 (one-time)
- **Complete Protect:** \$16.99 (monthly) - Covers all eligible past and future purchases.

For more information or to purchase a protection plan, please visit the official Tineco store or contact customer support.

For additional resources and product information, visit the [Tineco Store](#).