



Manuals.plus /

› SVHT /

› SVHT V15 Cordless Vacuum Cleaner User Manual

SVHT V15

SVHT V15 Cordless Vacuum Cleaner User Manual

Model: V15

INTRODUCTION

Thank you for choosing the SVHT V15 Cordless Vacuum Cleaner. This manual provides essential information for the safe and efficient use, maintenance, and troubleshooting of your new appliance. Please read it thoroughly before first use and retain it for future reference.

WHAT'S INCLUDED

Carefully unpack all components and ensure you have received the following items:

- Main Motor (with Canister, HEPA Filter, Stainless Steel Filter, Handle)
- 2 Extra HEPA Filters
- Battery
- Power Adapter
- 2-in-1 Brush
- Long Crevice Nozzle
- Motorized Brush Head with Anti-tangle Roller
- Telescopic Metal Tube
- Wall Mount & Screws
- 2-in-1 Cleaning Gadget
- User Manual



Image: All included components of the SVHT V15 Cordless Vacuum Cleaner.

SETUP

1. Assembly

1. **Attach the Telescopic Metal Tube:** Insert the telescopic metal tube into the main motor unit until it clicks securely into place.
2. **Attach the Motorized Brush Head:** Connect the motorized brush head to the other end of the

OPERATING INSTRUCTIONS

1. Power On/Off and Suction Modes

- **Power On:** Press the ON/OFF switch on the smart touch screen to start the vacuum.
- **Change Suction Mode:** Press the Speed Button on the smart touch screen to switch between two suction modes: ECO (up to 45 minutes runtime) and MAX (up to 20 minutes runtime).
- **Power Off:** Press the ON/OFF switch again to turn off the vacuum.

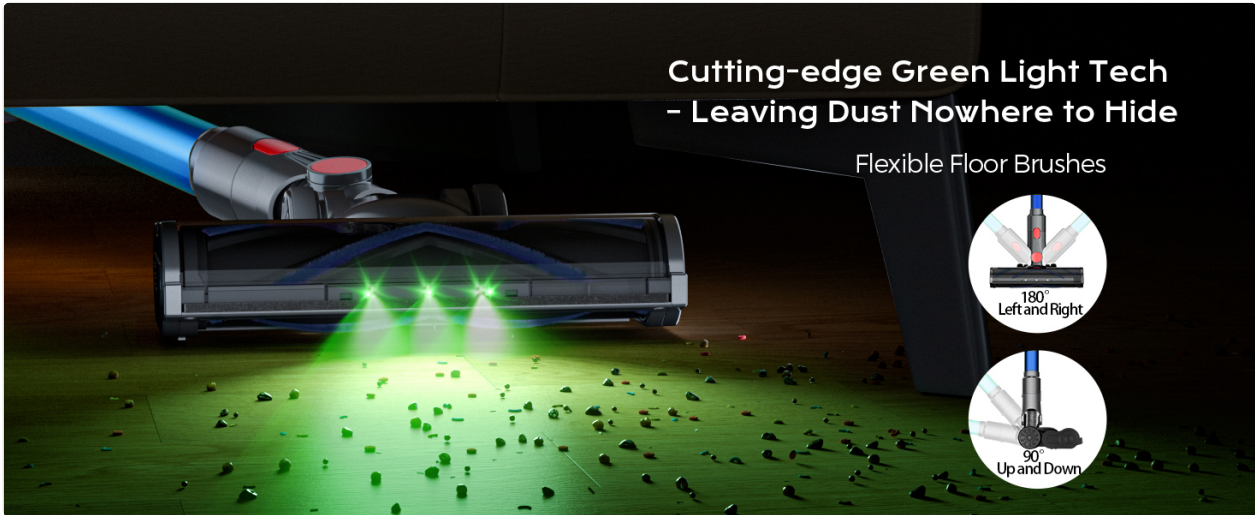

Image: Smart touch screen interface for controlling the vacuum.

2. Using the Green Light Technology

The motorized brush head features advanced green light technology. This light illuminates dust particles on hard floors, making hidden dirt visible for thorough cleaning.



Latest Green Light Technology - Spot the Hidden Dust

Image: Green light technology revealing dust on a hard floor.

3. Versatile Cleaning with Attachments

The SVHT V15 can be transformed into a handheld vacuum and used with various attachments for different cleaning tasks:

- **2-in-1 Brush:** Ideal for cleaning curtains, furniture, and soft furnishings.
- **Long Crevice Nozzle:** Suitable for reaching tight spaces, window sills, frames, and car interiors.
- **Motorized Brush Head:** Designed for carpets, rugs, and hard floors, featuring an anti-tangle V-shaped roller and soft-hard bristles.

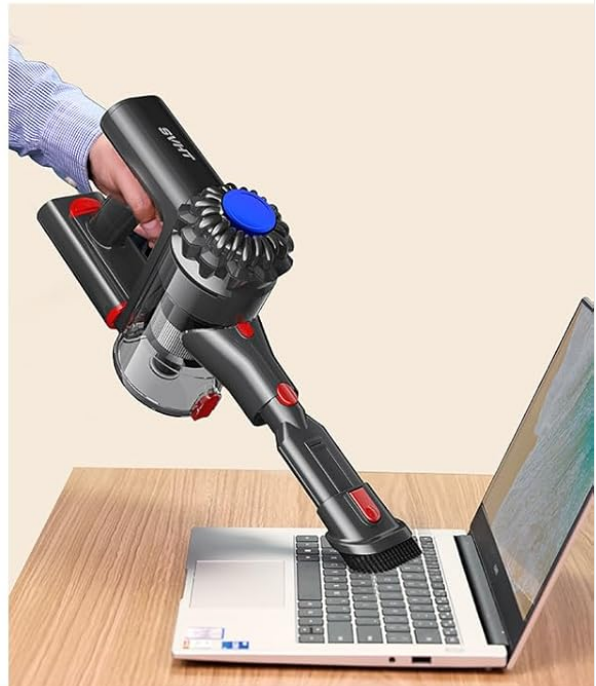

Meet Your All Cleaning Needs

Image: Demonstrating the versatility of the vacuum with different attachments for various cleaning tasks.

MAINTENANCE

Regular maintenance ensures optimal performance and extends the lifespan of your vacuum cleaner.

1. Emptying the Dustbin

The 1.5-liter dust cup should be emptied regularly, especially when full, to maintain suction power.

1. Disconnect the main motor unit from the telescopic tube if necessary.
2. Locate the quick-release button on the dustbin.

3. Press the button to open the dustbin flap and empty contents into a trash receptacle.

1.5L Large Dust Cup & One-touch Empty



Washable & Reusable Filter

Image: Emptying the dust cup and washing the filter.

2. Cleaning the Filters

The SVHT V15 features an 8-stage high-efficiency filtration system with reusable and washable HEPA filters. Cleaning the filters regularly is crucial to prevent weak suction and blockages.

1. Remove the dustbin from the main motor unit.
2. Carefully remove the HEPA filter and stainless steel filter from the dustbin.
3. Wash the strainer and HEPA filter with cool water. Do not use hot water or detergents.

4. Allow all filter components to air dry completely for at least 24 hours before reassembling. Ensure they are thoroughly dry to prevent damage to the motor.
5. Replace the HEPA filter if necessary (two extra filters are included).

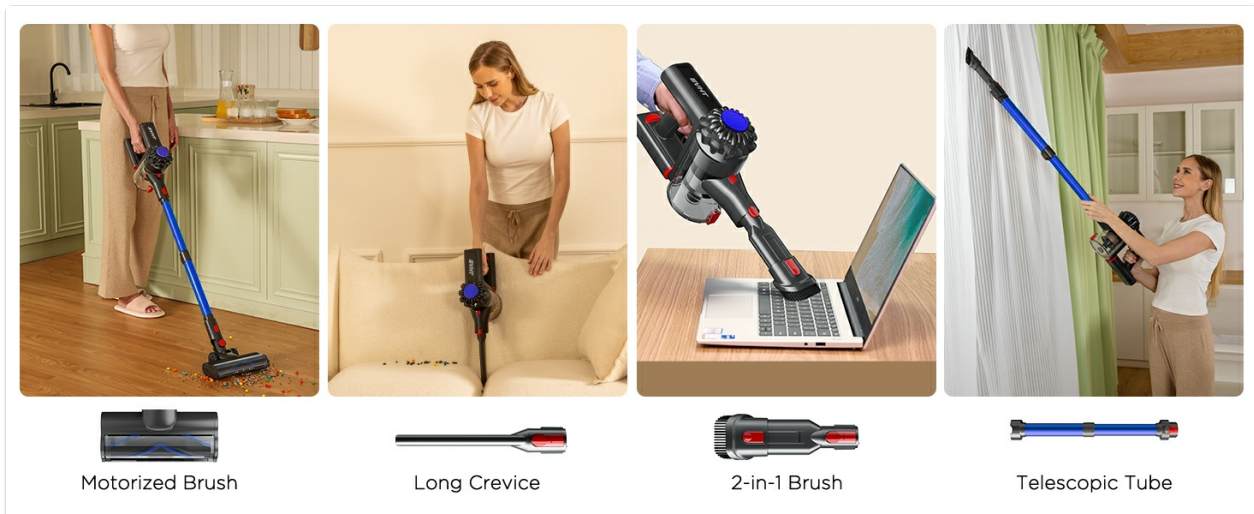

Image: Cleaning the filtration system components.

3. Cleaning the Motorized Brush Head

The anti-tangle V-shaped roller minimizes hair tangles, but occasional cleaning may be required.

1. Turn off the vacuum and disconnect it from any power source.
2. Detach the motorized brush head from the telescopic tube.
3. Use the included cleaning gadget to remove any tangled hair or debris from the roller brush.
4. Wipe the brush head with a dry cloth. Do not wash the motorized parts with water.

TROUBLESHOOTING

If you encounter issues with your SVHT V15 vacuum cleaner, refer to the following common problems and solutions:

Problem	Possible Cause	Solution
Weak Suction	<ul style="list-style-type: none"> • Dustbin is full. • Filters are dirty or clogged. • Blockage in the tube or brush head. 	<ul style="list-style-type: none"> • Empty the dustbin. • Clean or replace the HEPA and stainless steel filters. • Check for and remove any blockages in the telescopic tube or motorized brush head.
Vacuum Stops Working Suddenly	<ul style="list-style-type: none"> • Battery is depleted. • Blockage in the tube or brush head. • Overheating due to prolonged use or clogged filters. 	<ul style="list-style-type: none"> • Recharge the battery. • Check for and remove any blockages. • Turn off the vacuum and allow it to cool down for at least 30 minutes. Clean filters if necessary.
Battery Not Charging	<ul style="list-style-type: none"> • Power adapter not properly connected. • Power outlet is not working. • Damaged battery or adapter. 	<ul style="list-style-type: none"> • Ensure the power adapter is securely connected to both the battery/charging station and the outlet. • Test the power outlet with another device. • Contact customer support if the battery or adapter appears damaged.

SPECIFICATIONS

Feature	Detail
Brand	SVHT
Model Name	V15 Cordless Vacuum Cleaner
Suction Power	Up to 35Kpa (MAX mode)
Runtime	Up to 45 minutes (ECO mode), 20 minutes (MAX mode)
Battery Type	Lithium-Ion (12V, included)
Charging Time	4.5 Hours
Dust Cup Capacity	1.5 Liters
Filtration System	8-Stage High-Efficiency Filtration with Washable HEPA Filter
Special Features	Advanced Green Light Tech, Wider Motorized Brush, Anti-tangle V-shaped Roller, LED Touch Screen, Height Adjustable
Noise Level	≤ 65 Decibels
Weight	3 pounds (main body)
Product Dimensions	17.3"L x 10.6"W x 7.48"H
Wattage	400 watts

WARRANTY AND SUPPORT

SVHT provides comprehensive customer support for your V15 Cordless Vacuum Cleaner.

- **Warranty:** Your vacuum cleaner is backed by a 1-year warranty.
- **Technical Support:** Lifetime technical support is available.
- **Customer Service:** 24/7 after-sales service is provided for any inquiries or assistance you may need.

For support, please refer to the contact information provided in your product packaging or visit the official SVHT website.



Image: SVHT customer support details.