



Manuals.plus /

› GYVCBREU /

› GYVCBREU Car Radio for Toyota Tacoma 2016-2023 User Manual

## GYVCBREU B0F997G5D1

# GYVCBREU Car Radio for Toyota Tacoma 2016-2023 User Manual

Model: B0F997G5D1

## 1. INTRODUCTION

---

This manual provides detailed instructions for the installation, operation, and maintenance of your GYVCBREU Car Radio for Toyota Tacoma 2016-2023. Please read this manual thoroughly before using the product to ensure proper function and safety. Keep this manual for future reference.

## 2. PRODUCT OVERVIEW

---

The GYVCBREU Car Radio is an advanced infotainment system designed specifically for Toyota Tacoma models from 2016 to 2023. It features a 13.8-inch 2K display, Android 13 operating system, 8GB RAM, 128GB ROM, wireless CarPlay, Android Auto, GPS navigation, Wi-Fi, Bluetooth 5.0, FM/AM radio, and supports OEM camera and steering wheel controls.



Image: The GYVCBREU Car Radio with its large 13.8-inch screen integrated into a Toyota Tacoma dashboard, showing the user interface.

### 3. SPECIFICATIONS

---

Feature	Detail
Operating System	Android 13
Processor	8-Core Qualcomm CPU
Memory (RAM)	8GB
Storage (ROM)	128GB
Display Size	13.8 Inches
Display Resolution	1920x1440 (2K) HD IPS Touchscreen
Connectivity	Wi-Fi, 4G Module Support, Bluetooth 5.0
Navigation	GPS (Online/Offline Maps)
Audio Features	AM/FM/RDS Radio, 48-Band EQ, Subwoofer Support, Built-in HiFi, DSP
Integration	Wireless CarPlay, Android Auto, OEM Camera Support, Steering Wheel Control (SWC)
Vehicle Service Type	Car (Toyota Tacoma 2016-2023)
Item Weight	2 pounds
Package Dimensions	15 x 15 x 5 inches

## 4. SETUP AND INSTALLATION

---

The GYVCBREU Car Radio is designed for plug-and-play installation in compatible Toyota Tacoma models (2016-2023). While the kit includes necessary components, professional installation is recommended if you are unfamiliar with car audio systems.

### 4.1 Compatibility Check

Before installation, ensure your vehicle is a Toyota Tacoma model year 2016-2023. If unsure, compare your car's central control panel with the images provided or contact customer support with a photo of your dashboard.

# Toyota Tacoma 2016-2023



Image: Comparison of a Toyota Tacoma dashboard before and after the GYVCBREU Car Radio installation, showing the integrated large screen.

## 4.2 Basic Installation Steps (General Guide)

1. **Disconnect Battery:** Always disconnect the vehicle's negative battery terminal before starting any electrical work.
2. **Remove Old Unit:** Carefully remove the existing car radio and trim panels. Refer to your vehicle's service manual for specific instructions.
3. **Connect Wiring Harness:** Connect the provided wiring harness to your vehicle's existing wiring. Ensure all connections are secure.
4. **Install GPS Antenna:** Mount the GPS antenna in a location with a clear view of the sky, typically on the dashboard or under the windshield.
5. **Connect USB/Auxiliary Cables:** Route any USB or auxiliary input cables to a convenient location within the cabin.
6. **Mount New Unit:** Secure the GYVCBREU Car Radio into the dashboard opening.
7. **Reconnect Battery:** Reconnect the negative battery terminal.

8. **Test Functionality:** Power on the unit and test all functions (radio, navigation, Bluetooth, etc.).

## 5. OPERATING INSTRUCTIONS

---

### 5.1 Power On/Off

The unit powers on automatically with the vehicle's ignition. To manually power off or restart, press and hold the power button (if available) or use the system settings menu.

### 5.2 Touchscreen Navigation

The 13.8-inch HD IPS touchscreen supports multi-touch gestures. Swipe left/right to navigate between home screens, tap icons to launch applications, and use pinch-to-zoom for maps.



Image: Visual comparison highlighting the clarity of the 1920x1440 HD IPS touchscreen versus a 1080p display.

### 5.3 Wireless CarPlay & Android Auto

Connect your smartphone wirelessly for seamless integration of CarPlay or Android Auto. This allows access to navigation, music, calls, and messages directly from the car radio display.

1. **Enable Bluetooth & Wi-Fi:** On your smartphone, ensure Bluetooth and Wi-Fi are enabled.
2. **Pair Device:** On the car radio, go to Bluetooth settings and pair with your phone.
3. **Launch Car Auto App:** Open the "Car Auto" application on the car radio.
4. **Connect:** Follow the on-screen prompts to connect to CarPlay or Android Auto.

# Wireless Carplay & Android Auto



Image: The car radio screen displaying the Wireless CarPlay and Android Auto interfaces, showing smartphone integration.

Your browser does not support the video tag.

Video: Demonstration of connecting a smartphone to the car radio for CarPlay functionality, showing the steps to pair via Bluetooth and launch the Car Auto app.

## 5.4 GPS Navigation

The unit supports online and offline GPS navigation. Pre-installed map applications are available, and you can download others from the Play Store. Real-time traffic updates are available with an internet connection.



Image: The car radio displaying a detailed GPS navigation map with route information.

## 5.5 Bluetooth 5.0

Connect your phone via Bluetooth for hands-free calling and audio streaming. Access your phone's contacts and call history directly from the car radio.

# Bluetooth Built-in upgraded Bluetooth 5.0 for clearer hands-free calls and musics



## AM/FM/RDS Radio High-quality audio encoding capability multi-channel support, and surround sound experience the concert hall.



Image: The car radio screen showing Bluetooth connectivity for hands-free calls and music playback.

### 5.6 Audio Features (FM/AM/RDS, DSP, EQ)

Tune into FM/AM radio stations with RDS support. Utilize the built-in Digital Sound Processor (DSP) and 48-band equalizer to customize your audio experience. The system supports subwoofer output and Hi-Fi audio.

## Support OEM Camera

The night images are still bright and clear making reversing safer.



Waterproof



Night vision



HD Image



170°  
Viewing angle

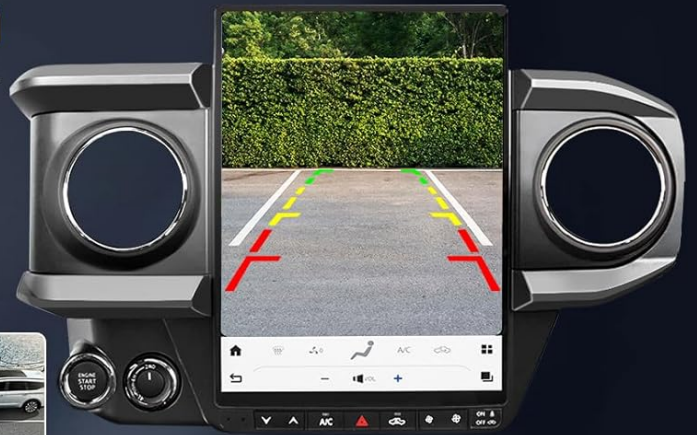

Front 170°

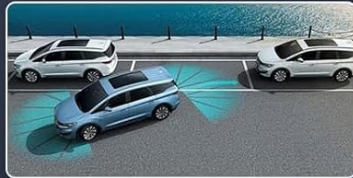

## Steering Wheel Control

Compatible with steering wheel control functions Easily switch songs channels and adjust volume



Image: The car radio displaying the FM/AM/RDS radio interface and the DSP sound effect settings with equalizer adjustments.

### 5.7 Steering Wheel Control (SWC)

The unit supports your vehicle's original steering wheel controls. This allows you to adjust volume, change tracks, and answer calls without taking your hands off the wheel. Configuration may be required in the system settings.

## Split Screen Display & Full Screen

Screens are displayed at the same time  
Synchronize entertainment and map usage

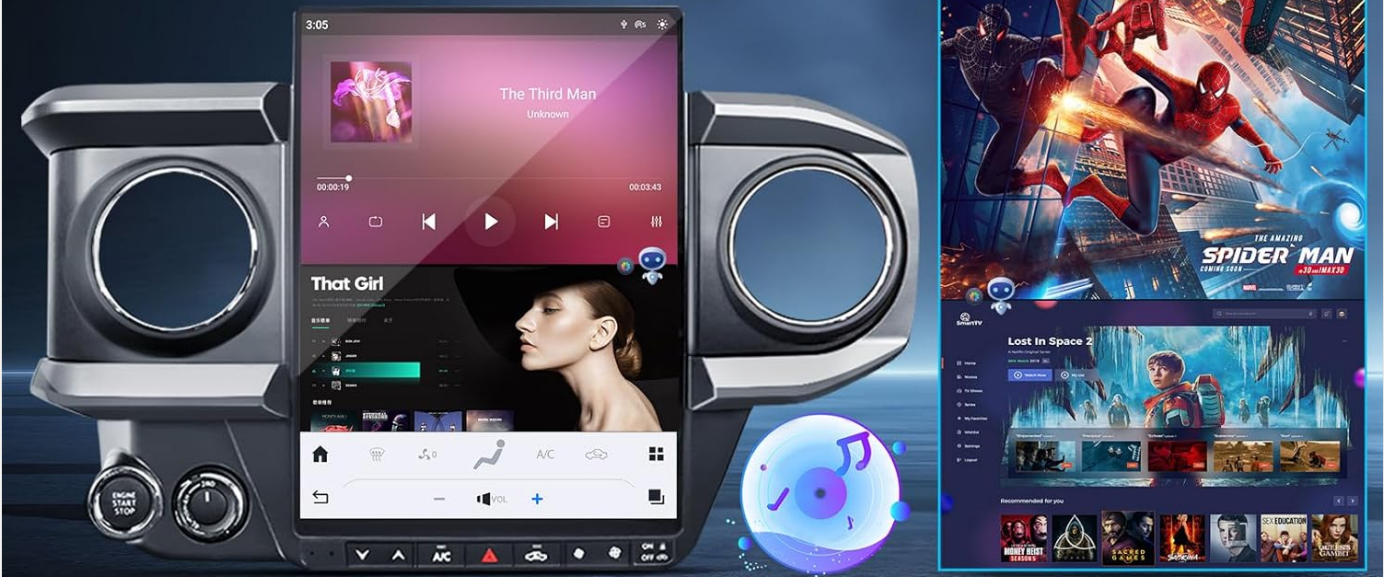

## Professional DSP Sound

The overall sound is full and bright. It's like a concert!

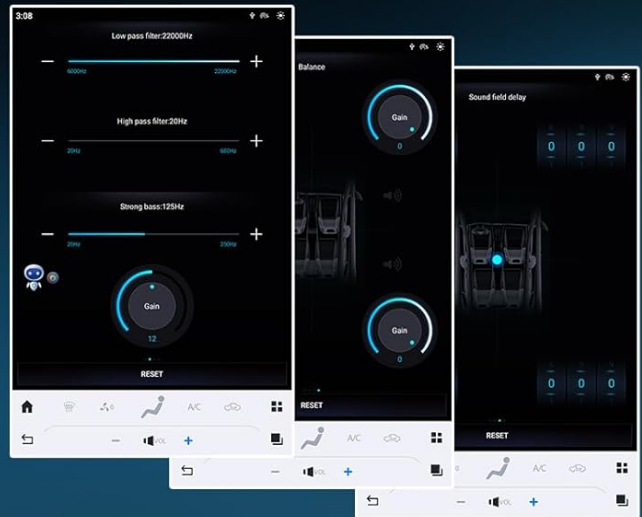

Image: The car radio screen showing the interface for configuring steering wheel controls, with a view of a steering wheel.

## 5.8 OEM Camera Support

The car radio integrates with your vehicle's original OEM camera, providing a clear view for safer parking and reversing, even in low-light conditions.

# 1920x1440 HD IPS Touchscreen

High-definition picture quality for all



Image: The car radio screen displaying the view from an OEM camera, showing parking guidelines.

## 5.9 Split Screen Display

Utilize the split-screen feature to run two applications simultaneously, such as navigation and music playback, enhancing multitasking capabilities.

# More Multimedia Features



Android 13.0



8G+128GB  
Qualcomm Chip



GPS navigation



Bluetooth 5.0

Support OEM Camera



Image: The car radio screen demonstrating the split-screen functionality, with a navigation app on one side and a media player on the other.

## 6. MAINTENANCE

- **Screen Cleaning:** Use a soft, lint-free cloth to clean the touchscreen. For stubborn smudges, lightly dampen the cloth with water or a screen-safe cleaner. Avoid harsh chemicals.
- **Software Updates:** Periodically check for system software updates through the device settings to ensure optimal performance and access to new features.
- **Avoid Extreme Temperatures:** Do not expose the unit to extreme temperatures for prolonged periods, as this can affect performance and lifespan.
- **Cable Connections:** Ensure all cables remain securely connected. Loose connections can lead to intermittent issues.

## 7. TROUBLESHOOTING

Problem	Possible Cause	Solution
Unit does not power on.	Loose power connection, blown fuse, vehicle battery issue.	Check power cables and fuses. Ensure vehicle battery is charged. Consult a professional if issues persist.
No sound from speakers.	Volume too low, mute activated, incorrect audio source, loose speaker wires.	Increase volume, check mute status, select correct audio source. Verify speaker connections.
GPS signal lost or inaccurate.	Antenna obstruction, poor satellite reception, outdated maps.	Ensure GPS antenna has a clear view of the sky. Update map data.
Bluetooth connection issues.	Device not paired, Bluetooth off on phone/unit, interference.	Ensure Bluetooth is enabled on both devices and paired correctly. Restart both devices.
CarPlay/Android Auto not connecting.	Incorrect setup, phone compatibility, app issues.	Verify all steps in section 5.3. Ensure phone OS is up-to-date. Try restarting the "Car Auto" app.
Touchscreen unresponsive.	Temporary software glitch, screen damage.	Restart the unit. If the problem persists, contact customer support.

## 8. WARRANTY AND SUPPORT

Your GYVCBREU Car Radio comes with a **12-month warranty policy** and **lifetime technical support**. Additionally, a **30-day money-back guarantee** is provided.

For any assistance with assembly, operation, or other issues, please reach out to our professional technical team. You can contact the seller, AUTOPARTS-999, directly through the Amazon platform by visiting their storefront and using the "Ask a question" feature.

### 24 hours technical support

#### STEP 1

#### STEP 2

Add to Cart

Buy Now

Ships from Amazon

Sold by AUTOPARTS-999

Returns

Payment

AUTOPARTS-999

Visit the AUTOPARTS-999 storefront

★★★★★ | 100% positive lifetime (1 total ratings)

---

**About Seller**

AUTOPARTS-999 is committed to providing each customer with the highest standard of customer service.

Have a question for AUTOPARTS-999?

Ask a question

If you need any help for installing the Car stereo Please follow step1 & step2. Leave your questions through the above path in Amazon. Then we can receive your problem. We will get back to you soon.

Image: Visual guide on how to contact the seller, AUTOPARTS-999, for technical support via Amazon.