

Phomemo M832

Phomemo M832 Bluetooth Inkless Portable Printer User Manual

Model: M832

1. PRODUCT OVERVIEW

The Phomemo M832 is a compact, inkless thermal printer designed for portable document printing. It utilizes advanced thermal technology, eliminating the need for ink cartridges or toner, making it an economical and convenient solution for various printing needs. With Bluetooth connectivity, it seamlessly integrates with mobile devices, while USB connectivity supports laptops and PCs.

Key features include support for multiple paper sizes, a built-in rechargeable battery, and a user-friendly application for efficient document management and printing.



Image: The Phomemo M832 portable printer actively printing a document, showcasing its compact design and output.



Image: A visual representation of the Phomemo M832's key features, including portability, Bluetooth connectivity, 300dpi resolution, multiple device support, and various paper sizes.

2. PACKAGE CONTENTS

Please verify that all items are present in the package:

- Phomemo M832 Portable Thermal Printer
- USB Charging Cable
- Thermal Printer Paper (100 sheets, 8.5 x 11 inch)
- User Manual (this document)

3. DEVICE LAYOUT AND COMPONENTS

Familiarize yourself with the physical components of your Phomemo M832 printer:

- **Power Button:** Located on the top surface, used to turn the printer on/off.
- **Paper Input Slot:** The opening where thermal paper is fed into the printer.
- **USB-C Port:** For charging and wired connection to computers.
- **Indicator Light:** Displays printer status (e.g., power on, charging, error).

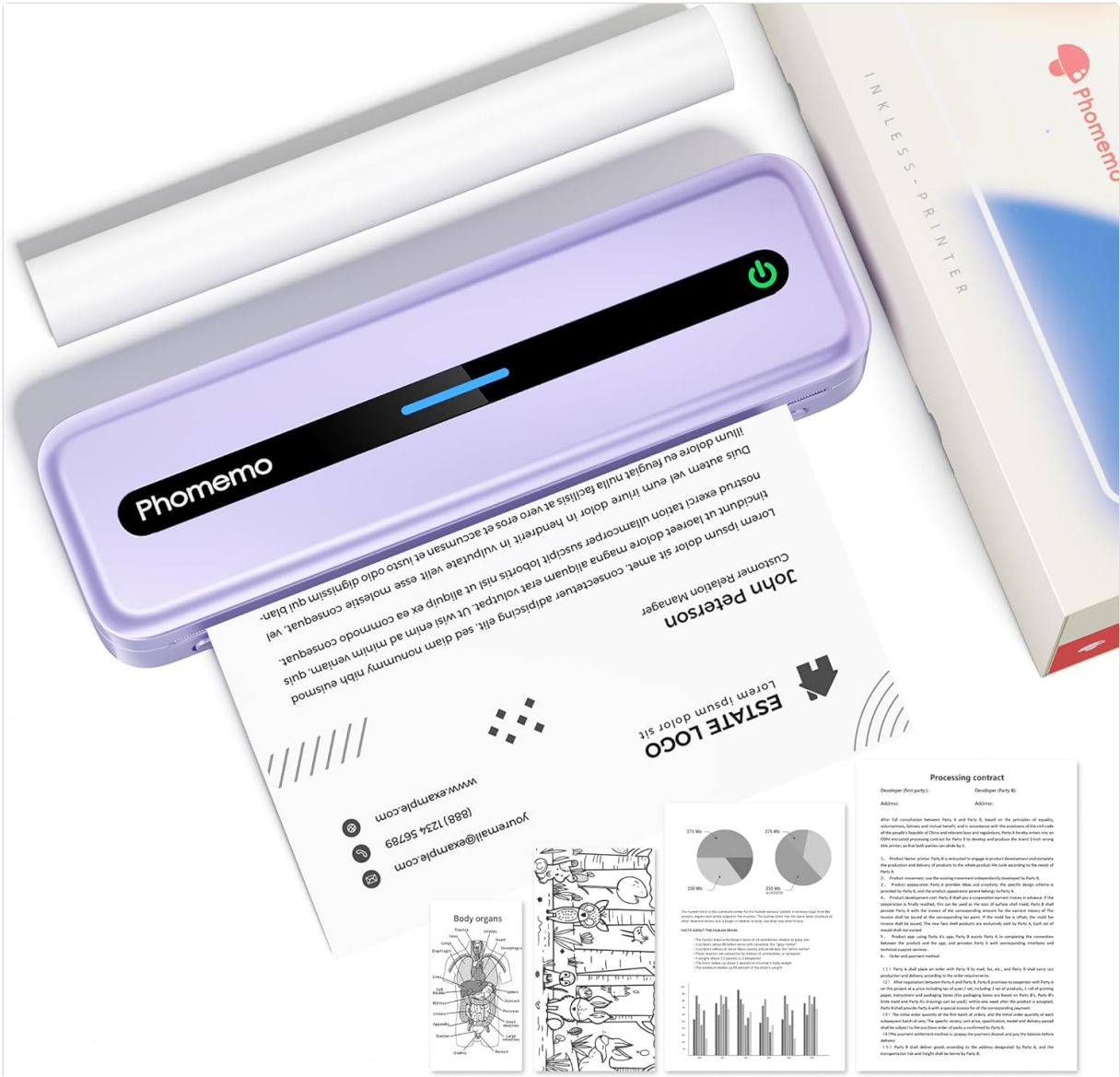

Image: A detailed view of the Phomemo M832 printer, showing the paper output and the power button with an illuminated indicator light.

4. INITIAL SETUP

4.1 Charging the Printer

1. Connect the provided USB charging cable to the printer's USB-C port.
2. Plug the other end of the cable into a compatible USB power adapter (not included) or a computer's USB port.
3. The indicator light will show charging status. A full charge typically takes several hours.

4.2 Loading Thermal Paper

Ensure you use Phomemo-compatible thermal paper for optimal results. The M832 supports various sizes, including 8.5 x 11 inch US Letter.

1. Gently open the paper cover of the printer.
2. Insert the thermal paper into the input slot, ensuring the printable side (usually smoother and brighter) faces the print head.
3. Adjust the paper guides to fit the width of the paper snugly.
4. Close the paper cover securely.

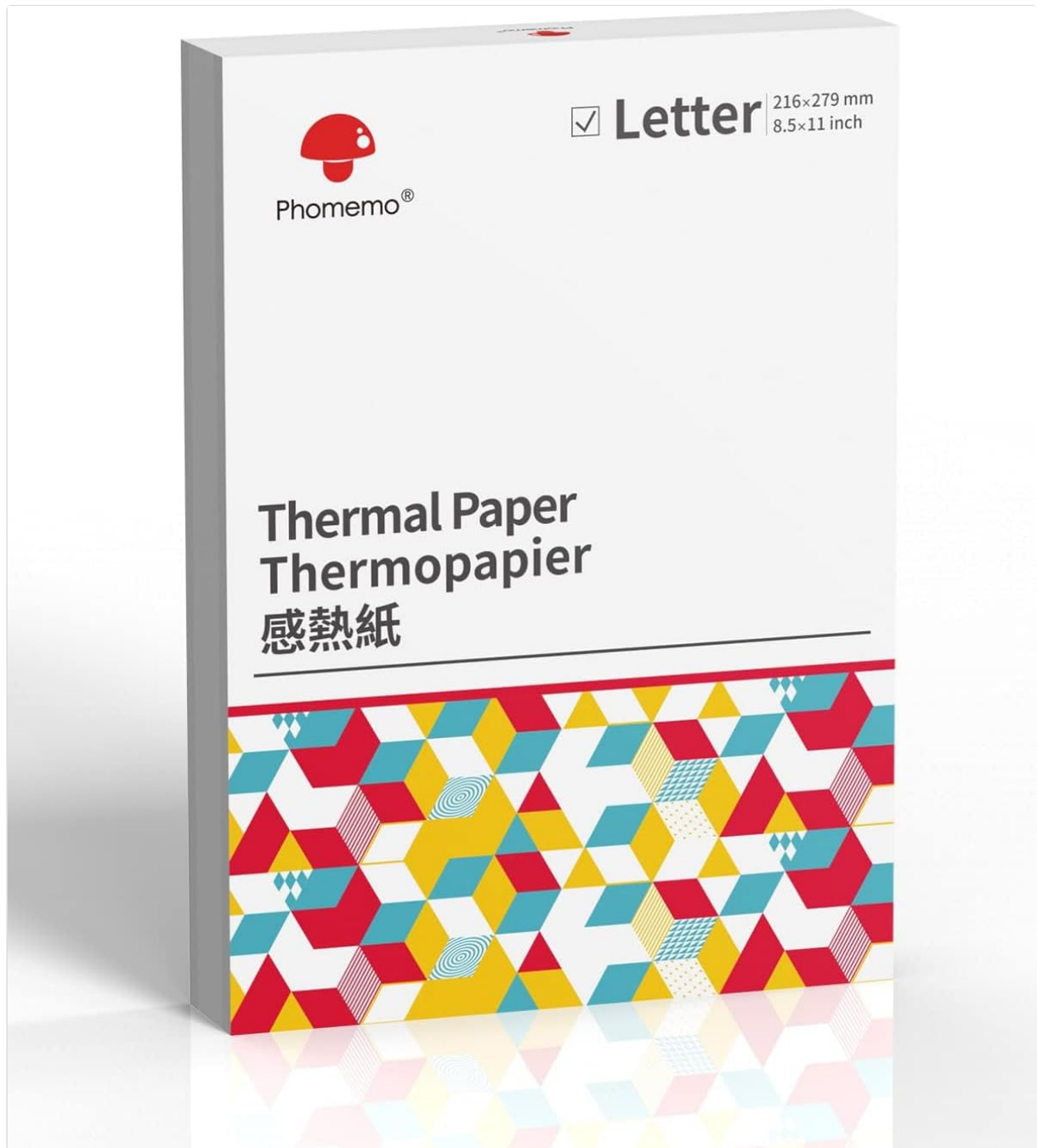

Image: A box of Phomemo thermal paper, indicating its compatibility with the printer.

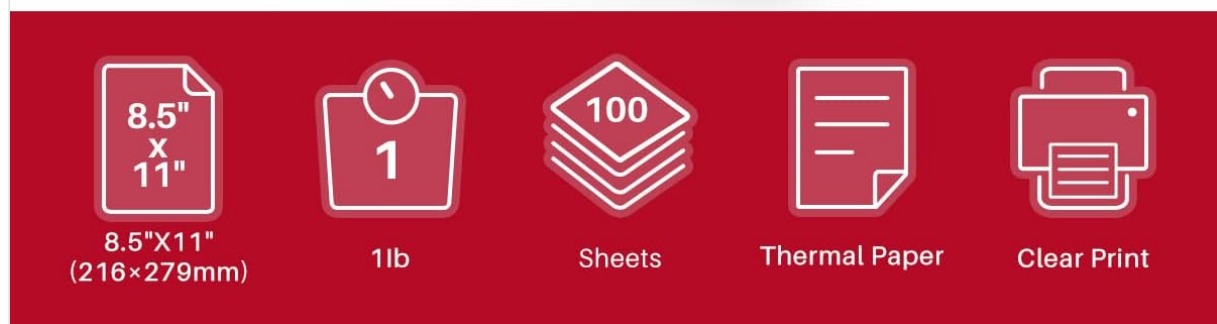

Image: The Phomemo thermal paper box, detailing its specifications including 8.5" x 11" size and quantity of 100 sheets.

4.3 App Installation

1. Download the official "Phomemo" application from your device's app store (Google Play Store for Android or Apple App Store for iOS).
2. Install the application on your smartphone or tablet.

4.4 Bluetooth Connection (for Mobile Devices)

1. Ensure the Phomemo M832 printer is powered on.
2. Enable Bluetooth on your smartphone or tablet.
3. Open the "Phomemo" app.
4. Within the app, tap the 'Printer' icon or navigate to the device connection settings.
5. Select the M832 from the list of available devices to pair. The app will confirm a successful connection.

4.5 USB Connection (for Laptops/PCs)

1. Ensure the Phomemo M832 printer is powered on.
2. Connect the printer to your computer using the provided USB cable.
3. Your computer may automatically install necessary drivers. If not, visit the Phomemo official website for driver downloads.
4. The printer will appear as an available printing device in your computer's print settings.

Expand Print Horizons Multi-Scenario Excellence

Support **5 Sizes** Thermal Paper
(8.5"x11", A4, 4.33", 3.14" and 2.08")



Bluetooth Connect for Mobile Device



Image: The Phomemo M832 printer demonstrating its versatility by being connected to both a laptop via USB and a mobile phone via Bluetooth.

Connectivity Unleashed

Seamless Integration for Every Device



Bluetooth Connection



iOS



Android



Tablet



USB Connection



Mac OS



Windows



Chromebook



Linux

Image: An illustration detailing the Phomemo M832's connectivity options, including Bluetooth for iOS, Android, and tablets, and USB for Mac OS, Windows, Chromebook, and Linux.

5. OPERATION

5.1 Printing from the Phomemo App

1. Ensure your printer is connected via Bluetooth (refer to Section 4.4).
2. Open the Phomemo app and select the document or image you wish to print.
3. Adjust print settings such as paper size (e.g., 8.5" x 11", A4, 4.33", 3.14", 2.08"), orientation, and density as needed.
4. Tap the 'Print' button to initiate printing.

5.2 Printing from a Computer

1. Ensure your printer is connected via USB (refer to Section 4.5).
2. Open the document or file you wish to print on your computer.
3. Select 'Print' from the application's menu (e.g., File > Print).
4. Choose the Phomemo M832 from the list of available printers.
5. Adjust print preferences (paper size, quality) as required and click 'Print'.



Image: A hand writing on a document printed with the Phomemo M832, illustrating the quick-dry nature of thermal prints.

6. MAINTENANCE

6.1 Cleaning the Print Head

To maintain print quality, clean the print head periodically:

1. Turn off the printer and disconnect it from power.
2. Open the paper cover.
3. Gently wipe the print head with a cotton swab lightly dampened with isopropyl alcohol.
4. Allow the print head to dry completely before closing the cover and using the printer.

6.2 Paper Handling and Storage

- Use only high-quality thermal paper compatible with the Phomemo M832.
- Store thermal paper in a cool, dry place away from direct sunlight and heat to prevent premature fading.
- Avoid creasing or damaging the paper before printing.

6.3 Battery Care

- Charge the printer regularly, even if not in frequent use, to maintain battery health.
- Avoid fully discharging the battery frequently.
- Do not expose the printer to extreme temperatures.

7. TROUBLESHOOTING

If you encounter issues with your Phomemo M832 printer, refer to the following common problems and solutions:

Problem	Possible Cause	Solution
Printer does not turn on	Low battery; Power button not pressed correctly	Charge the printer; Press and hold the power button for a few seconds
Cannot connect via Bluetooth	Bluetooth off; Printer not in pairing mode; App issue	Ensure Bluetooth is enabled on both devices; Restart printer and app; Re-pair device in app
Poor print quality	Dirty print head; Incorrect paper type; Low battery	Clean the print head (Section 6.1); Use Phomemo thermal paper; Charge the printer
Paper jam	Improper paper loading; Damaged paper	Turn off printer, carefully remove jammed paper; Reload paper correctly (Section 4.2)
Printer not recognized by PC	Missing drivers; Faulty USB cable	Install drivers from Phomemo website; Try a different USB cable or port

If the problem persists, please contact Phomemo customer support for further assistance.

8. SPECIFICATIONS

- **Model:** M832
- **Printing Technology:** Direct Thermal
- **Connectivity:** Bluetooth, USB
- **Battery:** Built-in 2600 mAh rechargeable battery
- **Ink/Toner:** Not required (Inkless)

- ## 9. WARRANTY AND SUPPORT

For technical support, troubleshooting assistance, or warranty claims, please contact Phomemo customer service through their official website or the contact information provided in the Phomemo app.

Related Documents - M832

Information and usage tips for the Phomemo M832 A4 Portable Thermal Printer by Zoolion, including setup instructions and troubleshooting advice.

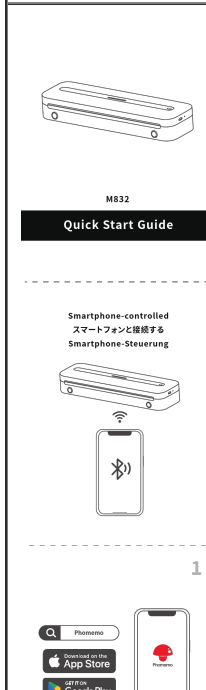

User guide for the Phomemo M832 portable thermal printer, covering package contents, printer components, precautions, app installation, printing instructions, paper types, warranty, and FCC/IC compliance.

A concise guide to setting up and using the Phomemo M832 printer with both computer and smartphone connections, including driver installation, paper loading, and Bluetooth pairing.



English Get/Install the Phomemo App.
日本語 Phomemoアプリをインストールする
Deutsch Holen/Installieren Sie die Phomemo App.

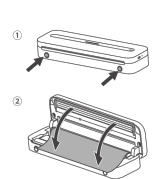

English Follow the steps to load the paper roll properly.
日本語 手順に従って紙ロールを正しくセットしてください。
Deutsch Folgen Sie den Schritten, um die Papierrolle ordnungsgemäß zu laden.

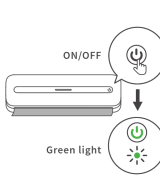

English Press and hold for 3s to turn on the M832 printer.
日本語 3秒も長押しするとM832起動できる
Deutsch Halten Sie 3 Sekunden lang gedrückt, um den M832 Drucker einzuschalten.

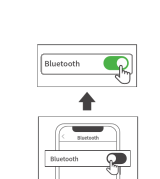

English Turn on Bluetooth from phone settings.
日本語 スマートフォンの設定からBluetoothをオンにする
Deutsch Aktivieren Sie Bluetooth über die Telefoneneinstellungen.

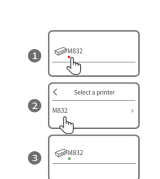

English Connect the printer via Bluetooth in the Phomemo App.
日本語 PhomemoアプリでBluetoothを利用してM832に接続する
Deutsch Verbinden Sie den Drucker über Bluetooth in der Phomemo App.



English Select the file in the Phomemo App to print.
日本語 Phomemoアプリでファイルを選択して印刷する
Deutsch Wählen Sie die zu druckende Datei in der Phomemo App aus.

FCC Warning

This device complies with part 15 of the FCC Rules. Operation is subject to the following two conditions: (1) This device may not cause harmful interference, and (2) this device must accept any interference received, including interference that may cause undesired operation.

Any changes or modifications not expressly approved by the party responsible for compliance could void the user's authority to operate the equipment.

This equipment has been tested and found to comply with the limits for a Class B digital device, pursuant to part 15 of the FCC Rules. These limits are designed to provide reasonable protection against harmful interference in a residential installation. This equipment generates and can radiate radio frequency energy and, if not installed and used in accordance with the instructions, may cause harmful interference to radio communications. However, there is no guarantee that interference will not occur in a particular installation. If this equipment does cause harmful interference to radio communications, which can be determined by turning the equipment off and on, the user is encouraged to try to correct the interference by one of the following measures:

- Reorient or relocate the receiving antenna.
- Increase the separation between the equipment and receiver.
- Connect the equipment to an outlet on a circuit different from that to which the receiver is connected.
- Consult the dealer or an experienced radio/TV technician for help.

The device has been evaluated for most general RF exposure requirements. The device can be used at portable exposure conditions without limitations.

IC Warning

IC Notice:
Radio Standard Specification RSS-Gen, Issue 5 (English)
This device complies with the Canadian Interference-Suppression (CIS) requirements for Class B digital devices. It is designed to minimize interference to radio communications. However, there is no guarantee that interference will not occur in a particular installation. If this equipment does cause harmful interference to radio communications, which can be determined by turning the equipment off and on, the user is encouraged to try to correct the interference by one of the following measures:

- Reorient or relocate the receiving antenna.
- Increase the separation between the equipment and receiver.
- Connect the equipment to an outlet on a circuit different from that to which the receiver is connected.
- Consult the dealer or an experienced radio/TV technician for help.

The device has been evaluated for most general RF exposure requirements. The device can be used at portable exposure conditions without limitations.

Support a 3rd party repair program for portable equipment (dismantling and repair) if supported and the repair is done under the conditions of the program.

Support a 3rd party repair program for portable equipment (dismantling and repair) if supported and the repair is done under the conditions of the program.

Support a 3rd party repair program for portable equipment (dismantling and repair) if supported and the repair is done under the conditions of the program.

Support a 3rd party repair program for portable equipment (dismantling and repair) if supported and the repair is done under the conditions of the program.

Support a 3rd party repair program for portable equipment (dismantling and repair) if supported and the repair is done under the conditions of the program.

Support a 3rd party repair program for portable equipment (dismantling and repair) if supported and the repair is done under the conditions of the program.

Support a 3rd party repair program for portable equipment (dismantling and repair) if supported and the repair is done under the conditions of the program.

Support a 3rd party repair program for portable equipment (dismantling and repair) if supported and the repair is done under the conditions of the program.

Support a 3rd party repair program for portable equipment (dismantling and repair) if supported and the repair is done under the conditions of the program.

Support a 3rd party repair program for portable equipment (dismantling and repair) if supported and the repair is done under the conditions of the program.

Support a 3rd party repair program for portable equipment (dismantling and repair) if supported and the repair is done under the conditions of the program.

Support a 3rd party repair program for portable equipment (dismantling and repair) if supported and the repair is done under the conditions of the program.

Support a 3rd party repair program for portable equipment (dismantling and repair) if supported and the repair is done under the conditions of the program.

Computer Printing with Data Cable
データケーブルを使用したコンピュータ印刷
Computerdruck mit Datenkabel



Phomemo M832 Quick Start Guide: Smartphone and Computer Printing

A concise guide to setting up and using the Phomemo M832 printer for both smartphone and computer printing. Learn how to connect via Bluetooth, load paper, install drivers, and print various file types.

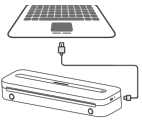

1



English Open the link: M832.phonemo.com
日本語 リンクも開きます : M832.phonemo.com
Deutsch Öffnen Sie den Link: M832.phonemo.com

2



English Download the corresponding drive for your computer system.
日本語 コンピュータシステム向けのドライバをダウンロードします
Deutsch Laden Sie das entsprechende Laufwerk für Ihr Computersystem herunter.

3



English Follow the above instructions to install the driver.
日本語 上記の手順でドライバーをインストールしてください
Deutsch Folgen Sie den obigen Anweisungen, um den Treiber zu installieren.

4

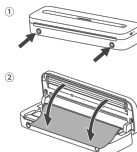

English Follow the steps to load the paper roll properly.
日本語 手順に従って紙ロールを正しくセットしてください
Deutsch Folgen Sie den Schritten, um die Papierrolle ordnungsgemäß zu laden.

5

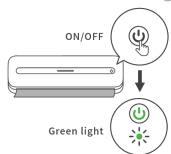

English Press and hold for 3s to turn on the M832 printer.
日本語 3秒を長押しすると、M832起動できる
Deutsch Halten Sie 3 Sekunden lang gedrückt, um den M832-Drucker einzuschalten.

6

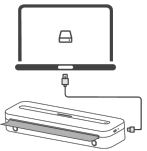

English Connect the printer to your computer with a Type-C data cable.
日本語 Type-Cケーブルを使用してプリンターをコンピュータに接続します
Deutsch Schließen Sie den Drucker mit einem Type-C-Datenkabel an Ihren Computer an.

7



English Right-click the file and click the print button.
日本語 ファイルを右クリックして、印刷ボタンをクリックします
Deutsch Klicken Sie mit der rechten Maustaste auf die Datei und klicken Sie auf die Schaltfläche „Drucken“.

8



12. Warranty Card			
<input type="checkbox"/> Return	<input type="checkbox"/> Exchange	<input type="checkbox"/> Repair	
User Info	Name	Gender	Phone
	Address		
Product Info	Purchase date		
	Product order number		
Reasons for return (Please explain)	Product serial Number		
	Reason description		
Maintenance records	Failure conditions		Maintenance person
	Handling charges		Delivery date
	Maintenance cost (in yuan)		

Download the driver from the driver download website to print via USB connection (Bluetooth driver printing is not supported at present)
 Driver download URL are as follows: <http://www.brother.com>

A comprehensive troubleshooting guide for Phomemo A281M, A282M, and A285M thermal printers, covering product information, usage, common machine and connection issues, printing problems, and app-related questions.