



[Manuals.plus](#) /

› [Aoxun](#) /

› AOXUN 10x12 Outdoor Patio Gazebo Instruction Manual

Aoxun 10x12 Outdoor Patio Gazebo

AOXUN 10x12 Outdoor Patio Gazebo Instruction Manual

Model: 10x12 Outdoor Patio Gazebo

1. INTRODUCTION

This manual provides detailed instructions for the assembly, operation, maintenance, and troubleshooting of your AOXUN 10x12 Outdoor Patio Gazebo. Please read this manual thoroughly before assembly and retain it for future reference.



Image 1: AOXUN 10x12 Outdoor Patio Gazebo in a backyard setting.

2. IMPORTANT SAFETY INFORMATION

WARNING: Failure to follow these safety instructions may result in injury or damage to the product.

- Always secure the gazebo to a stable foundation using the provided windproof ropes and expansion bolts. This is especially critical during windy conditions.
- Do not leave the gazebo erected during heavy rain, strong winds, or storms. Disassemble or properly secure the canopy and curtains to prevent damage.
- Always follow the assembly and disassembly instructions carefully to avoid potential hazards.
- Ensure all connections are tight and secure before and during use. Regularly inspect the structure for any signs of wear or damage.
- Keep children and pets away from the assembly area during installation.

3. PACKAGE CONTENTS

Before beginning assembly, verify that all parts are present and undamaged. If any parts are missing or damaged, contact customer support.

- Steel Frame Components (legs, beams, roof supports)
- Main Canopy Fabric
- Upper Roof Canopy Fabric
- Mosquito Netting (with zippers)
- Privacy Curtains (with zippers)
- Anchoring Hardware (expansion bolts, windproof ropes, stakes)
- Assembly Tools (e.g., Allen wrench)
- Instruction Manual

4. ASSEMBLY INSTRUCTIONS

Assembly typically requires two or more people. Follow the numbered steps provided in the included detailed assembly guide. Ensure you have adequate space and a level surface for assembly.

4.1 Frame Assembly

Begin by assembling the main support frame. Connect the leg posts to the base plates and then attach the horizontal beams. Ensure all bolts are finger-tight initially, then fully tighten once the frame is stable.



Image 2: Wind Resistance Installation Options for securing the gazebo frame.

4.2 Roof and Canopy Installation

Attach the roof support structure to the main frame. Carefully drape the main canopy fabric over the roof structure, ensuring it is centered and taut. Secure the upper roof canopy over the main canopy, aligning it with the ventilation opening.



Image 3: Ventilated Double-Roof with Netting for air circulation and insect protection.

4.3 Netting and Curtain Attachment

Hang the mosquito netting and privacy curtains from the designated tracks on the frame. Ensure the zippers are functional and the netting/curtains can move freely along the tracks.

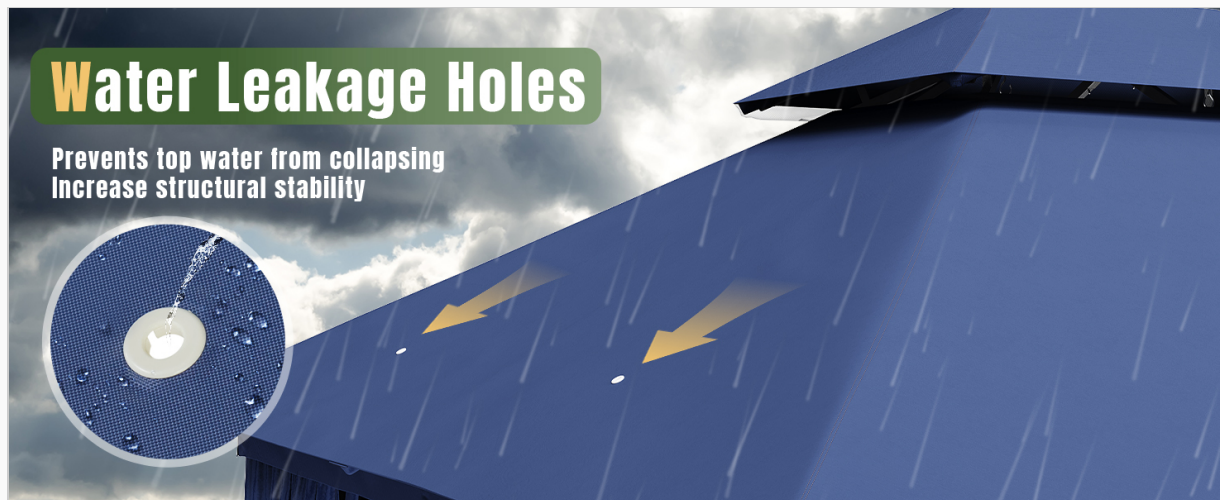

Image 4: Double Track Design for independent curtain and netting adjustment.

4.4 Anchoring the Gazebo

Once the gazebo is fully assembled, anchor it securely to the ground. Use the provided windproof ropes and stakes for soft ground, or expansion bolts for concrete surfaces. Proper anchoring is essential for stability and safety.



Wind-resistant Ropes
Make your gazebo more stable

Image 5: Wind-resistant Ropes for enhanced stability.

5. OPERATION

5.1 Adjusting Netting and Curtains

The gazebo features a double track design, allowing the mosquito netting and privacy curtains to be adjusted independently. Use the zippers to open or close them as needed for ventilation, insect protection, or privacy.

DOUBLE TRACK DESIGN

Curtain & netting can be adjusted separately, protect you from UV & rain, while adding more privacy.

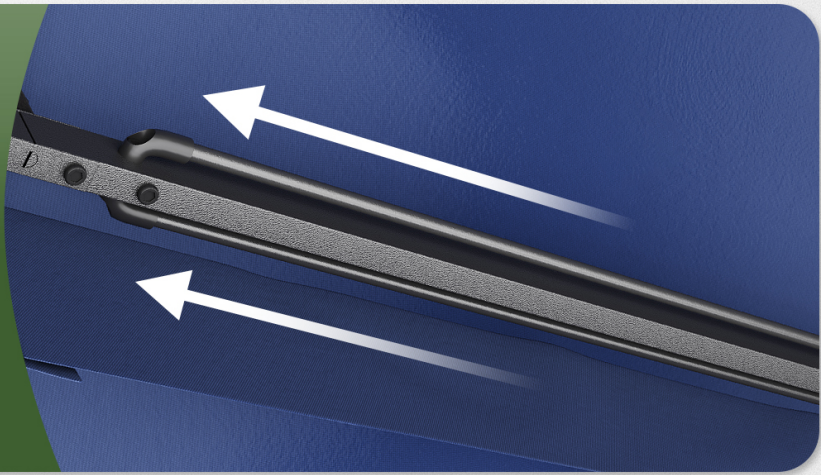

Image 6: Three modes of use: Good Ventilation, Anti-Mosquito, and Sun Shade.

5.2 Utilizing Top Hooks and Corner Rings

The gazebo roof is equipped with J-shaped hooks for hanging items such as chandeliers, fans, or decorative plants. The four corner rings can be used to tie wind ropes or hang additional decorations like string lights or wind chimes.

PRODUCT DETAILS



Practical Design



Heavy-duty Frame



1

2" J" Shaped Hooks
Lights, Fans, Plants

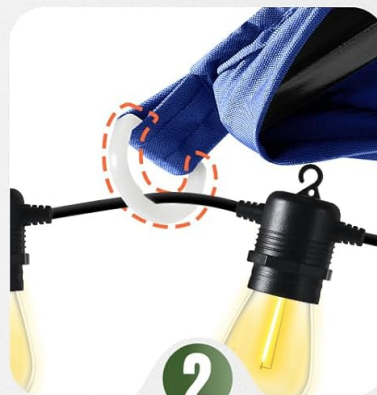

2

4 Corner Rings
Decoration Hanging

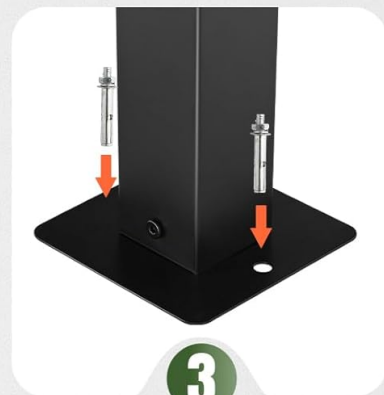

3

Anchored Frame
More Stable

Image 7: Product Details showing J-shaped hooks, corner rings, and anchored frame.

6. MAINTENANCE

6.1 Cleaning

Clean the canopy fabric and curtains with mild soap and water. Rinse thoroughly and allow to air dry completely before storage. Avoid using harsh chemicals or abrasive cleaners, as these can damage the fabric's UV and water-resistant properties. Wipe down the steel frame with a damp cloth as needed.

6.2 Seasonal Care and Storage

During periods of severe weather (heavy snow, strong winds, prolonged rain), it is recommended to remove the canopy and curtains to prevent damage. For long-term storage, disassemble the gazebo, clean all components, and store them in a dry, protected area to prolong the product's lifespan.

6.3 Inspection

Regularly inspect all frame connections, fabric condition, and anchoring points. Tighten any loose bolts and repair or replace any damaged components promptly to maintain structural integrity and safety.

7. TROUBLESHOOTING

- **Water Accumulation on Roof:** The gazebo is designed with leakage holes to prevent water buildup. Ensure these holes are clear of debris. If water still accumulates, check that the canopy is installed tautly and correctly.

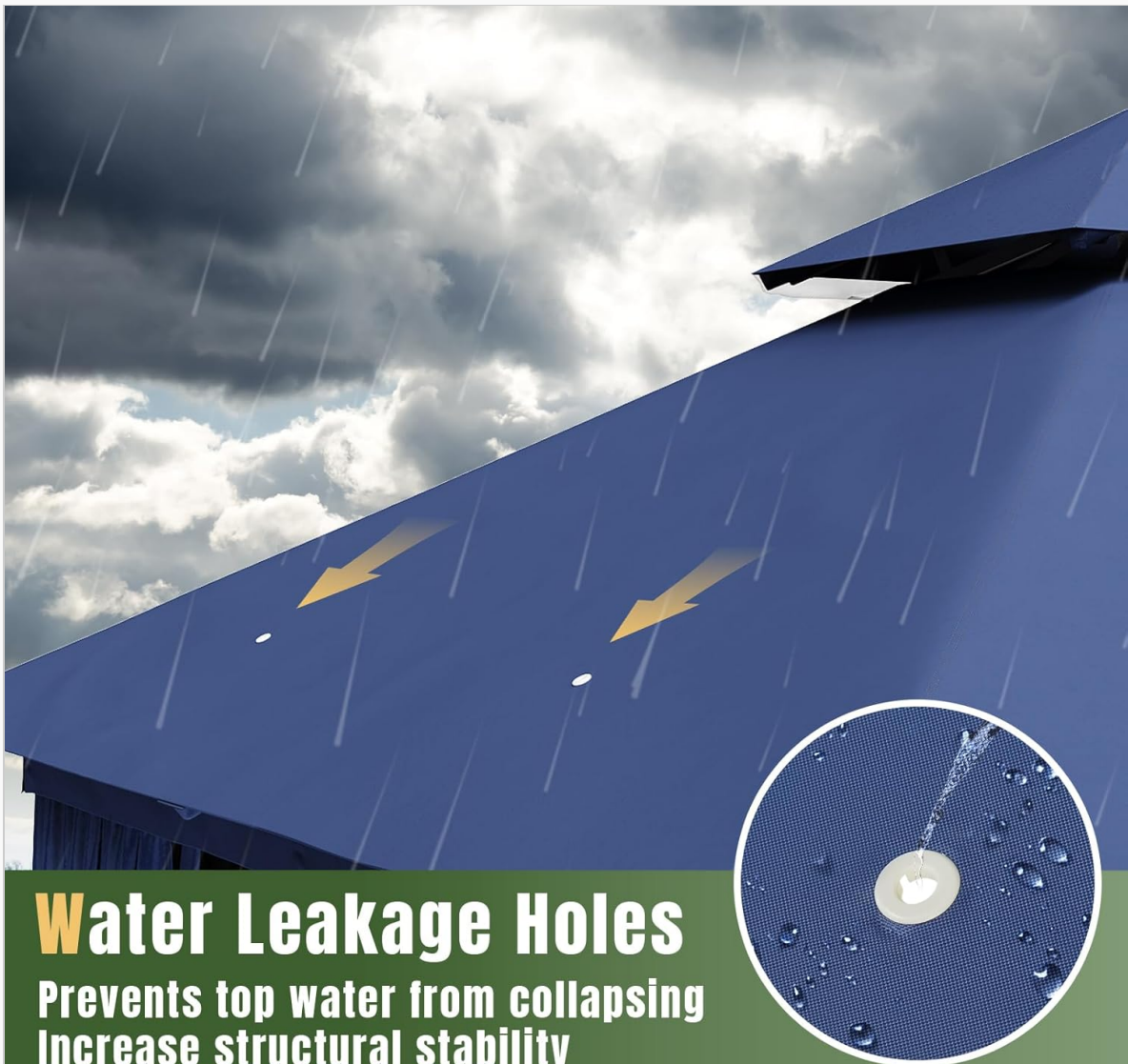

Image 8: Water Leakage Holes on the roof.

- **Gazebo Instability in Wind:** Verify that the gazebo is properly anchored using all provided windproof ropes and stakes/expansion bolts. Ensure all frame connections are securely tightened. Consider relocating the gazebo to a more sheltered area if high winds are a frequent concern.
- **Difficulty with Netting/Curtain Movement:** Check the tracks for any obstructions or debris. Ensure the fabric is not snagged or twisted. Lubricate tracks if necessary with a silicone-based spray.
- **Fabric Tears or Fading:** While the fabric is UV-resistant (UPF 50+) and waterproof, prolonged exposure to extreme weather can cause wear. Ensure proper seasonal care and storage. Small tears may be repaired with fabric repair kits.

8. SPECIFICATIONS

Feature	Detail
Brand	Aoxun
Model	10x12 Outdoor Patio Gazebo
Product Dimensions	144"L x 120"W x 111.6"H (12 ft x 10 ft x 9.3 ft)
Frame Material	Alloy Steel (Powder Coated)
Leg Diameter	Φ80mm (Thickened Square Frame)
Canopy Material	Waterproof Polyester Fabric
UV Protection	UPF 50+
Water Resistance Level	Water Resistant (Water Pressure Resistance 1500mL)
Wind Resistance	Up to Level 7 (31-38 mph)
Item Weight	102 pounds
Assembly Required	Yes

10X12FT PATIO GAZEBO

aoxun

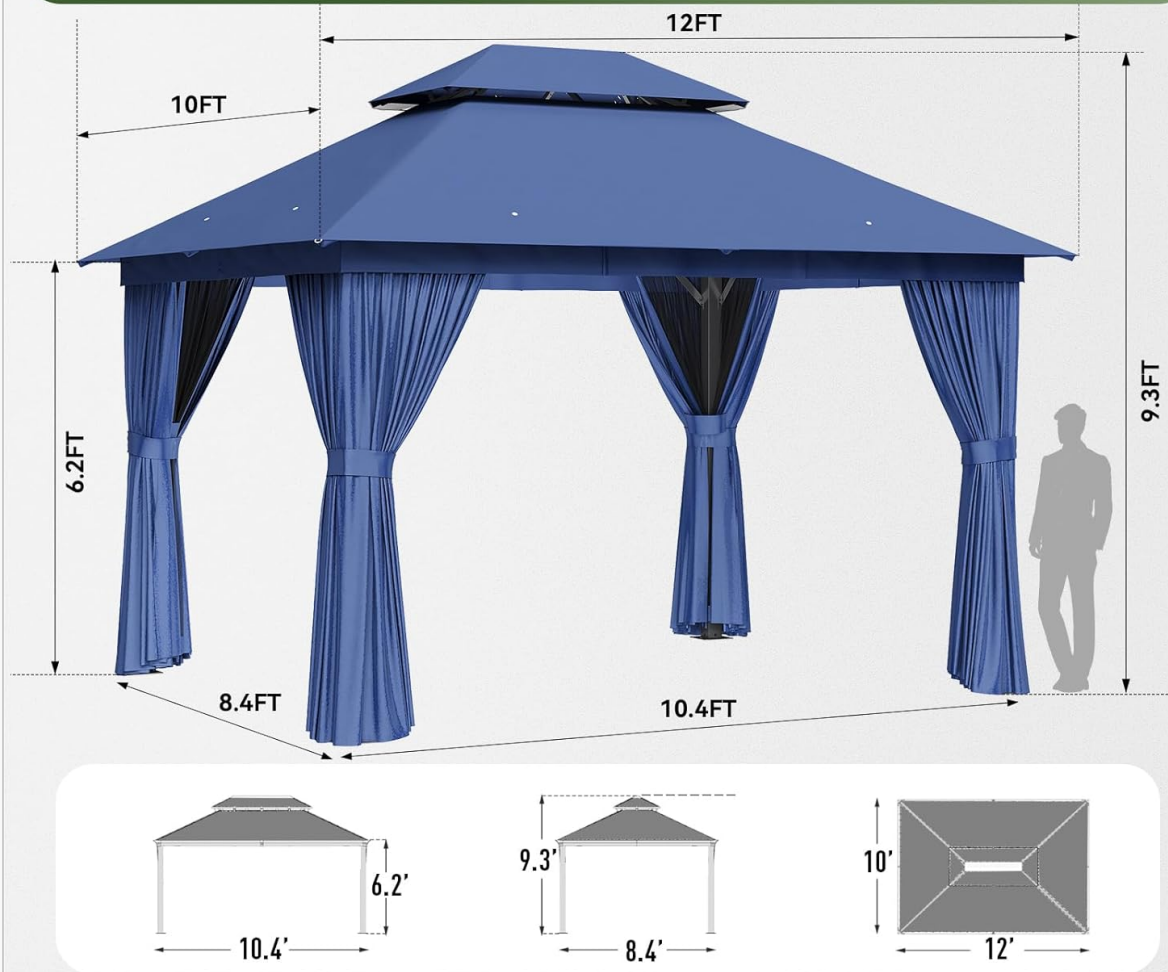

Image 9: Gazebo Dimensions Diagram.

9. WARRANTY AND SUPPORT

For warranty information, please refer to the documentation included with your purchase or contact the retailer where the product was acquired. For technical support, missing parts, or other inquiries, please contact Aoxun customer service through the retailer's platform or the official Aoxun website.