



[Manuals.plus](#) /

> [Richelock](#) /

> Richelock IU53 Double-Sided Fingerprint & Keypad Door Lock Instruction Manual

## Richelock IU53

# Richelock IU53 Double-Sided Fingerprint & Keypad Door Lock Instruction Manual

Model: IU53

### PRODUCT OVERVIEW

The Richelock IU53 is a double-sided fingerprint and keypad door lock designed for enhanced security in various environments, including outdoor gates, indoor doors, and fences. It offers multiple access methods, including fingerprint recognition, custom passcodes, and mechanical keys, on both sides of the door. The lock is constructed from heavy-duty zinc alloy and features an IP65 waterproof rating, making it suitable for all-weather conditions.

# DUAL-SIDED SMART ACCESS



Image: The Richelock IU53 lock showcasing dual-sided smart access features including fingerprint, passcode, key, and all-weather capability.

## WHAT'S IN THE BOX

The product package includes all necessary components for installation and operation. Please verify that all items are present before beginning the installation process.

- Lock Assembly (Exterior and Interior)
- User Guide
- Quick Start Guide
- Screws (various sizes)
- Strike Plate
- Spindles (for different door thicknesses)
- Keys (four provided)
- Mounting Plate
- Screwdriver (not always included, but useful for installation)

# WHAT'S IN THE BOX?

(2 AA Batteries not included)



Image: A visual representation of all items included in the Richelock IU53 package, such as the lock units, keys, screws, and manuals. Note: 2 AA batteries are not included.

## INSTALLATION GUIDE

Follow these steps to properly install your Richelock IU53 door lock. Ensure you have all components listed in the "What's in the Box" section.

### Disassembly of the Lock

1. **Remove the screw on the battery cover:** Use a screwdriver to loosen and remove the screw securing the battery cover.
2. **Gently separate the battery cover:** Carefully detach the battery cover from the main unit.
3. **Remove the 2 screws inside the battery compartment:** Locate and remove the two screws within the battery compartment.
4. **Locate and remove 1 screw beneath the knob on the interior assembly:** Find the screw positioned under the knob on the interior part of the lock and remove it.
5. **Carefully separate the interior assembly by pulling it backward:** Gently pull the interior assembly away from the lock body.
6. **Remove the 2 screws securing the mounting plate:** Unscrew the two screws that hold the

mounting plate in place.

7. **Separate the mounting plate from the lock body:** Detach the mounting plate from the rest of the lock.
8. **Slide the latch off along the spindle to complete disassembly:** Remove the latch by sliding it off the spindle.

## Installation on the Door

1. **Check dimensions and adjust the latch:** Verify that the latch dimensions match your door's requirements. Adjust the latch if necessary (e.g., for 2-3/8" or 2-3/4" backsets).
2. **Install the latch:** Insert the latch into the door edge and secure it with screws.
3. **Insert the exterior assembly:** Carefully insert the exterior lock assembly into the door.  
**IMPORTANT:** Make sure the spindle is installed with the 'THIS SIDE UP' marking facing upward. Position the power cable above the latch mechanism to prevent pinching.
4. **Install the mounting plate:** Place the mounting plate over the exterior assembly and secure it with screws. Ensure the power cable passes through the designated opening.
5. **Install the interior assembly:** Connect the power cable from the exterior assembly to the interior assembly. Carefully align and attach the interior assembly to the mounting plate.  
**IMPORTANT:** Ensure these two screws are fully tightened.
6. **Connect the power cable:** Connect the power cable to the interior assembly, ensuring proper orientation alignment.
7. **Install the battery:** Insert 2 AA batteries (not included) into the battery compartment, observing correct polarity.
8. **Install the battery cover:** Reattach the battery cover and secure it with the screw.

Your browser does not support the video tag.

Video: A step-by-step guide demonstrating the unboxing and installation process for the Richelock IU53 door lock, including disassembly and reassembly on a door.

# Fits Most Doors

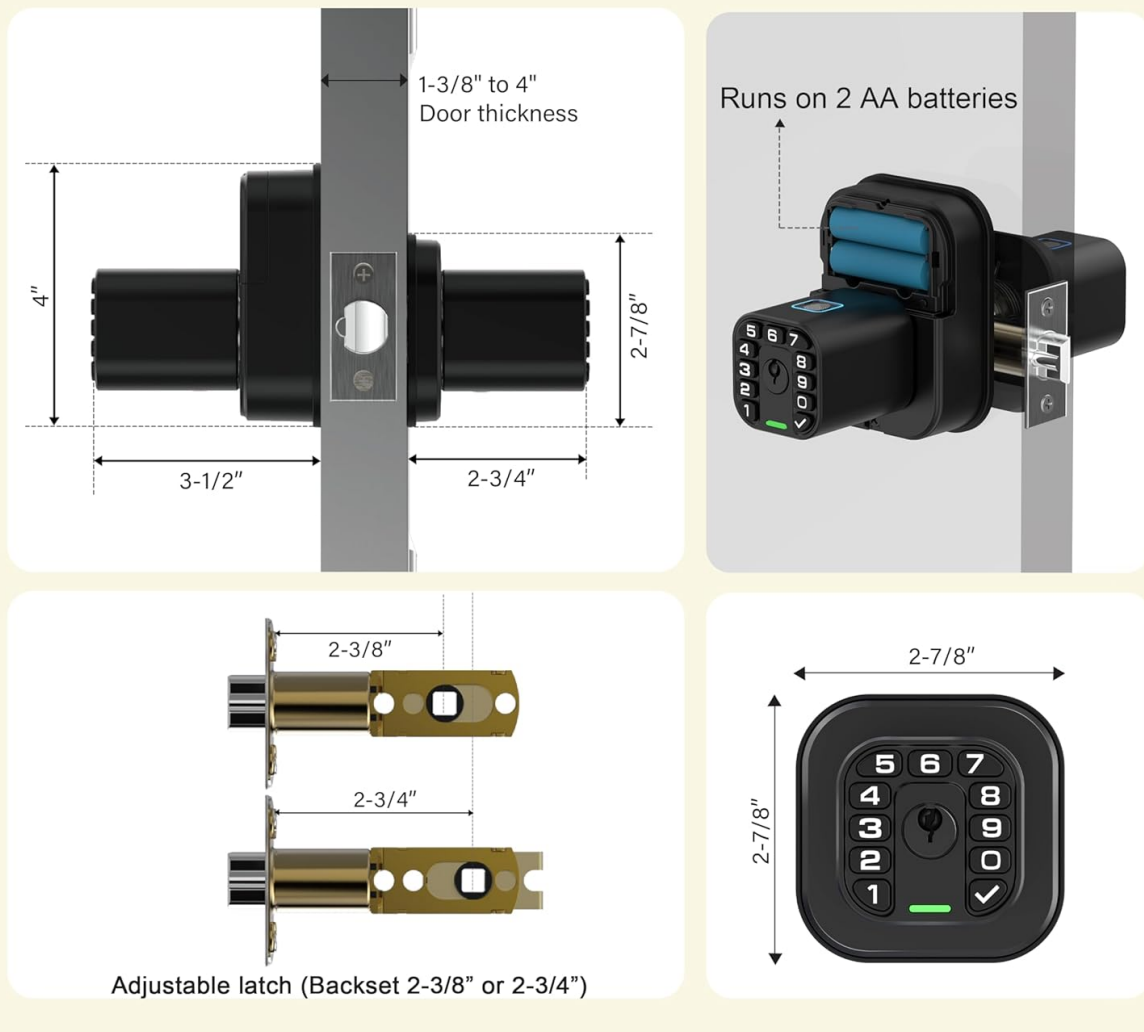

Image: Detailed diagram illustrating the compatibility of the Richelock IU53 with various door thicknesses and backset sizes, along with battery placement.

## SETUP AND PROGRAMMING

The Richelock IU53 features voice-guided setup to simplify programming. Refer to the included Quick Start Guide for specific instructions on setting up master codes, user codes, and fingerprints.

- **Master Code:** A default master code is typically provided. It is recommended to change this immediately after installation.
- **User Codes:** Set 1-15 digit unique codes, with up to 50 codes available per side.
- **Fingerprints:** High-resolution fingerprint sensors can store up to 100 fingerprints per side. The AI-powered sensors improve accuracy over time. Fingerprints are programmed independently for each side (interior and exterior).
- **Voice Prompts:** Hold the  $\checkmark$  button for 4 seconds to activate voice prompts for guided setup.

## OPERATING INSTRUCTIONS

The IU53 lock offers multiple ways to secure and access your door.

- **Fingerprint Access:** Place a registered finger on the sensor. The light will turn green, indicating successful recognition, and the lock will disengage.
- **Keypad Access:** Enter a programmed user code on the backlit keypad, then press '✓'. The lock will disengage.
- **Mechanical Key Access:** Use one of the provided mechanical keys to manually unlock the door.
- **Dual-Sided Operation:** Both the exterior and interior sides feature keypads and fingerprint scanners, allowing independent access control from either side.
- **Auto-Lock Feature:** The lock defaults to auto-lock after 5 seconds, but this can be programmed from 2 seconds up to 12 hours.
- **Manual Mode:** The lock can be set to manual mode, requiring a manual lock action.
- **Instant Lock:** Lock the door instantly by tapping the '✓' button four times.
- **Silent Mode:** Mute keypad sounds for quiet operation.

## ADVANCED SECURITY & PRIVACY PROTECTION

**2 PACK SAME KEY**

100 Fingerprints   50 Codes   4 Keys   Auto-Lock   Remote-Code   Manual Lock   2+ Years Battery Life

Image: Overview of advanced security and privacy protection features, including 100 fingerprints, 50 codes, 4 keys, auto-lock, remote-code, manual lock, and 2+ years battery life.

# PEACE OF MIND FOR YOUR LOVED ONES



Image: Illustrates the lock's benefit for families, showing a child using the fingerprint scanner, an elderly person, and a caregiver, highlighting its use for securing vulnerable individuals.

## MAINTENANCE

- **Battery Life:** The lock is designed for 2+ years of battery life with typical usage.
- **Low-Power Alerts:** The lock will provide alerts when batteries are low. Replace batteries promptly to ensure continuous operation.
- **Emergency Power:** In case of complete battery depletion, emergency USB-C ports are located under each knob to provide instant power for temporary access.
- **Cleaning:** Clean the keypad and fingerprint sensor with a soft, dry cloth. Avoid abrasive cleaners or solvents.

## TROUBLESHOOTING

- **Fingerprint Sensor Issues:**
  - If the fingerprint sensor is finicky, ensure your finger is clean and dry, and try different angles during registration and use.
  - In rainy conditions, fingerprint recognition may be less reliable. Use the keypad or mechanical

key as an alternative.

- **Battery Depletion:** If the batteries are completely dead, use the emergency USB-C port for temporary power or the mechanical key.
- **Lock Not Responding:** Check battery levels. If issues persist after replacing batteries, refer to the Quick Start Guide for factory reset procedures or contact customer support.
- **Waterproof Claims:** While rated IP65 waterproof, ensure proper installation and sealing to prevent water ingress, especially in exposed outdoor environments.

## SPECIFICATIONS

<b>Brand</b>	Richelock
<b>Model Name</b>	IU53 (Internal Model Number: 23846b20-0213-43d7-a8d4-2a230a7e7b1b)
<b>Lock Type</b>	Biometric
<b>Material</b>	Zinc Alloy
<b>Special Feature</b>	Waterproof (IP65 rated)
<b>Finish Type</b>	Electroplated
<b>Control Method</b>	Touch, Voice
<b>Operating Temperature Range</b>	-22°F to 176°F (-30°C to 80°C)
<b>Door Thickness Compatibility</b>	2-3/4" or 2-3/8" backsets (standard US doors)
<b>Power Source</b>	2 AA Batteries (not included)
<b>Item Weight</b>	6.45 pounds

Harmonizing with any door



Image: A detailed view of the lock's keypad and fingerprint sensor, highlighting its robust construction.

## BUILT FOR ALL WEATHER



-22°F~176°F

Wide temperature range

Waterproof

Image: The Richelock IU53 lock shown in snowy and rainy conditions, emphasizing its all-weather and waterproof design.

## WARRANTY AND SUPPORT

---

The Richelock IU53 door lock is backed by a 1-year warranty. For any questions, technical assistance, or warranty claims, please contact Richelock customer support. 24/7 support is available to assist you.

For further assistance, please visit the [Richelock Store](#).