

WOBANE CP01

WOBANE LED Puck Lights (Model CP01) Instruction Manual

Dimmable LED puck lights for under cabinet, counter, shelf, closet, cupboard, bookcase, and display lighting. Features include easy installation with 3M adhesive, a dimmer switch, and warm white 2700K illumination.

PRODUCT OVERVIEW

The WOBANE LED Puck Lights provide efficient and customizable illumination for various indoor spaces. This kit includes linkable LED puck lights with a convenient dimmer switch, designed for easy installation and safe operation.

- **Linkable Design:** Lights connect with a single cable, reducing wire clutter.
- **Adjustable Brightness:** Control light intensity with the integrated dimmer switch.
- **Safe Low Voltage:** Operates on DC 24V with an ETL Listed power supply, ensuring safety.
- **Easy Installation:** Features 3M adhesive tape for screw-free mounting, protecting furniture. All necessary accessories are included.

WHAT'S IN THE BOX

Verify that all components are present before beginning installation.

- 6x LED Puck Lights
- 1x Power Adapter
- 1x Dimmer Switch
- Connection Cables and Accessories (e.g., cable clips, 3M adhesive)
- 1x Instruction Manual (this document)



Image: All components included in the WOBANE LED Puck Lights kit, laid out for inspection.

SETUP AND INSTALLATION

Follow these steps for proper installation of your WOBANE LED Puck Lights.

1. **Plan Placement:** Determine the desired locations for each puck light under your cabinet, shelf, or display area. Consider the cable lengths and power outlet proximity.
2. **Prepare Surface:** Ensure the mounting surfaces are clean, dry, and smooth for optimal adhesive performance.
3. **Attach Puck Lights:** Peel the backing from the 3M adhesive tape on each puck light and firmly press it onto the chosen surface. Hold for a few seconds to secure.
4. **Connect Lights:** Connect the puck lights to each other using the provided connection cables. Ensure secure connections.
5. **Connect Dimmer Switch and Adapter:** Connect the dimmer switch to the main cable line, and then connect

the power adapter to the dimmer switch. Plug the adapter into a standard electrical outlet.

6. **Manage Cables:** Use the included cable clips to neatly route and secure all cables, preventing them from hanging loosely. This ensures a tidy and safe installation.

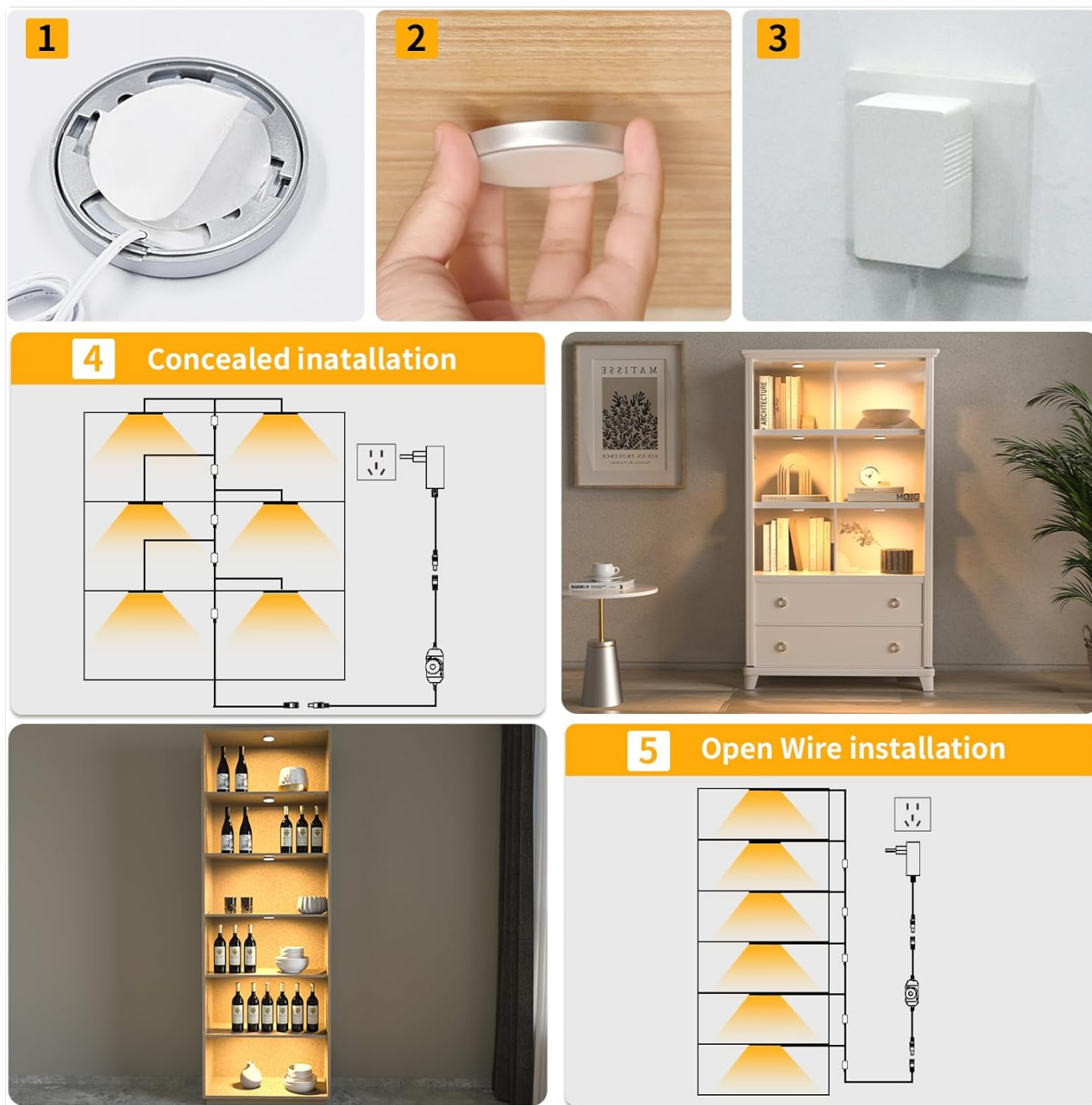
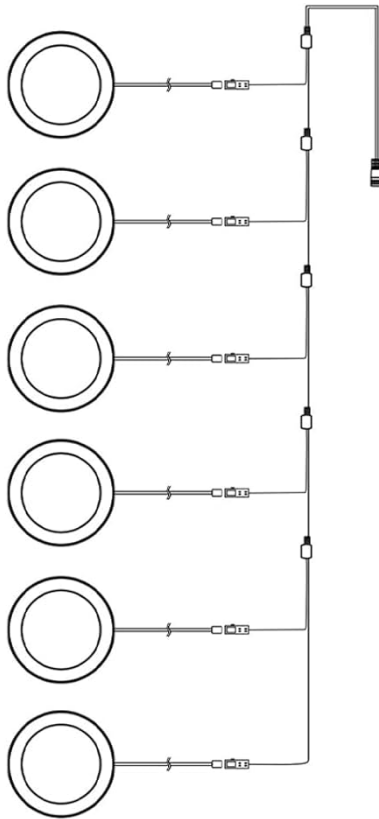

Image: Visual guide for installation, demonstrating how to attach puck lights and manage wiring for both concealed and open installations.

Our



Connection Cable



Less Wire, Less Messy Simple
to install and easy to organize.

Other



Connection Cable

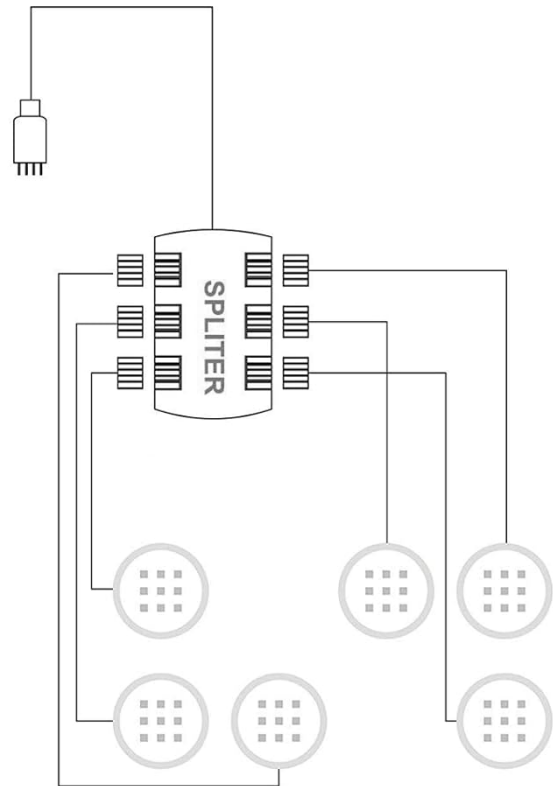

Installation is complicated
and difficult to organize

Image: Illustration comparing the streamlined connection cable system of WOBANE lights to a more complex splitter-based system.

Connection Diagram

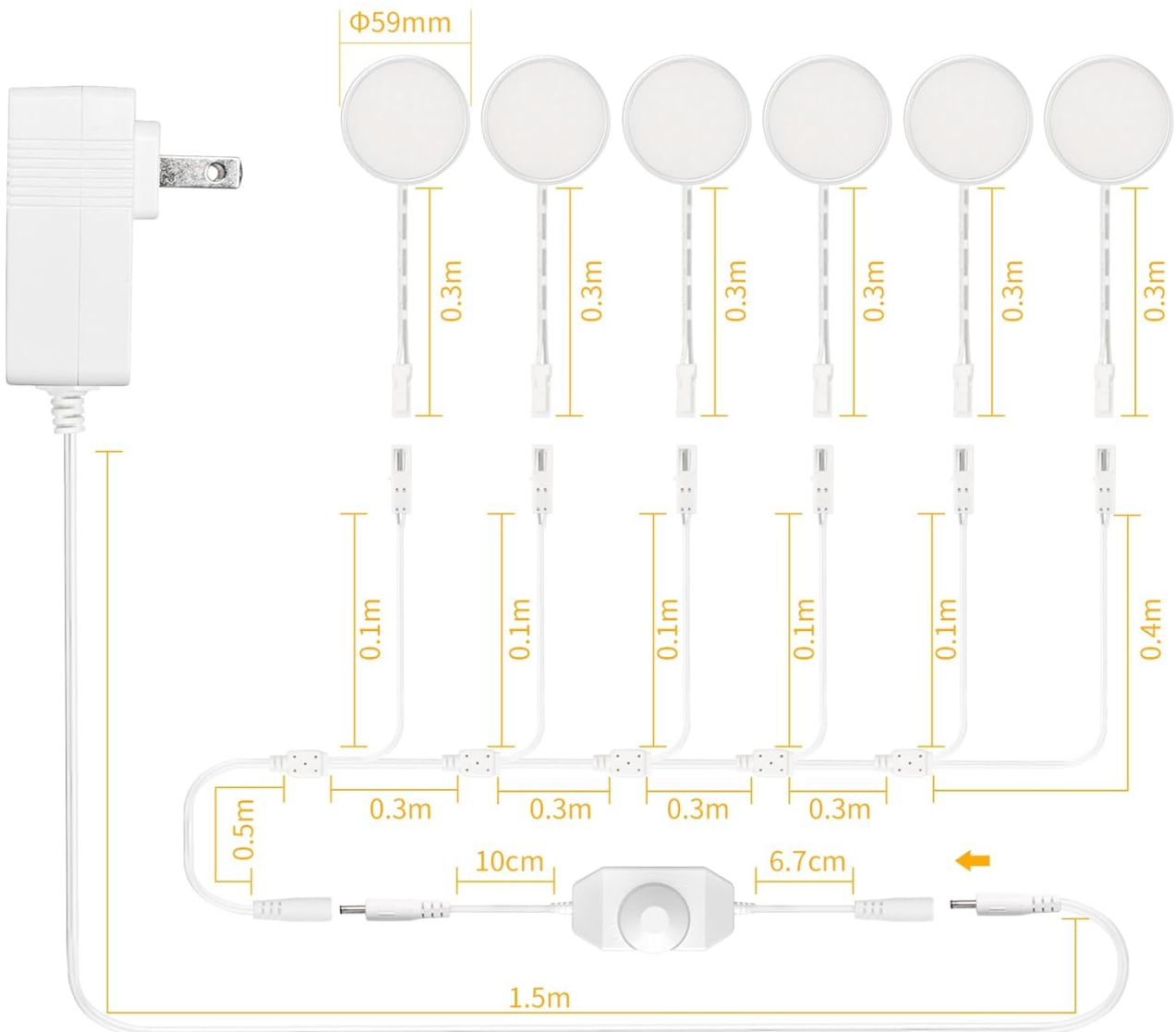

Image: A comprehensive diagram detailing the connections between the power adapter, dimmer switch, and the six puck lights, including cable measurements.

OPERATING INSTRUCTIONS

The WOBANE LED Puck Lights are designed for simple operation.

1. **Power On/Off:** The dimmer switch controls the power. Turn the rotary dial clockwise to turn the lights on and increase brightness. Turn counter-clockwise to decrease brightness and turn off the lights.
2. **Adjust Brightness:** Rotate the dimmer switch dial to achieve your desired light intensity, from a soft glow to full brightness.



Image: A kitchen setting with under-cabinet lighting, illustrating the use of the rotary dimmer switch to adjust light intensity.

MAINTENANCE

These LED puck lights require minimal maintenance.

- **Cleaning:** Disconnect power before cleaning. Wipe the lights gently with a soft, dry cloth. Do not use abrasive cleaners or solvents.
- **Adhesive Check:** Periodically check the adhesive to ensure the lights remain securely attached.
- **Cable Inspection:** Regularly inspect cables for any signs of damage or wear.

Troubleshooting

If you encounter issues with your WOBANE LED Puck Lights, refer to the following common solutions:

Problem	Possible Cause	Solution
Lights do not turn on.	No power, loose connection, dimmer switch off.	Check if the power adapter is securely plugged in. Ensure all cable connections are firm. Rotate the dimmer switch clockwise to turn on and increase brightness.
Lights are dim or flickering.	Dimmer setting too low, power issue.	Adjust the dimmer switch to a higher brightness setting. Verify the power adapter is functioning correctly.
Some puck lights are not working.	Loose connection to individual light.	Check the connection cable to the non-working puck light. Ensure it is fully inserted.

Specifications

Feature	Detail
Brand	WOBANE
Model Name	CP01
Light Source Type	LED
Color Temperature	2700 Kelvin (Warm White)
Brightness	1050 Lumens (Total)
Wattage	12.5 watts
Voltage	24 Volts (DC)
Power Source	AC/DC
Installation Type	Flush Mount (with 3M adhesive)
Material	Plastic
Product Dimensions	5"L x 2"W x 2"H (Overall package dimensions)
Item Weight	10.2 ounces
Indoor/Outdoor Usage	Indoor
Special Feature	Energy Efficient, Lightweight
Controller Type	Rotary Switch



Image: Display shelves illuminated by WOBANE puck lights, emphasizing their bright and efficient glow.



Image: The 24V low voltage power adapter, ensuring safe operation without overheating.

WARRANTY AND SUPPORT

The WOBANE LED Puck Lights come with a Limited Warranty. For specific warranty details, please refer to the documentation included in your product packaging or contact WOBANE customer support.

For technical assistance or customer service inquiries, please visit the official WOBANE website or contact their support team directly.