

OLIXIS OLIXIS-GDZ

OLIXIS 32 Inch Home Office Desk Instruction Manual

Model: OLIXIS-GDZ | Brand: OLIXIS

1. PRODUCT OVERVIEW

The OLIXIS 32 Inch Home Office Desk is designed for versatility and durability, suitable for various home and office environments. It features a robust construction with an X-shaped reinforcement for enhanced stability.

- **Premium MDF Material:** Scratch-resistant and waterproof surface for easy cleaning.
- **X-Brace Reinforcement Technology:** Engineered to prevent wobbling and ensure a flat, stable surface.
- **Heavy-Duty Square Tube Legs:** Supports up to 265 lbs, ideal for heavy projects or multiple devices.
- **Versatile Design:** Available in multiple sizes and colors to fit various spaces and aesthetics.

2. SETUP AND ASSEMBLY

This desk is designed for quick and simple assembly. All necessary tools and parts are included. Please follow the steps below carefully.

Assembly Video Guide

This video demonstrates the assembly process for OLIXIS Home Office Desks, including 32-inch and 40-inch models. It provides a visual guide to help you set up your desk efficiently.

Parts List

63in



This image displays all components required for assembling the desk, including the main board, metal support legs, crossbars, cross brace, various screws, and the provided wrench.

Assembly Steps

1. Attach the support legs (A) to the crossbar (B) and bottom crossbars (E) using the provided screws. Ensure all connections are secure but do not fully tighten yet.
2. Install the X-shaped cross brace (D) to the rear of the leg frames. This provides additional stability. Tighten screws to 50% at this stage.
3. Place the desk board (C) onto the assembled frame. Align the pre-drilled holes on the board with the holes on the frame.
4. Secure the desk board to the frame using the remaining screws.
5. Once all components are in place, fully tighten all screws to ensure maximum stability.

Quality Panels

Structural Stability and Good Load Bearing



This image illustrates the X-shaped structure and the robust metal frames, emphasizing the quality and thickness of the materials used for stability.

3. SPECIFICATIONS

Detailed specifications for the OLIXIS 32 Inch Home Office Desk.

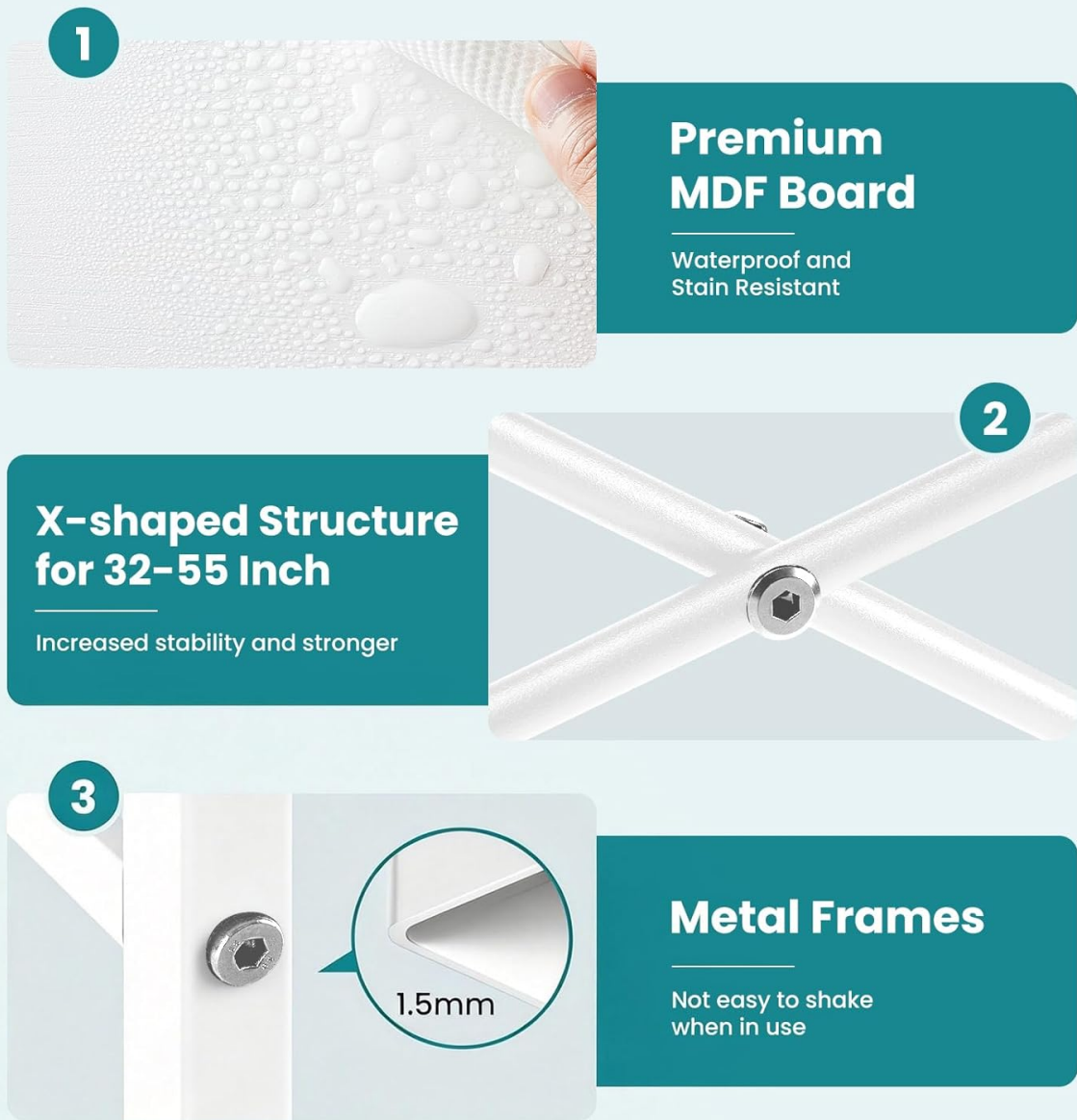

This diagram provides a clear overview of the desk's dimensions and maximum load capacity, along with a size chart for other available models.

Specification	Detail
Brand	OLIXIS
Model Number	OLIXIS-GDZ
Product Dimensions	31.5"D x 19.69"W x 29.69"H
Color	White
Style	Modern
Top Material Type	Wood (Premium MDF)
Base Material	Metal
Item Weight	16.87 Pounds
Max Load Capacity	265 lbs

Specification	Detail
Special Feature	Easy Clean
Required Assembly	Yes

4. OPERATING AND USAGE

The OLIXIS Home Office Desk is designed for straightforward use as a workstation, study table, or computer desk. Its sturdy construction ensures a reliable surface for your daily activities.

- Place the desk on a flat, stable surface to prevent wobbling.
- Distribute weight evenly across the desktop to maintain balance and prevent strain on the frame.
- Utilize the optional storage bag (if included with your model) for organizing documents, stationery, or other small items.
- The desk is suitable for holding computers, monitors, books, and other office supplies within its weight capacity.

5. MAINTENANCE

To ensure the longevity and appearance of your OLIXIS desk, follow these simple maintenance guidelines:

- **Cleaning:** The premium MDF surface is waterproof and easy to clean. Wipe spills immediately with a soft, damp cloth. Avoid abrasive cleaners or harsh chemicals that could damage the finish.
- **Protection:** While the surface is scratch-resistant, using coasters for drinks and pads under heavy or sharp objects is recommended to prevent potential damage.
- **Tighten Screws:** Periodically check and tighten all assembly screws to maintain the desk's stability.
- **Avoid Extreme Conditions:** Do not expose the desk to extreme temperatures or humidity, as this may affect the material integrity.

Why Choose OLIXIS

OLIXIS

- ✓ Premium MDF board for durability
- ✓ Extra strong 265 lbs weight capacity
- ✓ Sturdy square steel tube support
- ✓ X-shape or triangle heavy-duty reinforced structure

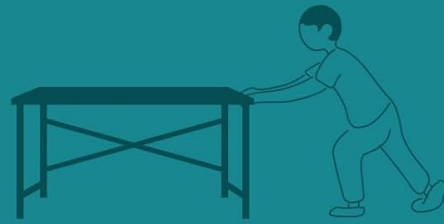

Stable structure



VS



Others

- ✗ Easily deformed
- ✗ Low load-bearing capacity, prone to breakage
- ✗ Fragile steel tubes, prone to damage
- ✗ Poor quality boards, not user-friendly



Easy to wobble

This image highlights the key features of the desk's surface: anti-scratch, water and moisture resistant, and easy to clean, ensuring durability and simple upkeep.

6. TROUBLESHOOTING

If you encounter any issues with your OLIXIS desk, please refer to the following common solutions:

- **Wobbling Desk:** Ensure all screws are fully tightened. Check that the desk is placed on a level surface. The X-brace reinforcement is designed to minimize wobbling.
- **Missing Parts:** If any parts are missing upon unboxing, please contact customer support immediately for assistance.
- **Difficulty during Assembly:** Review the assembly video and steps provided in Section 2. Ensure you are using the correct screws for each part. Do not force components together.

7. WARRANTY AND SUPPORT

For any questions, concerns, or support needs regarding your OLIXIS 32 Inch Home Office Desk, please contact our customer service team. While specific warranty details are not provided in this manual, standard consumer protection laws apply.

For further assistance, please visit the [OLIXIS Store on Amazon](#) or refer to your purchase documentation for

contact information.