



[Manuals.plus](#) /

> [GRACEALL](#) /

> GRACEALL 30 Inch Under Cabinet Range Hood JX3875S Instruction Manual

GRACEALL JX3875S

GRACEALL 30 Inch Under Cabinet Range Hood Instruction Manual

Model: JX3875S

IMPORTANT SAFETY INFORMATION

Please read all instructions carefully before installing or operating this appliance. Keep this manual for future reference.

- Always disconnect power before servicing or cleaning the unit.
- Installation must be performed by a qualified technician in accordance with all local codes and standards.
- Ensure proper grounding to reduce the risk of electric shock.
- Do not operate the range hood if the power cord is damaged. Contact customer service for replacement.
- Maintain a minimum distance between the cooktop surface and the bottom of the range hood as specified in the installation instructions.
- Clean grease filters regularly to prevent grease fires.
- Never leave cooking food unattended.

PRODUCT OVERVIEW

The GRACEALL JX3875S is a 30-inch under cabinet range hood designed to efficiently remove smoke, steam, and cooking odors from your kitchen. It offers versatile installation options, supporting both ducted and ductless configurations. The unit features an 80W brushless motor, providing up to 300 CFM airflow with quiet operation. It includes a 3-layer dishwasher-safe aluminum mesh filter and integrated LED lighting for enhanced visibility over your cooking area.

EFFECTIVELY REMOVE GREASE AND ODORS



Image: The GRACEALL 30 Inch Under Cabinet Range Hood, Model JX3875S, in a kitchen setting.

WHAT'S IN THE BOX

Verify that all components are present before beginning installation.

- Instruction Manual
- Charcoal filter (for ductless operation)
- Expandable Pipe (for ducted operation)
- Draft Damper Flaps
- Vent Cover
- Air Outlet
- Screw Kits

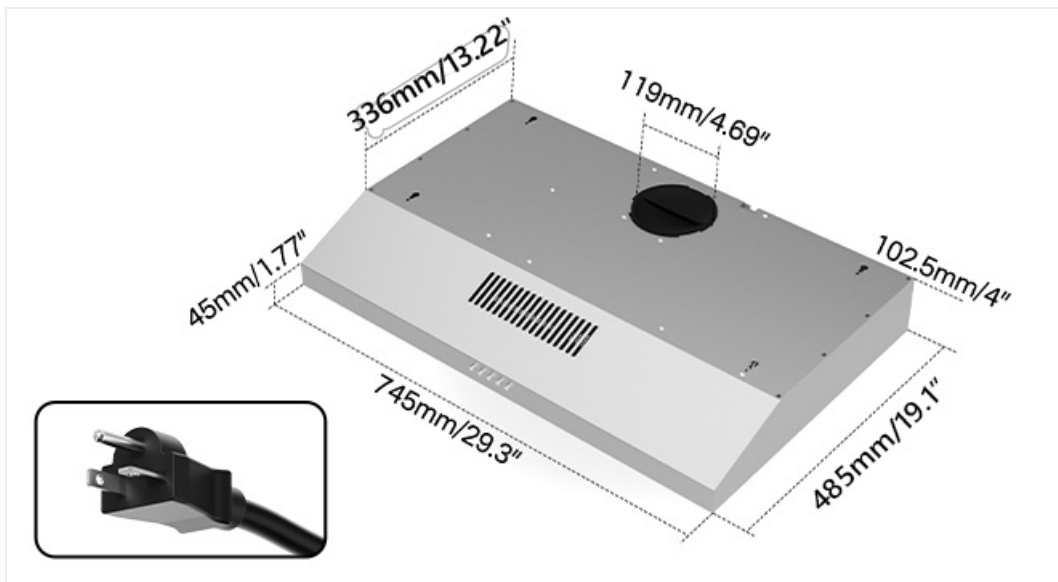

Image: Visual representation of all included components: aluminum pipe, charcoal filter, draft damper flaps, vent cover, air outlet, instructions, installation drawing, and screw kits.

SETUP AND INSTALLATION

The GRACEALL JX3875S range hood supports both ducted and ductless installation methods. Choose the method that best suits your kitchen layout and ventilation requirements.

Installation Options: Ducted vs. Ductless

- **Ducted Mode:** Air is exhausted outside through the included 6.56 ft (4.72 inch diameter) aluminum exhaust pipe. This method provides the most effective removal of smoke and odors.
- **Ductless Mode (Recirculation):** Air is filtered through the activated charcoal filter and recirculated back into the kitchen. This mode is suitable when external venting is not possible. Ensure the charcoal filter is installed for ductless operation.



MULTI-LAYER ALUMINUM FILTER
Effectively capture smoke and odors

Image: Comparison of Ducted Mode, which exhausts air outdoors, and Ductless Mode, which recirculates filtered air using a charcoal filter.

DUCTED AND DUCTLESS CONVERTIBLE



Top Venting Mode

Rear Venting Mode

Recirculation Mode

Image: Illustration showing Top Venting Mode, Rear Venting Mode, and Recirculation Mode for the range hood.

Power Connection

The range hood is designed for simple plug-in operation. Connect the unit to a standard 110~120V AC outlet. No hardwiring is required.

Installation Videos

For detailed visual guidance on installation, please refer to the official GRACEALL installation videos below.

Your browser does not support the video tag.

Video: GRACEALL 30 Inch Under Cabinet Range Hood Installation Guide. This video provides step-by-step instructions for mounting and setting up the range hood.

Your browser does not support the video tag.

Video: GRACEALL Range Hood Cooktop Exhaust Fan Installation. This video demonstrates the process of installing the exhaust fan component of the range hood.

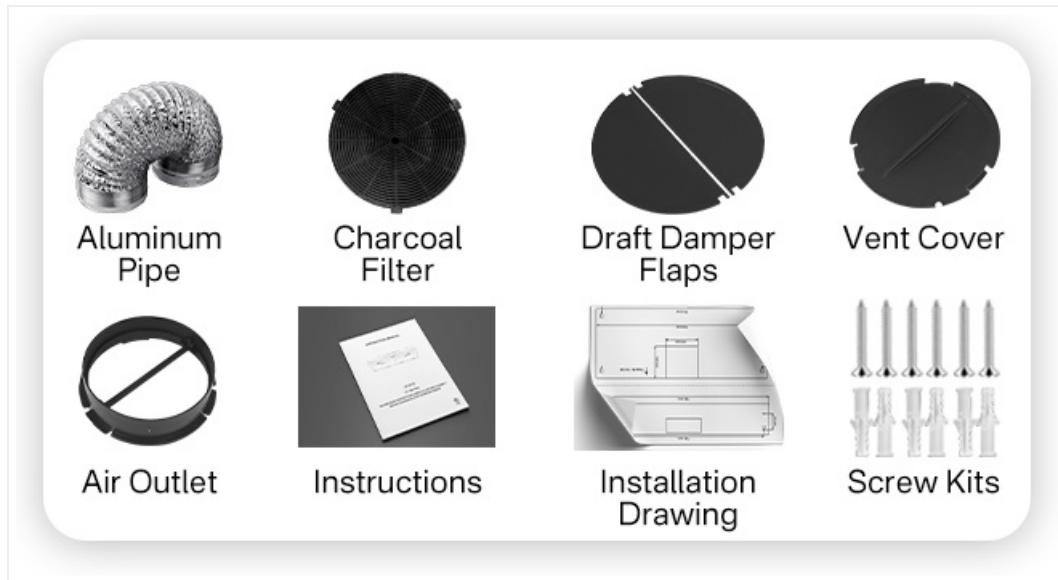

Image: Detailed dimensions of the GRACEALL range hood (29.3"W x 19.1"D x 4"H) and a visual of the standard power plug.

OPERATING INSTRUCTIONS

The range hood features intuitive push-button controls for fan speed and lighting.

Control Panel

The control panel consists of 5 buttons:

- **Power Button:** Turns the fan on or off.
- **Fan Speed Buttons (Low, Mid, High):** Adjusts the fan speed to one of three settings.
- **Light Button:** Turns the LED lights on or off.



Ductless Mode

Includes 1 charcoal filter to reduce odors for ductless indoor venting.



Ducted Mode

Includes a 6.6ft (φ4.72 inch) venting pipe for outdoor ducted venting.

Image: Close-up of the range hood's push-button control panel, showing buttons for power, three fan speeds, and lighting.



Image: A hand pressing one of the control buttons on the range hood, with an inset showing the five distinct button icons.

Fan Speed Selection

Select the appropriate fan speed based on your cooking needs:

- **Low Speed:** Ideal for simmering or light cooking.
- **Medium Speed:** Suitable for general cooking and stir-frying.
- **High Speed:** Use for heavy smoke, steam, or searing.



Image: Visual representation of the three fan speed settings (Low, Mid, High) and their recommended uses for different cooking activities like simmering, stir-frying, and searing.

LED Lighting

Press the light button to illuminate your cooktop area with energy-efficient LED lighting.

MAINTENANCE

Regular maintenance ensures optimal performance and longevity of your range hood.

Cleaning the Grease Filters

The 3-layer aluminum mesh filters trap grease and airborne particles. Clean them regularly (e.g., monthly, depending on cooking frequency) to maintain airflow efficiency and prevent grease buildup.

1. Ensure the range hood is turned off and disconnected from power.
2. Carefully remove the grease filters by pulling the release latch and sliding them out.

3. The filters are dishwasher-safe. Place them in the dishwasher or wash them by hand with warm, soapy water.
4. Allow filters to dry completely before reinstalling.
5. Slide the clean, dry filters back into their slots until they click into place.

LOW NOISE LEVEL

The range hood's noise level stays below 65dB at maximum speed.

≤60dB
Our range hood
at MAX speed

30~40dB
Refrigerator

70~80dB
Vacuum Cleaners

Image: A person removing a dishwasher-safe grease filter from the range hood for cleaning.



Image: A man placing a range hood filter into a dishwasher, demonstrating its dishwasher-safe feature.

Replacing Charcoal Filters (Ductless Mode)

If operating in ductless mode, the activated charcoal filter should be replaced approximately every 3 months, or more frequently depending on cooking habits. Refer to the product's official website or contact customer support for compatible replacement charcoal filters.



Image: The GRACEALL range hood, illustrating the internal charcoal filter used for ductless air recirculation.

Exterior Cleaning

Wipe the exterior surfaces with a soft cloth and mild detergent. Avoid abrasive cleaners or scouring pads that could scratch the stainless steel finish.

TROUBLESHOOTING

Before contacting customer support, review these common issues and solutions.

Problem	Possible Cause	Solution
Fan does not operate.	No power supply; Fan switch off; Motor malfunction.	Check power connection and circuit breaker; Ensure fan switch is on; Contact customer support.
Poor suction.	Clogged grease filters; Incorrect fan speed; Obstruction in ductwork (ducted mode); Saturated charcoal filter (ductless mode).	Clean or replace grease filters; Select higher fan speed; Check ductwork for blockages; Replace charcoal filter.
Excessive noise.	Loose components; Obstruction in fan blades; Improper installation.	Check for loose screws or parts; Inspect fan blades for debris; Re-check installation steps or consult a professional.
Lights not working.	Light switch off; Faulty LED bulb; Wiring issue.	Ensure light switch is on; Replace LED bulb if possible (refer to specifications); Contact customer support.

SPECIFICATIONS

Feature	Detail
Brand	GRACEALL
Model Number	JX3875S
Product Dimensions (D x W x H)	19.1" x 29.3" x 4"
Color	Brushed Steel
Material Type	Stainless Steel
Air Flow Capacity	300 Cubic Feet Per Minute (CFM)
Noise Level	60 Decibels (Max Speed)
Mounting Type	Under Cabinet Mount
Controls Type	Push Button
Number of Speeds	3
Voltage	120 Volts (AC)
Light Source	LED
Filter Type	Mesh (3-layer aluminum)
Ventilation Type	Ducted/Ductless Convertible

Feature	Detail
Included Components	Charcoal filter, Expandable Pipe, Instruction Manual
Item Weight	12.2 Pounds

WARRANTY AND SUPPORT

For warranty information, technical assistance, or to purchase replacement parts (such as charcoal filters), please contact GRACEALL customer support directly. Refer to the contact information provided with your purchase or visit the official GRACEALL website.

Manufacturer: Zhongshan Nardea Electrical Technology Co., Ltd