

[Manuals.plus](#) /

> [JCHICI](#) /

> JCHICI 2x2 Video Wall Controller User Manual

## JCHICI video wall controller 2x2

# JCHICI 2x2 Video Wall Controller User Manual

Model: video wall controller 2x2

Brand: JCHICI

## 1. INTRODUCTION

The JCHICI 2x2 Video Wall Controller is a high-definition processor designed to create impressive large-scale video walls and digital signage displays by splitting a single HDMI input signal across four HDMI output displays, allowing for a dynamic and immersive viewing experience. This device is ideal for various applications including television broadcasting, video conferencing, security monitoring, and large-screen splicing displays in both indoor and outdoor environments.

It supports a 4K@30Hz input resolution and outputs at 1920x1080P@60Hz, ensuring clear and vibrant visuals. The controller offers multiple splicing modes and a unique 180-degree rotation function for flexible installation and optimized display alignment.



Image: The JCHICI 2x2 Video Wall Controller shown with a remote control, demonstrating a soccer match displayed seamlessly across a four-screen video wall.

## 2. WHAT'S IN THE BOX

Upon unboxing your JCHICI 2x2 Video Wall Controller, please verify that all the following components are included:

- 1 x JCHICI 2x2 TV Wall Controller
- 1 x 12V 1A Power Adapter
- 1 x User Manual
- 1 x IR Remote Controller (Requires 2 x AAA Batteries, not included)



Image: A visual representation of the product contents, including the controller unit, power adapter, user manual, and IR remote control.

### 3. SETUP INSTRUCTIONS

Follow these steps to set up your JCHICI 2x2 Video Wall Controller:

1. **Connect HDMI Source:** Connect your HDMI source device (e.g., laptop, computer, set-top box, DVD player) to the HDMI input port on the video wall controller using a high-quality HDMI cable. Ensure the input distance does not exceed 5m/16.4ft.
2. **Connect Displays:** Connect the four HDMI output ports (OUTPUT 1-4) on the controller to your video display units (e.g., LCD TVs, monitors, projectors) using HDMI cables. For accurate image display, connect the displays from left to right and top to bottom to OUTPUT1-4 respectively. Ensure the output distance does not exceed 10m/32.8ft.
3. **Connect Power:** Plug the 12V 1A power adapter into the DC 12V port on the controller and then into a power outlet.
4. **Audio Connection (Optional):** If desired, connect external audio devices (e.g., speaker, sound bar, amplifier) to the separate 3.5mm stereo audio port. Note that only PCM 2.0 audio format is supported; Dolby Digital and DTS are not supported.
5. **Set Display Resolution:** To ensure optimal performance, it is recommended to set the resolution of all connected screens to 1080p.



Image: A diagram illustrating the connection points for HDMI input, HDMI outputs, power, and audio on the video wall controller.

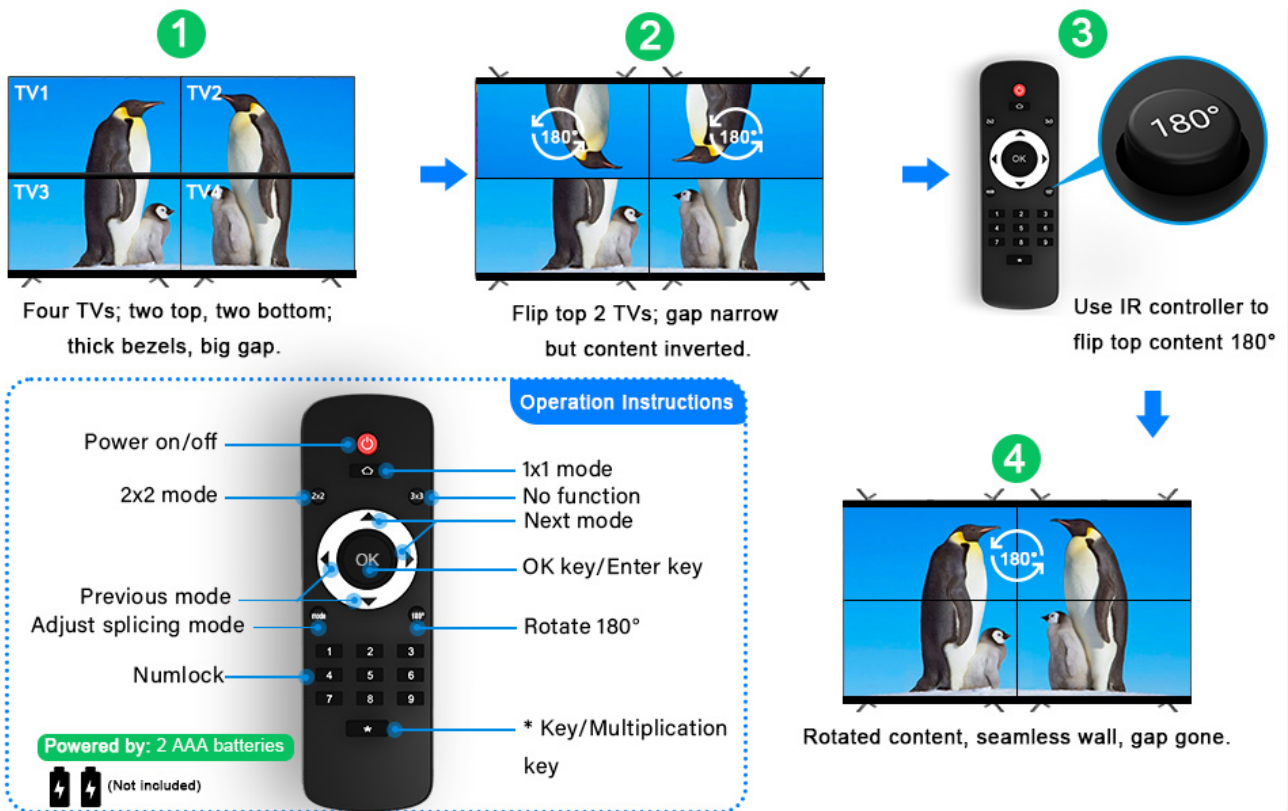

Image: This image shows the compatibility of the video wall controller with various input devices like laptops, computers, PS3/4, and set-top boxes, and output devices such as HDTVs, projectors, monitors, and splicing screens.

## 4. OPERATING INSTRUCTIONS

### 4.1. Switching Splicing Modes

The JCHICI 2x2 Video Wall Controller supports 8 different display modes, which can be easily switched using either the

"MODE" button on the unit or the included IR remote controller.

- **Supported Modes:** 2x2, 1x1, 1x2, 1x3, 1x4, 2x1, 3x1, 4x1.
- **Via Unit Button:** Press the "MODE" button on the front panel of the controller to cycle through the available splicing modes.
- **Via IR Remote Controller:** Use the dedicated mode buttons (e.g., 2x2, 1x2, 1x3, 1x4, 2x1, 3x1, 4x1) on the remote to directly select your desired mode.

#### Input Resolution Requirements for Different Modes:

- **2x2 Splicing Mode:** Recommended input resolution is 1920x1080 or 3840x2160.
- **1x2, 1x3, 1x4 Splicing Modes:** Recommended input resolution is 3840x1080.
- **2x1 Splicing Mode:** Recommended input resolution is 1920x2160.
- **3x1, 4x1 Splicing Modes:** Recommended input resolution is 1920x3240 (may result in slightly compressed image quality).



Image: A visual guide demonstrating the eight different splicing modes (2x2, 1x1, 1x2, 1x3, 1x4, 2x1, 3x1, 4x1) available with the controller.

## 4.2. 180-Degree Rotation Function

The 180-degree rotation function is particularly useful for minimizing noticeable gaps between displays in a 2x2 configuration, especially when using TVs with thicker bottom bezels. This feature allows for a more seamless and complete image.

#### Operation Steps:

1. **Physical Setup:** For a 2x2 setup, physically install the top two TVs upside down.
2. **Remote Control Sequence:**
  - Press the "180°" key on the IR remote controller.
  - After a 1-second interval, press the numeric key "1".
  - After another 1-second interval, press the "OK" button to confirm.

#### Important Notes:

- All output ports support 180-degree rotation, which also aids in flexible cable management.
- The device itself does **not** support 90-degree rotation. For portrait modes, you may need to configure your PC's display settings to rotate the image by 90 degrees.



Image: This image illustrates the process of using the 180-degree rotation feature to achieve a more seamless video wall display by flipping the top two screens.

Your browser does not support the video tag.

Video: This video demonstrates how to use the 180-degree rotation function to narrow the splicing gaps between displays, resulting in a more cohesive video wall.

## 5. SPECIFICATIONS

Feature	Detail
Brand	JCHICI
Model Number	video wall controller 2x2
HDMI Input	3840x2160P (4K) @ 24/30/50/60Hz and below (HDMI 1.4, HDCP 1.4 supported)
HDMI Outputs	4 x 1920x1080P @ 60Hz HD resolution output
Audio Output	3.5mm stereo audio port (PCM 2.0 supported, Dolby Digital and DTS not supported)
Splicing Modes	2x2, 1x1, 1x2, 1x3, 1x4, 2x1, 3x1, 4x1

Rotation Function	180-degree rotation for 2x2 mode (no 90-degree rotation)
Dimensions (L x W x H)	6.9 x 3.1 x 0.9 inches
Weight	0.75 lbs
Power Supply	DC 12V 1A
Input Cable Distance	No more than 5m/16.4ft
Output Cable Distance	No more than 10m/32.8ft

## 6. MAINTENANCE

To ensure the longevity and optimal performance of your JCHICI 2x2 Video Wall Controller, follow these simple maintenance guidelines:

- **Cleaning:** Regularly wipe the device with a soft, dry cloth to remove dust and debris. Avoid using liquid cleaners or abrasive materials, as they may damage the surface.
- **Ventilation:** Ensure the controller is placed in a well-ventilated area. Do not block the ventilation openings, as this can lead to overheating and affect performance.
- **Storage:** When not in use for extended periods, store the device in a cool, dry place away from direct sunlight and extreme temperatures.
- **Cable Management:** Keep all cables neatly organized and free from kinks or excessive bending to prevent damage to the cables and ports.

## 7. TROUBLESHOOTING

If you encounter issues with your JCHICI 2x2 Video Wall Controller, please refer to the following common problems and their solutions:

Problem	Possible Cause / Solution
No image on displays	<ul style="list-style-type: none"> <li>◦ Ensure all HDMI cables are securely connected to both the source and the displays.</li> <li>◦ Verify the power adapter is correctly plugged in and the device is powered on.</li> <li>◦ Check if the input and output resolutions are compatible with the displays and the controller's specifications.</li> <li>◦ Try a different HDMI cable or source device to rule out cable or source issues.</li> </ul>

Distorted or flickering image	<ul style="list-style-type: none"> <li>◦ Ensure HDMI cable lengths are within the recommended limits (Input: &lt;5m, Output: &lt;10m).</li> <li>◦ Check for loose cable connections.</li> <li>◦ Verify that the input resolution matches the recommended settings for the selected splicing mode.</li> <li>◦ Ensure all displays are set to 1080p resolution for optimal performance.</li> </ul>
Remote control not working	<ul style="list-style-type: none"> <li>◦ Check if the remote control has 2 x AAA batteries installed correctly.</li> <li>◦ Replace the batteries if they are depleted.</li> <li>◦ Ensure there are no obstructions between the remote and the IR receiver on the controller.</li> <li>◦ Point the remote directly at the IR receiver.</li> </ul>
No audio or incorrect audio format	<ul style="list-style-type: none"> <li>◦ Confirm that your audio source is outputting PCM 2.0 format. Dolby Digital and DTS are not supported by the controller's 3.5mm audio output.</li> <li>◦ Check the audio cable connection to your external audio device.</li> <li>◦ Ensure the volume on your external audio device is turned up.</li> </ul>

## 8. WARRANTY AND SUPPORT

JCHICI stands behind the quality of its products. The JCHICI 2x2 Video Wall Controller comes with a **3-year warranty** from the date of purchase.

Customer satisfaction is our top priority. If you have any questions, concerns, or require technical assistance with your product, please do not hesitate to contact JCHICI customer support. We are committed to providing prompt and helpful solutions, including refunds or replacements if necessary.

For support, please refer to the contact information provided on the product packaging or the official JCHICI website. Thank you for choosing JCHICI.