



[Manuals.plus](#) /

> [WITMYA](#) /

> WITMYA Smart Toilet TC02 User Manual

WITMYA WITMYA-TC-02

WITMYA Smart Toilet TC02 User Manual

Model: WITMYA-TC-02 | Brand: WITMYA

1. INTRODUCTION

This user manual provides comprehensive instructions for the installation, operation, maintenance, and troubleshooting of your WITMYA Smart Toilet TC02. Please read this manual thoroughly before using the product to ensure safe and efficient operation. Keep this manual for future reference.

2. SAFETY INFORMATION

WARNING: To reduce the risk of burns, electrocution, fire, or injury to persons, read all instructions before using.

- Ensure proper electrical grounding.
- Do not immerse the product in water or other liquids.
- Do not attempt to disassemble, repair, or modify the product yourself. Contact qualified service personnel.
- Keep children and individuals with reduced physical, sensory, or mental capabilities away from the product unless supervised.
- Unplug the product during lightning storms or when unused for long periods.
- Do not use abrasive cleaners or harsh chemicals on the product surface.
- Ensure water supply is turned off before any maintenance or installation.

The WITMYA Smart Toilet TC02 features built-in leakage protection and flame retardant materials for enhanced safety.



Image: Safety features including dry burning protection, prevention of seat/water/wind overheating, electrical leakage protection, and flame retardant material.

3. PRODUCT OVERVIEW

The WITMYA Smart Toilet TC02 is a modern, elongated smart toilet with integrated bidet functions, designed for enhanced hygiene and comfort. It features advanced technologies such as voice control, foot sensing, and automatic flushing.

3.1 Key Features

- **Tankless Design:** Efficient 1.28 GPF water-saving flush with 360° powerful flushing system. Operates during power outages.
- **Multiple Cleaning Modes:** Feminine care, posterior cleaning, and massage cleaning with self-cleaning nozzles.
- **Adjustable Heated Seat:** Warms within 1 second, with three adjustable temperature levels.
- **Automatic Sensing:** Microwave sensing for automatic lid opening/closing, and foot-sensing flush.
- **Night Convenience:** High-definition LED screen for temperature display and soft night light.
- **Durability & Safety:** Compact one-piece ceramic design, IPX4 waterproof rating, built-in leakage protection.

3.2 Components

The product package includes:

- 1x Smart Toilet with Hose and Components Pre-installed
- 1x Installation Manual (this document)
- 1x Flange & Screw bolt
- 1x Angle Valve
- 1x Toilet Seal
- 1x Wireless Remote Control (including batteries)



Image: Front view of the WITMYA Smart Toilet TC02, highlighting its sleek design and integrated features.



Image: Detailed dimensions of the smart toilet, including length, width, height, and rough-in measurement.

4. SETUP AND INSTALLATION

Proper installation is crucial for the optimal performance and longevity of your smart toilet. It is recommended to have installation performed by a qualified professional.

4.1 Required Tools

- Percussion Drill
- Glue Gun
- Tape Measure
- Adjustable Wrench
- Pliers
- Gradenter (Level)

- Steel Saw
- Knife
- Screwdriver
- Pencil

4.2 Pre-Installation Steps

1. Ensure the rough-in distance from the wall to the center of the drain is at least 11.8 inches.
2. Open the inlet valve and let water run for 3-5 minutes until approximately 3000ml of water has passed through, then close the inlet valve. This flushes out any debris.

4.3 Installation Methods

There are two primary installation methods: without a flange and with a flange. Follow the instructions relevant to your bathroom setup.

Method 1: Without Flange

1. Position the toilet and mark the curve of the ceramic base on the floor with a pencil.
2. Remove the toilet and apply glass cement along the marked outline.
3. Install the toilet seal onto the drain outlet.
4. Carefully place the toilet onto the seal and align it with the marked outline.
5. Wipe up any spilled glass cement immediately.
6. Block the screw holes on the ceramic side with the equipped rubber plugs.
7. Connect the water inlet hose to the angle valve and the toilet.
8. Connect the power cord to a grounded outlet.

Method 2: With Flange

1. If your existing flange is too high, cut off any excess to ensure it is flush with the floor.
2. Assemble the mounting block together with the flange plate as per the diagram.
3. Install the assembled sealing flange into the drain outlet, ensuring a secure fit.
4. Position the toilet and mark the curve of the ceramic base on the floor with a pencil.
5. Remove the toilet and apply glass cement along the marked outline.
6. Carefully place the toilet onto the flange and align it with the marked outline.
7. Wipe up any spilled glass cement immediately.
8. Install the external screw to connect the 7-character fixing component of the toilet flange.
9. Connect the water inlet hose to the angle valve and the toilet.
10. Connect the power cord to a grounded outlet.

Your browser does not support the video tag.

Video: WITMYA Smart Toilet Installation Guide. This video demonstrates the step-by-step process for installing the smart toilet, including preparing the area, connecting water lines, and securing the unit to the floor.

5. OPERATING INSTRUCTIONS

Your WITMYA Smart Toilet TC02 offers various intelligent functions for convenience and hygiene.

5.1 Automatic Sensing Features

- **Automatic Lid Opening/Closing:** The microwave sensing system detects your approach and automatically opens the lid. It closes after a period of inactivity (e.g., 3 minutes after leaving).
- **Foot-Sensing Flush:** A sensor near the base allows for hands-free flushing by simply tapping your foot.
- **Off-seat AUTO Dual Flush:** The toilet automatically flushes when you stand up from the seat.

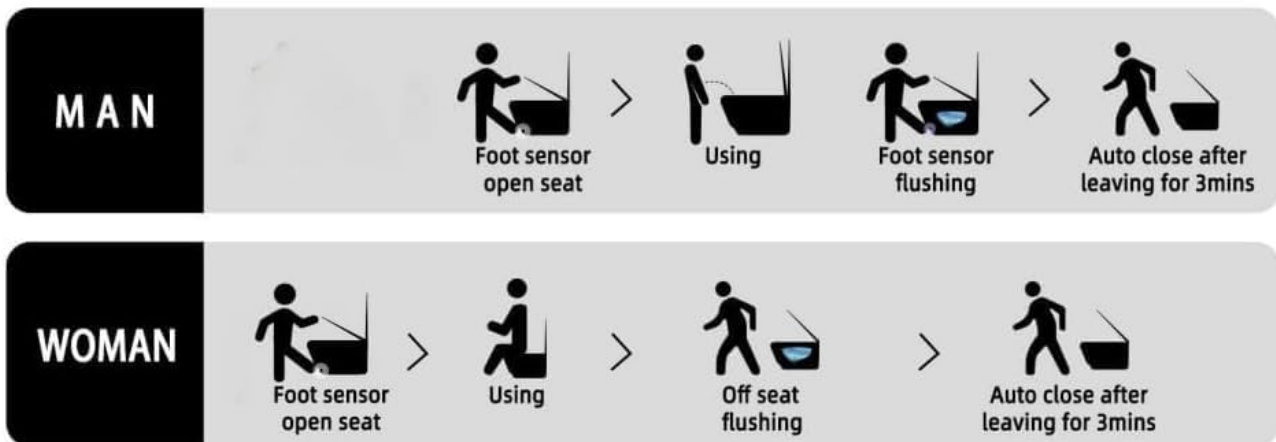

Image: Illustration of the automatic lid opening and flushing sequence activated by foot sensing, differentiating between male and female usage patterns.

5.2 Remote Control and Knob Functions

The wireless remote control and side rotary knob provide full control over the toilet's features.

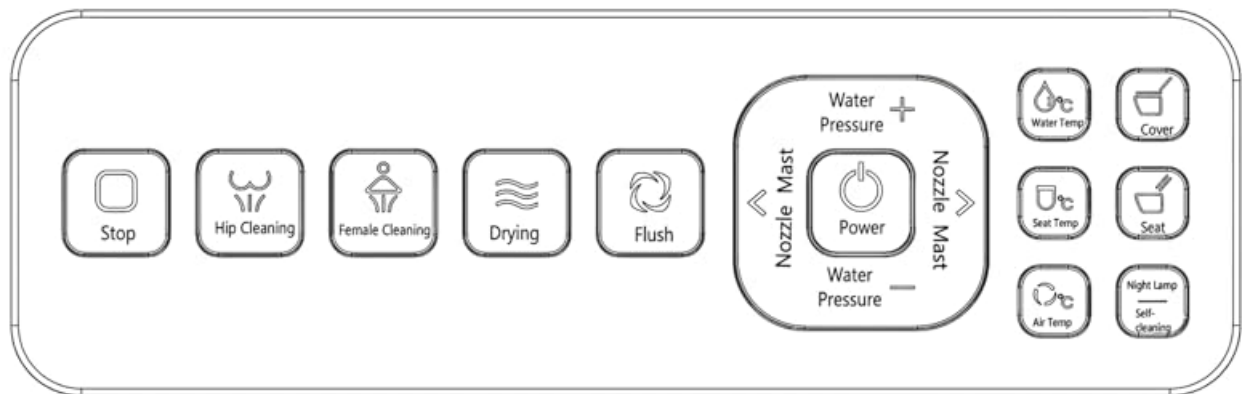

Image: Detailed diagram of the wireless remote control, indicating buttons for stop, hip cleaning, feminine cleaning, drying, flush, nozzle adjustment, water pressure, water temperature, seat temperature, cover control, night lamp, and self-cleaning.

- **Heated Seat:** Adjust the seat temperature using the remote control. The seat warms up within 1 second of sitting.
- **Warm Air Drying:** Adjust the warm air drying temperature and mode via the remote.
- **Cleaning Modes:** Select from feminine care, posterior cleaning, and massage cleaning. Adjust water pressure and temperature as desired.
- **Nozzle Adjustment:** Control the position of the bidet nozzle.
- **Flushing:** Initiate a flush using the remote or the side knob.
- **Night Light:** Activate the soft night light for convenience in low-light conditions.

AIR DRYER

4-Gear Adjustable Temperature



INSTANT HEATED SEAT

Warming up within
1s after seating



Image: Visual representation of the 4-gear adjustable temperature air dryer and the instant heated seat, which warms up within 1 second after seating.

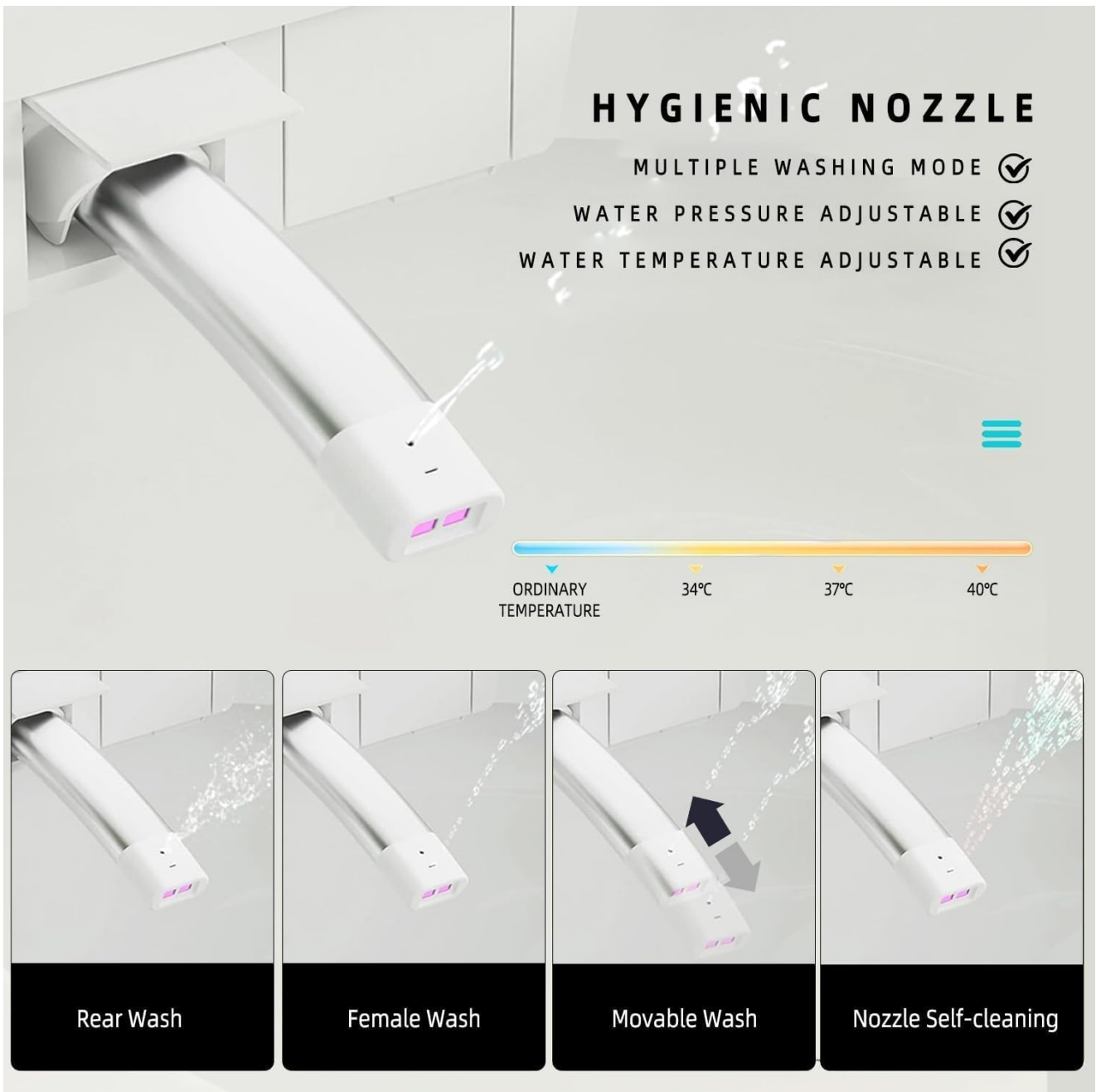

Image: Close-up of the hygienic nozzle, illustrating its multiple washing modes including rear wash, female wash, movable wash, and nozzle self-cleaning, along with adjustable water temperature settings.

5.3 Display Screen

The high-definition LED screen displays real-time water and seat temperatures, along with other operational indicators.

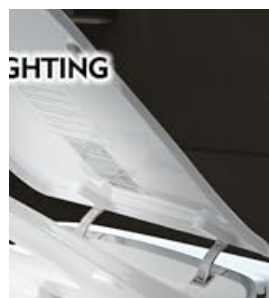

Image: Close-up of the HD LED display on the smart toilet, showing temperature readings and various function icons.

Your browser does not support the video tag.

Video: WT-ST-CY-02 Display Video. This video showcases the various display features and functions of the smart toilet, including

temperature settings and mode indicators.

Your browser does not support the video tag.

Video: TC02 Smart Toilet with Auto Open/close. This video demonstrates the automatic lid opening and closing feature of the TC02 smart toilet, activated by user presence.

Your browser does not support the video tag.

Video: WITMYA BSJ Smart Toilet with Auto Open/close. This video provides another demonstration of the automatic lid opening and closing feature, showcasing its convenience.

Your browser does not support the video tag.

Video: TC02-Smart Toilet Automatic Flushing. This video illustrates the automatic flushing mechanism of the TC02 smart toilet, demonstrating its efficiency and hands-free operation.

6. MAINTENANCE

Regular maintenance ensures the longevity and hygienic performance of your smart toilet.

- **Nozzle Self-Cleaning:** The bidet nozzle performs an automatic self-cleaning cycle before and after each use.
- **Exterior Cleaning:** Use a soft, damp cloth and mild, non-abrasive cleaner to wipe down the exterior surfaces. Avoid harsh chemicals.
- **IPX4 Waterproof:** The product has an IPX4 waterproof rating, meaning it is resistant to splashing water from any direction. However, do not spray water directly onto electrical components or immerse the unit.
- **UV Sterilization:** The toilet features automatic UV sterilization after the lid closes, helping to prevent cross-infection.

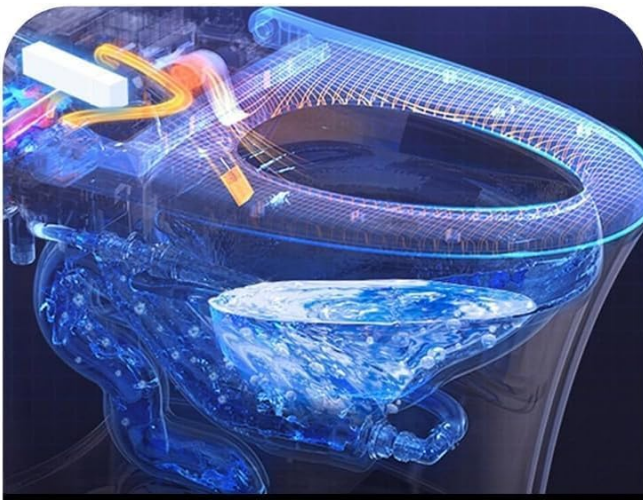

IPX4 WATERPROOF



**MULTIFUNCTION
KNOB CONTROL**



**AMBIENT
NIGHTLIGHT**



REMOTE CONTROL

Image: Overview of key features including IPX4 waterproof design, intuitive multifunction knob control, ambient nightlight for convenience, and comprehensive remote control capabilities.

7. TROUBLESHOOTING

If you encounter issues with your WITMYA Smart Toilet TC02, refer to the common problems and solutions below. For persistent issues, contact customer support.

Problem	Possible Cause	Solution
No power/display off	Power cord unplugged, circuit breaker tripped, power outage.	Check power connection, reset breaker, verify power supply. The toilet supports power-off flushing.

Problem	Possible Cause	Solution
Lid not opening/closing automatically	Sensor obstructed, sensing distance too far, sensor malfunction.	Clear sensor area, adjust sensing distance (if applicable), or contact support.
Bidet not spraying water	Water supply valve closed, nozzle clogged, water pressure too low.	Ensure water valve is open, perform nozzle self-cleaning, check water pressure.
Heated seat not warming	Heated seat function off, temperature setting too low, sensor issue.	Activate heated seat via remote, increase temperature setting.
Flushing issues	Low water pressure, partial clog, sensor issue.	Check water pressure, clear any visible obstructions, ensure sensors are clean.

Your browser does not support the video tag.

Video: WT-ST-CY-02 User Manual. This video provides a quick overview of the smart toilet's features and basic operation, which may assist in initial troubleshooting.

8. SPECIFICATIONS

Attribute	Value
Model Number	WITMYA-TC-02
Color	TC02 Black
Material	Ceramic
Installation Type	Floor Mounted
Item Weight	86 pounds
Product Dimensions	26.77 x 15.75 x 18.9 inches
Power Source	AC
Voltage	110 Volts (AC)
Wattage	1300 watts
Water Consumption	1.28 Gallons per Flush (GPF)
Rough-In	11.8 Inches
Accessory Connection Type	1/2-inch / 3/8-inch

9. WARRANTY AND SUPPORT

WITMYA is committed to providing high-quality products and excellent customer service.

- **Warranty:** If there is a quality problem with the product, WITMYA provides 1 year of free after-sales service.
- **Customer Support:** For any questions, technical assistance, or warranty claims, please contact WITMYA customer support. Professional service teams are available 24 hours online.
- **Returns:** This product is eligible for 30-day easy returns.

For more information, visit the official WITMYA store on Amazon:[WITMYA Store](#)