

Giuqa 4JC1

Giuqa 4JC1 Engine Overhaul Rebuild Kit Instruction Manual

For Isuzu 4JC1 and 4JC1-T Engines

1. PRODUCT OVERVIEW

This Giuqa Engine Overhaul Rebuild Kit is designed for a comprehensive restoration of Isuzu 4JC1 and 4JC1-T engines. The kit includes essential components such as pistons, piston rings, crankshaft bearings, connecting rod bearings, thrust washers, and a full gasket set, excluding cylinder liners and valves. It is intended for professional use in engine rebuilding applications.

2. KIT CONTENTS

The Giuqa 4JC1 Engine Overhaul Rebuild Kit includes the following standard size components:

- 1 Set 4JC1 Full Gasket Kit with Head Gasket
- 1 Set STD 4JC1 Crankshaft / Main Bearings
- 1 Set STD 4JC1 Connecting Rod Bearings
- 1 Set STD 4JC1 Thrust Washers / Bearings
- 4 PCS STD 4JC1 Pistons
- 4 Sets STD 4JC1 Piston Rings
- 4 PCS STD 4JC1 Piston Pins
- 4 Pairs STD 4JC1 Piston Clips

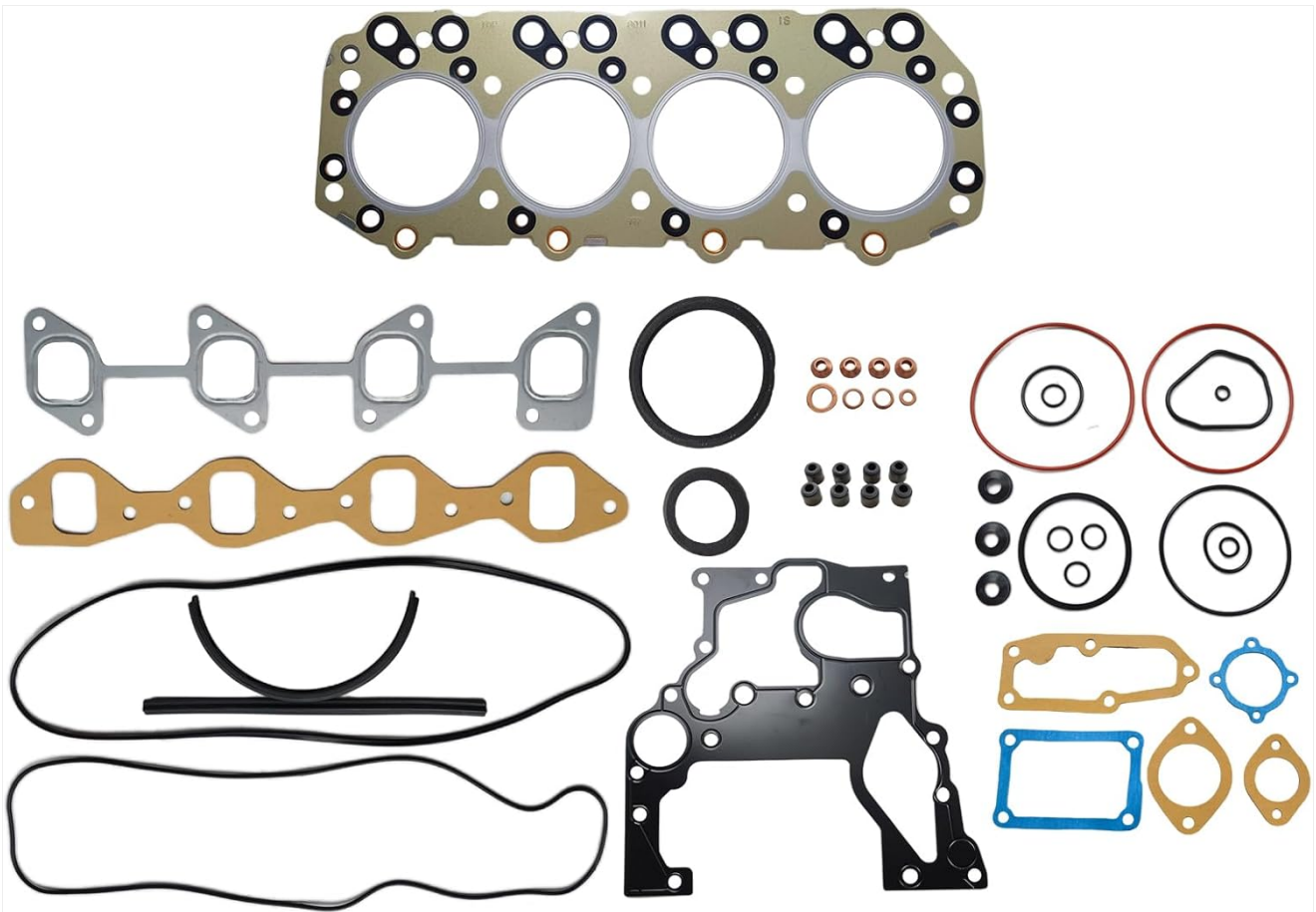

Image 2.1: Overview of the complete Gisuq 4JC1 Engine Overhaul Rebuild Kit components, including various gaskets, seals, bearings, and piston components.

2.1. Gasket Kit

The full gasket kit includes all necessary gaskets and seals for the engine overhaul, such as the head gasket, manifold gaskets, and various oil seals.



Image 2.2: A selection of gaskets and seals from the Giqua 4JC1 Engine Overhaul Rebuild Kit, including a large black gasket and various smaller brown, blue, and black seals.

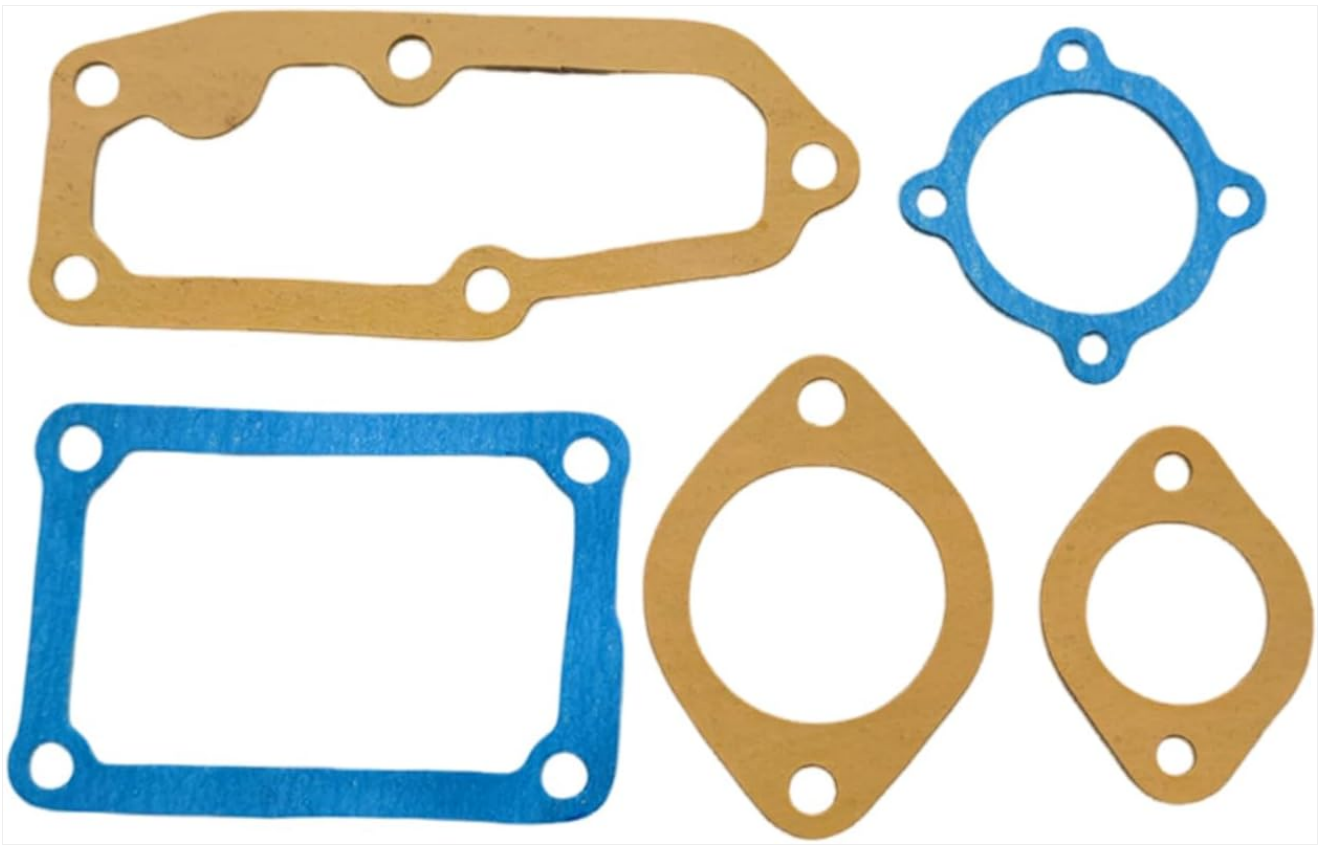

Image 2.3: Various smaller gaskets and seals included in the kit, featuring different shapes and colors (brown, blue) for specific engine components.

2.2. Pistons and Piston Rings

Four standard size pistons, piston pins, and piston clips are included, along with four sets of standard size piston rings. The pistons feature a square combustion chamber design.



Image 2.4: Multiple views of a Giqua 4JC1 engine piston, showcasing its top with a square combustion chamber, side profile, and internal structure.



Image 2.5: Four sets of Giusa 4JC1 engine piston rings, each set containing multiple rings for a single piston.



Image 2.6: A close-up view of a single set of Giuspa 4JC1 engine piston rings, showing the different ring types and their construction.

2.3. Bearings

Standard size crankshaft/main bearings, connecting rod bearings, and thrust washers are provided to ensure proper engine rotation and reduce friction.



Image 2.7: Various engine bearings and thrust washers for the Giqua 4JC1 engine, including main bearings, connecting rod bearings, and thrust washers.

3. SPECIFICATIONS

Key specifications for the pistons included in this kit:

- **Piston Part Number:** 8-97176-852-0 / 8971768520
- **Piston Diameter:** 88mm
- **Piston Height:** 87.7mm
- **Square Combustion Chamber:** 42mm
- **Piston Pin Diameter:** 31mm x 71mm
- **Piston Ring Dimensions:** 2.0mm x 2.0mm x 4.0mm

Full Gasket Kit Part Number: 5-87811396-0 / 5878113960



Ring: 2.0×2.0×4.0mm, Diameter 88 mm
Pin Diameter: 31×71mm

Measurement results may deviate, for reference only.
subject to receipt of the physical object.

Image 3.1: Detailed diagram illustrating the dimensions of the Giqua 4JC1 engine piston, including diameter, height, combustion chamber size, and piston pin diameter.

Note: Measurement results may deviate slightly; these specifications are for reference only. Refer to the physical object received for exact details.

4. APPLICATION

This engine overhaul rebuild kit is specifically designed for:

- Isuzu 4JC1 Engine
- Isuzu 4JC1-T Engine

5. IMPORTANT INSTALLATION NOTES

Professional installation is strongly recommended for this engine overhaul kit. This kit does not include detailed installation instructions. Engine rebuilding requires specialized knowledge, tools, and experience to ensure proper assembly and function. Incorrect installation can lead to engine damage or failure.

Before installation, it is crucial to verify that all components match your specific engine model. If you are uncertain about compatibility, please provide a photo of your engine nameplate, the original product part number, or a photo of the product you need to the seller for confirmation.

Please note that while the kit aims to be accurate, there might be minor deviations between the product images and the physical items due to the large number of components. Always refer to the physical objects received for final confirmation.

6. GENERAL MAINTENANCE (POST-REBUILD)

After a successful engine rebuild, proper maintenance is critical for longevity and performance. Follow your vehicle manufacturer's recommendations for:

- **Initial Break-in Period:** Adhere to specific break-in procedures for newly rebuilt engines, which typically involve controlled RPMs and loads for a certain mileage.
- **Oil Changes:** Perform the first oil change earlier than usual, often after 500-1000 miles, to remove any assembly debris. Subsequently, follow the recommended oil change intervals.
- **Fluid Levels:** Regularly check engine oil, coolant, and other fluid levels.
- **Inspections:** Periodically inspect for leaks, unusual noises, or performance changes.
- **Filter Replacement:** Ensure timely replacement of oil, air, and fuel filters.

7. TROUBLESHOOTING

Should any issues arise after the engine rebuild, it is recommended to consult with a qualified automotive technician or engine specialist. Common issues that may require professional diagnosis include:

- Unusual engine noises
- Oil or coolant leaks
- Overheating
- Loss of power or poor performance
- Excessive smoke from the exhaust

Attempting to diagnose or repair complex engine problems without proper expertise can lead to further damage.

8. SUPPORT

For any questions regarding the compatibility of this kit with your specific engine, or if you require assistance with identifying the correct parts, please contact the seller directly. Providing details such as your engine's nameplate information or part numbers will help facilitate a quick and accurate response.

