

## FORIOUS FF0023BN

# FORIOUS FF0023BN Traditional Brushed Nickel Kitchen Faucet with Pull Down Sprayer User Manual

Model: FF0023BN | Brand: FORIOUS

## 1. PRODUCT OVERVIEW

The FORIOUS FF0023BN Traditional Brushed Nickel Kitchen Faucet is designed for modern kitchens, offering both functionality and aesthetic appeal. This high-arc single-handle faucet features a pull-down sprayer, durable stainless steel construction, and a brushed nickel finish. It is suitable for various settings including farmhouse, RV, camper, and laundry room sinks.



Figure 1: FORIOUS Traditional Brushed Nickel Kitchen Faucet with Pull Down Sprayer.

## 2. KEY FEATURES

---

- **Durable Construction:** Crafted entirely from lead-free stainless steel material, ensuring water safety and long-lasting

durability.

- **Versatile Spray Head:** Features a 3-function spray head (sprayer, stream, and paused modes) and an 18-inch pull-out hose for extended reach and flexibility.
- **Anti-leakage Design:** Equipped with a tested valve that has withstood over 5,000,000+ cycles, providing reliable leak-free performance.
- **Easy Installation:** Pre-installed components allow for DIY installation, potentially saving time and money on professional plumbing services.
- **Aesthetic Finish:** Multi-layer brushed nickel plating resists fingerprints and water stains, making it easy to clean and maintain.
- **360° Swivel Spout:** Offers full swivel capability, providing maximum flexibility and easy access to all areas of the sink for added convenience.

### 3. SPECIFICATIONS

Brand	FORIOUS
Model Name	Kitchen Faucet with Pull Down Sprayer (FF0023BN)
Color	Brushed Nickel
Material	Stainless Steel
Finish Type	Brushed
Mounting Type	Deck Mount
Number of Handles	1
Hole Count	1 (or 3 with included deck plate)
Spout Height	6.7 inches
Overall Height	14.8 inches
Spout Reach	9.79 inches
Maximum Flow Rate	1.8 Gallons Per Minute
Required Pre-drilled Hole Size	1.30" - 1.38"
Max. Countertop Thickness	1.5 inches
Connection Thread	3/8"
Certifications	DOE Certificate, NSF/ANSI/CAN 61, Lead-free Certificate

## COMPATIBILITY INSTALLATION

1.30-1.38 ins

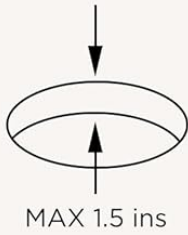
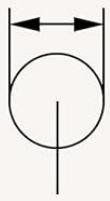

**MOUNTING HOLE SIZE**  
1.30-1.38 INCHES

**MAXIMUM THICKNESS  
OF COUNTER-TOP**  
1.5 INCHES

## SUPPLY HOSE SIZE

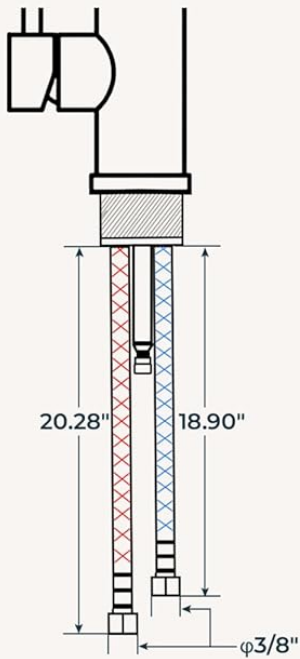

# DIMENSIONS

SPOUT REACH **9.8 inches**



**OPTINAL DECK PLATE (Included)**  
10.04 inches wide  
**8 inches** between hole centers

Figure 2: Detailed dimensions and compatibility information for installation.

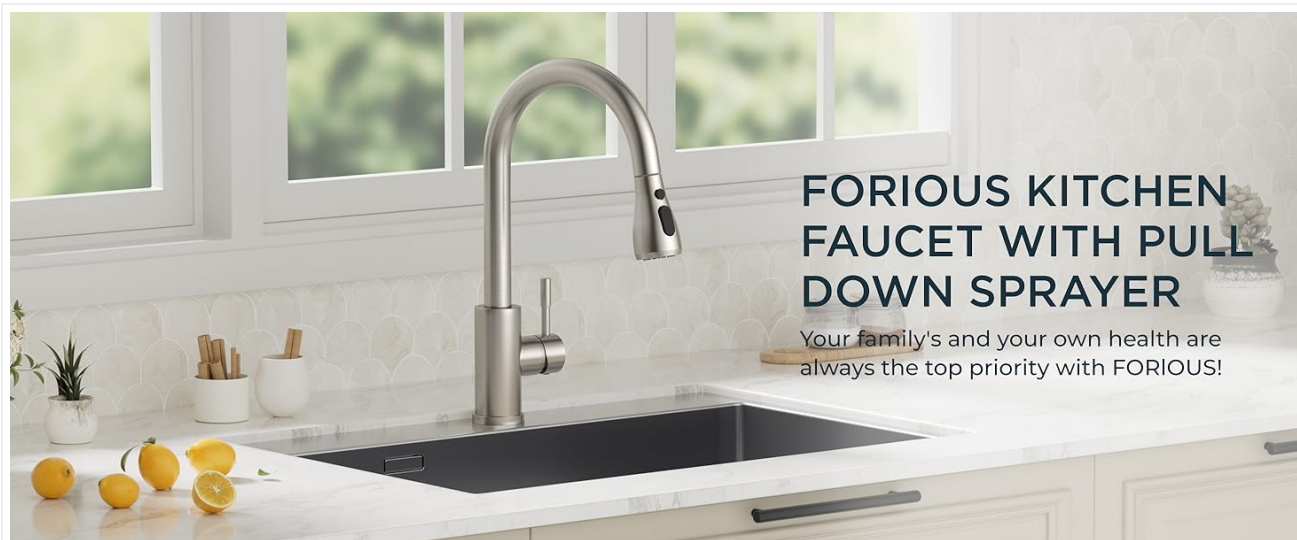

Figure 3: Additional product dimensions and important installation notes regarding the gravity ball placement.

## 4. SETUP AND INSTALLATION

---

The FORIOUS kitchen faucet is designed for effortless DIY installation. Follow these steps carefully for a secure and leak-free setup.

### 4.1 Before Installation

- Shut off the main water supply valves.
- Clear the area of the mounting holes on the countertop.
- Ensure your pre-drilled hole size is between 1.30" and 1.38" and maximum countertop thickness is 1.5".

### 4.2 Installation Steps

1. Take the faucet out of the packaging box. For a 1-hole sink, install the deck plate (if desired) or directly install the faucet. For a 3-hole sink, install the deck plate first, then the faucet.
2. Place the faucet body into the mounting hole on the countertop.
3. From underneath the sink, slide the rubber gasket, metal washer, and mounting nut onto the connected hoses. Hand-tighten the mounting nut.
4. Tighten the screws on the mounting nut using a screwdriver. **Caution: Avoid over-tightening.**
5. Attach the pull-down hose's quick-connect fitting to the faucet outlet.
6. Position the weighted ball on the pull-down hose at the locator mark (typically 8 inches from the bottom of the faucet). Use a screwdriver to loosen and then tighten the screw on the weighted ball to secure it. Ensure 20x20cm clear space for smooth retraction.
7. Connect the hot and cold water supply hoses to the corresponding water supply valves. Use a wrench to snugly tighten the connection nuts.
8. Open the water supply valves to flush out any residue before using the faucet.

Your browser does not support the video tag.

Video 1: Official FORIOUS Product Installation Guide. This video demonstrates the step-by-step process of installing the kitchen faucet, including attaching hoses, securing the mounting nut, and positioning the weighted ball for the pull-down sprayer.

## PREMIUM PVD COATING, EASY TO MAINTAIN



Figure 4: Visual guide for the easy installation process, showing key steps from placing the faucet to connecting water lines.

## 5. OPERATION

### 5.1 Water Flow and Temperature Control

The single handle lever controls both water flow and temperature. Move the handle up to increase flow and down to decrease. Move it left for hot water and right for cold water.

### 5.2 Pull-Down Sprayer Functions

The pull-down sprayer offers three distinct modes:

- **Stream Mode:** Ideal for filling pots and general washing.
- **Spray Mode:** Provides a wider spray for rinsing dishes and cleaning the sink.
- **Pause Mode:** Temporarily stops water flow, useful for moving the sprayer between tasks without turning off the main handle.

# FORIOUS Escort For Your Health

Obtained **CUPC, NSF+ANSI+CAN 61, LEAD FREE**

Authority Certifications

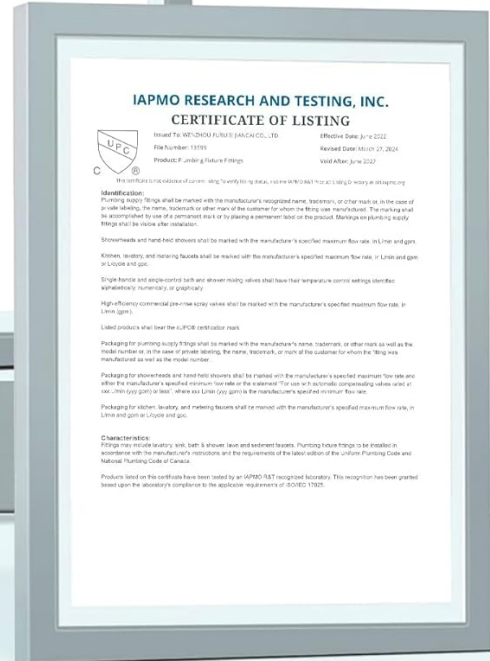
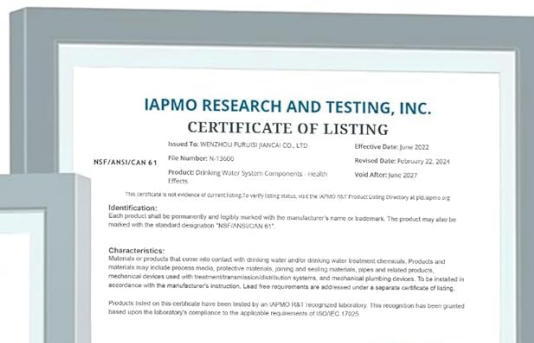

Cupc/NSF/LEAD FREE Certified by  
(IAPMO Research and Testing, Inc.)in (2024)

Figure 5: Illustration of the three spray modes available on the pull-down sprayer: Stream, Spray, and Pause.



Figure 6: Detailed view of the 3-function spray head, highlighting the different water flow options.



Figure 7: The faucet's 360° swivel design and extended pull-down hose for wider cleaning range.

## 6. MAINTENANCE

Proper maintenance ensures the longevity and optimal performance of your FORIOUS kitchen faucet.

- **Cleaning:** Always blot dry any water from the faucet surface. Clean with a damp non-abrasive sponge and a soft cloth to maintain the finish.
- **Mineral Deposits:** To remove water spots, apply warm water and a damp soft cloth. For stubborn deposits, use a mild soap solution. Avoid harsh chemicals or abrasive cleaners.

- **Spray Nozzles:** The soft rubber spray holes allow mineral residue to be wiped away simply. Regularly clean these to ensure a steady flow of water.
- **Ceramic Valve:** The faucet features a durable ceramic valve designed for long-term, leak-proof use.



Figure 8: Highlights of the faucet's lead-free material, 360° rotation, and easy-to-clean rubber spray holes.

# LEAK-PROOF FAUCET VALVE

PASS **50000+**  
Cycle Testing  
Leak No More, Problem Solved



Figure 9: Illustration of the leak-proof faucet valve, tested for over 50,000 cycles.

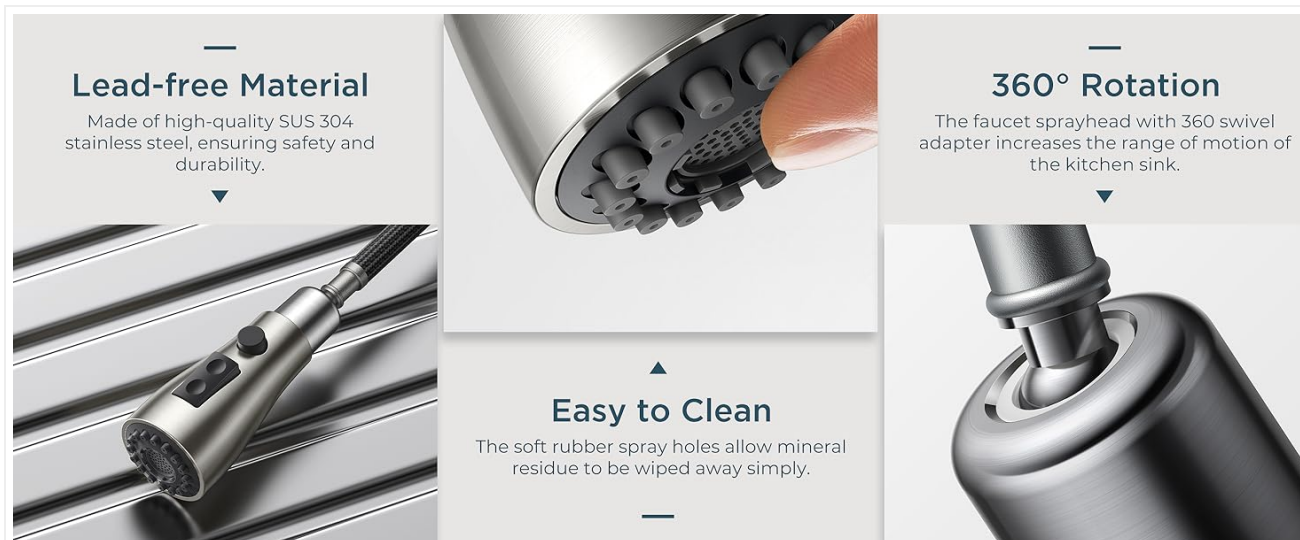

Figure 10: Information on the ceramic valve's extended lifespan and leak-proof qualities.



Figure 11: Details about the faucet's premium PVD coating, offering lead-free, fingerprint-resistant, water-repellent, rust protection, and easy-to-clean properties.







## 7. TROUBLESHOOTING

Problem	Possible Cause	Solution
Low Water Flow	Clogged aerator or mineral buildup in spray nozzles.	Clean the aerator and wipe rubber spray holes to remove mineral deposits. Ensure water supply valves are fully open.
Leaking from Faucet Base	Loose mounting nut or improper installation of gaskets.	Check and tighten the mounting nut underneath the sink. Ensure all gaskets are correctly seated.
Sprayer Not Retracting Smoothly	Improper placement of the weighted ball or obstruction under the sink.	Verify the weighted ball is positioned correctly on the hose at the locator mark. Ensure there is clear space (20x20cm) for the hose to move freely.
Water Temperature Issues	Incorrect hot/cold water line connection or issues with water heater.	Confirm hot and cold water lines are connected to the correct valves. Check water heater settings.

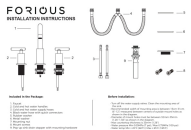
## 8. WARRANTY AND SUPPORT

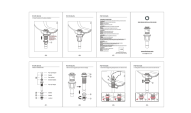
The FORIOUS FF0023BN Kitchen Faucet comes with a **limited warranty**. For specific warranty details and to register your product, please refer to the documentation included in your product packaging or visit the official FORIOUS website. For technical support, replacement parts, or any inquiries, please contact FORIOUS customer service. Contact information can typically be found on the product packaging or the manufacturer's website.

### Related Documents - FF0023BN

	<p><a href="#">FORIOUS Bathroom Faucet Installation Guide</a></p> <p>Comprehensive installation instructions for FORIOUS bathroom faucets, detailing included parts, pre-installation requirements, step-by-step assembly, and essential maintenance tips.</p>
	<p><a href="#">FORIOUS LL0216BN-5 Bathroom Hardware Installation Guide</a></p> <p>Detailed installation instructions and package contents for the FORIOUS LL0216BN-5 bathroom hardware set, including towel bar, towel ring, toilet paper holder, and robe hooks.</p>
	<p><a href="#">FORIOUS Sink Drain Installation Guide and Troubleshooting</a></p> <p>Comprehensive installation guide and troubleshooting tips for FORIOUS sink drain assemblies, including pop-up stoppers and drain bodies. Learn how to install and fix common issues with your FORIOUS sink drain.</p>
	<p><a href="#">FORIOUS Multi-Function Shower Panel Installation and Usage Guide</a></p> <p>Comprehensive guide for installing and using the FORIOUS Multi-Function Shower Panel, featuring LED display, rainfall, waterfall, handheld sprayer, and massage jets. Includes technical specifications, care instructions, and troubleshooting tips.</p>
	<p><a href="#">FORIOUS Widespread Bathroom Faucet Installation Guide</a></p> <p>Comprehensive installation and maintenance guide for FORIOUS widespread bathroom faucets, detailing parts, specifications, step-by-step assembly, and care instructions.</p>
	<p><a href="#">Forious CFLT-2020 Kitchen Faucet Installation Guide</a></p> <p>Detailed installation instructions for the Forious CFLT-2020 kitchen faucet, including parts list, required tools, and step-by-step guidance for a secure and proper setup.</p>