

## VEVOR SL6319

# VEVOR SL6319 A3 Cold & Hot Laminator Machine User Manual

Model: SL6319

## 1. INTRODUCTION

---

Thank you for choosing the VEVOR SL6319 A3 Cold & Hot Laminator Machine. This manual provides essential information for the safe and efficient operation, maintenance, and troubleshooting of your laminator. Please read these instructions thoroughly before using the device and retain them for future reference.

## 2. SAFETY INSTRUCTIONS

---

- Read all instructions before use.
- Keep the laminator away from water and moisture. Do not operate with wet hands.
- Ensure the power supply matches the voltage requirements of the laminator.
- Do not open or attempt to repair the laminator yourself. Refer all servicing to qualified personnel.
- Keep children and pets away from the laminator during operation.
- Place the laminator on a stable, flat surface with adequate ventilation.
- Unplug the laminator when not in use or before cleaning.
- Avoid laminating sharp objects, metal, or items thicker than the specified maximum.
- Use only laminating pouches designed for thermal or cold lamination, as appropriate.

## 3. PACKAGE CONTENTS

---

The VEVOR SL6319 Laminator Machine package includes the following items:

- VEVOR SL6319 A3 Cold & Hot Laminator Machine
- Laminating Pouches (various sizes: A4, A5, A6)
- Corner Rounder

- Hole Punch
- Paper Cutter (with 3 spare blades)
- File Rings (3 pieces)



Image: VEVOR SL6319 Laminator Machine shown with its various accessories, including laminating pouches, a corner rounder, hole punch, and paper cutter, alongside laminated documents.

## Rich Accessories to Meet Various Needs

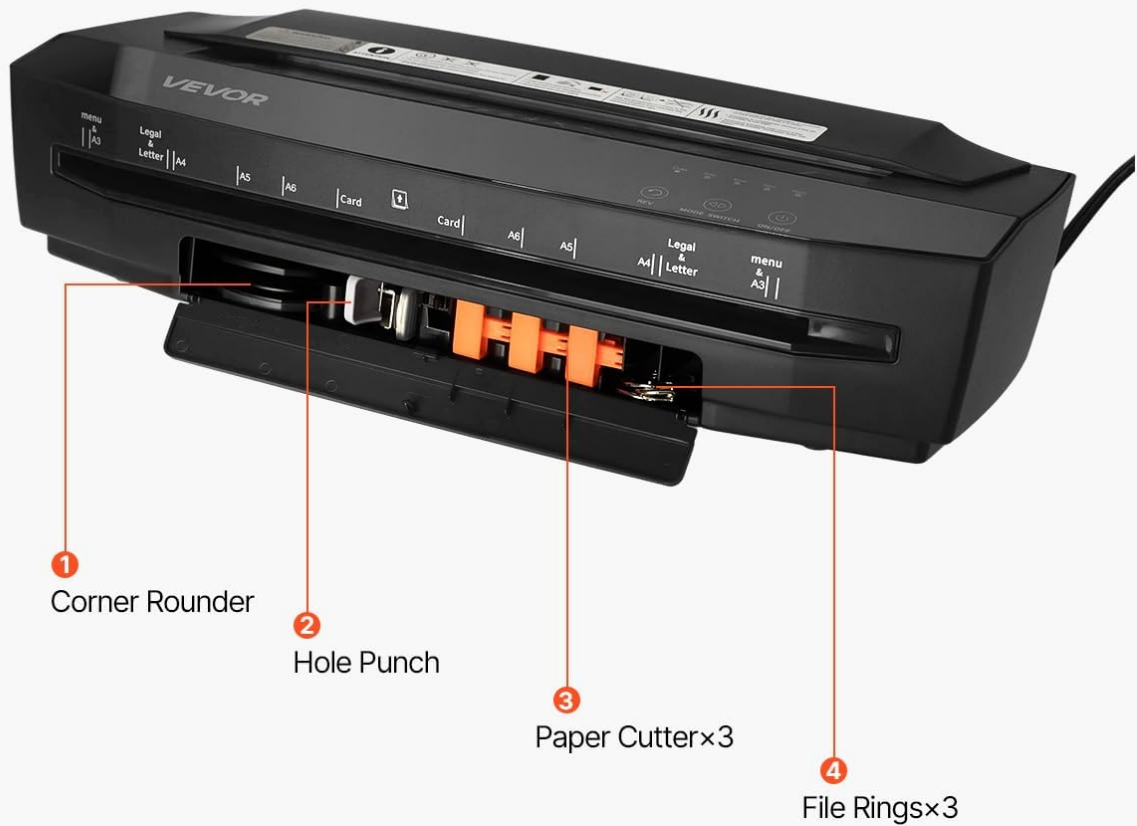

Image: A detailed view of the accessories provided with the laminator, highlighting the corner rounder, hole punch, paper cutter, and file rings.

### 4. PRODUCT OVERVIEW

The VEVOR SL6319 is a versatile laminator supporting both cold and hot lamination for documents up to A3 size. It features a quick warm-up time and efficient laminating speed, designed for various applications in home, office, or school settings.



Image: Top-down view of the VEVOR SL6319 Laminator Machine, illustrating the control panel with buttons for reverse, mode switch, and power, along with paper size guides.



Image: An angled view of the VEVOR SL6319 Laminator Machine, showcasing its sleek black design and compact form factor.

## 5. SETUP

1. **Unpack:** Carefully remove the laminator and all accessories from the packaging.
2. **Placement:** Place the laminator on a stable, flat, and heat-resistant surface. Ensure there is enough space around the machine for proper ventilation and for documents to exit.
3. **Power Connection:** Plug the power cord into a suitable electrical outlet.

## 6. OPERATING INSTRUCTIONS

### 6.1 Power On and Mode Selection

1. Press the **ON/OFF** button to power on the laminator.
2. The machine will begin to preheat. The preheat time is approximately 1 minute.
3. Use the **MODE SWITCH** button to select the desired lamination mode and film thickness:
  - **Cold Mode:** For heat-sensitive materials like old photos or receipts. The indicator light for 'Cold'

will illuminate.

- **Hot Mode (3 mil, 5 mil, 10 mil):** For standard documents, photos, and certificates. Select the appropriate thickness (3 mil, 5 mil, or 10 mil) based on your laminating pouch. The corresponding indicator light will illuminate.

4. Wait for the selected mode's indicator light to turn solid, indicating the machine has reached the optimal temperature for hot lamination or is ready for cold lamination.

## Adaptable for Various Laminating Materials

Hot and Cold Dual Mode



### Cold Mode



DIY Bookmarks



Tickets



Old Photos



Heat-Sensitive Materials



### Hot Mode



Menu



Photos



Certificates



Documents



Image: A visual guide explaining the applications for Cold Mode (DIY bookmarks, tickets, old photos, heat-sensitive materials) and Hot Mode (menus, photos, certificates, documents).

# 1 min Quick Preheat for Efficient Performance

39.4 in / min  
Laminating Speed



Image: The laminator displaying its rapid performance with a 1-minute preheat time and a laminating speed of 39.4 inches per minute.

## 6.2 Laminating Process

1. **Prepare Document:** Place your document neatly inside a laminating pouch, ensuring it is centered and there is an even border around the edges.
2. **Insert Pouch:** With the sealed edge of the pouch first, carefully insert it straight into the laminator's entry slot. The machine will automatically feed the pouch through.
3. **Retrieve:** Once the laminated document exits the machine, allow it to cool on a flat surface before handling or trimming.



Image: A user demonstrating the process of feeding a document, enclosed in a laminating pouch, into the VEVOR laminator machine.

### 6.3 Jam Release Function

In the event of a paper jam or misalignment, the laminator features an ABS jam release function:

- Press and hold the **ABS** button (or **REV** button if labeled as such) located on the control panel.
- While holding the button, gently pull the jammed pouch out of the entry slot.
- Release the button once the pouch is removed.
- Inspect the pouch and document for damage. If undamaged, you may attempt lamination again with a new pouch.

# One-Touch Paper Jam Prevention Protect Your Documents

Lightly Touch the ABS Button to Quickly Remove the Film



Image: A hand pressing the ABS button on the laminator's control panel, demonstrating the one-touch jam release feature.

## 7. MAINTENANCE

- **Cleaning:** Ensure the laminator is unplugged and completely cool before cleaning. Wipe the exterior with a soft, dry cloth. Do not use abrasive cleaners or solvents.
- **Roller Cleaning:** Periodically run a cleaning sheet (available separately) through the laminator to remove adhesive residue from the rollers.
- **Storage:** Store the laminator in a clean, dry place when not in use.

## 8. TROUBLESHOOTING

| <b>Problem</b>                             | <b>Possible Cause</b>                                    | <b>Solution</b>   |
|--|--|---|
| Laminator does not turn on.                | No power supply.   | Check power cord connection and wall outlet.  |
| Document jams.                             | Pouch inserted incorrectly or too thick.                 | Use the ABS/REV button to release. Ensure pouch is inserted straight and not exceeding maximum thickness. |
| Poor lamination quality (bubbles, cloudy). | Incorrect temperature setting, old pouches, or moisture. | Ensure correct temperature/mil setting. Use fresh, high-quality pouches. Ensure documents are dry.        |
| Laminator is slow to heat up.              | Normal operation or environmental factors.               | Allow the full 1-minute preheat time. Ensure adequate ventilation.  |

## 9. SPECIFICATIONS

| <b>Feature</b>            | <b>Specification</b>                         |
|---------------------------|--|
| Item Model Number         | SL6319                                       |
| Maximum Power Consumption | 1200W  |
| Film Width                | Maximum A3 (12.6 inches / 320 mm)            |
| Lamination Film Thickness | 3-10 mil                                     |
| Preheat Time              | 1 minute                                     |
| Rollers                   | 4-Roller System                              |
| Laminating Speed          | 39.4 inches/minute (1000 mm/minute)          |
| ABS Anti-Jam Function     | Yes  |
| Auto Shut-off             | Yes  |
| Net Weight                | 7.1 lbs / 3.2 kg                             |
| Product Dimensions        | 16.9 x 6.5 x 4.1 inches (428 x 166 x 103 mm) |
| Lamination Function       | 2-in-1 Hot and Cold Lamination               |

# Supports A3 and Smaller Paper Sizes



12.6 in / 320 mm

Max Lamination Width:  
**12.6 in / 320 mm**

Lamination Thickness:  
**3~10 mil**



Image: Illustration of the laminator's compatibility with A3, A4, A5, and A6 paper sizes, detailing a maximum lamination width of 12.6 inches (320 mm) and a thickness range of 3-10 mil.

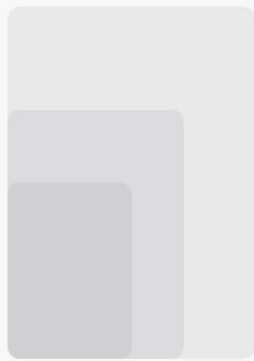

15 x Laminating Sheets  
(5 x A4, 5 x A5, 5 x A6)



3 x Binder Rings



3 x Paper Cutter



1 x Corner Rounder



1 x Hole Punch

Item Model Number: **SL6319**      Auto Shut-off: **Yes**  
 Maximum Power Consumption: **1200W**      Rollers: **4-Roller System**  
 Film Width: **Maximum A3**      Speed: **39.4 in / min; 1000 mm / min**  
 Lamination Film Thickness: **3-10 mil**      ABS Anti-Jam: **Yes**  
 Preheat Time: **1min**      Net Weight: **7.1lbs / 3.2 kg**  
 Product Dimensions: **16.9 x 6.5. x 4.1 in / 428 x 166 x 103 mm**  
 Lamination Function: **2-in-1 Hot and Cold Lamination**

Image: A comprehensive overview of the VEVOR SL6319 laminator's dimensions and key technical specifications, including power consumption, preheat time, and roller system.

## 10. WARRANTY AND SUPPORT

VEVOR products are designed for durability and performance. For warranty information, technical support, or service inquiries, please refer to the official VEVOR website or contact their customer service directly. Please have your model number (SL6319) and purchase details ready when contacting support.