

Mesqool CR1030

Mesqool CR1030 Solar Hand-Crank AM/FM Radio User Manual

Model: CR1030 | Brand: Mesqool

INTRODUCTION

This manual provides detailed instructions for the Mesqool CR1030 Solar Hand-Crank AM/FM Radio. Please read this manual thoroughly before using the device to ensure proper operation and to maximize its features. This versatile radio is designed for emergency preparedness, outdoor activities, and daily use, offering multiple power sources and essential functions.

PRODUCT OVERVIEW

The Mesqool CR1030 is a multi-functional emergency radio equipped with AM/FM reception, a powerful 12000mAh power bank, various charging methods, a bright flashlight, a reading light, and an SOS alarm. Its robust design ensures reliability in diverse environments.



Image: Front view of the Mespool CR1030 radio, showing the solar panel, flashlight, control knobs, and a smartphone connected for charging.

Key Features:

- **AM/FM Radio Reception:** Wide frequency range for reliable signal acquisition.
- **12000mAh Power Bank:** High-capacity battery for charging external devices.
- **Five Charging Methods:** Type-C USB, Solar Panel, Hand-Crank, Built-in Battery, AAA Batteries (not included).
- **Integrated Lighting:** 5W LED flashlight and 12-LED reading light with adjustable brightness.
- **SOS Alarm:** Loud siren and flashing light for emergency signaling.
- **Durable Design:** IPX6 waterproof and IPX4 dustproof rating with a robust ABS shell.
- **High-Quality Audio:** 57mm full-range speaker and 3.5mm headphone jack.

SETUP

Initial Charge:

Before first use, it is recommended to fully charge the radio's internal 12000mAh battery using the Type-C

USB cable. Connect the Type-C cable to the radio's input port and the other end to a standard USB power adapter (not included). A full charge typically takes 5-6 hours.

Battery Installation (Optional):

The radio can also operate on 3 AAA batteries (not included) as an alternative power source. Open the battery compartment, insert the AAA batteries according to the polarity indicators, and close the compartment securely.

OPERATING INSTRUCTIONS

Radio Operation:

1. **Power On/Off:** Rotate the "VOLUME" knob clockwise to turn the radio on and adjust the volume. Rotate counter-clockwise to turn off.
2. **Select Band:** Use the "BAND" switch to select between FM, AM, or Weather Band (if available on your model).
3. **Tune Frequency:** Extend the telescopic antenna for better reception. Rotate the "TUNING" knob to scan for radio stations. The frequency display will show the current station.
4. **Headphone Use:** Insert 3.5mm headphones into the headphone jack for private listening.

High - Sensitivity Reception

Suitable For Camping And Emergencies

AM: 520-1710 kHz
FM: 87-108 MHz

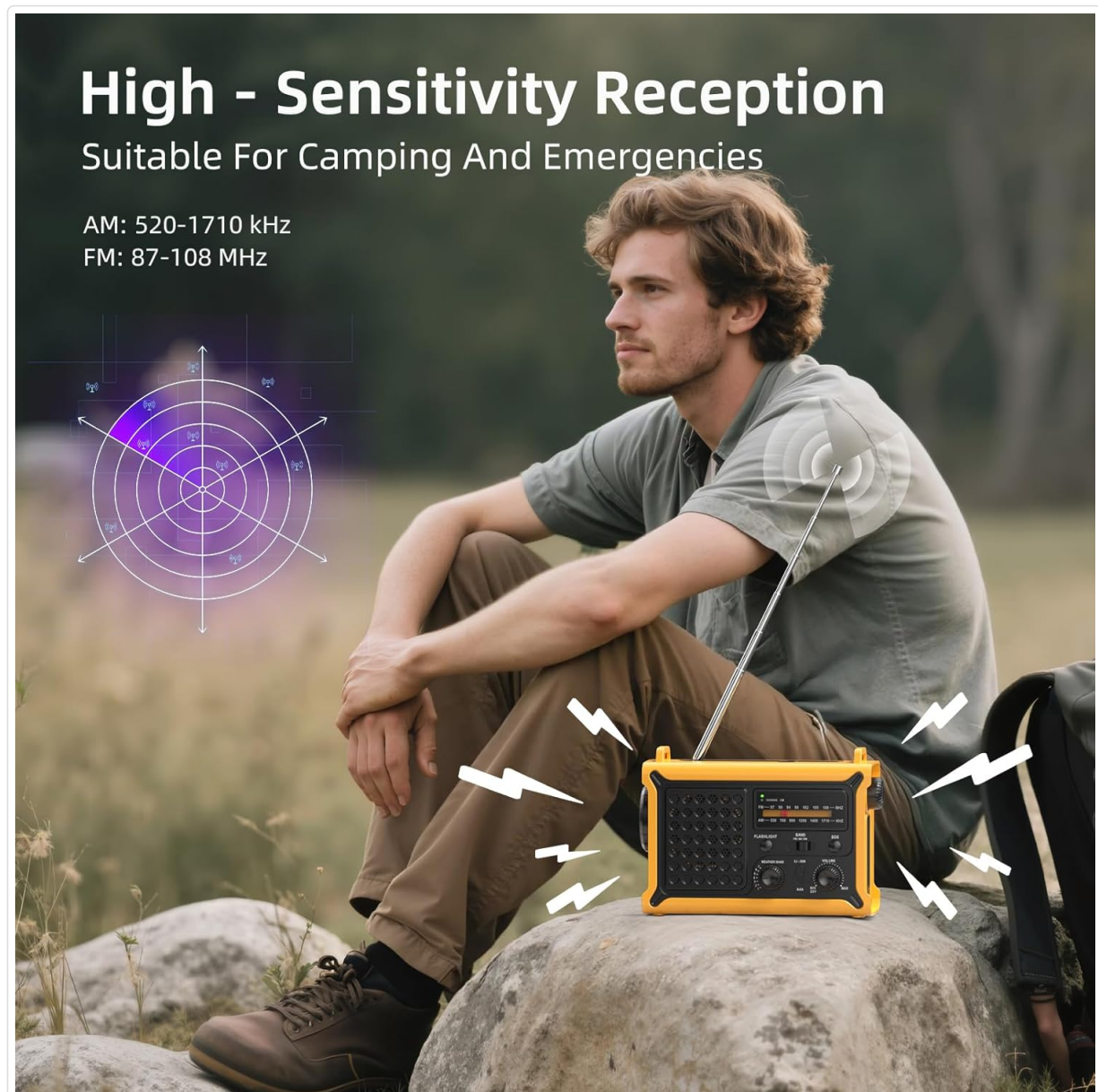

Image: A person sitting outdoors, listening to the Mesqool radio with its telescopic antenna extended for optimal signal reception.

Charging the Radio (5 Methods):



Image: A collage illustrating the five different charging methods for the Mesqool CR1030 radio: hand-crank, built-in battery, Type-C charging, solar panel, and AAA battery compartment.

1. **Type-C USB Charging:** Connect the provided Type-C cable to the radio's input port and a USB power source. This is the fastest and most efficient charging method.
2. **Solar Panel Charging:** Place the radio with the solar panel facing direct sunlight. The solar panel (8500mm²) will convert sunlight into energy to charge the internal battery. This method is ideal for maintaining charge or slow charging in outdoor conditions.
3. **Hand-Crank Charging:** Unfold the hand-crank handle and rotate it clockwise or counter-clockwise at a steady pace (approximately 130-150 RPM). Cranking for 1 minute can provide several minutes of radio operation or flashlight use.
4. **Built-in 12000mAh Battery:** The radio comes with a large capacity internal battery that powers all functions.
5. **AAA Battery Power:** Insert 3 AAA batteries (not included) into the designated compartment. This serves as an additional backup power source.

8500_{mm}² Monocrystalline Solar Panel

Oversized Solar Panels Charge Faster
Than Standard Solar Radios

Solar Panel Power: Up To 350mA



Image: The Mesqool CR1030 radio highlighting its 8500mm² monocrystalline solar panel and product dimensions.

Light Functions:

5W Super Led Flashlight

Long Distance Beam (80-100m Range)



12-Led Reading Light

Soft, Even Light For Clear, Comfortable Viewing



Image: Top panel shows the 5W LED flashlight beam illuminating a tent in the dark. Bottom panel shows a child reading a book under the soft light of the 12-LED reading lamp.

- **Flashlight:** Press the "FLASHLIGHT" button to turn on the 5W LED flashlight. Press again to turn off.
- **Reading Light:** Lift the solar panel to reveal the 12-LED reading light. Press the dedicated reading light button to turn it on. Some models may offer two brightness levels; press again to cycle through them.

SOS Alarm:

In an emergency, press the "SOS" button. The radio will emit a loud 120dB siren and activate a flashing light to attract attention. Press the "SOS" button again to deactivate the alarm.

Power Bank Function:

The built-in 12000mAh battery can be used to charge external devices such as smartphones. Connect your device to the radio's USB or Type-C output port using an appropriate charging cable. The radio will automatically begin charging your device.

Built-in 12000mAh High Capacity Battery

3X Standard Radio Capacity



Image: The Mesqool CR1030 radio simultaneously charging a smartphone via its USB port and connected to headphones via the 3.5mm jack.

MAINTENANCE

- **Cleaning:** Wipe the radio with a soft, damp cloth. Do not use harsh chemicals or abrasive cleaners.
- **Storage:** Store the radio in a cool, dry place away from direct sunlight and extreme temperatures. If storing for extended periods, ensure the internal battery is charged to approximately 50-70% and recharge every 3-6 months to prolong battery life.
- **Water Resistance:** The radio is IPX6 waterproof, meaning it can withstand strong jets of water. However, it is not designed for submersion. Ensure all port covers are securely closed to maintain water resistance.
- **Dust Resistance:** The radio is IPX4 dustproof, offering protection against solid objects larger than 1mm.

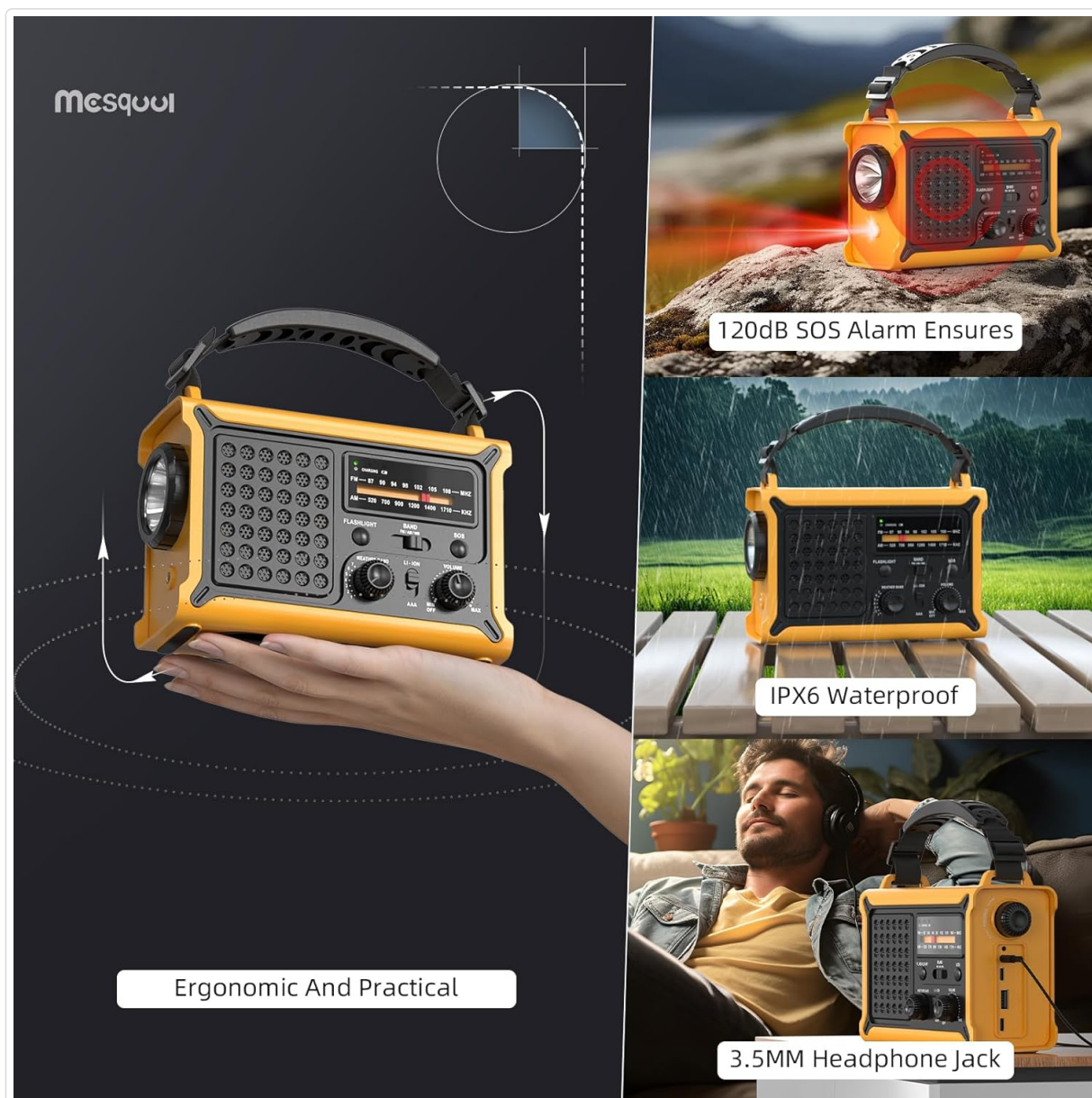

Image: A composite image demonstrating the ergonomic design of the Mesqool radio, its 120dB SOS alarm, IPX6 waterproof rating, and the 3.5mm headphone jack.

TROUBLESHOOTING

Problem	Possible Cause	Solution
Radio does not turn on.	Battery is depleted; volume knob is off.	Charge the radio using Type-C, solar, or hand-crank. Ensure the volume knob is turned clockwise. Check AAA batteries if installed.
Poor radio reception.	Antenna not extended; weak signal area; interference.	Fully extend the telescopic antenna. Adjust the radio's position. Try tuning slowly.
Flashlight/Reading light not working.	Battery is low; light button not pressed correctly.	Charge the radio. Ensure the respective light button is pressed firmly.

Problem	Possible Cause	Solution
External device not charging.	Radio battery is low; incorrect cable; device not compatible.	Ensure the radio's internal battery is sufficiently charged. Use a compatible USB/Type-C cable. Verify device compatibility.
Hand-crank is stiff or not charging.	Mechanism obstruction; insufficient rotation speed.	Ensure no debris is obstructing the crank. Rotate at a consistent speed of 130-150 RPM.



SPECIFICATIONS

- **Model:** CR1030
- **Brand:** Mesqool
- **Radio Bands:** AM (520-1710 KHz), FM (87-108 MHz)
- **Internal Battery:** 12000mAh (rechargeable)
- **External Battery Option:** 3 x AAA batteries (not included)
- **Charging Methods:** Type-C USB, Solar Panel, Hand-Crank, Internal Battery, AAA Batteries
- **Solar Panel Size:** 8500mm²
- **Flashlight:** 5W LED
- **Reading Light:** 12-LED (5W)
- **SOS Alarm:** 120dB
- **Speaker:** 57mm Full-Range
- **Connectivity:** USB (output), Type-C (input/output), 3.5mm Headphone Jack
- **Water Resistance:** IPX6
- **Dust Resistance:** IPX4
- **Dimensions:** 17.3 cm (L) x 12.1 cm (W) x 7.4 cm (H)
- **Material:** ABS Hard Shell

WARRANTY AND SUPPORT

The Mesqool CR1030 radio comes with an **18-month manufacturer's warranty**. This warranty covers defects in materials and workmanship under normal use. It does not cover damage caused by misuse, accidents, unauthorized modifications, or natural disasters.

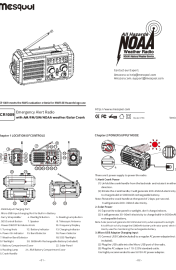
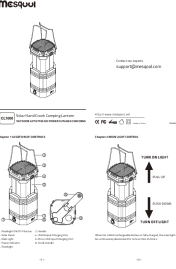
For warranty claims, technical support, or any inquiries regarding your product, please contact Mesqool customer service through the retailer's platform or the official Mesqool website. Please have your purchase receipt and product model number (CR1030) available when contacting support.

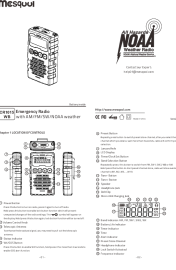
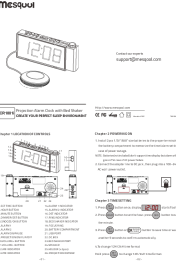
 <p>The image shows the Mesqool CR1009 Emergency Alert Radio, a portable device with a speaker, antenna, and various control buttons. It also includes a NOAA weather alert logo.</p>	<p>Mesqool CR1009 Emergency Alert Radio User Manual</p> <p>Comprehensive user manual for the Mesqool CR1009 Emergency Alert Radio, detailing its features, operation, power supply modes, and specifications. Includes AM/FM/SW/NOAA weather bands, solar crank, and USB charging capabilities.</p>
 <p>The image shows the Mesqool CL1000 Solar Hand Crank Camping Lantern, a cylindrical lantern with a handle and a solar panel. It also includes a NOAA weather alert logo.</p>	<p>Mesqool CL1000 Solar Hand Crank Camping Lantern User Manual</p> <p>User manual for the Mesqool CL1000 Solar Hand Crank Camping Lantern. This guide details its features, controls, power supply modes (solar, hand crank, USB), and specifications for outdoor activities and emergency preparedness.</p>
 <p>The image shows the Mesqool CR1009Pro Emergency Alert Radio, a portable device with a speaker, antenna, and various control buttons. It also includes a NOAA weather alert logo.</p>	<p>Mesqool CR1009Pro Emergency Alert Radio User Manual</p> <p>Comprehensive user manual for the Mesqool CR1009Pro Emergency Alert Radio, covering features like AM/FM/SW/NOAA weather bands, solar and hand crank power, flashlight, SOS alert, and device charging.</p>
 <p>The image shows the Mesqool CR1015 WB Emergency Weather Radio, a portable device with a speaker, antenna, and various control buttons. It also includes a NOAA weather alert logo.</p>	<p>Mesqool CR1015 WB Emergency Weather Radio User Manual</p> <p>Comprehensive user manual for the Mesqool CR1015 WB Emergency Radio, covering operation, battery charging, weather alerts, SOS function, and specifications for AM, FM, SW, and NOAA weather bands.</p>
 <p>The image shows the Mesqool CR1001i Projection Alarm Clock with Bed Shaker, a digital clock with a projection display and a bed shaker. It also includes a NOAA weather alert logo.</p>	<p>Mesqool CR1001i Projection Alarm Clock with Bed Shaker - User Manual</p> <p>User manual for the Mesqool CR1001i Projection Alarm Clock with Bed Shaker. Learn how to set time, alarms, use projection features, and connect the bed shaker.</p>

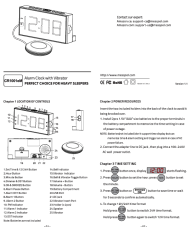

[Mesqool CR1001eM Alarm Clock with Vibrator User Manual](#)

User manual for the Mesqool CR1001eM Alarm Clock with Vibrator, detailing its features, controls, alarm settings, dimmer, DST, USB charging, and vibrator functions. Perfect for heavy sleepers.