

Manuals+

[Q & A](#) | [Deep Search](#) | [Upload](#)

Manuals.plus /

- › [ATOTOEXCEL](#) /
- › ATOTOEXCEL A5L 10-inch Adaptive Car Stereo User Manual

ATOTOEXCEL A5L

ATOTOEXCEL A5L 10-inch Adaptive Car Stereo User Manual

Model: A5L (10.1", 2+32G)

1. INTRODUCTION

This manual provides detailed instructions for the installation, operation, and maintenance of your ATOTOEXCEL A5L 10-inch Adaptive Car Stereo. Please read this manual thoroughly before using the product to ensure proper functionality and safety.



Image 1.1: The ATOTOEXCEL A5L 10-inch Adaptive Car Stereo with its floating QLED screen and included backup camera.

Key Features:

- **FlexView Pro Floating QLED Screen:** 10.1-inch detachable display with 1280x800 resolution and 178° viewing angle.
- **Flexible Adjustable Mounting:** 9-way screen adjustment for optimal viewing and minimal obstruction.
- **Wireless CarPlay & Android Auto:** Supports both wired and wireless connectivity for seamless smartphone integration.
- **Android OS Expandability:** Install apps via Google Play, with WiFi hotspot, Bluetooth, and USB tethering.
- **DriveChat GenAI Voice Assistant:** AI-powered assistant with multiple chatbots and customizable wake-up words.
- **Upgraded Digital Signal Processor (DSP):** Built-in amplifier (Peak 4x45W, RMS 4x24W) and 24-Band EQ with 9 presets.
- **AHD 720P Rear-View Camera:** Includes AC-HD01LR camera with parking guidelines, 140° wide view, and Live Rear View (LRV).
- **Bluetooth Connectivity:** Connects to phones and third-party Bluetooth devices like diagnostic scanners.
- **GPS Tracking (TrackHU App):** Real-time vehicle updates, trip management, and instant alerts.

2. SETUP AND INSTALLATION

The ATOTOEXCEL A5L is designed for compatibility with most single and double DIN dash openings. Proper installation is crucial for optimal performance and safety. Professional installation is recommended.

2.1 Pre-Installation Checks

- **Dashboard Opening:** Ensure your vehicle's dash opening is compatible with single or double DIN sizes.
- **Obstruction Check:** Before permanent installation, check the screen's full range of adjustment (forward, backward, up, down, left, right) to ensure it does not block essential controls like A/C buttons or vents.
- **Wiring Harness:** Research and acquire a wiring harness adapter specific to your vehicle model to avoid cutting or splicing wires.



Image 2.1: Illustration of screen dimensions and adjustment ranges to prevent obstruction of vehicle controls.

2.2 Flexible Adjustable Mounting

The FlexView Pro design allows for 9-way screen adjustment. These adjustments should be made during installation to fix the screen position. Once fixed, reattach screws firmly to maintain stability while driving.

- Slide Left/Right: Up to 24mm.
- Move Up/Down: Up to 27mm.
- Rotate Horizontally (Swivel): Up to 30° Left/Right.
- Rotate Vertically (Tilt): Up to 10° Up/Down.
- Extend Forward/Backward: Up to 18mm.

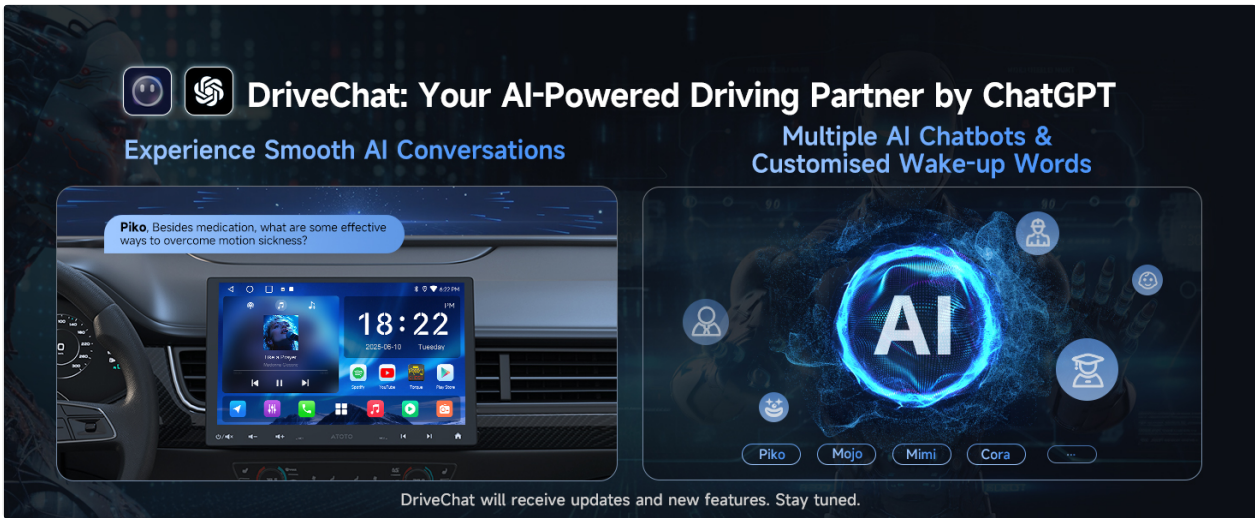

Image 2.2: Visual representation of the 9-way adjustable screen, including swivel, left/right, forward, tilt, and up/down movements.

2.3 Standard Installation Procedures

The A5L supports both standard double DIN and single DIN installation methods. Ensure all necessary components are used as illustrated.

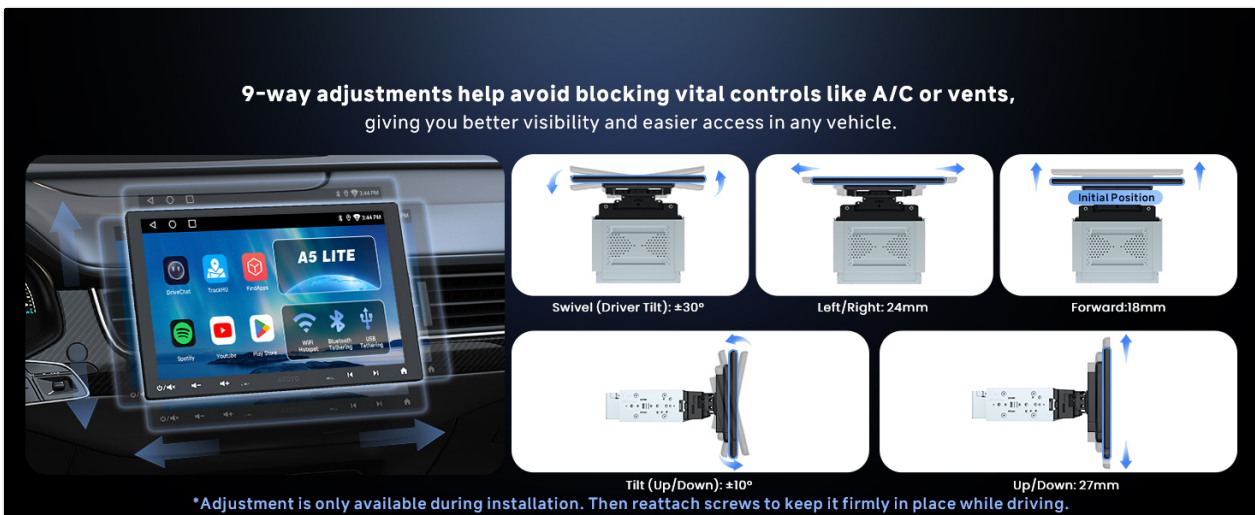

Image 2.3: Installation diagrams for both standard double DIN and single DIN configurations. Note that panel brackets and trim panels are not included.

2.4 Wiring Diagram

Refer to the following diagram for proper wiring connections. Ensure all connections are secure before powering on the unit.

TrackHU
Track Your Vehicle

No Extra GPS Tracker Needed

- Flexible Refresh Rate**
(2min)
- Accurate Positioning**
(GPS, GLONASS, Galileo, Beidou)
- Instant Alerts**
for Geofence
- Track Playback**
with Speed Control

FindApps
Our App Store

Access featured apps that you might not find on G00gle Play.

If the app you need isn't listed, let us know—we'll work to add it to FindApps.

Image 2.4: Comprehensive wiring diagram for the A5L unit, illustrating connections for the 20-pin power cable, RCA outputs, HDMI, USB, microphone, GPS, and FM antennas. Accessories for ports marked with (*) are not included.

3. OPERATING INSTRUCTIONS

3.1 Wireless CarPlay and Android Auto

The A5L supports both wired and wireless CarPlay and Android Auto. This allows for seamless integration of your smartphone for navigation, music, messaging, and calls using voice commands (Siri or Google Assistant).



Image 3.1: Examples of Wireless CarPlay and Wireless Android Auto interfaces, demonstrating voice command functionality for navigation, calls, and music. Note: Wi-Fi is not supported during wireless CarPlay or Android Auto use.

3.2 Android OS and Connectivity

Powered by the Android OS, the A5L allows you to install thousands of applications via Google Play. Expand your capabilities for navigation, entertainment, and customization. Internet access is available through WiFi hotspot, Bluetooth tethering, and USB tethering.

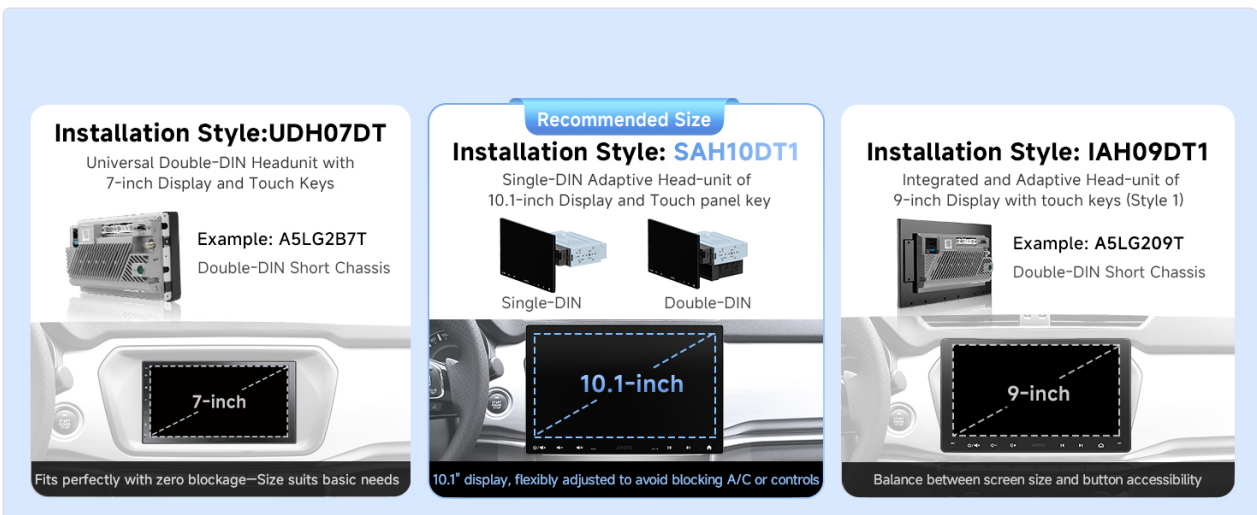

Image 3.2: The A5L displaying various applications accessible through in-car internet connectivity options: WiFi Hotspot (stable and fast), Bluetooth Tethering (less power consumption), and USB Tethering (charges slightly). An OTA upgrade may be required if your car stereo does not support USB tethering.

3.3 DriveChat GenAI Voice Assistant

DriveChat, powered by ChatGPT, is an exclusive application offering diverse interactions. You can switch between multiple AI chatbots for specialized advice and customize wake-up words to personalize your experience.



Image 3.3: The DriveChat interface demonstrating an AI-powered conversation, providing information or assistance. DriveChat receives regular updates for new features.

3.4 Digital Signal Processor (DSP)

The A5L features an upgraded DSP with a built-in amplifier (Peak 4x45W, RMS 4x24W) and a 24-Band EQ with 9 presets. This allows for precise audio adjustments to suit your music preferences and provides a tailored listening experience with time alignment.

Clear Vision for Your Back

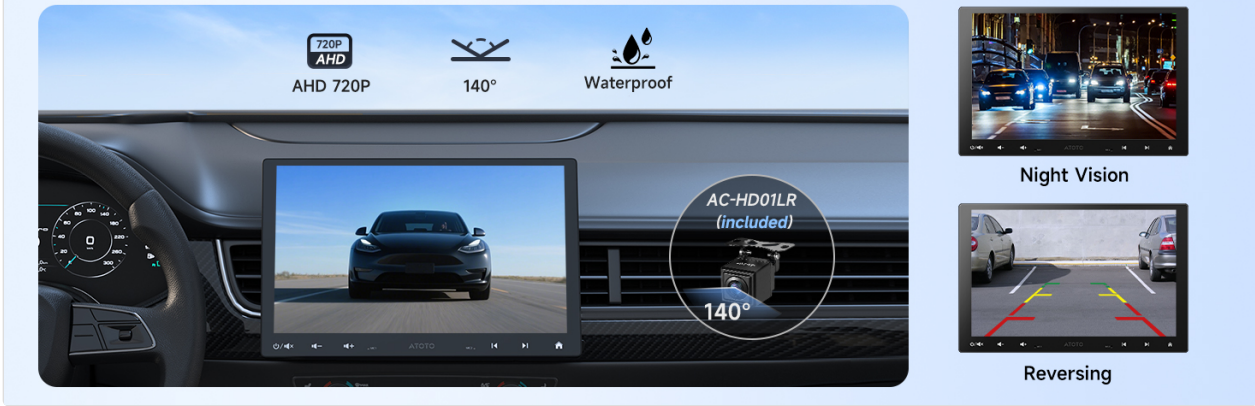

Image 3.4: The 24-band equalizer interface, allowing users to fine-tune audio output with various presets.

Steering Wheel COntrOl (SWC) Options



Image 3.5: Detailed view of DSP functionalities, including time alignment for harmonious sound from every seat, adjustable crossover settings, and the built-in amplifier's peak and RMS power ratings.

3.5 Rear-View Camera System

When connected to the included AC-HD01LR rear-view camera, the system provides 720P AHD rear-view capabilities. Features include dynamic parking guidelines, a 140° wide viewing angle, and Live Rear View (LRV) for enhanced parking assistance.

Enhanced Navigation Experience: Direct Access or CAA Connectivity

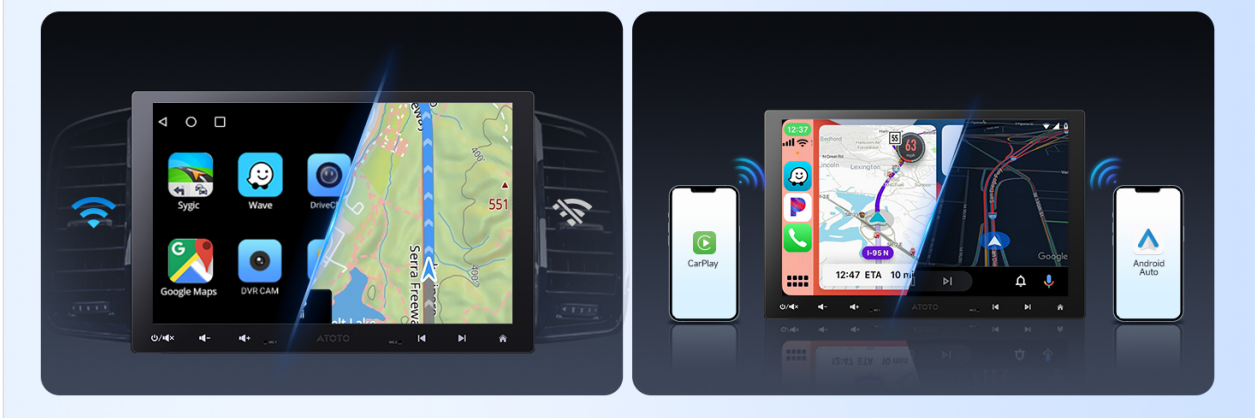

Image 3.6: The A5L display showing a clear 720P AHD rear-view camera feed with reversing guidelines, a 140° wide view

angle, waterproof design, and night vision capabilities.

3.6 Bluetooth Connection

The A5L's Bluetooth system connects to both your phone and third-party Bluetooth devices, such as diagnostic scanners. This allows you to play music and access other Bluetooth functions without affecting hands-free calls.

3.7 GPS Tracking (TrackHU App)

The TrackHU app provides real-time vehicle updates, allowing you to manage trip data and favorites. It offers flexible refresh rates, accurate positioning (GPS, GLONASS, Galileo, Beidou), and instant alerts for geofence and online/offline status. Data can be deleted or deactivated at any time.

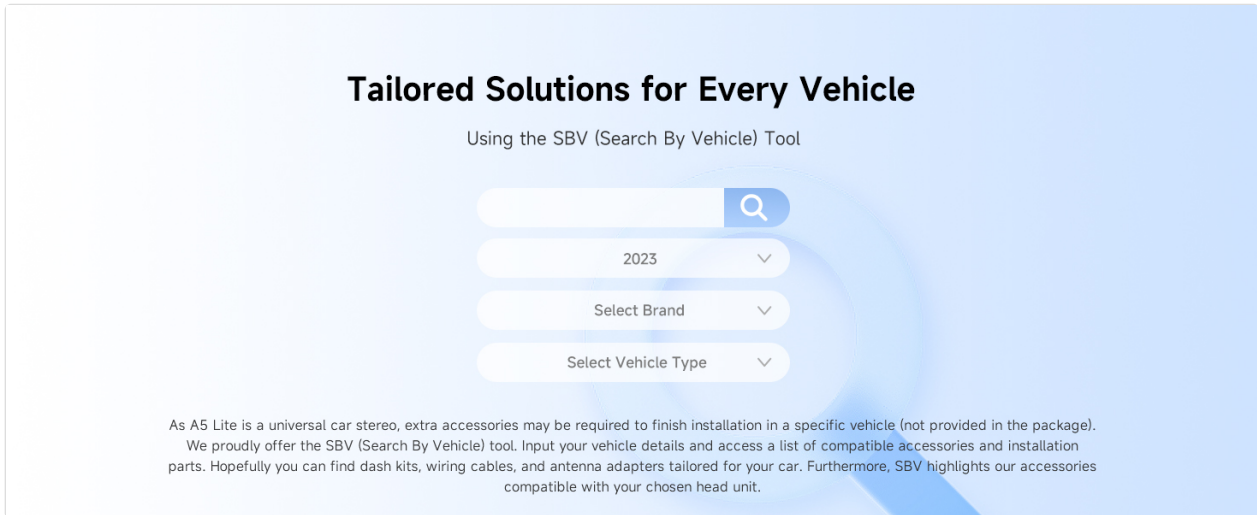

Image 3.7: The TrackHU app interface showing real-time GPS tracking, track playback with speed control, flexible refresh rate, 4-satellite accurate positioning, and instant alerts for geofencing.

3.8 Phone Mirroring

Mirror your phone's screen to the car stereo's display, either wirelessly or via a wired connection. This allows you to view your phone's content on the larger QLED screen. Note that a few applications may not be cast via Phone Mirroring.

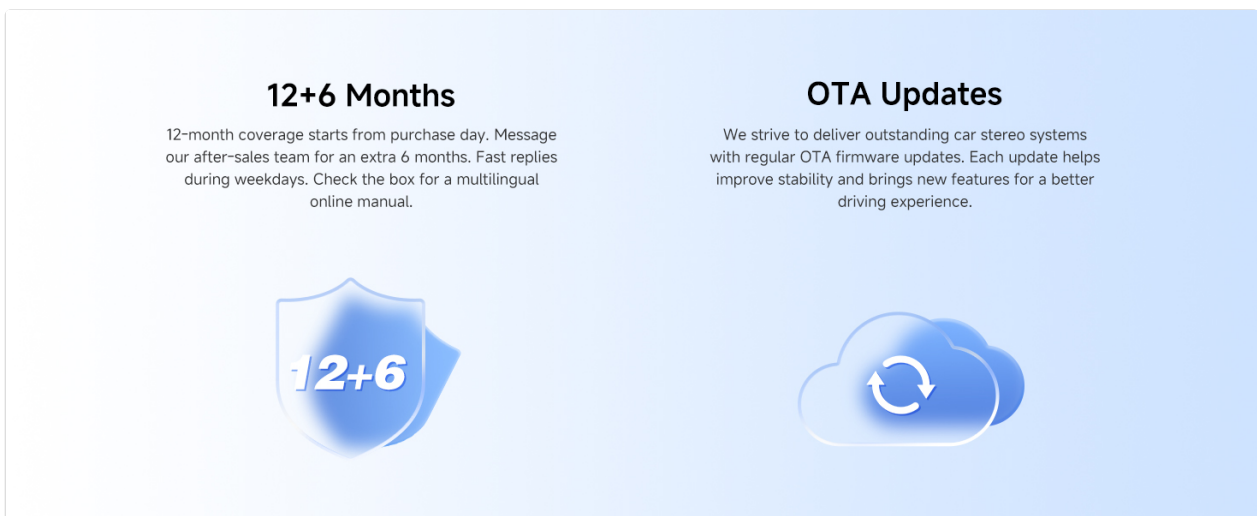

Image 3.8: The A5L's 1280x800 QLED display showcasing phone mirroring functionality, offering a brighter visual experience with strong light suppression and a 178° viewing angle.

3.9 Steering Wheel Control (SWC)

The A5L offers several options for integrating with your vehicle's steering wheel controls:

- Connect to SWC wires on your vehicle (analog signals).
- Use the dedicated 3.5mm jack to keep the OEM SWC via a third-party SWC interface.
- Choose the optional AC-44F8 SWC (not included).



Image 3.9: Various methods for connecting steering wheel controls to the A5L car stereo, including direct wiring, 3.5mm jack for OEM integration, and an optional external SWC unit.

4. MAINTENANCE

The ATOTOEXCEL A5L car stereo is designed for durability and requires minimal routine maintenance. Keep the screen clean using a soft, lint-free cloth. Avoid abrasive cleaners or solvents. Ensure all connections remain secure.

5. TROUBLESHOOTING

If you encounter any issues with your ATOTOEXCEL A5L car stereo, please refer to the online manuals available in various languages. For persistent problems or technical assistance, contact ATOTOEXCEL customer support.

Common Issues and Solutions:

- **Unit not powering on:** Check all power connections, including the 15A fuse. Ensure the ignition wire (red) and constant power wire (yellow) are correctly connected.
- **No sound:** Verify speaker connections and check the DSP settings for proper EQ and volume levels. Ensure the amplifier turn-on wire (blue) is connected if using an external amplifier.
- **Backup camera not displaying:** Confirm the reverse camera input (RCAM) is correctly wired and the reverse trigger wire (pink) is connected to the vehicle's reverse light signal.
- **Wireless CarPlay/Android Auto not connecting:** Ensure Bluetooth and Wi-Fi are enabled on your phone and the stereo. Try restarting both devices.
- **Slow boot-up or unresponsive:** Perform a soft reset. If issues persist, check for available OTA updates.

6. SPECIFICATIONS

Feature	Specification
Screen Size	10.1 Inches
Display Type	QLED, 1280x800 Resolution, 178° Viewing Angle
Operating System	Android
Memory (RAM)	2GB
Storage (ROM)	32GB
Connectivity	2.4/5Ghz Wi-Fi, Bluetooth, USB
Special Features	Wireless CarPlay & Android Auto, DriveChat AI, DSP, GPS Tracking, Detachable Floating Touchscreen
Audio Output Mode	Stereo
Built-in Amplifier	Peak 4x45W, RMS 4x24W
Equalizer	24-Band EQ with 9 Presets
Rear-View Camera	AC-HD01LR (Included), 720P AHD, 140° Wide View
GPS Map Type	Worldwide (GPS, GLONASS, Galileo, Beidou)
Mounting Type	Panel Mount (Single/Double DIN Adaptive)
Item Weight	7.67 pounds
Package Dimensions	11.5 x 9.72 x 8.43 inches

7. PACKAGE CONTENTS

The following items are included in your ATOTOEXCEL A5L package:

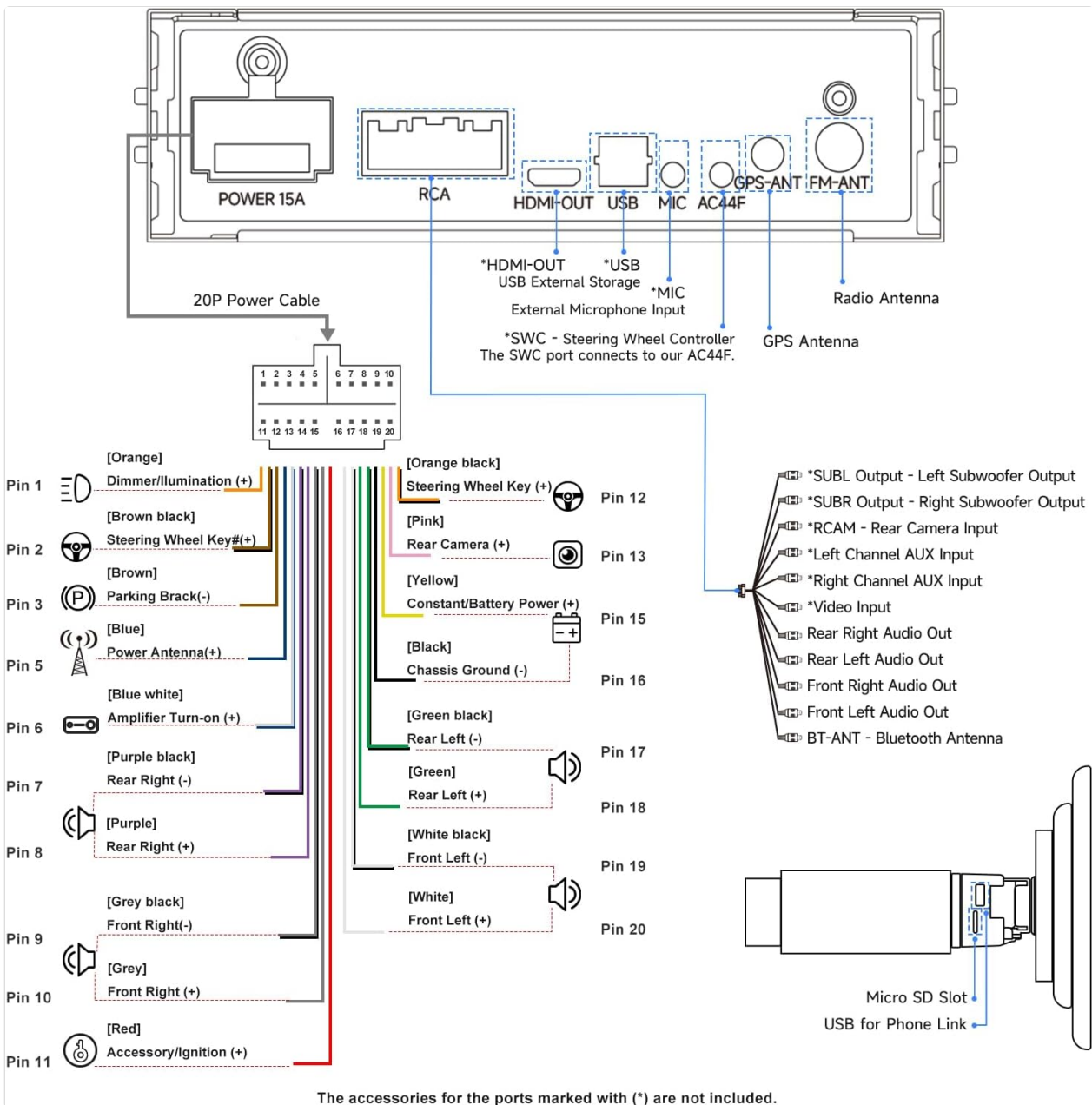

Image 7.1: All components included in the package, such as the car stereo, rearview camera, wiring harnesses, GPS antenna, and mounting hardware.

- ATOTOEXCEL A5L Car Stereo Unit
- AC-HD01LR Rearview Camera
- 20-Pin Power Wire Harness
- GPS Antenna
- 8-Pin USB Cable
- 24-Pin RCA Combination Cable
- Mounting Brackets
- Mounting Screws
- Reverse Camera Cable
- Single DIN Storage Pocket
- Online Resources Quick Guide
- Product Care Online Support Information

8. WARRANTY AND SUPPORT

Your ATOTOEXCEL A5L car stereo comes with a 12-month product care period from the date of purchase. You can extend this by an additional 6 months by contacting our support team. Our team is available during workdays to assist with any inquiries.

8.1 OTA Updates

ATOTOEXCEL is committed to providing outstanding car stereo systems with regular Over-The-Air (OTA) firmware updates. These updates improve stability and introduce new features for an enhanced driving experience. Updates are delivered via FindApps.



Image 8.1: Visual representation of 12+6 months product care and OTA updates.

8.2 Contact Support

For assistance, please refer to the contact details provided in the product box or visit the ATOTOEXCEL support website. You can also seek help via your order center.



Image 8.2: Various methods to seek help and support for your ATOTOEXCEL product.