

Starlink Mini Kit 4th Gen

SpaceX Starlink Mini Kit (4th Gen) Portable Satellite Internet Antenna User Manual

Model: Starlink Mini Kit 4th Gen | Brand: SpaceX Starlink

1. INTRODUCTION

The SpaceX Starlink Mini Kit (4th Gen) provides high-speed, low-latency internet access in remote and mobile locations. Designed for portability, it features an integrated Wi-Fi router, DC power input, and supports free roam region unlock, making it ideal for RVs, camping, and remote work scenarios.



Image: The Starlink Mini Kit (4th Gen) satellite antenna with its integrated kickstand.

2. PACKAGE CONTENTS

Verify that all components are present in your Starlink Mini Kit package:

- Starlink Mini Satellite Antenna with Integrated Wi-Fi Router
- DC Power Cable (15m / 49.2 ft)
- Power Supply
- Flat Mount Mini Pipe Adapter

- Kickstand

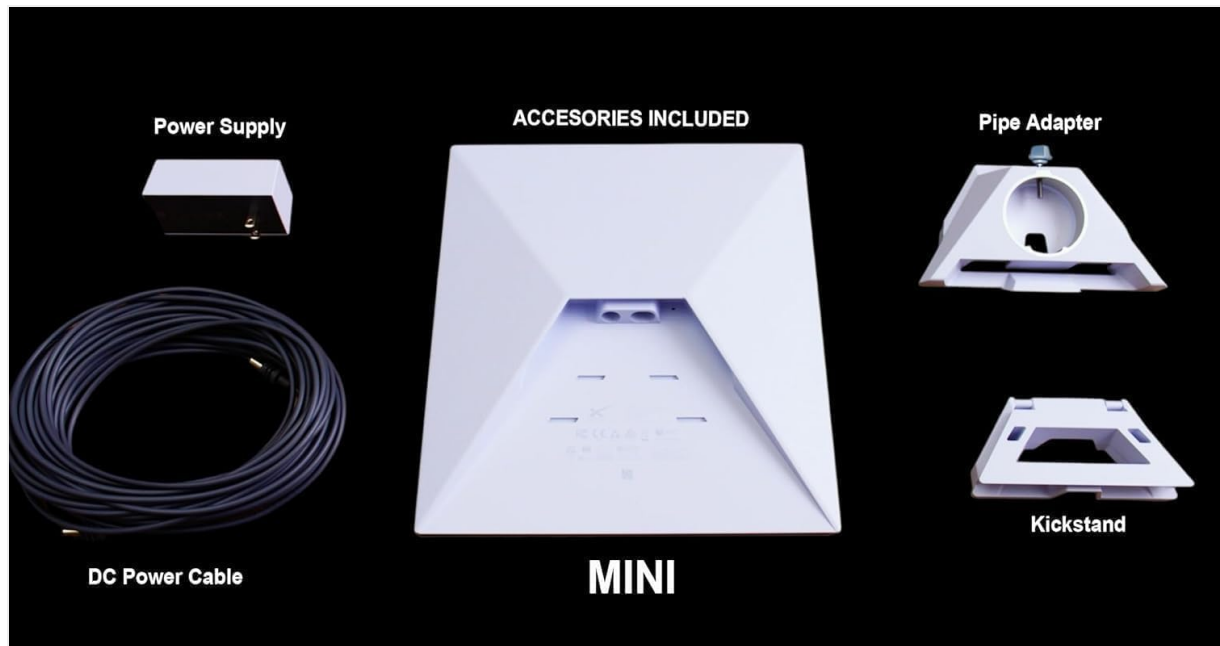

Image: All included accessories for the Starlink Mini Kit.

Video: An overview of the Starlink Mini Kit components and basic setup.

3. SETUP

3.1 Initial Placement

For optimal performance, the Starlink Mini antenna requires a clear, unobstructed view of the sky. Avoid placing it near tall buildings, trees, or other objects that could block the signal to the satellites. The integrated kickstand allows for quick deployment on flat surfaces.

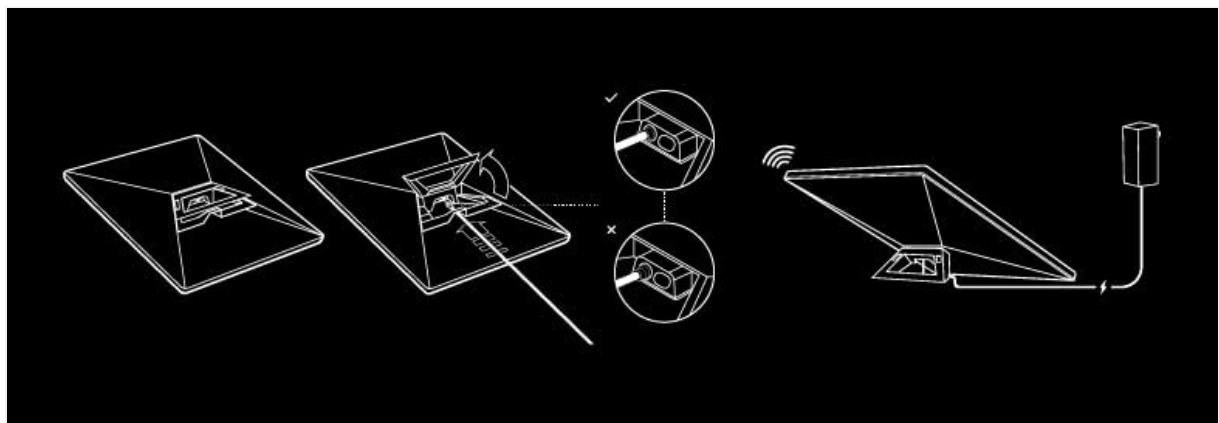

Image: Illustrated guide for connecting the Starlink Mini.

3.2 Power Connection

Connect the DC Power Cable to the Starlink Mini antenna and then to the provided Power Supply. The kit supports 12–48V DC input or can be powered via USB-C PD battery packs for off-grid use.

Video: Demonstrates how to install the Starlink Mini using a Gen 3 mount.

3.3 Using the Starlink App

Download the official Starlink app from your device's app store. The app will guide you through the alignment process to ensure your antenna has the best possible connection to the Starlink satellite constellation. It also provides tools to check for obstructions and monitor performance.

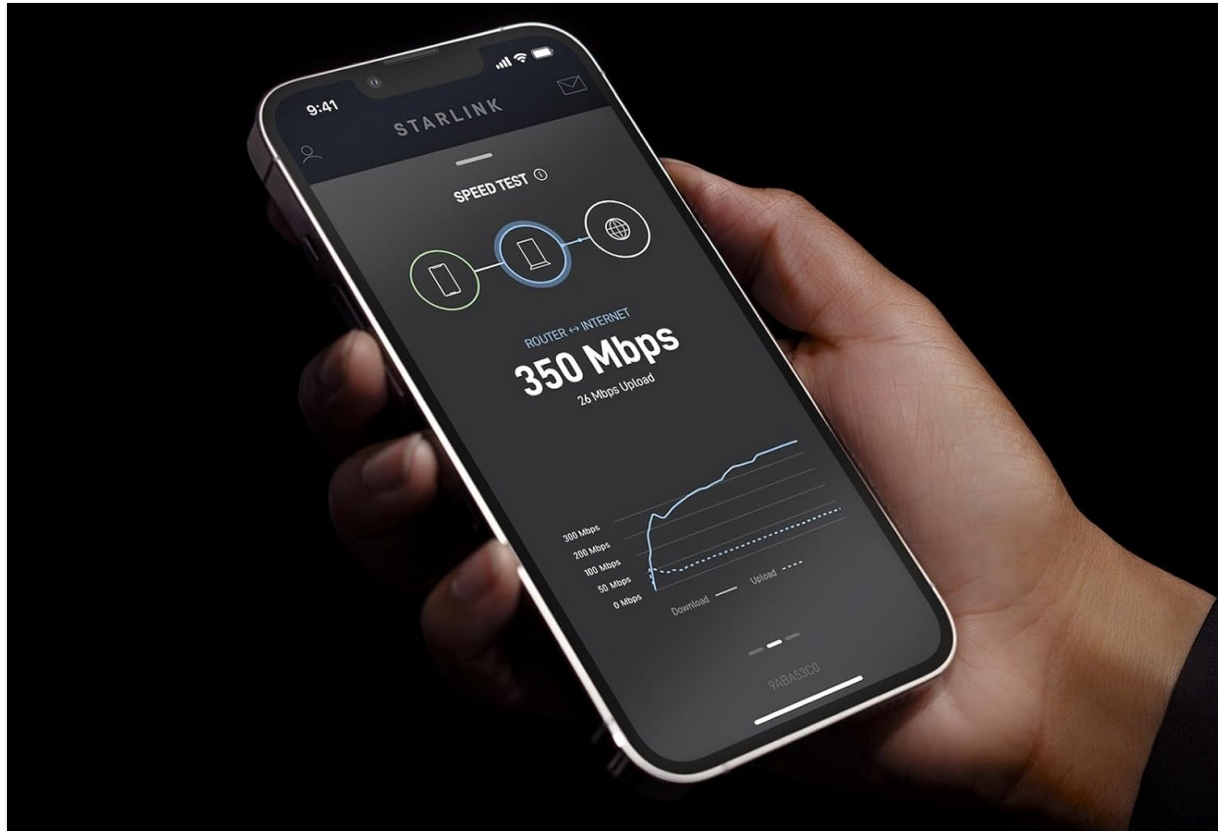

Image: The Starlink app showing internet speed test results.

4. OPERATING INSTRUCTIONS

4.1 Connectivity

The Starlink Mini features an integrated Wi-Fi 5 (802.11ac) router with dual-band 3x3 MU-MIMO technology, supporting up to 128 devices simultaneously. Once connected, you can expect download speeds over 100 Mbps, suitable for streaming, video calls, and general internet use.

4.2 Portability and Roaming

The compact design (11.75" x 10.2", under 2.5 lbs) allows for easy transport in a backpack. With the Free Roam Region Unlock feature, the Starlink Mini can be used across various regions without restrictions, offering internet access for international travelers and digital nomads.



Image: Starlink Mini attached to a backpack, demonstrating its portability.



Image: Starlink Mini supports connectivity at home, on the go, and on boats.

5. MAINTENANCE

To ensure the longevity and optimal performance of your Starlink Mini Kit, follow these maintenance guidelines:

- **Cleaning:** Gently wipe the antenna surface with a soft, damp cloth to remove dust, dirt, or debris. Avoid abrasive cleaners or solvents.
- **Environmental Protection:** While designed for outdoor use, protect the antenna from extreme weather conditions when possible. Ensure proper ventilation around the power supply.
- **Cable Management:** Keep cables neatly organized and free from kinks or damage. Avoid placing heavy objects on cables.

6. TROUBLESHOOTING

If you encounter issues with your Starlink Mini Kit, consider the following steps:

- **No Internet Connection:**
 - Verify the antenna has a clear view of the sky. Use the Starlink app's "Check for Obstructions" feature.
 - Ensure all cables are securely connected to the antenna and power supply.
 - Restart the Starlink Mini by unplugging and re-plugging the power supply.
- **Slow Speeds:**
 - Check the Starlink app for any performance alerts or network issues in your area.
 - Ensure your device is connected to the Starlink Wi-Fi network and not another network.
 - Minimize the number of active devices or high-bandwidth activities on your network.
- **App Connectivity Issues:**
 - Ensure your smartphone is connected to the Starlink Wi-Fi network.
 - Update the Starlink app to the latest version.
 - Restart your smartphone.

For further assistance, refer to the Starlink app's support section or visit the official Starlink support website.

7. SPECIFICATIONS





Feature	Detail
Model	Starlink Mini Kit 4th Gen
Dimensions	11.75"L x 10.2"W x 2.5"H (Antenna)
Item Weight	2.5 lbs (Antenna), 4.8 lbs (Package)
Wi-Fi Standard	Wi-Fi 5 (802.11ac), Dual-Band 3x3 MU-MIMO
Power Consumption	25–40W
Power Input	12–48V DC, USB-C PD compatible
Maximum Range	3200 Feet (Wi-Fi coverage)
Color	White and Gray

8. WARRANTY AND SUPPORT

For information regarding product warranty, please refer to the documentation included with your purchase or visit the official SpaceX Starlink website. Extended protection plans may be available for purchase, such as the 3-Year Protection Plan or Complete Protect monthly plan.

For technical support, troubleshooting assistance, or service inquiries, please contact Starlink customer service through the Starlink app or their official support channels.

Related Documents - Starlink Mini Kit 4th Gen

 <p>What's Included in the Starlink Kit</p> <ul style="list-style-type: none">• Starlink Dish• Router• Power Adapter• Starlink Gen 3 Kit (includes Starlink Dish, Router, and Power Adapter) <p>Getting Started</p> <p>1. Unpack the Starlink Kit and check the contents. The Starlink Dish should be in its protective carrying case. The Router and Power Adapter should be in their respective boxes. The Starlink Gen 3 Kit should be in its protective carrying case.</p> <p>2. Connect the Starlink Dish to the Router. The Starlink Dish should be connected to the Router using the provided cable. The Router should be connected to the Power Adapter using the provided cable.</p> <p>3. Connect the Router to the Power Adapter. The Router should be connected to the Power Adapter using the provided cable.</p> <p>4. Connect the Router to the Internet. The Router should be connected to the Internet using the provided cable.</p> <p>5. Connect the Router to the Wi-Fi Network. The Router should be connected to the Wi-Fi Network using the provided cable.</p> <p>6. Connect the Router to the Starlink Service. The Router should be connected to the Starlink Service using the provided cable.</p> <p>7. Connect the Router to the Starlink Service. The Router should be connected to the Starlink Service using the provided cable.</p> <p>8. Connect the Router to the Starlink Service. The Router should be connected to the Starlink Service using the provided cable.</p> <p>9. Connect the Router to the Starlink Service. The Router should be connected to the Starlink Service using the provided cable.</p> <p>10. Connect the Router to the Starlink Service. The Router should be connected to the Starlink Service using the provided cable.</p>	<p>Starlink Kit Gen 3 Setup Guide: Get Connected</p> <p>Learn how to set up your Starlink Kit, including connecting the Starlink dish, router, and power supply. Follow step-by-step instructions for optimal satellite alignment and Wi-Fi setup.</p>
 <p>STARLINK GEN 3 ROUTER MOUNT INSTALL GUIDE</p>	<p>Starlink Gen 3 Router Mount Installation Guide</p> <p>Comprehensive installation guide for the Starlink Gen 3 Router Mount, detailing components, required tools, step-by-step instructions for both anchored and non-anchored mounting, and essential safety precautions.</p>
<p>Starlink Router</p> <p>Model UTR-231</p> <p>STARLINK</p>	<p>Starlink Router UTR-231 Setup and Safety Information</p> <p>Concise guide to setting up the Starlink Router (Model UTR-231) by SpaceX, including regulatory, environmental, and safety notices.</p>
 <p>STARLINK GEN 3 ROUTER SETUP GUIDE (STANDARD CIRCULAR)</p>	<p>Starlink Gen 3 Router Setup Guide (Standard Circular)</p> <p>Follow this step-by-step guide to set up your Starlink Gen 3 Router (Standard Circular model). Learn how to connect, troubleshoot, and optimize your Starlink internet connection.</p>
 <p>Starlink™ Flat High-Performance Activation and Configuration</p> <p>Activating Your Starlink</p> <p>1. Connect the Starlink Flat High-Performance system to the power source.</p> <p>2. Connect the Starlink Flat High-Performance system to the internet source.</p> <p>3. Connect the Starlink Flat High-Performance system to the antenna system.</p> <p>4. Connect the Starlink Flat High-Performance system to the KVM antenna system.</p> <p>5. Connect the Starlink Flat High-Performance system to the KVM antenna system.</p> <p>6. Connect the Starlink Flat High-Performance system to the KVM antenna system.</p> <p>7. Connect the Starlink Flat High-Performance system to the KVM antenna system.</p> <p>8. Connect the Starlink Flat High-Performance system to the KVM antenna system.</p> <p>9. Connect the Starlink Flat High-Performance system to the KVM antenna system.</p> <p>10. Connect the Starlink Flat High-Performance system to the KVM antenna system.</p> <p>Technical Support</p>	<p>Starlink Flat High-Performance Activation and Configuration Guide</p> <p>This guide provides detailed instructions for activating and configuring the Starlink Flat High-Performance system, including Wi-Fi setup, data usage management, and integration with KVM antenna systems.</p>

STARLINK MINI TOP VIEW

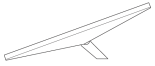

[Starlink Mini Setup Guide: Easy Installation for Satellite Internet](#)

Learn how to set up your Starlink Mini satellite internet kit with this comprehensive guide. Covers unboxing, installation, Wi-Fi connection, alignment, and troubleshooting.