

Carrera 370430041

Carrera RC Bundesliga Soccer Field with 2 Mini RC Cars Instruction Manual

Model: 370430041

1. INTRODUCTION

This instruction manual provides essential information for the safe and proper operation, assembly, and maintenance of your Carrera RC Bundesliga Soccer Field with 2 Mini RC Cars. Please read this manual thoroughly before first use and retain it for future reference.

2. SAFETY WARNINGS

WARNING:

- Not suitable for children under 36 months due to small parts which may present a choking hazard.
- Adult supervision is recommended during play.
- Keep packaging for important instructions.
- Technical and design modifications are reserved.
- This product is manufactured in China.

3. PACKAGE CONTENTS

Ensure all components listed below are present in your package:

- 2x Carrera RC Mini Cars (1x Black, 1x Grey)
- 2x 2.4 GHz Remote Controllers
- 1x Soccer Ball
- 2x Goals
- 22x Field Boundary Elements
- Club Sticker Sheets (24 clubs)
- Instruction Manual



Image 3.1: Complete Carrera RC Bundesliga Soccer Field Set including packaging, cars, controllers, and sticker sheets.

4. SETUP

4.1 Battery Installation

The RC cars and controllers require batteries for operation. Please refer to the specific battery compartment on each device for correct polarity and type. The product requires 2x AAA batteries per controller (included).

1. Open the battery compartment cover on the underside of the controller.
2. Insert 2x AAA batteries, ensuring correct polarity (+/-).
3. Close the battery compartment cover securely.
4. The RC cars have integrated rechargeable batteries. Ensure they are charged before first use.



Image 4.1: The Carrera RC controller. Battery compartment is located on the underside.

4.2 Assembling the Playing Field

The playing field consists of 22 boundary elements and two goals. Connect the boundary elements to form a rectangular or oval field. Attach the goals at opposite ends.

1. Unpack all 22 boundary elements.
2. Interlock the elements to create the desired field shape. Ensure connections are secure.
3. Place the two goals at the center of the short sides of the field.



Image 4.2: An assembled Carrera RC Bundesliga Soccer Field with boundary elements and goals.



Image 4.3: A close-up view of one of the soccer goals, showing its design and attachment points.

4.3 Applying Club Stickers

Personalize your RC cars with the included Bundesliga club stickers. Choose your favorite club and apply the stickers carefully to the vehicles.

1. Select your preferred club stickers from the provided sheets.
2. Carefully peel the stickers and apply them to the designated areas on the RC cars.
3. Ensure the stickers are smoothed out to avoid air bubbles.

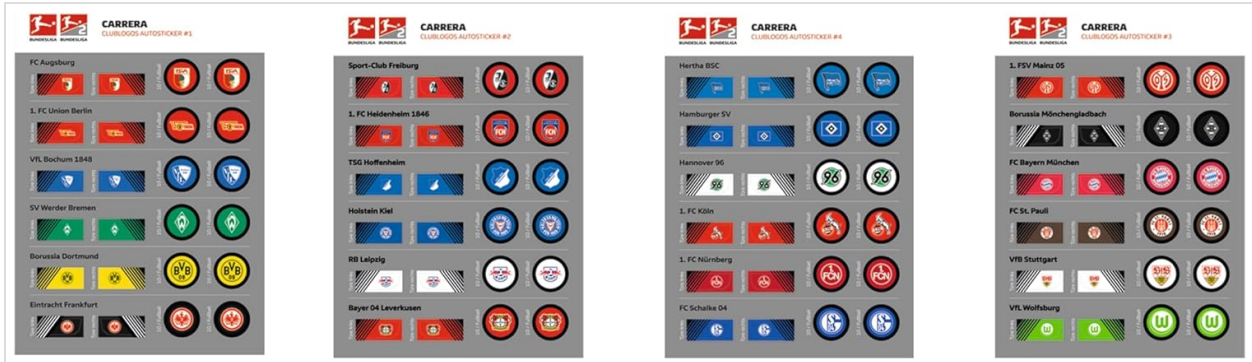

Image 4.4: Various sheets of Bundesliga club stickers for customizing the RC cars.

5. OPERATING THE RC CARS

5.1 Pairing Controller and Car

Each car needs to be paired with its respective controller. This usually happens automatically when both are turned on for the first time or after battery replacement.

1. Ensure fresh batteries are in the controller and the car is charged.
2. Turn on the RC car using its power switch.
3. Turn on the controller. The indicator light on the controller should flash and then become solid, indicating a successful connection.
4. If pairing fails, turn both devices off and repeat the process.

5.2 Driving and Gameplay

Use the joysticks or buttons on the controller to maneuver your RC car. The cars are equipped with front "shovels" to control the soccer ball.



Image 5.1: The two RC cars, black and grey, featuring front shovels designed for ball control.

- **Forward/Backward:** Use the left control to move the car forward or backward.
- **Left/Right:** Use the right control to steer the car.
- **Ball Control:** Position the front shovel of your car to push, dribble, and shoot the soccer ball towards the opponent's goal.
- **Gameplay:** The objective is to score goals by maneuvering the ball into the opponent's net.

6. MAINTENANCE

6.1 Cleaning

- Wipe the cars and field elements with a dry, soft cloth.
- Do not use chemical cleaners or solvents, as these may damage the plastic.
- Ensure no hair or debris gets tangled in the car wheels. Regularly check and clean if necessary.

6.2 Battery Care and Storage

- Remove batteries from controllers if the product will not be used for an extended period.
- Store the product in a cool, dry place, away from direct sunlight and extreme temperatures.

7. TROUBLESHOOTING

Problem	Possible Cause	Solution
Car does not respond to controller.	<ul style="list-style-type: none"> ◦ Low or dead batteries in controller. ◦ Car not charged. ◦ Not paired correctly. ◦ Interference. 	<ul style="list-style-type: none"> ◦ Replace controller batteries. ◦ Charge the RC car. ◦ Turn both off and on again to re-pair. ◦ Move to an area with less electronic interference.
Playing field shifts during play.	<ul style="list-style-type: none"> ◦ Playing surface is too smooth. ◦ Elements not securely connected. 	<ul style="list-style-type: none"> ◦ Place the field on a carpeted surface or use non-slip mats underneath. ◦ Ensure all boundary elements are firmly interlocked.
Car performance is poor.	<ul style="list-style-type: none"> ◦ Low car battery. ◦ Debris in wheels. 	<ul style="list-style-type: none"> ◦ Recharge the car. ◦ Inspect and clean wheels.

8. SPECIFICATIONS

Feature	Detail
Product Dimensions (L x W x H)	40 x 30 x 1 cm; 1.37 kg
Manufacturer Recommended Age	6 years and up
Model Number	370430041
Number of Players	2
Scale	1:24

Feature	Detail
Batteries Required	Yes
Batteries Included	Yes (for controllers)
Battery Type	2x AAA (for controllers)
Main Material	Plastic
Remote Control Included	Yes
Color	Multicolor
Brand	Carrera
Theme	Sport
Power Source	Battery Powered

9. WARRANTY AND SUPPORT

Please retain your purchase receipt and original packaging for any warranty claims. Information regarding spare parts availability is not provided in the product details.

For technical support or warranty inquiries, please contact Carrera customer service through their official website or the retailer where the product was purchased. Contact details are typically found on the product packaging or the manufacturer's website.

Related Documents - 370430041

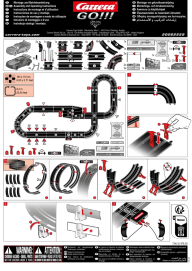
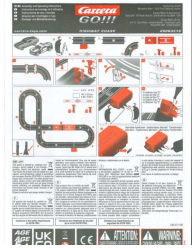
	<p>Carrera GO!!! Disney Pixar Cars Slot Car Racing Set Assembly and Operating Instructions</p> <p>Comprehensive assembly and operating instructions for the Carrera GO!!! Disney Pixar Cars slot car racing set (Model 20062559). Learn how to build the track, connect components, and operate the cars safely.</p>
	<p>Carrera GO!!! Highway Chase Slot Car Racing Set: Assembly & Operating Instructions (Model 20063519)</p> <p>Assembly and operating instructions for the Carrera GO!!! Highway Chase slot car racing set (model 20063519). Provides detailed guidance on setup, safe operation, and technical specifications for this toy racing track.</p>

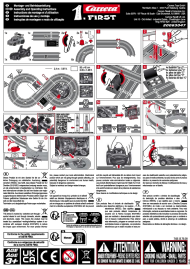

[Carrera FIRST 63047 DC Batwheels Slot Car Racing Set - Assembly & Operating Instructions](#)

Comprehensive assembly and operating instructions for the Carrera FIRST 63047 DC Batwheels slot car racing set, including safety guidelines, technical specifications, and maintenance tips. Learn how to set up and safely operate your Carrera FIRST slot car track.



[Carrera GO!!! 370410529 User Manual - Slot Car Racing Set Guide](#)

Official user manual for the Carrera GO!!! 370410529 slot car racing set. Learn how to set up, operate, maintain, and troubleshoot your racing experience.

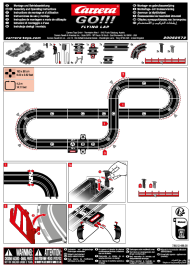

[Carrera GO!!! Flying Lap Slot Car Racing Set Assembly and Operating Instructions](#)

Comprehensive guide to assembling and operating the Carrera GO!!! Flying Lap slot car racing set (Model 20062572), including track layout, parts, assembly steps, and safety information.

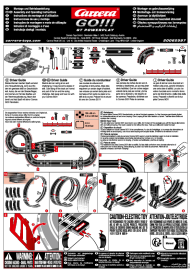

[Carrera GO!!! GT POWERPLAY Slot Car Racing Set - Assembly & Operation Guide](#)

Detailed assembly and operating instructions for the Carrera GO!!! GT POWERPLAY slot car racing set (Model 20062597). This guide covers track setup, car operation, contact brush maintenance, turbo boost usage, and essential safety warnings for an enjoyable racing experience.