

TP-Link TL-MR110-Outdoor

TP-Link TL-MR110-Outdoor 4G LTE Router User Manual

Model: TL-MR110-Outdoor

1. INTRODUCTION

The TP-Link TL-MR110-Outdoor is a robust 4G LTE Wi-Fi router specifically designed for outdoor use. It provides reliable internet connectivity in various environments, from gardens to construction sites or remote areas. This manual provides essential information for the proper installation, configuration, and operation of your device.

Key features include:

- **IP65 Certified:** Weather-resistant casing, protected against dust and water.
- **4G LTE Cat 4:** Download speeds up to 150 Mbps for stable internet.
- **300 Mbps Wi-Fi (2.4 GHz):** Fast wireless connection for up to 32 devices simultaneously.
- **Wide Temperature Range:** Operates reliably from -30 °C to +60 °C.
- **Enhanced Protection:** 6 kV lightning protection and 15 kV electrostatic discharge (ESD) protection.
- **Flexible Power Supply:** Supports 12 V DC, passive PoE (48 V), and 802.3af PoE (44-57 V).
- **Easy Mounting:** Can be installed on a pole, wall, or window.
- **Tether App:** Convenient management via smartphone (iOS/Android).



Image 1.1: TP-Link TL-MR110-Outdoor 4G LTE Router, front view with antennas.

2. PACKAGE CONTENTS

Verify that your package contains the following items:

- 1 x TL-MR110-Outdoor Unit
- 1 x 10m RJ45 Ethernet Cable
- 1 x PoE Adapter
- 1 x Power Cable
- 1 x Quick Installation Guide
- Mounting Kits (for Window/Pole/Wall)

3. PHYSICAL OVERVIEW

The TL-MR110-Outdoor features a durable, weather-resistant casing designed for outdoor deployment. It includes external antennas for optimal signal reception and transmission. The device typically has a SIM card slot, an Ethernet port (for PoE and data), and a power input port.

WiFi 4G rapide, une connexion stable où que vous soyez

Routeur WiFi 4G d'extérieur 300 Mbit/s

TL-MR110-Outdoor



Image 3.1: TL-MR110-Outdoor router mounted outdoors, illustrating fast 4G Wi-Fi and stable connection.

4. SETUP

4.1 SIM Card Installation

1. Ensure the device is powered off.
2. Locate the SIM card slot cover on the device.
3. Open the cover and insert your 4G SIM card into the slot until it clicks into place.
4. Close the SIM card slot cover securely to maintain IP65 protection.

4.2 Mounting Options

The TL-MR110-Outdoor offers versatile mounting options:

- **Pole Mounting:** Use the provided pole mounting kit to attach the device to a pole.
- **Wall Mounting:** Use the provided wall mounting kit to secure the device to a wall.
- **Window Mounting:** Use the provided window mounting kit for installation on a window.

Choose a location that provides optimal 4G signal reception and Wi-Fi coverage.

Montage sur poteau

Montage mural

Montage sur fenêtre



Installation polyvalente pour divers environnements

Le TL-MR110-Outdoor se fixe sur mât, mur ou fenêtre, s'adaptant à tout environnement pour un signal optimal et une connexion fiable.

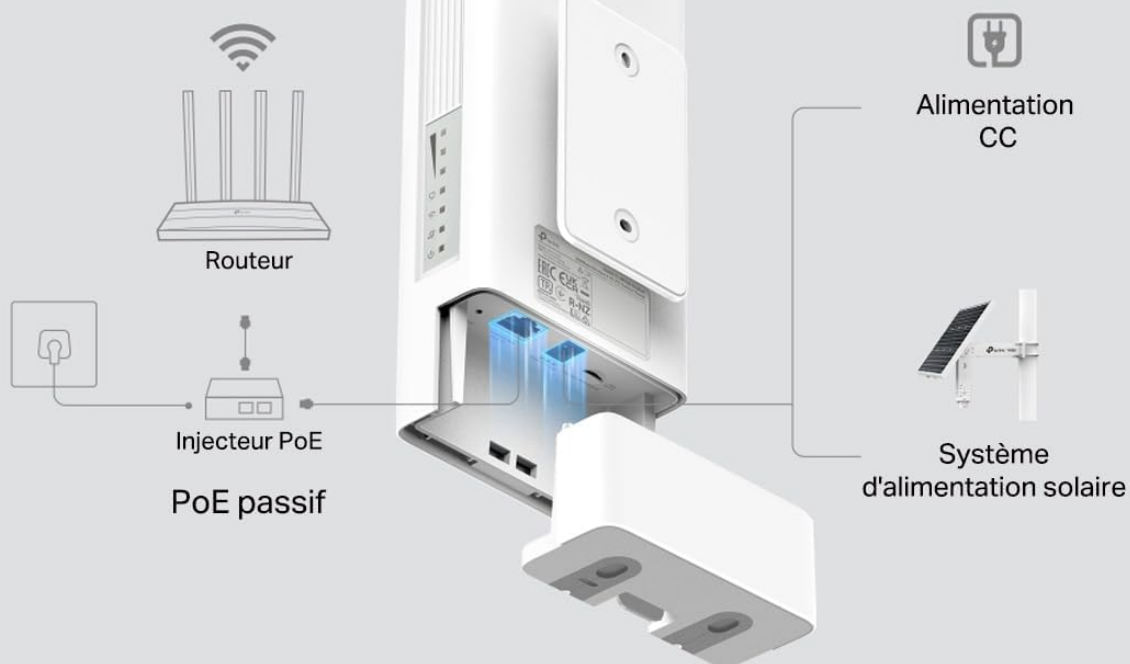

Image 4.1: Versatile mounting options for the TL-MR110-Outdoor.

4.3 Powering the Device

The router supports flexible power options:

- **PoE (Power over Ethernet):** Connect the router to the PoE adapter using the Ethernet cable. The PoE adapter then connects to a power outlet. This is the recommended method for outdoor installations as it simplifies cabling.
- **DC Power:** Connect the provided power cable to the DC input port on the router and then to a power outlet.



Prise en charge PoE/CC : installation extérieure simplifiée

Le TL-MR110-Outdoor offre une alimentation PoE ou DC, facilitant l'installation et assurant une connexion fiable en extérieur.



Image 4.2: Flexible power options: PoE, DC, and solar compatibility.

4.4 Initial Configuration

The TL-MR110-Outdoor is designed for quick Plug & Play setup with a SIM card, often requiring no complex configuration. However, for advanced settings, you can use the Tether app or the web management interface.

5. OPERATING THE ROUTER

5.1 Connecting Devices

Once powered on and connected to the 4G network, the router will broadcast a Wi-Fi signal. You can connect devices via:

- **Wi-Fi:** Search for the router's Wi-Fi network name (SSID) on your devices and enter the password (found on the product label).
- **Ethernet:** Connect devices directly to the router's Ethernet port using an RJ45 cable.

The router supports up to 32 simultaneous wireless connections.



Image 5.1: Router distributing Wi-Fi and wired internet to multiple devices.

5.2 Managing the Router

You can manage your TL-MR110-Outdoor using the TP-Link Tether app or a web browser.

- **Tether App:** Download the TP-Link Tether app from the App Store (iOS) or Google Play Store (Android). The

app allows for easy setup, network management, parental controls, and more.

- **Web Management Interface:** Connect a device to the router's Wi-Fi or Ethernet. Open a web browser and enter the default IP address (usually 192.168.0.1 or tplinkwifi.net) to access the management page.

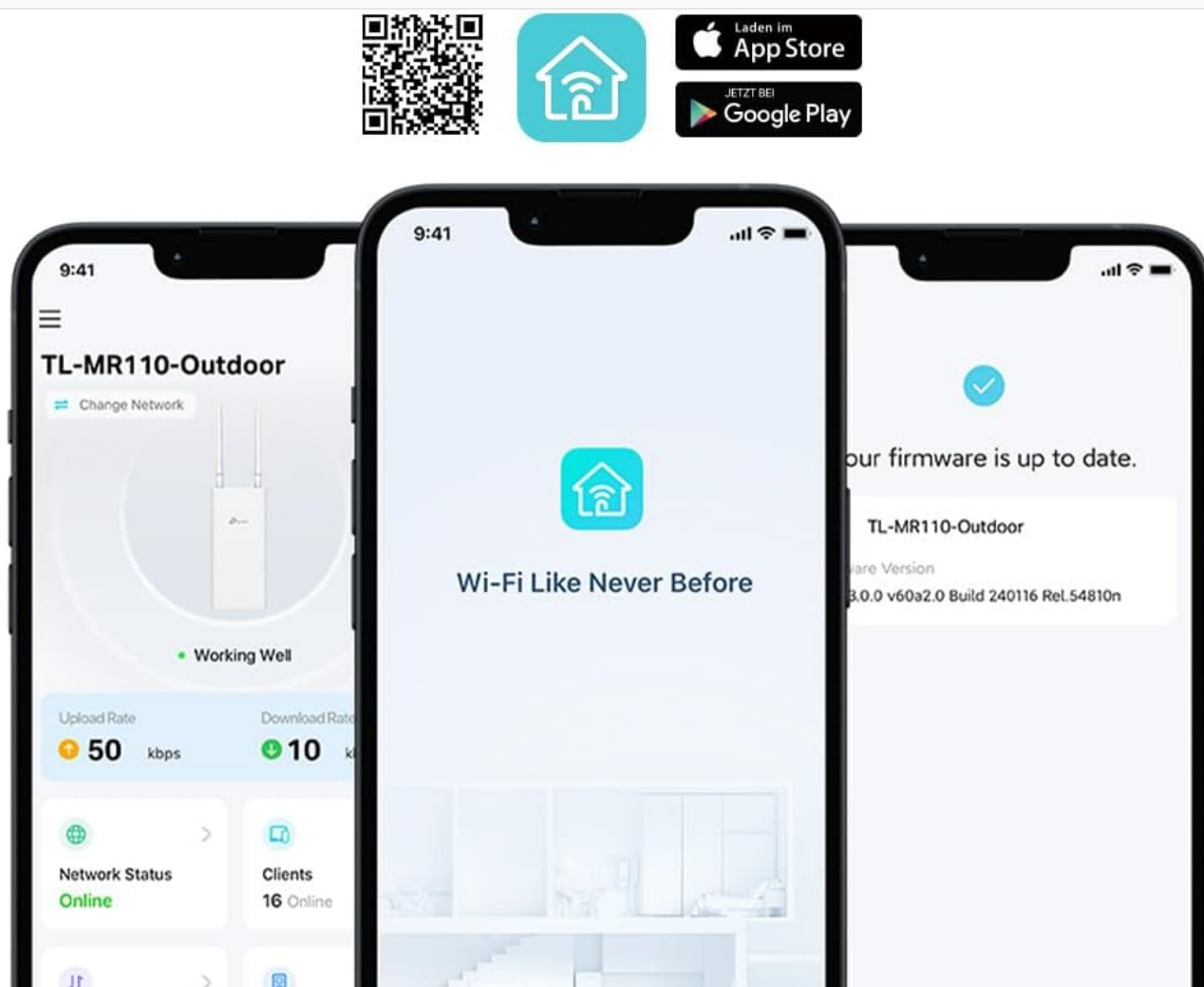

Configuration et gestion simple

Configurez rapidement le TL-MR110-Outdoor via son interface web intuitive ou l'application Tether, qui permet aussi de gérer le réseau, contrôle parental et accès depuis Android ou iOS.



Image 5.2: TP-Link Tether app for smartphone management.
For more information on the Tether app, visit: [TP-Link Tether App](#)

6. MAINTENANCE

6.1 Environmental Considerations

The TL-MR110-Outdoor is designed for harsh outdoor conditions:

- **IP65 Rating:** Ensures protection against dust ingress and low-pressure water jets from any direction.
- **Temperature Range:** Operates effectively between -30 °C and +60 °C.
- **Lightning and ESD Protection:** Built-in 6 kV lightning protection and 15 kV ESD protection safeguard the device from electrical surges.



Image 6.1: Robust outdoor design features.

6.2 Cleaning

Periodically inspect the device for any dirt or debris accumulation. Clean the exterior with a soft, dry cloth. Do not use liquid cleaners or aerosols.

6.3 Firmware Updates

Regularly check the TP-Link website or the Tether app for available firmware updates to ensure optimal performance and security.

7. TROUBLESHOOTING

7.1 No Internet Connection

- Ensure the SIM card is correctly inserted and active.
- Check the signal strength indicators on the device or via the Tether app.
- Verify that the router is powered on and all cables are securely connected.
- Restart the router and your connected devices.

- Confirm your SIM card has an active data plan.

7.2 Wi-Fi Not Visible or Connectable

- Ensure the Wi-Fi function is enabled (check via Tether app or web interface).
- Verify the Wi-Fi network name (SSID) and password.
- Move closer to the router to improve signal strength.
- Reset the router to factory defaults if issues persist (refer to the Quick Installation Guide for instructions).

8. SPECIFICATIONS

Feature	Detail
Brand	TP-Link
Model Name	TL-MR110-Outdoor
Operating System	TP-Link Firmware
Connectivity Technology	Ethernet, Wi-Fi 2.4 GHz
Wireless Communication Standard	802.11n
Frequency Band Class	Single-band
4G LTE Speed	Up to 150 Mbps (Cat 4)
Wi-Fi Speed	Up to 300 Mbps (2.4 GHz)
Compatible Devices	Personal Computer, Laptop, Smartphone, Tablet
Special Features	IP65 Casing, PoE/DC Power, Operating Temperature -30 °C to +60 °C, 6 kV Lightning Protection, 15 kV ESD Protection
Power Supply	12 V DC, Passive PoE (48 V), 802.3af PoE (44-57 V)
Recommended Uses	Outdoor
Included Components	TL-MR110 Outdoor Unit, 10m RJ45 Ethernet Cable, PoE Adapter, Power Cable, Quick Installation Guide, Mounting Kits

Débit 4G LTE
150 Mbit/s
Débit WiFi
300 Mbit/s

4G



Montage sur mât, mur ou fenêtre



Alimentation
PoE/DC



Plug and play



Connectez jusqu'à
32 appareils

IP65

Étanche et résistant
à la poussière

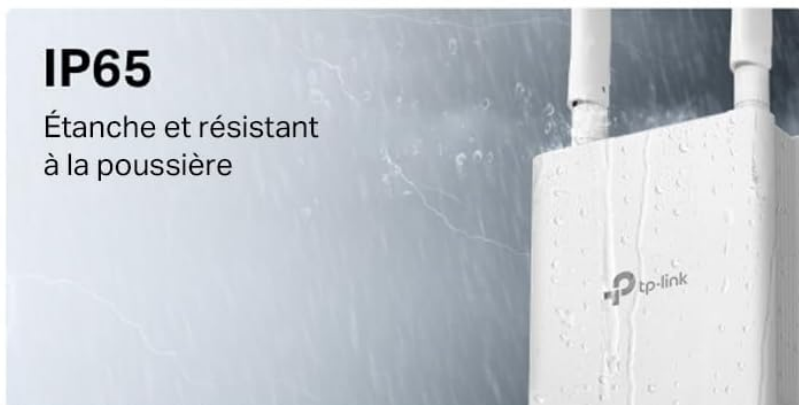

Image 8.1: Key features summary of the TL-MR110-Outdoor.





9. WARRANTY AND SUPPORT

For warranty information, technical support, and additional resources, please visit the official TP-Link website or contact their customer support. Details regarding warranty periods and service procedures are typically provided with your product documentation or on the manufacturer's website.

Manufacturer: TP-Link

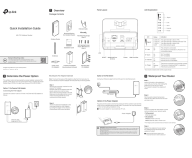
Country of Origin: China

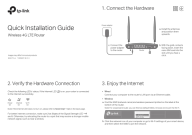
Related Documents - TL-MR110-Outdoor

	<p>TP-Link 4G LTE Outdoor Router Quick Installation Guide</p> <p>Step-by-step instructions for installing and setting up your TP-Link 4G LTE Outdoor Router (Model TL-MR100-Outdoor), including mounting, power options, waterproofing, and initial configuration via Tether app or web browser.</p>
	<p>TP-Link Outdoor Router Quick Installation Guide</p> <p>A comprehensive guide to installing and configuring your TP-Link outdoor router, covering power options, mounting instructions, and troubleshooting FAQs.</p>
	<p>Guide de l'utilisateur TP-Link TL-MR110 4G LTE</p> <p>Manuel complet pour le routeur TP-Link TL-MR110 4G LTE, couvrant l'installation, la configuration réseau, la sécurité, la gestion et le dépannage pour une connectivité Internet optimale.</p>
	<p>TP-Link Wireless 4G LTE Router Quick Installation Guide</p> <p>This guide provides step-by-step instructions for setting up your TP-Link Wireless 4G LTE Router, including hardware connection, verifying internet status, wireless and wired connectivity, router customization via web management, and using the TP-Link Tether app. It also includes troubleshooting tips and safety information.</p>
	<p>TP-Link Router Troubleshooting Guide: Access and Internet Issues</p> <p>Comprehensive troubleshooting steps for TP-Link routers, addressing common issues like inability to access the web management page or the internet, and how to perform a factory reset.</p>
	<p>TP-Link Outdoor Router Quick Installation Guide</p> <p>A comprehensive guide for setting up and installing your TP-Link outdoor router. Learn about power options, waterproof cable connections, mounting methods on poles, walls, and windows, router configuration, and frequently asked questions.</p>

