

KU XIU X39 ProMax

KU XIU Magnetic Wireless Charging Panel User Manual

Model: X39 ProMax

1. INTRODUCTION

This manual provides instructions for the KU XIU Magnetic Wireless Charging Panel, designed to securely mount and wirelessly charge your compatible iPad Pro. Please read this manual thoroughly before use to ensure proper installation and operation.

Compatibility

- **iPad Pro:** ONLY compatible with iPad Pro 11-inch M4 (2024) and iPad Pro 11-inch M5 (2025).
- **Mount:** Designed for use with 17mm ball head stands/mounts.
- **Important Note:** Not compatible with other iPad models, Android tablets, or other devices. The charging function is not compatible with iPadOS Beta series; please use the official release or upgrade for full functionality.

Important Considerations

- The package includes only the magnetic panel and accessories. The arm/mount/stand is **not included** and must be purchased separately.
- To prevent sagging, ensure your chosen stand has a load capacity of at least 1.1 kg (2.4 lbs).

Important Note:

1. The package includes only the magnetic panel, the stand/holder is not included.
2. To prevent your mount from sagging, ensure your stand has a load capacity of at least **1.1kg (2.4lbs)**.



The magnetic charging panel requires a separate stand or mount for use.

2. PACKAGE CONTENTS

Verify that all items listed below are included in your package:

- Magnetic Charging Panel ×1
- 2M USB-C Charging Cable ×1
- User Manual ×1
- Cable Clips ×10
- Nano Traceless Double-sided Tape ×10

Magnetic Wireless Charging Panel ONLY Compatible With

✓ 2024 iPad Pro 11-in.(M4)

✓ 2025 iPad Pro 11-in.(M5)

Special Note:

1. The charging function is not compatible with iPadOS Beta series, please use the official release or upgrade for full functionality!
2. **NOT** compatible with other iPad versions or Android tablets!

PACKAGE CONTENTS

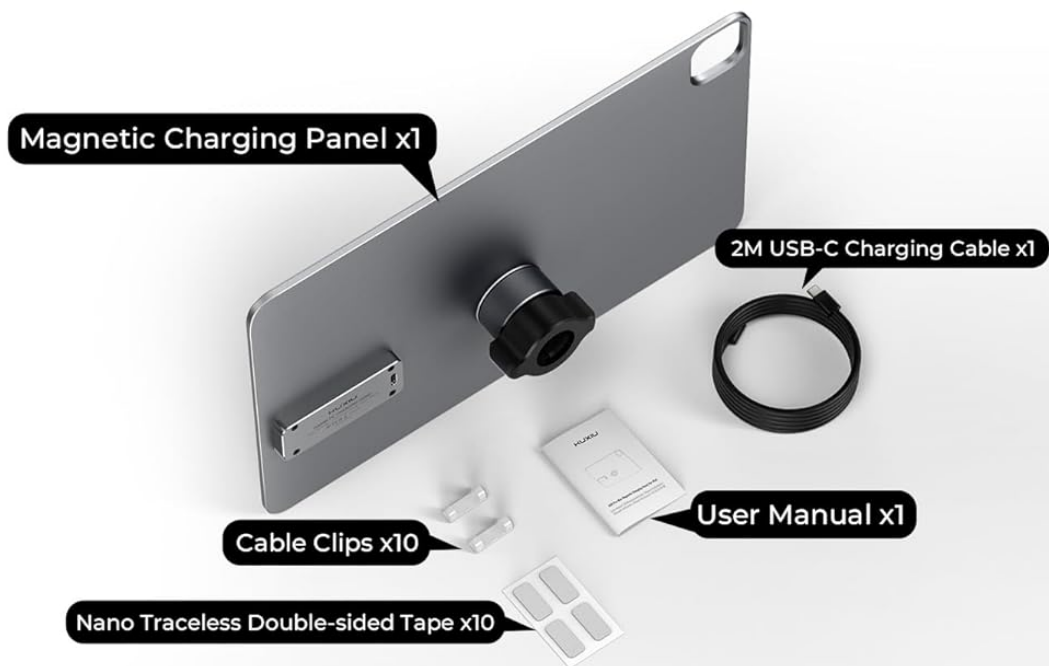

All components included in the KU XIU Magnetic Wireless Charging Panel package.

3. SETUP INSTRUCTIONS

3.1 Attaching to a 17mm Ball Head Mount

1. Ensure your existing tablet mount has a 17mm ball head.
2. Align the socket on the back of the magnetic charging panel with the 17mm ball head of your mount.

3. Secure the panel by tightening the collar around the ball head until it is firmly in place.



Securely attach the magnetic panel to a 17mm ball head mount.

3.2 Connecting the USB-C Cable

1. Connect one end of the provided 2M USB-C charging cable to the USB-C port on the magnetic charging panel.
2. Connect the other end of the USB-C cable to a compatible power adapter (not included). For optimal charging, use an 18W or higher power adapter.
3. Use the included cable clips and nano traceless double-sided tape to manage the cable neatly along your mount

or desk, if desired.



The panel charges the iPad wirelessly, leaving the iPad's USB-C port available.

4. OPERATING INSTRUCTIONS

4.1 Magnetic Attachment

The panel features 88 high-quality N52 neodymium magnets for a strong and secure hold.

1. Align your compatible iPad Pro 11-inch M4/M5 with the magnetic charging panel.
2. The iPad will automatically snap into place due to the strong magnetic force.
3. Ensure the iPad is centered and fully seated on the panel for optimal connection and charging.

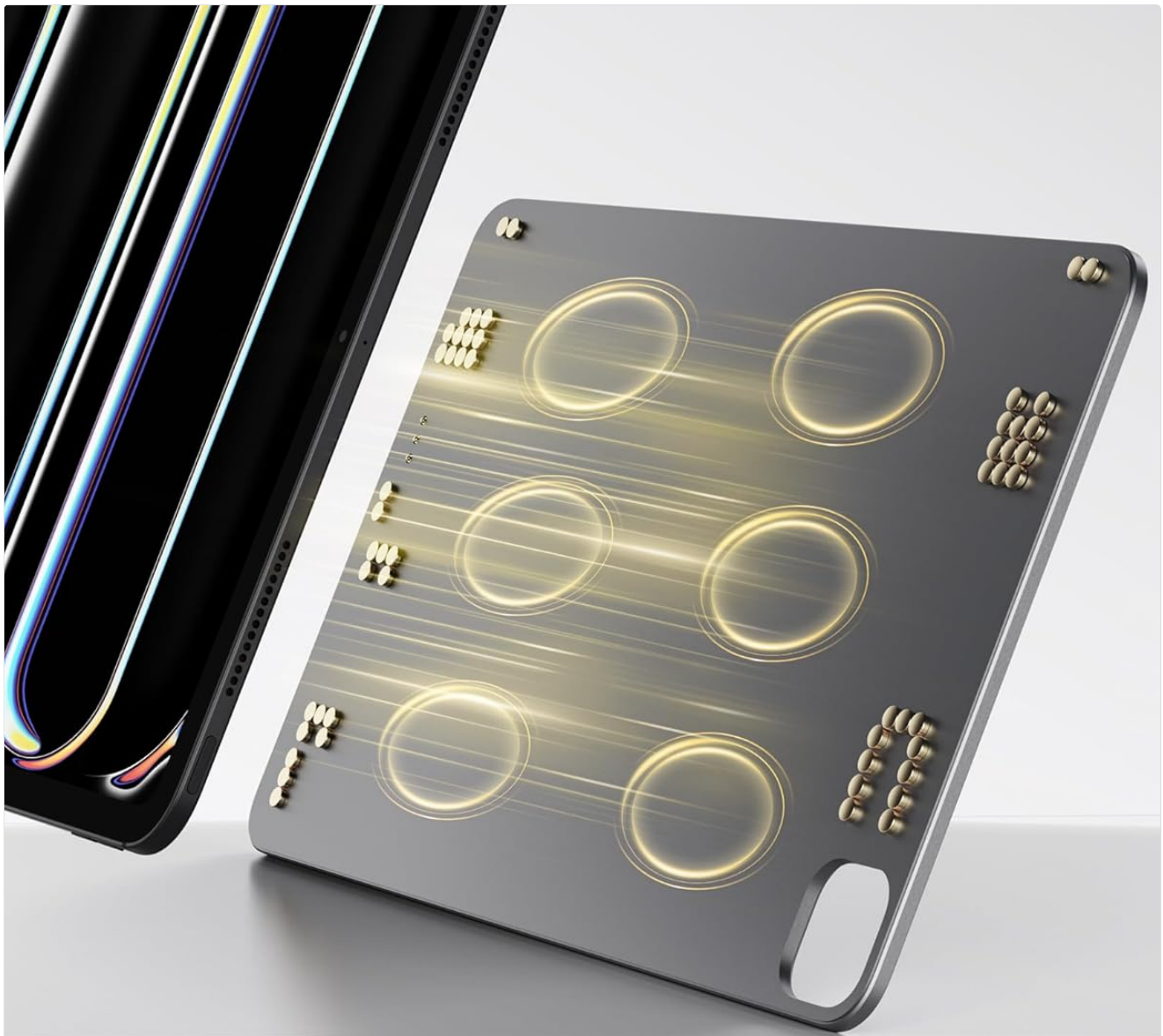

Super Magnetic Adsorption Force

84 N52 neodymium magnets precisely aligned



Auto-Lock
Into Place



Gripping Power
Increased 500%



No Shaking
No Falling

The panel uses strong magnets for secure iPad attachment.

4.2 Wireless Charging

Once your iPad is magnetically attached and the panel is connected to power, wireless charging will begin automatically via the iPad's Smart Connector.

- The panel delivers up to 18W of power for fast wireless charging.
- The original Type-C port on your iPad remains open and usable for connecting other devices or accessories while charging wirelessly.

TOP.1 WORLD'S FIRST

Magnetic Wireless Charging
Panel for iPad



Pin Smart Connector
18W Fast Charging

Wireless charging is initiated via the Smart Connector upon magnetic attachment.

4.3 Unobstructed Display

The magnetic design ensures a 100% unobstructed display, unlike traditional clip-on mounts that may block a portion of the screen.

Clip-to-Magnetic Mount Upgrade

Magnetic Panel:
100% unobstructed



Clip-On:
15% occlusion



Enjoy a full, unobstructed view of your iPad screen.

5. MAINTENANCE

To ensure the longevity and optimal performance of your KU XIU Magnetic Wireless Charging Panel, follow these maintenance guidelines:

- **Cleaning:** Use a soft, dry, lint-free cloth to wipe the surface of the panel. Avoid using abrasive cleaners, solvents, or aerosol sprays, which can damage the finish.

- **Storage:** When not in use, store the panel in a clean, dry environment away from extreme temperatures and direct sunlight.
- **Handling:** Avoid dropping the panel or subjecting it to strong impacts, as this may affect its structural integrity and magnetic properties.

6. TROUBLESHOOTING

If you encounter issues with your magnetic wireless charging panel, refer to the following common solutions:

6.1 iPad Not Charging

- **Check Compatibility:** Ensure your iPad is an iPad Pro 11-inch M4 (2024) or M5 (2025). The panel is not compatible with other iPad models or Android tablets.
- **Power Connection:** Verify that the USB-C cable is securely connected to both the charging panel and a working power adapter. Ensure the power adapter is plugged into a live outlet.
- **Power Adapter:** Use a power adapter that provides sufficient wattage (18W or higher recommended).
- **iPad Alignment:** Re-attach your iPad to the panel, ensuring it is properly aligned and the magnetic connection is firm.
- **iPadOS Version:** If using an iPadOS Beta version, the charging function may not work. Update to an official iPadOS release for full functionality.

6.2 On-Screen Keyboard Disappears

- This is a known behavior for some iPad models when connected to certain accessories. If the on-screen keyboard does not appear, consider using an external Bluetooth keyboard for typing.

6.3 Panel Sagging or Instability

- Ensure your mount/stand has a sufficient load capacity of at least 1.1 kg (2.4 lbs) to support the iPad and panel without sagging.
- Verify that the 17mm ball head connection is tightened securely.

7. SPECIFICATIONS

Brand	KU XIU
Model Name	X39 ProMax
Compatible Devices	iPad Pro 11-inch M4 (2024), iPad Pro 11-inch M5 (2025)
Mounting Type	Compatible with 17mm Ball Head Mounts
Wireless Charging Output	Up to 18W
Material	Aircraft-Grade Aluminum Alloy
Weight Capacity (Mount)	Minimum 1.1 kg (2.4 lbs) recommended

Sturdy Aircraft-Grade Aluminum Alloy Build

High load-bearing capacity and corrosion resistance

CNC High-Speed Machining

Sandblasting and Anodic Oxidation Treatment



The panel is constructed from durable aircraft-grade aluminum alloy.

8. SUPPORT & WARRANTY

For any questions, concerns, or technical assistance, please contact KU XIU customer support. We are committed to providing excellent service.

- **Customer Service:** Refer to the contact information provided with your product packaging or visit the official KU XIU store on Amazon: [KU XIU Store](#).
- **Warranty:** This product typically comes with a 1-year limited warranty from the date of purchase. Please retain your proof of purchase for warranty claims. For detailed warranty terms and conditions, contact customer support.