



Manuals.plus /

› BoyKeep /

› BoyKeep 2K Pet Camera K30 Instruction Manual

## BoyKeep K30

# BoyKeep 2K Pet Camera K30 Instruction Manual

MODEL: K30

## 1. Package Contents

---

Verify that all items are present in your package:

- BoyKeep K30 2K Pet Camera
- Power Adapter
- USB Cable (Micro USB)
- Instruction Manual

## 2. Setup Guide

---

### 2.1 Powering On the Camera

1. Connect the Micro USB cable to the camera's USB port (located at the back of the base).
2. Plug the power adapter into a standard electrical outlet.
3. The camera will perform an automatic calibration sequence, rotating to its full range. Wait for the voice prompt indicating it is ready for connection.

### 2.2 App Download and Installation

To control your BoyKeep K30 camera, download the 'BoyKeep' app on your smartphone.

- Scan the QR code provided in the manual or on the packaging.
- Alternatively, search for 'BoyKeep' in the Apple App Store or Google Play Store.
- Install the app and register a new account or log in if you already have one.

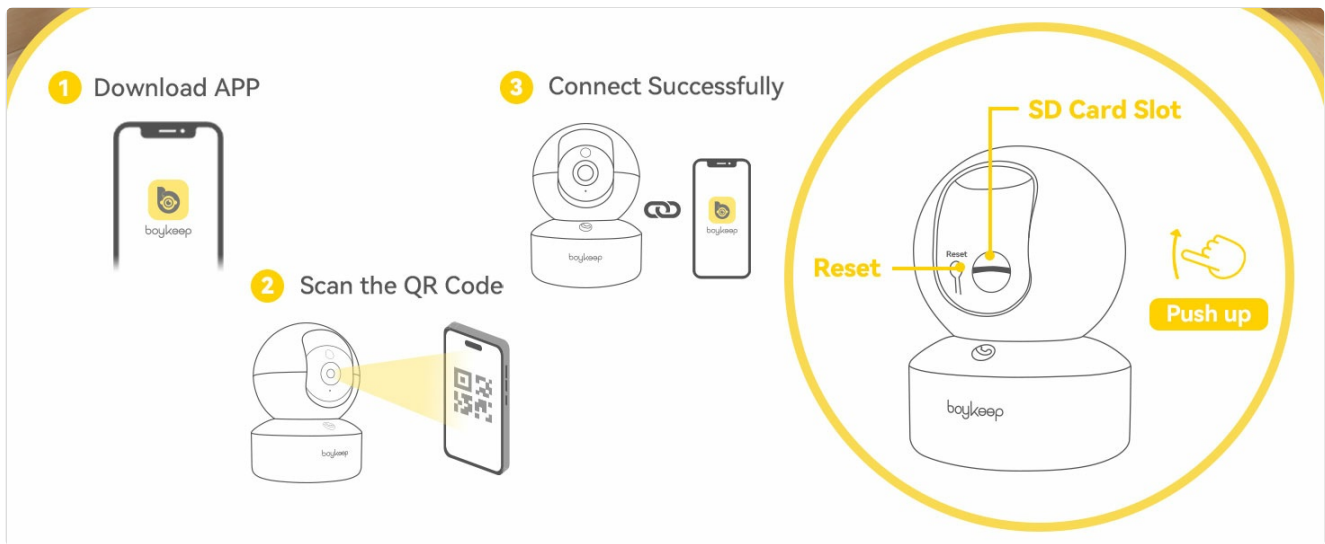

Image: Scan the QR code to download the BoyKeep app or find it in your app store. The app requires iOS 10.0 or later / Android 5.0 or later.

## 2.3 Connecting to Wi-Fi

The BoyKeep K30 supports both 5GHz and 2.4GHz Wi-Fi networks for flexible connectivity.

1. Open the BoyKeep app and tap 'Add your first device' or the '+' icon.
2. Select 'Indoor Camera' and then 'K30' (Dome Cam).
3. Choose 'Wi-Fi Connection'.
4. Follow the on-screen instructions to enter your Wi-Fi network name and password.
5. The app will generate a QR code. Place your phone's screen 4 to 12 inches in front of the camera lens. The camera will beep when it successfully scans the code.
6. Wait for the device to connect to the network. This process may take 1-2 minutes.

## 2.4 Mounting the Camera

The camera can be placed on a flat surface or mounted to a wall or ceiling. Mounting hardware is sold separately.

- For wall mounting, use appropriate screws and anchors for your wall type.
- Ensure the camera is securely fastened and has a clear line of sight to the desired monitoring area.

Your browser does not support the video tag.

Video: This video demonstrates the unboxing, powering on, and Wi-Fi connection process for the BoyKeep K30 camera, including scanning the QR code for app setup and initial camera calibration.

## 3. Operating Instructions

### 3.1 Live View and Pan/Tilt Control

Access the live feed from your camera through the BoyKeep app. You can remotely control the camera's viewing angle.

- In the app's live view, use the directional controls to pan (rotate horizontally up to 360°) and tilt (move vertically up to 110°) the camera lens.
- The 2K resolution provides clear, detailed images.



Motion Tracking



Two-way Audio



Realistic Video



Night Vision



Image: The BoyKeep K30 camera offers 360° horizontal pan and 95° vertical tilt for comprehensive room coverage.



Image: The camera features 355° pan and 110° tilt capabilities, allowing for a wide-angle view of your space.

### 3.2 Two-Way Audio

Communicate with individuals or pets near the camera using the two-way audio feature.

- Tap the microphone icon in the live view to speak through the camera's speaker.
- The camera's built-in microphone allows you to hear sounds from the monitored area.



Image: The camera supports two-way audio, enabling easy communication with those in the camera's vicinity.

### 3.3 Night Vision

The camera provides clear monitoring even in low-light conditions or complete darkness.

- The camera automatically switches to night vision mode when light levels are low.
- It features full-color night vision, capturing vivid images even in total darkness.

## Records Every Moment

Never miss any precious moments

 30 Days Free Cloud

 Micro SD Card Storage (8-128G)



Image: The camera offers clear night vision, allowing for continuous monitoring in dark environments.

### 3.4 Motion Tracking and Detection

The camera can detect movement and automatically track subjects within its field of view.

- Enable smart motion tracking in the app settings. The camera will follow detected movement.
- Set specific zones for targeted monitoring to receive alerts only for activity in critical areas.
- Receive real-time notifications on your phone when motion is detected.

## Records Every Moment

Never miss any precious moments

 30 Days Free Cloud

 Micro SD Card Storage (8-128G)

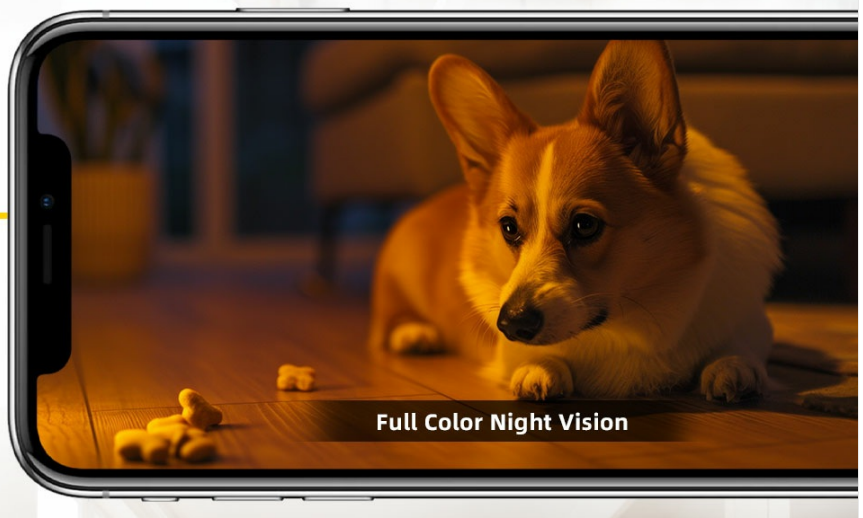

Image: Smart AI detection and tracking features allow the camera to identify and follow people and pets, capturing key moments.

### 3.5 One-Touch Call

The camera features a physical button for initiating a call to the connected smartphone.

- Press the one-touch call button on the camera to initiate an immediate call to the paired smartphone.
- This feature is useful for children or seniors to quickly contact family members.

# Records Every Moment

Never miss any precious moments

 30 Days Free Cloud

 Micro SD Card Storage (8-128G)



Image: The camera includes a one-touch call button, allowing users to initiate a call to the connected phone for instant communication.

## 3.6 Storage Options

The BoyKeep K30 camera offers flexible storage solutions for your recordings.

- **MicroSD Card Storage:** The camera supports a microSD card (up to 256GB, not included) for continuous 24/7 recording. The slot is accessible by tilting the camera lens upwards.
- **Cloud Storage:** Free lifetime cloud storage is available for 12-second motion-detection clips from the last 24 hours (activation required via app). Premium cloud plans are available for continuous recording.

# Versatile Storage Options



## Cloud Storage

Not Required



## 24/7 Recording

Support for Up to 128GB SD Card (Not included)



Image: The camera offers versatile storage options including cloud storage (not required for basic function) and 24/7 recording with an SD card (up to 128GB, not included).

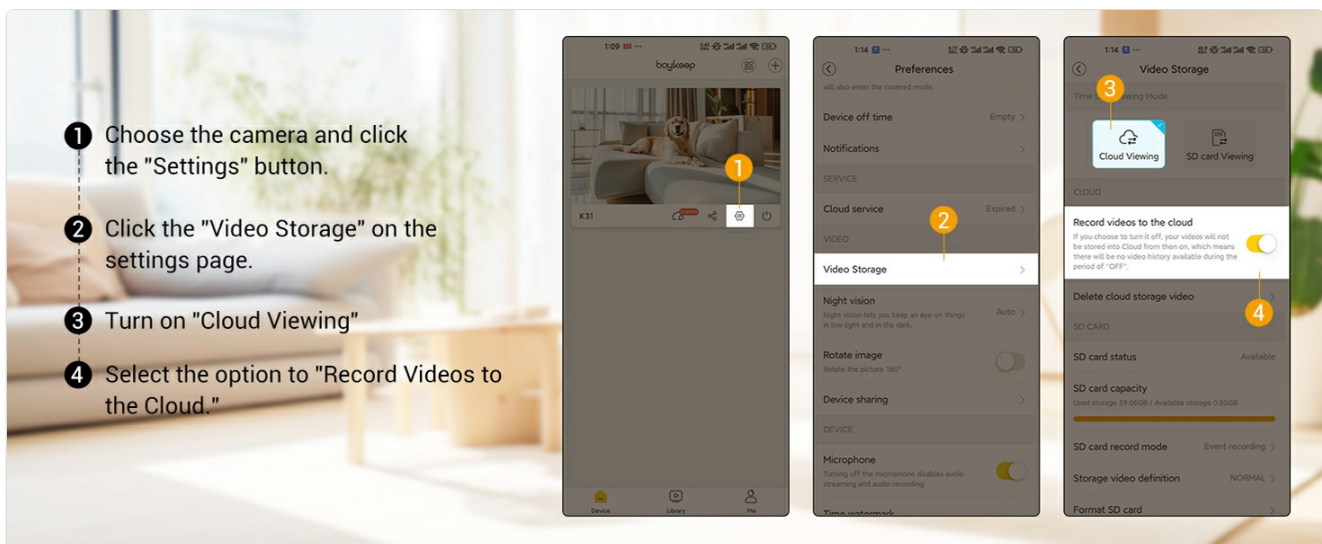

Image: Steps to enable cloud storage recording: Choose camera settings, click 'Video Storage', turn on 'Cloud Viewing', and select 'Record Videos to the Cloud'.

## 4. Maintenance

Regular maintenance ensures optimal performance and longevity of your BoyKeep K30 camera.

- **Cleaning:** Gently wipe the camera lens and body with a soft, dry cloth. Avoid using harsh chemicals or abrasive materials.
- **Firmware Updates:** Periodically check the BoyKeep app for available firmware updates. Updates often include performance improvements and security enhancements.
- **Power Cycle:** If the camera experiences issues, try unplugging it from the power source for 10 seconds and then plugging it back in.

## 5. Troubleshooting

If you encounter problems with your BoyKeep K30 camera, refer to the following common issues and solutions:

- **Camera Not Connecting to Wi-Fi:**  
Ensure your Wi-Fi password is correct. Verify that the camera is within range of your Wi-Fi router. Try resetting the camera by pressing the reset button (located under the lens when tilted up) for 5 seconds.
- **Poor Image Quality:**  
Check your Wi-Fi signal strength. Ensure the camera lens is clean and free from obstructions. Adjust the video quality settings in the app (FHD/SD).
- **Two-Way Audio Issues:**  
Ensure your phone's volume is up and the microphone in the app is not muted. Check the camera's speaker volume in the app settings.
- **Motion Detection Not Working:**  
Verify that motion detection is enabled in the app settings. Adjust sensitivity levels and detection zones as needed.
- **SD Card Not Recording:**  
Ensure the SD card is correctly inserted and formatted within the app. Check if the SD card has sufficient storage space.

## 6. Specifications

Feature	Specification
Model Name	K30
Indoor/Outdoor Usage	Indoor
Video Capture Resolution	1296p (2K)
Connectivity Technology	Wireless (Wi-Fi)
Connectivity Protocol	5G & 2.4GHz Wi-Fi
Pan & Tilt Range	360° Pan, 110° Tilt
Special Feature	Adjustable, 2-Way Audio, Color Night Vision, Motion Tracking, One-Touch Call
Storage Options	MicroSD Card (up to 256GB), Cloud Storage
Power Source	Corded Electric
Compatible Devices	Smartphone
Product Dimensions	4.57 x 3.35 x 6.46 inches
Item Weight	1.26 pounds (0.57 Kilograms)

## 7. Warranty and Support

---

For warranty information, technical support, or customer service, please refer to the contact details provided in your product packaging or visit the official BoyKeep website.

**Email:** [support@boykeep.com](mailto:support@boykeep.com)

**Website:** [www.boykeep.com](http://www.boykeep.com)