

johgee WiFi 3 Voies avec RF 500M

Johgee WiFi 3-Way Watering Programmer Instruction Manual

Model: **WiFi 3 Voies avec RF 500M** | Brand: **Johgee**

1. PRODUCT OVERVIEW

The Johgee WiFi 3-Way Watering Programmer is an intelligent irrigation system designed to automate and manage your garden's watering needs with precision and convenience. Featuring advanced RF 433 wireless technology, it offers an impressive control range of up to 500 meters (without obstacles), allowing you to manage your watering system from various points within your property. This device supports three independently programmable outlets, making it ideal for diverse watering requirements across different zones like lawns, vegetable gardens, and other plants.

Key features include:

- **Extended Range RF 433 Technology:** Control your watering system up to 500 meters away.
- **Three Independent Outlets:** Program up to three separate watering zones simultaneously.
- **Scheduled Watering Mode:** Set up to 5 watering plans for automatic irrigation at specific times.
- **Misting Irrigation Mode:** Ideal for cooling and dust reduction with intermittent spray cycles.
- **Smart Rain Delay:** Manually set delays from 1 to 7 days or allow automatic adjustments based on real-time weather forecasts.
- **WiFi 2.4 GHz Connectivity:** Connect to the Smart Life/Tuya app for remote control and management.
- **Voice Control Compatibility:** Works with Alexa and Google Assistant for hands-free operation.
- **Battery Protection:** Prevents operation when battery is low to conserve water and protect the device.
- **Durable Construction:** Made from high-quality, heat-resistant materials, suitable for outdoor use.



Figure 1.1: Johgee WiFi 3-Way Watering Programmer with its gateway and accessories.

2. PACKAGE CONTENTS

Please ensure all components are present before proceeding with installation:

- 1 x Johgee WiFi 3-Way Watering Programmer
- 1 x RF 433 Gateway Adapter
- 3 x Water Valve Connectors
- 1 x Raw Tape (for sealing connections)
- 1 x User Manual (this document)

3. SETUP AND INSTALLATION

3.1 Powering the Device

The watering programmer requires batteries for operation. Ensure you insert the correct type and number of batteries as indicated in the battery compartment. The device will not operate if the battery level is too low.

3.2 Connecting the Gateway

The RF 433 Gateway is essential for WiFi connectivity and remote control. Follow these steps to connect the gateway:

1. Plug in the Gateway adapter to a power outlet.
2. Download the **Smart Life** or **Tuya Smart** application from your mobile device's app store (available for Android and iOS).
3. Open the app and register or log in to your account.
4. In the app, turn on the power of the Gateway and navigate to the Smart Home APP interface to add Gateway Devices.
5. Select "Add Device" and choose the Gateway from the list of discoverable devices.
6. Enter your 2.4 GHz WiFi network information (SSID and password) when prompted. The gateway only supports 2.4 GHz WiFi.
7. Once connected, the app will confirm the successful addition of the Gateway.

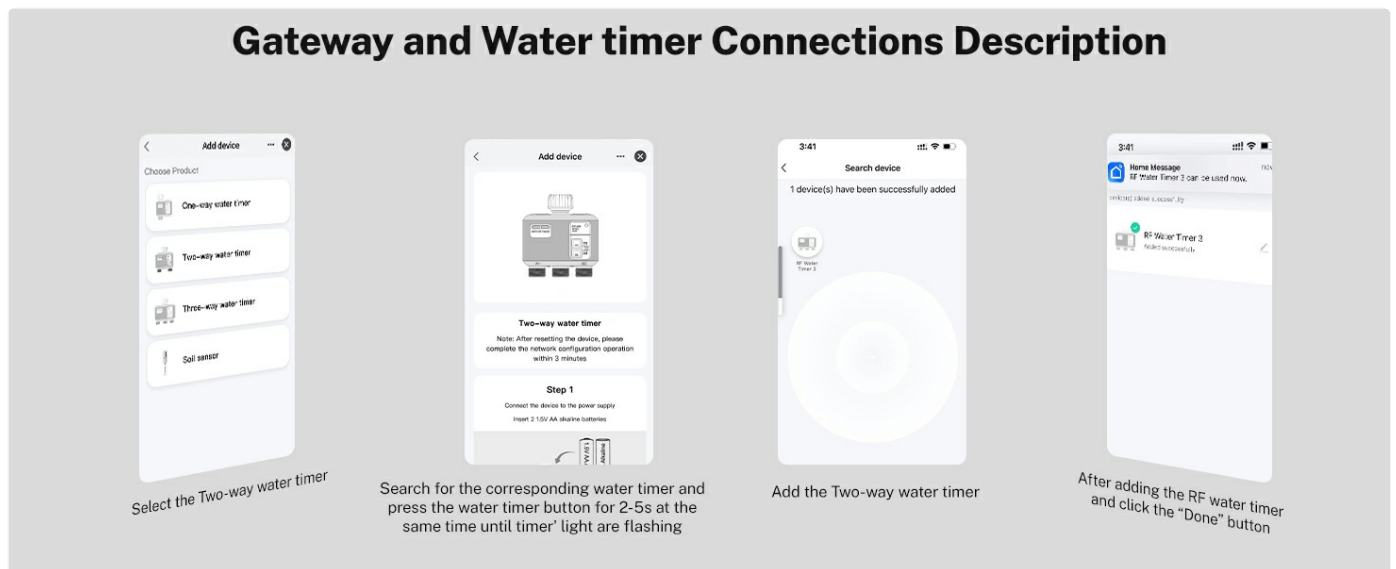

Figure 3.1: Initial steps for connecting the Gateway to the Smart Life/Tuya app.

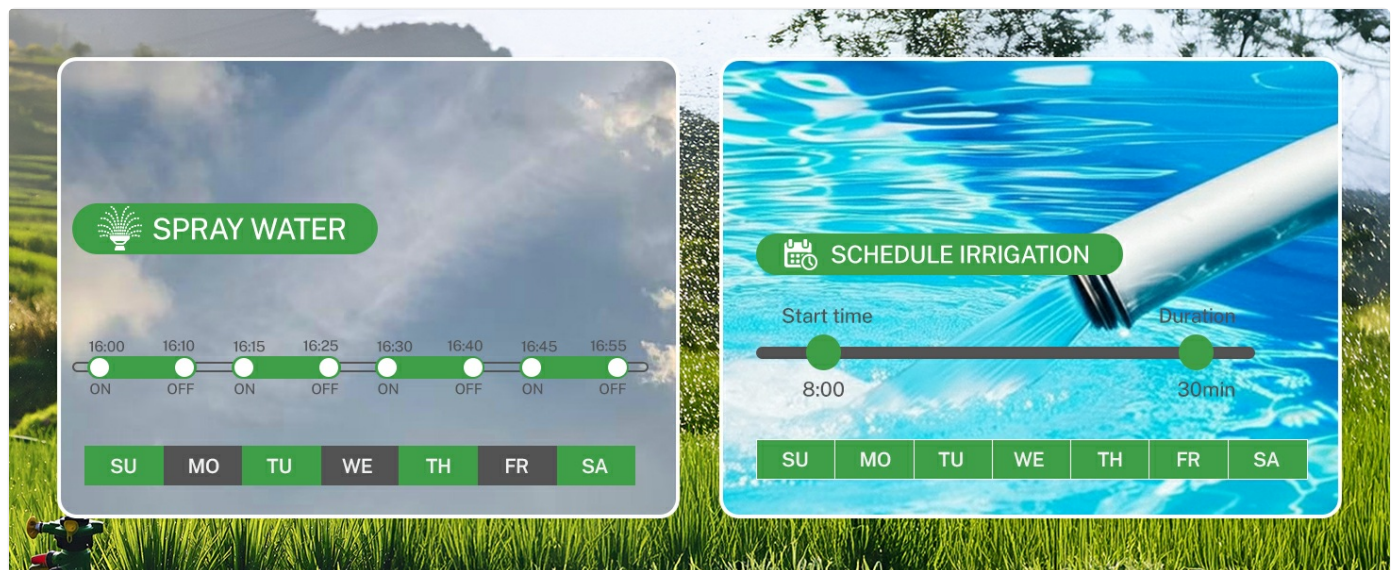

Figure 3.2: Steps for adding the water timer to the app after gateway setup.

3.3 Connecting the Watering Programmer to the Gateway

After the Gateway is successfully connected to your WiFi network, you can add the watering programmer:

1. In the Smart Life/Tuya app, select the option to add a new device under your Gateway.
2. Choose the "Three-way water timer" option.
3. On the watering programmer, press and hold the designated button (refer to the device's physical buttons, usually marked A, B, C or a pairing button) for 2-5 seconds until the indicator light starts flashing, indicating pairing mode.
4. The app will search for and discover the watering programmer.
5. Confirm the addition in the app. Once successfully paired, the device will appear in your app interface.

3.4 Physical Installation

Attach the Johgee WiFi 3-Way Watering Programmer directly to your outdoor faucet. Ensure a secure and watertight connection. Then, connect your garden hoses to the three independent outlets (Zone A, Zone B, Zone C) on the programmer. Use the provided raw tape for better sealing if necessary.



Figure 3.3: The watering programmer installed with three independent hose connections.

4. OPERATING INSTRUCTIONS

The Johgee WiFi 3-Way Watering Programmer offers various modes for flexible irrigation management via the Smart Life/Tuya app.

4.1 Scheduled Watering Mode

This mode allows you to set precise watering schedules for each of the three zones. You can create up to 5 watering plans.

1. Open the Smart Life/Tuya app and select your Johgee watering programmer.
2. Navigate to the "Schedule" or "Programmed Watering" section.
3. Choose the zone (A, B, or C) you wish to program.
4. Set the **Start Time** and **Runtime** (duration) for the watering cycle.
5. Select the specific days of the week for the schedule to repeat (e.g., Monday, Wednesday, Friday).
6. Save the schedule. You can set multiple schedules for each zone.

The app allows for both single watering mode and circulating water supply mode, enabling daily watering or custom schedules.



Figure 4.1: Setting up a scheduled irrigation plan within the mobile application.

4.2 Misting Irrigation Mode (Spray Mode)

This mode is designed for intermittent spraying, suitable for cooling or dust reduction. The watering programmer will turn the 3 outlets on and off intermittently.

1. In the app, select the "Spray" or "Misting Mode" option.
2. Set the **Start Time** and **End Time** for the misting period.
3. Define the **Spray Duration** (how long the spray is on) and **Interval Duration** (how long the spray is off) for each cycle. These can range from 1 to 59 minutes.
4. Select the days of the week for the misting schedule.
5. Save the settings.

SPRAY IRRIGATION

Spray watering for summer outdoor cooling and dust reduction



Figure 4.2: Configuring the spray irrigation mode for intermittent watering.

4.3 Smart Rain Delay

The smart rain delay feature helps conserve water by pausing irrigation during or before rainfall.

- **Manual Rain Delay:** In the app, you can manually set a rain delay for 1 to 7 days. During this period, all scheduled watering will be paused.
- **Automatic Rain Delay:** The timer utilizes real-time weather forecasts to automatically adjust or pause your watering plan, helping to save water. Ensure your location services are enabled for accurate weather data.



Figure 4.3: Options for setting a smart rain delay in the application.

4.4 Manual Watering

You can initiate manual watering at any time without interrupting your pre-set schedules.

- **Via App:** In the Smart Life/Tuya app, select the desired zone and choose the "Manual Watering" option. Set the duration for immediate watering.
- **Via Device:** The device may have physical buttons (A, B, C) to manually activate each zone for a short period. Refer to the device's physical interface for specific button functions.

MANUAL WATERING ANYTIME

Without interrupting present watering schedules



Figure 4.4: Manual watering can be initiated via the app at any time.

4.5 Voice Control

The Johgee watering programmer is compatible with Alexa and Google Assistant for convenient voice control.

1. Ensure your Smart Life/Tuya account is linked to your Alexa or Google Home app.
2. Discover new devices in your voice assistant app.
3. You can then use voice commands such as:
 - "Alexa, turn on the WiFi water timer Zone A."
 - "Hey Google, start watering Zone B for 10 minutes."

APP & VOICE CONTROL

Compatible with Alexa and Google Assistant

))) Alexa, turn on the WiFi water time Zone A

))) Ok



Figure 4.5: Controlling the watering programmer using voice commands with Alexa or Google Assistant.

5. MAINTENANCE

5.1 Battery Replacement

The watering programmer is equipped with a battery protection feature that prevents operation when the battery is low to avoid water wastage. When the battery level is low, replace the batteries promptly. The app may also provide low battery reminders.

Gateway and Water timer Connections Description

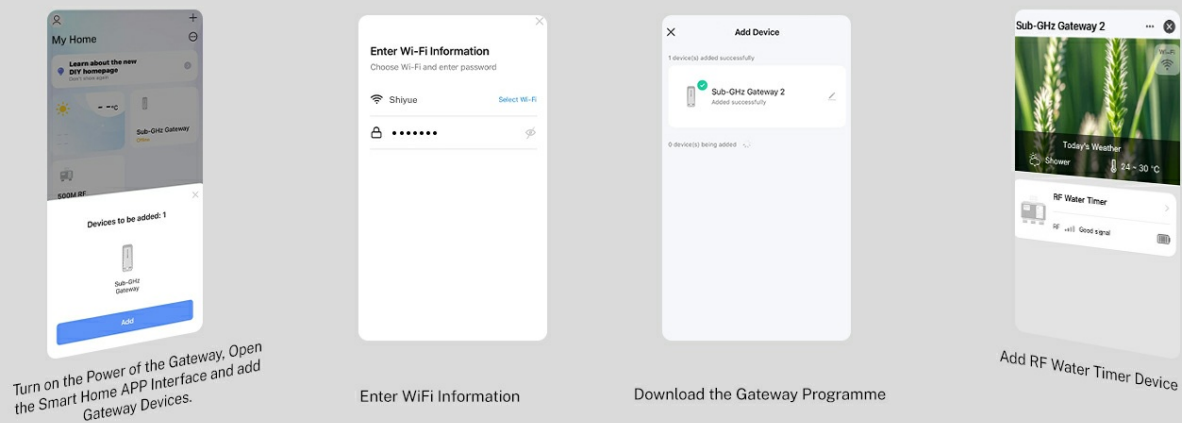

Figure 5.1: The device features IPX5 waterproofing and low battery protection with reminders.

5.2 Cleaning and Storage

Regularly inspect the device for any debris or mineral buildup, especially around the hose connections. Clean with a soft, damp cloth. During winter months or periods of non-use, disconnect the programmer from the faucet, remove batteries, and store it in a dry, frost-free location to prevent damage.

6. TROUBLESHOOTING

Problem	Possible Cause	Solution
Device not connecting to WiFi/App.	Incorrect WiFi password; 5GHz WiFi network; Gateway not powered or paired.	Ensure correct 2.4 GHz WiFi network is selected. Verify Gateway is powered and successfully added to the app. Restart Gateway and try pairing again.
Watering not starting as scheduled.	Low battery; Rain delay active; Incorrect schedule settings; Water supply off.	Check battery level and replace if necessary. Disable rain delay if active. Verify schedule times and days in the app. Ensure the faucet is turned on.
Poor RF signal or limited range.	Obstacles between Gateway and programmer; Distance too great.	Relocate the Gateway closer to the watering programmer, minimizing physical obstructions. Ensure the Gateway is not placed near large metal objects or other sources of interference.
Water leakage from connections.	Loose connections; Damaged O-rings/seals.	Ensure all connections are tightened securely. Use the provided raw tape for better sealing. Inspect O-rings and replace if damaged.

7. SPECIFICATIONS

Feature	Detail
Model	WiFi 3 Voies avec RF 500M
Brand	Johgee
Connectivity	WiFi 2.4 GHz, RF 433 MHz
RF Control Range	Up to 500 meters (without obstacles)
Number of Outlets	3 independent outlets
Material	Plastic
Color	Green
Dimensions (Package)	23.1 x 17.7 x 8.2 cm
Weight	782 grams
Power Source	Batteries (not included, required)
Water Resistance	IPX5
App Compatibility	Smart Life / Tuya Smart (Android, iOS)
Voice Assistant Compatibility	Amazon Alexa, Google Assistant

8. WARRANTY AND SUPPORT

Specific warranty details are not provided in the product information. For warranty claims, technical support, or further assistance, please contact Johgee customer service through their official channels or the retailer from whom you purchased the product.





You can visit the official Johgee brand store for more information and contact options:[Johgee Brand Store](#)

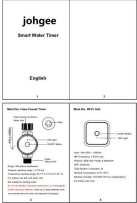

© 2025 Johgee. All rights reserved.

Related Documents - WiFi 3 Voies avec RF 500M

	<p>Johgee HCT-355 Water Timer User Manual and Warranty Information</p> <p>Comprehensive guide for the Johgee HCT-355 Water Timer, covering setup, programming, features, maintenance, troubleshooting, and warranty details. Learn how to use this flexible and precise irrigation timer for lawns, gardens, and more.</p>
---	--

	<p>Johgee Smart Water Timer User Manual</p> <p>User manual for the Johgee Smart Water Timer, detailing setup, features, and troubleshooting for both the Hose Faucet Timer and the Wi-Fi Hub. Includes instructions for app integration, manual watering, stop watering, and rain delay features.</p>
	<p>Johgee Salon Tray Cart Installation Instructions</p> <p>Detailed installation guide for the Johgee Salon Tray Cart, including parts list and step-by-step assembly instructions for this adjustable height rolling tray.</p>
	<p>Johgee HCT-355 Water Timer User Manual and Warranty Information</p> <p>Comprehensive guide for the Johgee HCT-355 Water Timer, covering setup, programming, features, maintenance, troubleshooting, and warranty details. Learn how to use this flexible and precise irrigation timer for lawns, gardens, and more.</p>
	<p>Programmateurs d'arrosage EMOS PW56202 - Guide d'utilisation et spécifications</p> <p>Découvrez le programmeur d'arrosage EMOS PW56202. Ce manuel fournit des informations sur l'installation, la configuration via l'application mobile EMOS GoSmart, les spécifications techniques et le dépannage.</p>
	<p>Smart WiFi Garden Water Timer User Manual - WT501</p> <p>User manual for the WT501 Smart WiFi Garden Water Timer. Learn how to set up, operate, and manage your garden's irrigation system remotely via the Tuya Smart app, with support for Alexa and Google Home.</p>