

Manuals+

[Q & A](#) | [Deep Search](#) | [Upload](#)

manuals.plus /

› [OSTMARS](#) /

› [OSTMARS Portable Electric Juicer Blender DIS0124 User Manual](#)

OSTMARS DIS0124

OSTMARS Portable Electric Juicer Blender DIS0124 User Manual

Model: DIS0124

1. INTRODUCTION

This manual provides essential instructions for the safe and efficient operation of your OSTMARS Portable Electric Juicer Blender, model DIS0124. Please read this manual thoroughly before first use and retain it for future reference. This portable blender is designed for preparing fresh juices, smoothies, and shakes.

2. IMPORTANT SAFETY INSTRUCTIONS

To reduce the risk of fire, electric shock, or injury, always follow these basic safety precautions:

- Read all instructions before using the appliance.
- Do not immerse the motor base in water or other liquids. Clean with a damp cloth only.
- Keep hands and utensils out of the blender cup while blending to prevent severe injury and damage to the blender.
- Ensure the lid is securely fastened before operating.
- Do not blend hot liquids, as pressure buildup may cause the lid to eject and result in burns.
- Do not operate the blender with an empty cup.
- Unplug the blender from the power source when not in use, before assembling or disassembling parts, and before cleaning.
- This appliance is not intended for use by persons with reduced physical, sensory, or mental capabilities, or lack of experience and knowledge, unless they have been given supervision or instruction concerning use of the appliance by a person responsible for their safety.
- Keep out of reach of children.
- Do not use attachments not recommended or sold by the manufacturer.
- Do not operate any appliance with a damaged cord or plug, or after the appliance malfunctions or has been dropped or damaged in any manner.
- Avoid contact with moving parts.

3. PRODUCT OVERVIEW

3.1 Components

Your OSTMARS Portable Electric Juicer Blender consists of the following main components:

- Motor Base with Blade Assembly
- Blender Cup (500mL capacity with 250mL and 500mL markings)
- Lid (Standard Lid and optionally a Lid with Straw/Strap)
- USB-C Charging Cable

Crushed Fruit Pulp

Healthy Vitamin C Energy Station

Fresh Squeezed
Fruit Pulp

No additives, light and burden-free

The fine steel blade evenly crushes and easily produces a delicate taste



Image: Disassembled view of the blender, illustrating the motor base with its integrated blade, the transparent blending cup, and the lid. This shows the

Double Cover

Chaoyin Double Cover

Double Cover
for Use

Fancy juice extraction for drinking

One cup with two lids, change as you like, drink as much fresh fruit as you want



Image: Two versions of the OSTMARS blender. One is shown with a standard, sealed lid, while the other features a lid equipped with a built-in straw and a convenient carrying strap, highlighting the "Double Cover" feature.

3.2 Features

- **Portable Design:** Compact and lightweight for on-the-go use.
- **Capacity:** 500mL blending capacity with clear 250mL and 500mL measurement markings.
- **Automatic Operation:** Simple one-button control for blending.
- **Blade Material:** Stainless Steel (Ten-leaf precision steel knife).
- **Power Source:** Battery Powered (5V, 1A input current, 7.4V battery capacity).
- **Charging:** Universal Type-C port for convenient charging.
- **Material:** BPA Free.
- **Easy to Clean:** Wide-mouth design and detachable components for simple cleaning.

Fresh and interesting drinks

Every feature is a highlight

OSTMARS makes companionship warmer and more comfortable



Note: Full cup water storage capacity 800ML, whipping capacity 500ML

Image: An infographic highlighting the blender's features: wireless portability, ease of cleaning, food-grade materials, long battery life, and strong blending capability. Note: The image mentions an 800mL water filling station, but the blending capacity is 500mL.

4. SETUP

1. **Unpack:** Carefully remove all components from the packaging.
2. **Initial Charge:** Before first use, fully charge the blender. Connect the USB-C charging cable to the charging

port on the motor base and plug the other end into a compatible USB power adapter (not included). The indicator light will show charging status.

3. **Clean Components:** Wash the blender cup and lid with warm, soapy water. Rinse thoroughly and dry. Wipe the motor base with a damp cloth. Do not immerse the motor base in water.
4. **Assemble:** Ensure the blade assembly is securely attached to the motor base. Place the blender cup onto the motor base and twist clockwise until it locks into place.

Convenient Charging

Type C socket Anytime, anywhere

Universal Type C port, charging at your will

Convenient
Charging Anywhere



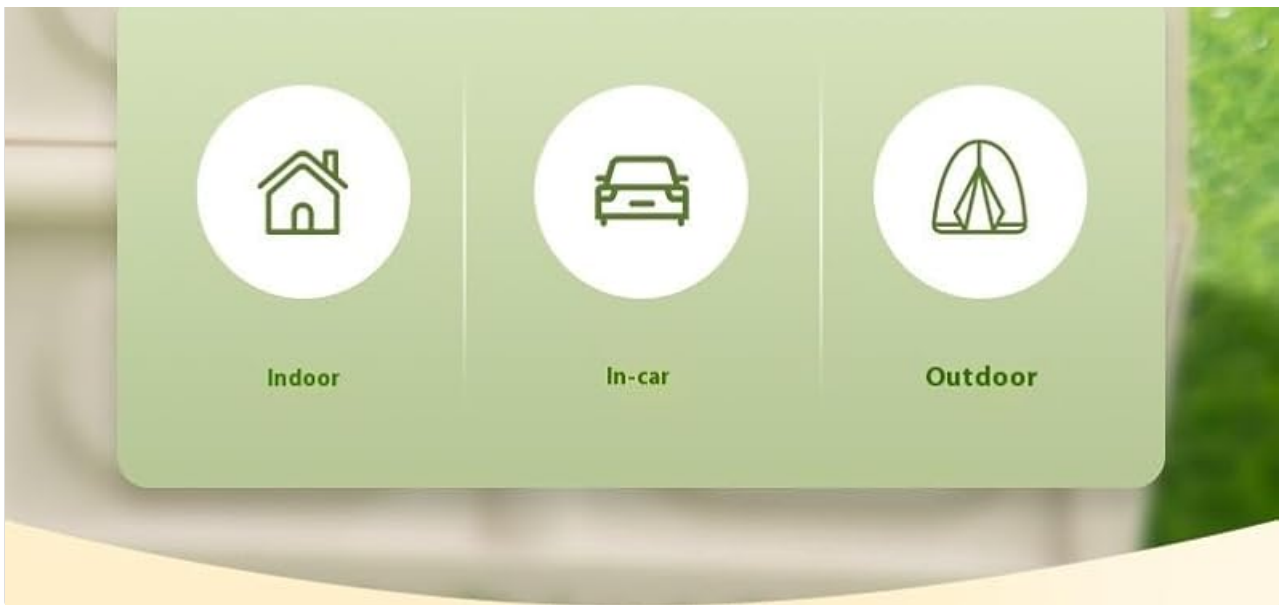

Image: The blender connected to a USB-C charging cable, demonstrating its versatile charging options for indoor, in-car, and outdoor use.

5. OPERATING INSTRUCTIONS

1. **Prepare Ingredients:** Cut fruits and vegetables into small pieces (approximately 1 inch or 2.5 cm) to ensure optimal blending.
2. **Add Ingredients:** Place your ingredients into the blender cup. For best results, add liquids first, then soft ingredients, and finally harder ingredients or ice. Do not exceed the 500mL maximum fill line.
3. **Secure Lid:** Place the lid onto the blender cup and twist clockwise until it is securely sealed.
4. **Start Blending:** Press the power button on the motor base to start blending. The blender will operate automatically.
5. **Monitor Blending:** For thicker mixtures, you may gently shake the blender during operation to ensure all ingredients come into contact with the blades.
6. **Stop Blending:** The blender will stop automatically after a blending cycle, or you can press the power button again to stop it manually.
7. **Enjoy:** Once blending is complete, open the lid and pour your beverage, or use the optional straw lid for direct consumption.



Image: The OSTMARS blender filled with a yellow liquid, likely juice, clearly displaying the 250mL and 500mL measurement lines on the side of the cup.

Precision Steel Blade

Ten-leaf stainless steel knife

Equipped with powerful motor

Fast spiral whipping, easy to beat a delicate taste
Ice cubes can also become smoothies

Ten Leaf Precision Steel Blade



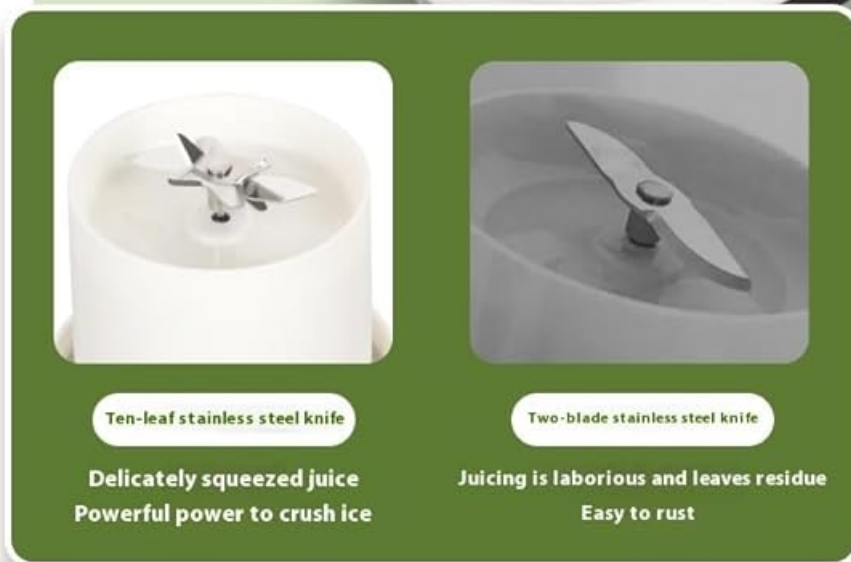

Image: A detailed view of the blender's stainless steel blade system actively blending ingredients, illustrating its powerful motor and "Ten-leaf Precision Steel Blade" design for efficient juice extraction. A comparison graphic shows the ten-leaf blade versus a two-blade design.

6. CLEANING AND MAINTENANCE

Proper cleaning and maintenance will ensure the longevity of your blender.

1. **Immediate Cleaning:** Clean the blender immediately after each use to prevent food residue from drying and sticking.
2. **Disassemble:** Separate the blender cup from the motor base. Remove the lid.
3. **Wash Cup and Lid:** Wash the blender cup and lid with warm, soapy water. A bottle brush may be helpful for thorough cleaning. Rinse thoroughly.

4. **Clean Motor Base:** Wipe the exterior of the motor base with a damp cloth. Do not immerse the motor base in water or place it in a dishwasher. Ensure the charging port is dry before charging.
5. **Blade Cleaning:** Exercise caution when cleaning the blade assembly as the blades are sharp. You can also add a small amount of water and a drop of dish soap to the cup, reattach the motor base, and run a short blending cycle for quick cleaning. Rinse thoroughly afterward.
6. **Drying and Storage:** Allow all parts to air dry completely before reassembling or storing. Store the blender in a clean, dry place.

7. TROUBLESHOOTING

Problem	Possible Cause	Solution
Blender does not start.	Battery is low or depleted. Cup not securely attached to the motor base. Overload protection activated.	Charge the blender fully. Ensure the cup is twisted clockwise until it locks into place. Remove some ingredients, add more liquid, and try again.
Ingredients are not blending smoothly.	Too little liquid. Ingredients are too large. Overfilling the cup.	Add more liquid. Cut ingredients into smaller pieces. Do not exceed the 500mL fill line.
Blender stops during operation.	Overload protection activated. Battery is low.	Reduce ingredients, add liquid, or cut into smaller pieces. Charge the blender.

8. SPECIFICATIONS

Brand	OSTMARS (Generic)
Model Number	DIS0124
Capacity	500mL (Blending) / 12 ounces
Product Dimensions	3.5"D x 3.5"W x 8.5"H
Color	Mint Green and Yellow
Power Source	Battery Powered
Voltage	5 Volts
Rated Input Current	1A
Battery Capacity	7.4V

Number of Speeds	1
Controls Type	Single Button
Blade Material	Stainless Steel
Material Type Free	BPA Free
Item Weight	1.2 pounds
Manufacturer	Ostmars



Product name

OSTMARS juice cup

Product color

Off-white/light green

Product number

GZ2023

Rated power

80W



Image: An infographic detailing product specifications. Note that the product number is listed as GZ2023 in the image, while the model number is DIS0124 in the product data. The image also states 80W rated power, which is not in the text specifications.

9. WARRANTY AND SUPPORT

Your OSTMARS Portable Electric Juicer Blender comes with a **Limited Manufacturer Warranty**. For specific details regarding warranty coverage, duration, and terms, please refer to the warranty card included with your product or contact the manufacturer directly.

For technical support, troubleshooting assistance, or to inquire about replacement parts, please contact Ostmars customer service. Contact information can typically be found on the product packaging or the manufacturer's official website.