

VSDINSIDE VSD M18

VSDINSIDE Macro Keypad Instruction Manual

Model: VSD M18

INTRODUCTION

The VSDINSIDE Macro Keypad is a versatile stream controller deck designed to enhance your workflow for gaming, streaming, content creation, and general productivity. Featuring 18 programmable keys, including 15 visual LCD keys and 3 button keys, it allows for one-touch operation of complex commands, application launches, and media control. This manual provides comprehensive instructions for setting up, operating, and maintaining your device.

KEY FEATURES

- **18 Programmable Keys:** 15 visual LCD keys and 3 button keys for customizable macros and shortcuts.
- **Personalized Icons:** Customize each LCD key with images and animations (JPG, PNG, GIF) for easy recognition.
- **One-Touch Operation:** Execute complex actions, launch applications, open files, control media, and switch scenes with a single press.
- **Multi-Hotkey Macro Pad:** Streamline game combos, video editing, music production, and photography workflows.
- **"Operation Follow" Feature:** Execute multiple macro operations simultaneously or in sequence.
- **Surrounding RGB Light Ring:** Adds visual ambiance to your setup (automatic color cycling, custom colors via future update).
- **Versatile Compatibility:** Compatible with Windows and macOS.
- **Software Integration:** Seamlessly integrates with popular software like OBS, Streamlabs, YouTube, Twitter, Discord, Excel, Word, and Photoshop.
- **Premium Quality:** Built with high-grade materials for durability.
- **Versatile Plugins:** Includes schedule reminders, clock, stopwatch, weather, calendar, and more.

SETUP GUIDE

Package Contents

Before you begin, ensure all components are present:

- VSDINSIDE Macro Keypad (ST Black)
- USB-C Cable
- Adjustable Stand
- User Manual (this document)

Connecting the Device

1. **Attach the Stand:** Securely attach the adjustable stand to the back of the VSDINSIDE Macro Keypad. This allows you to customize the angle for comfortable desktop use.



PLUG-AND-PLAY

Simply connect via USB-C and start using in seconds.



Non-Slip Rubber Base

Ensures stable placement on any desk or surface.



RGB Light Strip

Smart RGB Dynamic Color Shifting - 360° Surround Lighting for Elevated Ambience.



Adjustable Ergonomic Stand

Customize the angle for comfortable desktop use.

Image: The VSDINSIDE Macro Keypad showing its adjustable stand and USB-C port for connection. The device features a non-slip rubber base for stable placement.

2. **Connect via USB-C:** Plug one end of the provided USB-C cable into the port on the back of the Macro Keypad.
3. **Connect to Computer:** Plug the other end of the USB-C cable into an available USB port on your Windows or macOS computer. The device is plug-and-play and should be recognized by your system within seconds.

Software Installation

To fully utilize the VSDINSIDE Macro Keypad's features, you need to install the companion software. Please visit the official VSDINSIDE website to download the latest version of the software for your operating system (Windows or macOS). Follow the on-screen instructions for installation.

EASY TO USE VSDINSIDE STREAMDOCK

Select an action, drag - drop to the key for setup. Customize function, title, and icon in the properties panel.

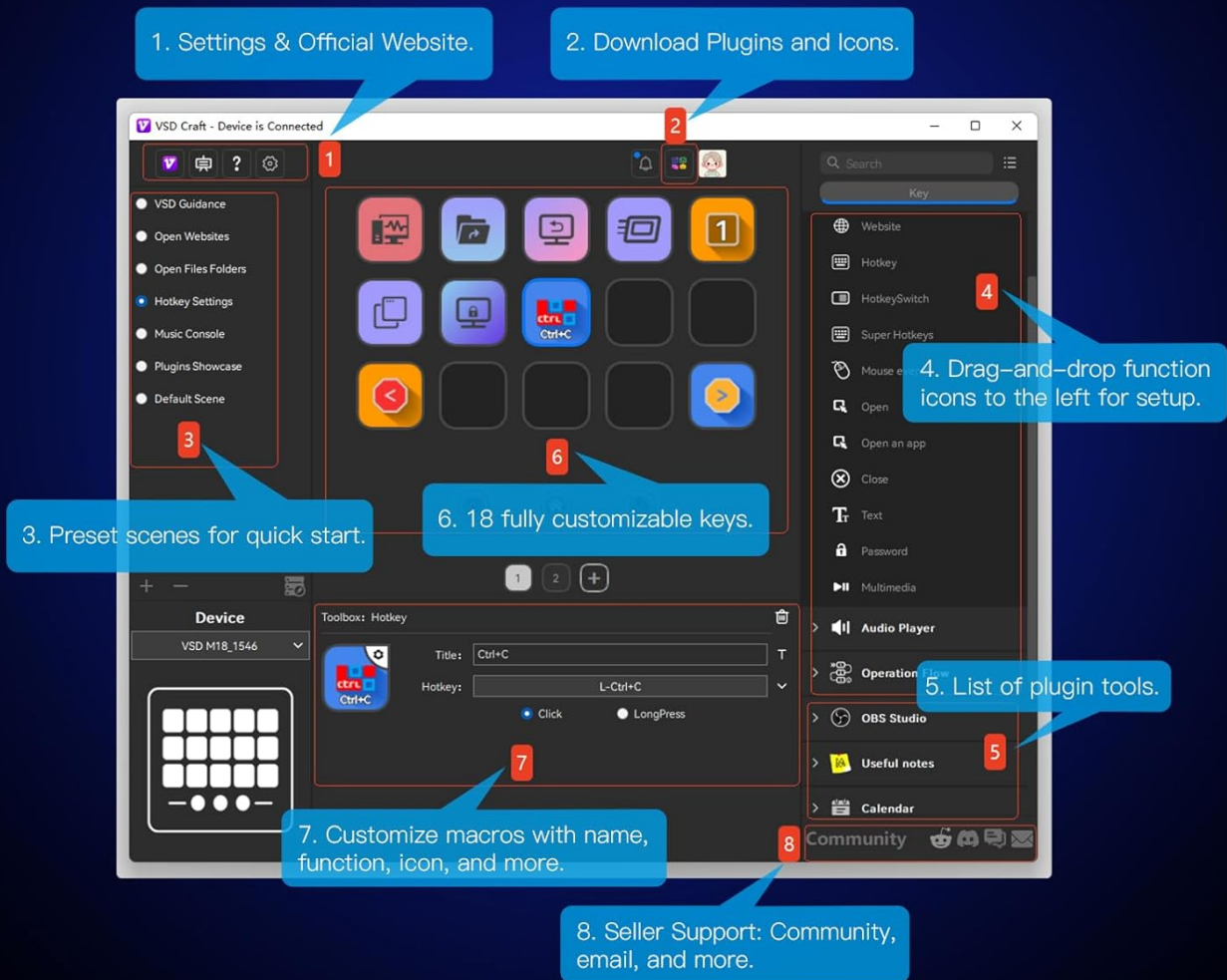

Image: A screenshot of the VSD Craft software interface, demonstrating how to drag and drop actions onto the 18 customizable keys and configure settings.

OPERATING INSTRUCTIONS

Customizing Keys

The VSDINSIDE Macro Keypad offers extensive customization options through its dedicated software. Each of the 18 keys can be programmed to perform a variety of functions:

- **Single Key Press:** Assign a single keyboard shortcut (e.g., Ctrl+C, Alt+Tab).
- **Macro Sequences:** Program a series of actions to be executed in sequence with a single press. This is ideal for complex game combos or multi-step editing tasks.
- **Application Launch:** Open frequently used applications, files, or websites.
- **Media Control:** Play, pause, skip tracks, or adjust volume.

- **OBS/Streamlabs Integration:** Switch scenes, mute/unmute audio sources, start/stop streaming or recording.
- **System Functions:** Lock computer, open task manager, etc.

To customize a key:

1. Open the VSDINSIDE companion software.
2. Select the desired key on the virtual keypad interface.
3. In the properties panel, choose the action type (e.g., Hotkey, Open App, Multimedia).
4. Configure the specific action and assign a title.
5. (Optional) Personalize the LCD key's visual display by uploading a JPG, PNG, or GIF image.
6. Save your changes.

FULLY PROGRAMMABLE MACRO KEYS

One-Touch Automation: Press a single button to trigger one or multiple shortcut commands in an instant.



Image: A close-up of the VSDINSIDE Macro Keypad's LCD keys, illustrating how a single button press can trigger a sequence of commands like Ctrl + Shift + N, followed by a 50ms delay, then Enter.

Using Profiles and Scenes

The software allows you to create multiple profiles or "scenes" for different applications or workflows. For example, you can have one profile for gaming, another for video editing, and a third for general office tasks. This enables you

to quickly switch between sets of customized commands.



Image: The VSDINSIDE Macro Keypad showcasing different workflow configurations, including consoles for Windows/macOS, music production, GIF desktop animation, productivity tools, OBS live streaming, and a numeric keyboard mode.

RGB Lighting

The device features a surrounding RGB light ring that provides dynamic color cycling. Future software updates may include options for custom color settings.

MEDIA DEMONSTRATIONS

Product Overview Video

Your browser does not support the video tag.

Video: An official overview of the VSDINSIDE Macro Keypad, demonstrating its features, customization options, and various applications in gaming, streaming, and productivity. This video highlights the ease of use and versatility of the device.

MAINTENANCE

To ensure the longevity and optimal performance of your VSDINSIDE Macro Keypad, follow these maintenance guidelines:

- **Cleaning:** Use a soft, dry, lint-free cloth to clean the device. For stubborn smudges, slightly dampen the cloth with water. Avoid using harsh chemicals, abrasive cleaners, or solvents.
- **Storage:** When not in use for extended periods, store the keypad in a cool, dry place away from direct sunlight and extreme temperatures.
- **Handling:** Avoid dropping the device or exposing it to excessive force, which could damage the internal components or LCD screens.
- **Software Updates:** Regularly check the official VSDINSIDE website for software and firmware updates to ensure you have the latest features and bug fixes.

TROUBLESHOOTING

Common Issues and Solutions

Issue	Possible Cause	Solution
Device not recognized by computer.	Loose USB connection, faulty cable, driver issue.	Ensure USB-C cable is securely connected. Try a different USB port or cable. Restart your computer. Reinstall the VSDINSIDE software.
Keys not responding or incorrect actions.	Software not running, incorrect key configuration, software glitch.	Ensure the VSDINSIDE software is running in the background. Verify key configurations in the software. Restart the software. Update software to the latest version.
LCD screens are blank or flickering.	Power issue, software issue, corrupted image/GIF.	Check USB connection. Restart the software. Try re-uploading the image/GIF for the affected key. Ensure your computer's USB port provides sufficient power.
RGB lighting not working.	Software setting, power issue.	Ensure the device is properly powered. Check for any lighting settings within the VSDINSIDE software (if available in your version).
Software is slow or crashes.	System resources, software bug, outdated version.	Close other demanding applications. Update the software to the latest version. Reinstall the software if the issue persists.
Device not compatible with Linux.	Linux is not officially supported.	The VSDINSIDE Macro Keypad is designed for Windows and macOS. Linux support is not guaranteed.
Software must remain open for keypad to work.	Intended design.	This is a known operational requirement. Ensure the software is running in the background for the keypad to function.

SPECIFICATIONS

Model Number: VSD M18

Dimensions: 4.6 x 4.1 x 0.8 inches

Weight: 10.6 ounces

Connectivity: USB-C

Number of Keys: 18 (15 LCD, 3 Button)

Compatibility: Windows, macOS

Manufacturer: Shenzhen An Rui Xin Technology Co.,Ltd.

Release Date: April 18, 2025

WARRANTY AND SUPPORT

VSDINSIDE provides customer support and free software updates for the Macro Keypad. For warranty information, technical assistance, or to report issues, please refer to the contact information provided on the official VSDINSIDE website or your purchase documentation. Keep your proof of purchase for warranty claims.