

[Manuals.plus](#) /

> [Roinvou](#) /

> Roinvou Android Car Stereo User Manual for Peugeot 508 (2011-2018)

## Roinvou Roinvou Android Car Stereo for Peugeot 508 (2011-2018)

# Roinvou Android Car Stereo User Manual for Peugeot 508 (2011-2018)

Model: Roinvou Android Car Stereo for Peugeot 508 (2011-2018)

## 1. INTRODUCTION

---

This manual provides detailed instructions for the installation, operation, and maintenance of your Roinvou Android Car Stereo. Please read this manual thoroughly before using the product to ensure proper functionality and safety. This unit is specifically designed for Peugeot 508 models manufactured between 2011 and 2018.

## 2. PRODUCT OVERVIEW

---

### 2.1 Package Contents

The Roinvou Android Car Stereo package includes the following components:

- Roinvou 9-inch Android Head Unit
- Power Cable
- Radio Antenna
- CANBUS Decoder
- Original USB Cable
- RCA Cable Set
- Rear Camera Input Cable
- GPS Antenna
- Dual USB Cable
- AHD Rear Camera
- External Microphone
- Installation Accessories & Tool Kit

### 2.2 Key Features

- **Operating System:** Android (updated system)

- **Memory & Storage:** 2GB RAM + 64GB Internal Storage
- **Display:** 9-inch Full HD 1080P Capacitive Touchscreen
- **Connectivity:** Wireless/Wired CarPlay, Wireless/Wired Android Auto, Mirror Link (iOS/Android), Wi-Fi, Bluetooth, USB, RCA
- **Navigation:** Integrated GPS with support for online and offline maps
- **Audio:** FM/RDS Radio, Customizable EQ (Classic, Pop, Rock, Jazz), APE/FLAC/WAV/MP3/WMA audio formats
- **Video:** MKV/RMVB/AVI/MP4/MDV video formats
- **Vehicle Integration:** Steering Wheel Control (SWC) support, CANBUS integration
- **Safety Features:** AHD Waterproof Rear Camera with Ultra-Wide Angle and HD Night Vision
- **User Interface:** 26 selectable UI themes, Split-screen functionality



Figure 2.1: Roinvou Android Car Stereo head unit, AHD rear camera, external microphone, and icons representing CarPlay/Android Auto functionality.

### 3. SETUP AND INSTALLATION

Professional installation is recommended for this product. Ensure the vehicle's power is disconnected before beginning installation.

#### 3.1 Compatibility

This unit is compatible with Peugeot 508 models from 2011 to 2018. Verify your vehicle's model year before installation.

### 3.2 Installation Steps (General Guide)

1. **Remove Original Unit:** Carefully remove the existing car stereo and trim panels from your Peugeot 508 dashboard.
2. **Connect Wiring Harness:** Connect the provided power cable, CANBUS decoder, radio antenna, and other necessary cables to the vehicle's wiring harness. Ensure all connections are secure.
3. **Install GPS Antenna:** Mount the GPS antenna in a location with a clear view of the sky, typically on the dashboard or under the windshield.
4. **Install Rear Camera:** Route the rear camera cable from the back of the vehicle to the head unit. Mount the AHD rear camera securely at the rear of the vehicle, ensuring a clear view. Connect the camera input cable to the head unit.
5. **Connect External Microphone:** Plug in the external microphone and position it for optimal voice pickup, such as near the sun visor.
6. **Test Connections:** Before fully reassembling the dashboard, temporarily connect the head unit and power on the vehicle to test basic functions (power, audio, touch screen, camera display).
7. **Secure Head Unit:** Once tested, secure the Roinvou Android Car Stereo into the dashboard opening.
8. **Reassemble Trim:** Reinstall all removed trim panels.

## For Peugeot 508 2011–2018



Before Installation



After Installation

Figure 3.1: Comparison of a Peugeot 508 dashboard before and after the installation of the Roinvou Android Car Stereo.

## 4. OPERATING INSTRUCTIONS

---

### 4.1 Basic Operation

- **Power On/Off:** The unit powers on automatically with the vehicle ignition. Press and hold the power button (if available) or use the vehicle's ignition to turn off.
- **Touchscreen:** Navigate the interface using the responsive 9-inch touchscreen.
- **Volume Control:** Adjust volume using the on-screen controls or steering wheel controls.
- **Home Screen:** Access various applications and settings from the customizable home screen. The unit supports 26 different UI themes.
- **Split Screen:** To use two applications simultaneously, activate the split-screen function from the recent apps menu.

### 4.2 CarPlay and Android Auto

The unit supports both wireless and wired connections for Apple CarPlay and Android Auto.

1. **Wireless Connection:** Enable Bluetooth and Wi-Fi on your smartphone. On the car stereo, open the CarPlay/Android Auto application and follow the on-screen prompts to pair your device.
2. **Wired Connection:** Connect your smartphone to the car stereo using a USB cable. The system should automatically detect and launch CarPlay or Android Auto.

Once connected, you can access navigation, make calls, send messages, and play music directly from your phone's interface displayed on the car stereo screen.

### 4.3 Mirror Link

Mirror Link allows you to display your smartphone's screen on the car stereo.

- **Android Devices:** Connect via USB or Wi-Fi. Supports two-way control (from phone to unit and unit to phone).
- **iOS Devices:** Connect via Wi-Fi. Supports one-way projection (from phone to unit).

# Carplay & Android Auto & Mirror Link



Figure 4.1: Visual representation of CarPlay, Android Auto, and Mirror Link connectivity options.

## 4.4 GPS Navigation and Wi-Fi

The unit features an integrated GPS module for navigation.

- **Online Navigation:** Connect to Wi-Fi to use online mapping services (e.g., Google Maps) for real-time traffic updates and map synchronization.
- **Offline Navigation:** Download maps for offline use directly from the Play Store.
- **Wi-Fi Connectivity:** Use Wi-Fi to download applications, update maps, and stream online content.

# GPS Navigation & WiFi Connection

You can purchase directly from play store for offline navigation. With wifi connected, Google Maps can be used perfectly, you can go anywhere you want and never get lost again.



Figure 4.2: GPS navigation interface and Wi-Fi connectivity for map updates and app downloads.

## 4.5 Bluetooth Functionality

Connect your smartphone via Bluetooth for hands-free calling and audio streaming.

- **Hands-Free Calling:** Pair your phone to make and receive calls directly through the car stereo. The external microphone ensures clear audio.
- **Music Streaming:** Play audio from your phone wirelessly. Track information (title, artist) will display on the screen.
- **Phone Book:** The unit supports automatic loading of your phone's contact list.

## 4.6 FM/RDS Radio

Access local and regional radio stations with the integrated FM/RDS tuner.

- **FM Tuning:** Scan and save your favorite FM radio stations.
- **RDS (Radio Data System):** Displays station information, song titles, and traffic announcements where available.

# Hands-free Bluetooth & FM/RDS Radio

Support Bluetooth hands-free calling, Bluetooth music playback and auto-loading phone book. Stable FM/RDS radio provides channel broadcasting, weather forecasts, and real-time traffic conditions.



Figure 4.3: Bluetooth call interface and FM radio display with RDS information.

## 4.7 Steering Wheel Control (SWC)

The unit supports integration with your vehicle's existing steering wheel controls for safer operation.

- **Configuration:** Access the settings menu to configure and map your steering wheel buttons to various functions (e.g., volume, track skip, mode change).

## 4.8 Rear View Camera

The included AHD rear camera provides a clear view when reversing.

- **Automatic Display:** The rear camera view automatically displays on the screen when the vehicle is shifted into reverse gear.
- **Features:** The camera offers an ultra-wide viewing angle and HD night vision for improved visibility in low-light conditions. It is waterproof for durability.

# Steering Wheel Control & AHD Rear View Camera

Upgrade your driving with steering wheel control and AHD reversing screen display with precision and safety in your hands.

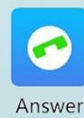
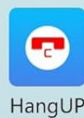
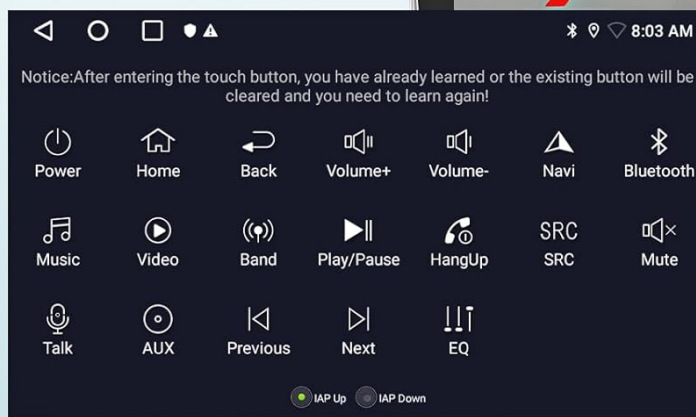
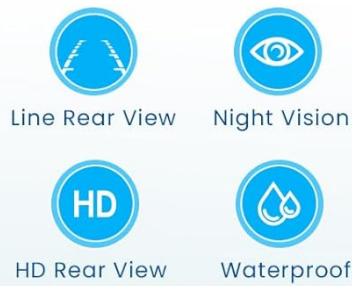

Figure 4.4: Steering wheel control button mapping and a simulated view from the AHD rear camera with parking assist lines.

## 4.9 Equalizer (EQ) Settings

Customize your audio experience with the built-in equalizer.

- **Presets:** Choose from various sound presets such as Classic, Pop, Rock, and Jazz.
- **Custom Adjustment:** Manually adjust frequency bands to create your preferred sound profile.

# 26UI Themes & EQ Settings

Support multiple EQ options and 26 desktop themes, allows you to enjoy a superior music listening experience and switch your favorite user interface style.



Figure 4.5: Examples of different user interface themes and the graphical equalizer settings.

## 5. MAINTENANCE

Regular maintenance ensures the longevity and optimal performance of your Roinvou Android Car Stereo.

- **Screen Cleaning:** Use a soft, lint-free cloth to gently wipe the touchscreen. For stubborn smudges, slightly dampen the cloth with water or a screen-safe cleaner. Avoid harsh chemicals or abrasive materials.
- **Software Updates:** Periodically check for software updates via Wi-Fi to ensure you have the latest features and security patches.
- **Cable Connections:** Ensure all cables remain securely connected. Loose connections can lead to intermittent issues.
- **Environmental Conditions:** Avoid exposing the unit to extreme temperatures, direct sunlight for prolonged periods, or excessive moisture.

## 6. TROUBLESHOOTING

If you encounter issues with your car stereo, refer to the following troubleshooting guide:

Problem	Possible Cause	Solution
Unit does not power on	Loose power connection, blown fuse, vehicle ignition issue	Check power cable connections. Inspect vehicle fuses. Ensure vehicle ignition is on.
No sound	Volume too low, mute activated, speaker wiring issue, incorrect audio source	Increase volume. Check if unit is muted. Verify speaker connections. Select correct audio source.
Touchscreen unresponsive	Software glitch, screen damage	Restart the unit (turn vehicle off and on). If issue persists, contact support.
GPS not acquiring signal	GPS antenna obstruction, faulty antenna, software issue	Ensure GPS antenna has a clear view of the sky. Check antenna connection. Restart unit.
Bluetooth connection issues	Phone not discoverable, incorrect pairing, interference	Ensure phone's Bluetooth is on and discoverable. Delete previous pairings and re-pair. Move phone closer to unit.
Rear camera not displaying	Loose camera cable, faulty camera, reverse trigger not connected	Check camera cable connections. Ensure reverse gear is engaged. Verify reverse trigger wire connection.

If the problem persists after attempting these solutions, please contact Roinvou customer support.

## 7. SPECIFICATIONS

Feature	Detail
Brand	Roinvou
Model Number	b5813662-e529-469d-a52b-59e01e44ca1b
Compatible Vehicles	Peugeot 508 (2011-2018)
Operating System	Android
RAM	2GB
Internal Storage	64GB
Screen Size	9 inches
Display Type	Full HD 1080P Capacitive Touchscreen
Connectivity	USB, RCA, Bluetooth, Wi-Fi, FM RDS
Special Features	CarPlay, Android Auto, Mirror Link, EQ, GPS, SWC, 26 UI Themes, Rear Camera Support
Audio Output Modes	APE/FLAC/WAV/MP3/WMA
Video Encoding	MKV/RMVB/AVI/MP4/MDV

Feature	Detail
Surround Sound Channels	4
HDMI Ports	1
Manufacturer	Roinvou
Country of Origin	China

## 8. WARRANTY AND SUPPORT

---

### 8.1 Manufacturer's Warranty

The Roinvou Android Car Stereo comes with a **24-month manufacturer's warranty** from the date of purchase. This warranty covers defects in materials and workmanship under normal use.

### 8.2 Customer Support

For any inquiries, technical assistance, or warranty claims, Roinvou provides **lifetime online support**. Our support team aims to respond to all inquiries within 24 hours.

Please refer to your purchase documentation or the Roinvou official website for specific contact details.