

[Manuals.plus](#) /

› [Lemorele](#) /

› Lemorele Wireless HDMI Transmitter and 3 Receivers User Manual

Lemorele HDMI TX+3 RX

Lemorele Wireless HDMI Transmitter and 3 Receivers User Manual

Model: HDMI TX+3 RX

INTRODUCTION

The Lemorele Wireless HDMI Transmitter and Receiver kit provides a seamless solution for wireless video and audio transmission. Designed for ease of use with its plug-and-play functionality, this system supports 1080P HD resolution at 60Hz and offers an impressive transmission range of up to 656 feet (200 meters) with ultra-low latency of 50ms. It is ideal for various applications including presentations, home theater setups, live broadcasting, and real-time monitoring, allowing you to stream content from devices like PCs, cameras, TV boxes, and Blu-ray players to monitors, projectors, or HD TVs without the need for cumbersome cables.



Image: The Lemorele Wireless HDMI Transmitter (TX) and three Receiver (RX) units, showcasing their compact design and antennas.

COMPONENTS

The package includes the following components:

- **HDMI TX (Transmitter) Unit:** Connects to your source device (e.g., laptop, camera).
- **HDMI RX (Receiver) Units (x3):** Connects to your display devices (e.g., TV, projector, monitor).
- **USB Power Cables:** For providing stable 5V2A power to the units.
- **HDMI Extender Cable:** A flexible cable for connecting the units in tight spaces or for better antenna positioning.

1 TX Supports up to 4 RXs

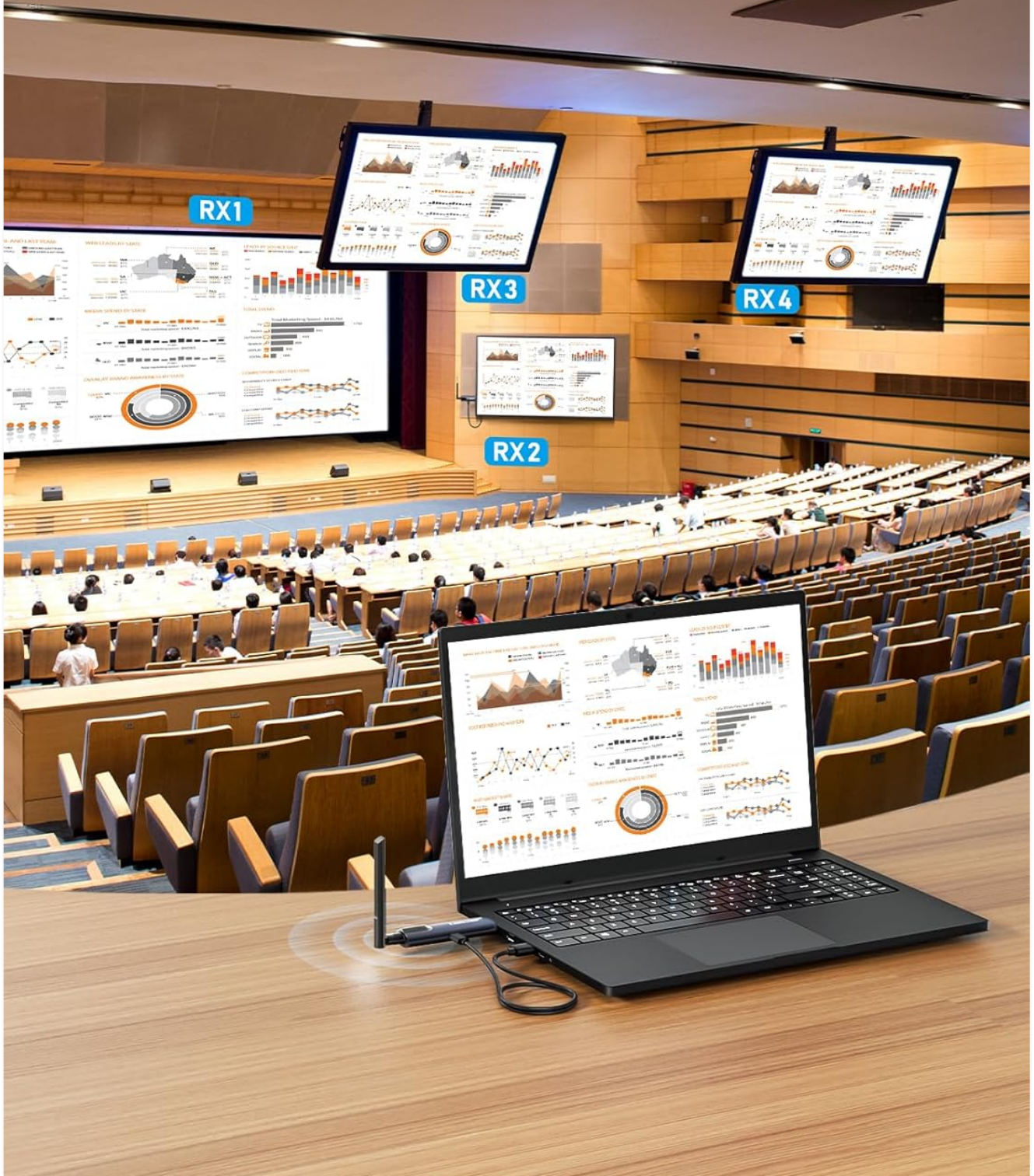

Image: An illustration showing one transmitter (TX) unit connected to a laptop, wirelessly transmitting to multiple receiver (RX) units connected to various displays in a large room, demonstrating multi-device support.

SETUP INSTRUCTIONS

The Lemoirele Wireless HDMI system is designed for plug-and-play operation. Follow these steps for initial setup:

1. **Power Supply:** Ensure a stable 5V2A power supply is connected to both the Transmitter (TX) and Receiver

(RX) units using the provided USB cables. Insufficient power can lead to connection issues or screen stuttering.

2. **Connect Receiver (RX):** Plug each Receiver (RX) unit into the HDMI input port of your display device (TV, projector, or monitor).
3. **Connect Transmitter (TX):** Plug the Transmitter (TX) unit into the HDMI output port of your source device (PC, camera, TV-Box, Blu-ray player, etc.).
4. **Automatic Pairing:** The units are designed to pair automatically. After connecting both TX and RX units and ensuring they are powered, wait approximately 5-10 seconds for the HD projection to begin.
5. **Optional HDMI Extender:** If space is limited or to optimize antenna positioning, use the flexible HDMI extender cable between the unit and the HDMI port.

Your browser does not support the video tag.

Video: An official product video demonstrating the setup and functionality of the Lemorele Wireless HDMI Transmitter and Receivers, highlighting its ease of use and various applications.

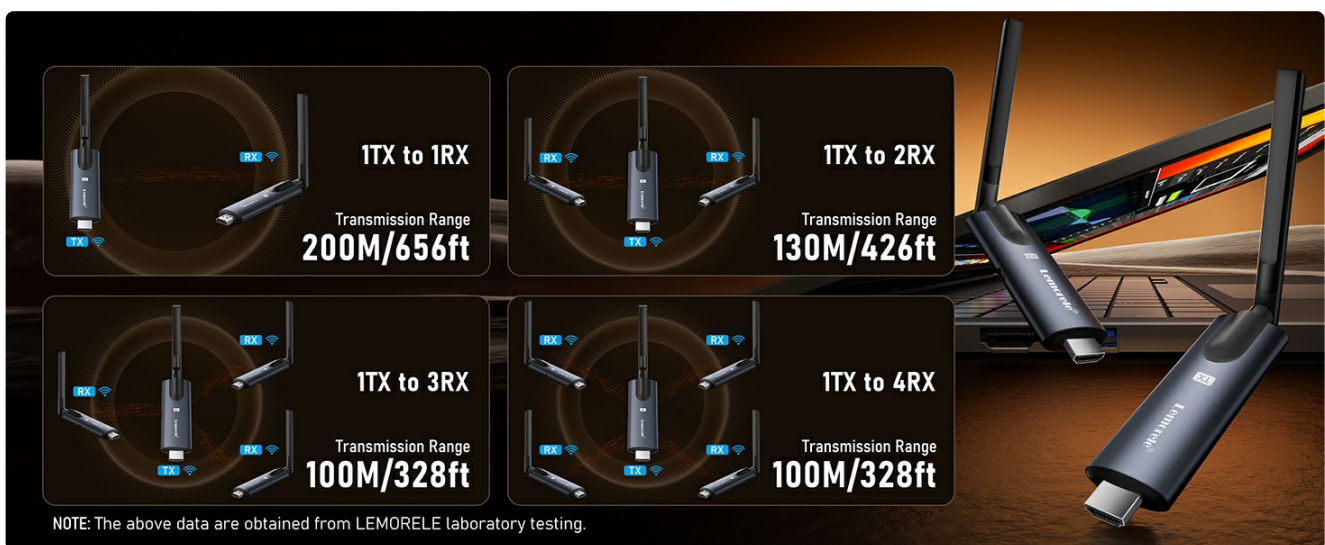

Image: A visual guide illustrating the steps to re-pair the transmitter and receiver units, involving pressing function buttons for 5 seconds until the indicator light remains steady.

OPERATING INSTRUCTIONS

Once the units are set up and paired, the system will automatically transmit video and audio. Here are additional operational details:

- **High-Definition Transmission:** The system utilizes advanced H.264 codec technology to deliver 1080P 60Hz high-refresh-rate video, ensuring clear, smooth, and detailed picture quality.
- **Multi-Device Support:** A single transmitter can support up to four receivers simultaneously, allowing for multiple displays in different locations.
- **APP Expansion (TuTuPlay):** For enhanced monitoring, download the TuTuPlay APP on your Android or iOS mobile phone or tablet. With the app, you can receive the transmitted picture directly on your mobile device.
 - a. Download and install the TuTuPlay APP from your device's app store.
 - b. Open the software and follow prompts to connect. Search for the Wi-Fi network "TuTuPlay****" and connect. The default password is "tc568878".
- **Transmission Range:** The system offers a wireless transmission distance of up to 656 feet (200 meters) in open environments. The range may vary depending on the number of receivers and environmental factors (e.g., walls, large furniture) between the units.

Wireless Screen Casting

1 transmitter and up to 4 receivers, supporting Full HD video



Image: A visual representation of wireless screen casting, showing a laptop connected to a transmitter (TX) and two large screens receiving the signal via receivers (RX), supporting Full HD video.

Support APP Monitor

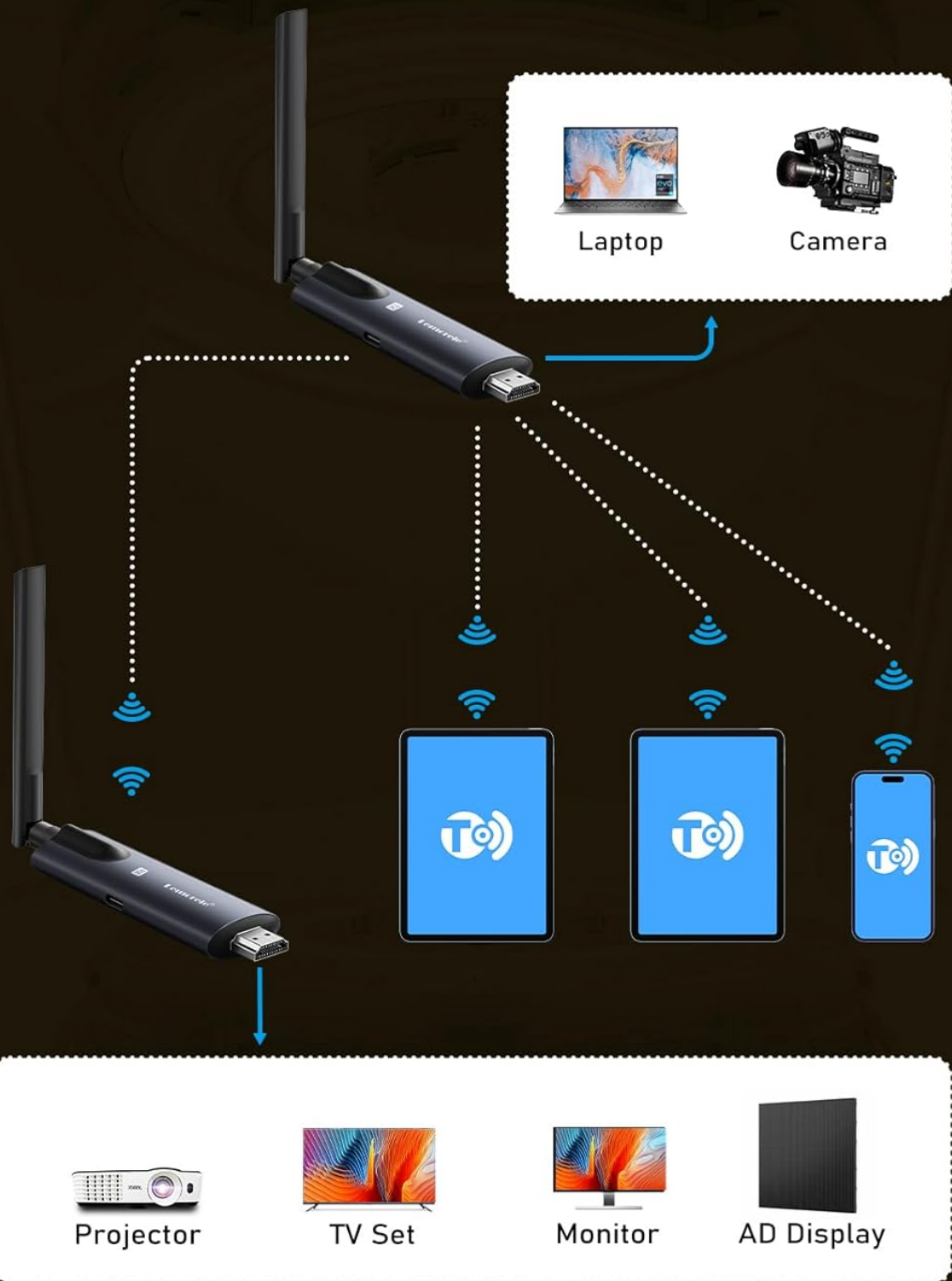

Image: A diagram illustrating how the Lemorele system supports APP monitoring, showing a laptop or camera transmitting to a receiver (RX) and then broadcasting to multiple mobile devices (phones, tablets) running the TuTuPlay app, as well as traditional displays like projectors and TVs.

MAINTENANCE

To ensure the longevity and optimal performance of your Lemorele Wireless HDMI system, please observe the

following maintenance guidelines:

- **Cleaning:** Use a soft, dry cloth to clean the exterior of the transmitter and receiver units. Avoid using liquid cleaners or abrasive materials.
- **Storage:** When not in use for extended periods, store the units in a cool, dry place away from direct sunlight and extreme temperatures.
- **Power Supply:** Always use the recommended 5V2A power supply to prevent damage and ensure stable operation. Do not use power adapters with lower voltage or current ratings.
- **Physical Protection:** The units are made of aluminum alloy for better heat dissipation, but avoid dropping or subjecting them to strong impacts.

TROUBLESHOOTING

If you encounter issues with your Lemorele Wireless HDMI system, try the following troubleshooting steps:

- **No Signal/Black Screen:**
 - Ensure both the Transmitter (TX) and all Receiver (RX) units are properly powered with a stable 5V2A supply.
 - Verify that the HDMI cables are securely connected to both the source and display devices.
 - Confirm that the input source on your display device is set to the correct HDMI input.
 - Try re-pairing the units by following the steps outlined in the "Setup Instructions" section (press function button for 5 seconds on both TX and RX).
- **Connection Lag/Screen Stutter/Disconnect:**
 - Check the power supply. Insufficient power is a common cause for these issues. Ensure you are using a 5V2A adapter.
 - Reduce the distance between the transmitter and receiver units.
 - Minimize obstacles (walls, large furniture) between the units.
 - Check for potential wireless interference from other devices operating on similar frequencies (e.g., Wi-Fi routers, microwaves).
- **Poor Picture Quality:**
 - Ensure your source device is outputting a 1080P 60Hz signal.
 - Verify that the units are within the optimal transmission range.
 - Check for any physical damage to the units or cables.
- **APP Connection Issues (TuTuPlay):**
 - Ensure your mobile device is connected to the "TuTuPlay*****" Wi-Fi network broadcast by the system.
 - Double-check the Wi-Fi password ("tc568878").
 - Restart the TuTuPlay app and the HDMI units.

SPECIFICATIONS

Feature	Specification
Brand	Lemorele
Model Number	HDMI TX+3 RX

Feature	Specification
Item Weight	11.4 ounces
Product Dimensions	10.8 x 3.3 x 1.3 inches
Country of Origin	China
Connectivity Technology	HDMI, Wireless (5G+2.4G)
Resolution	1080P @ 60Hz
Transmission Range	Up to 656ft (200m)
Latency	50ms (Ultra-low)
Power Supply	5V2A
Material	Aluminum Alloy
Supported Internet Services	Google TV (via connected device)

WARRANTY AND SUPPORT

For detailed warranty information and technical support, please visit the official Lemorele website or contact their customer service. You can find contact information on the product packaging or the official Lemorele store page on Amazon.

Official Website: us.lemorele.com

Email Support: support@lemorele.com