

HK-CW-007

## User Manual: Bluetooth Tracker for Android

Model: HK-CW-007

### 1. INTRODUCTION

This manual provides essential information for the setup, operation, and maintenance of your new Bluetooth Tracker. Designed to seamlessly integrate with Google Find My Device, this smart locator helps you keep track of your valuable items such as keys, wallets, luggage, and even pets.

The tracker is compact, lightweight, and compatible with most Android phones, including Samsung, Google, Xiaomi, Oppo, and Vivo, without requiring additional app downloads.



Image: The Bluetooth tracker in black, showcasing its compact, circular design with an integrated loop for easy attachment to various items.

#### Key Features:

- **Google Integration:** Works directly with Google Find My Device, no extra app needed.
- **Wide Compatibility:** Supports most Android phones (Samsung, Google, Xiaomi, Oppo, Vivo, etc.).
- **Long Battery Life:** Replaceable CR2032 battery lasts up to 1 year.
- **Versatile Tracking:** Ideal for keys, luggage, pets, and other valuables.
- **Smart Functions:** Includes worldwide tracking, sound reminder, and left-behind alerts.

# Works With Google Find My

Free yourself from the burden of find item

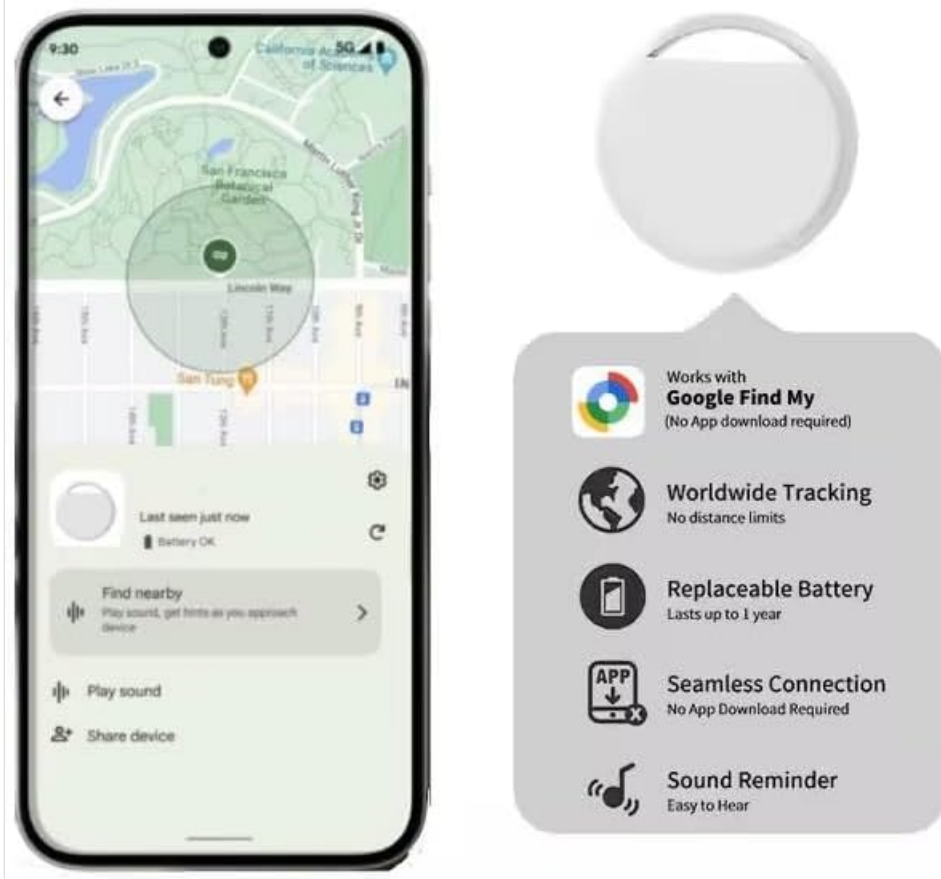

Image: An overview of the tracker's main features, including its compatibility with Google Find My Device, worldwide tracking capabilities, long-lasting replaceable battery, seamless connectivity, and sound reminder function.

## 2. SETUP

### 2.1. Battery Installation

The tracker uses one CR2032 coin cell battery. The battery is typically pre-installed. If you need to replace it:

1. Locate the small groove or opening on the side of the tracker.
2. Gently pry open the tracker casing using a thin tool (e.g., a small flat-head screwdriver or guitar pick).
3. Remove the old CR2032 battery.
4. Insert a new CR2032 battery with the positive (+) side facing up.
5. Carefully snap the two halves of the tracker casing back together until it clicks securely.

### 2.2. Pairing with Google Find My Device

Your Bluetooth tracker is designed for seamless integration with the Google Find My Device network. No separate app download is required.

1. Ensure your Android phone's Bluetooth is turned on.
2. Make sure your phone is connected to the internet (Wi-Fi or mobile data).
3. Activate the tracker by pressing its button (if it has one) or ensuring it's powered on. The tracker should enter pairing mode, indicated by a specific sound or light (refer to product packaging for specific indicator).
4. Open the Google Find My Device app on your Android phone. If you don't have it, it's usually pre-installed or can be

accessed via your Google account settings.

5. The app should automatically detect nearby compatible trackers. Follow the on-screen prompts to add your new tracker to your account.
6. Once paired, you can name your tracker (e.g., "Keys," "Wallet," "Pet Collar") for easy identification.



Image: Visual representation of the tracker's broad compatibility with major Android phone brands, emphasizing its seamless integration with the Google Find My Device network.



Works with  
**Google Android Find My  
Device Network**

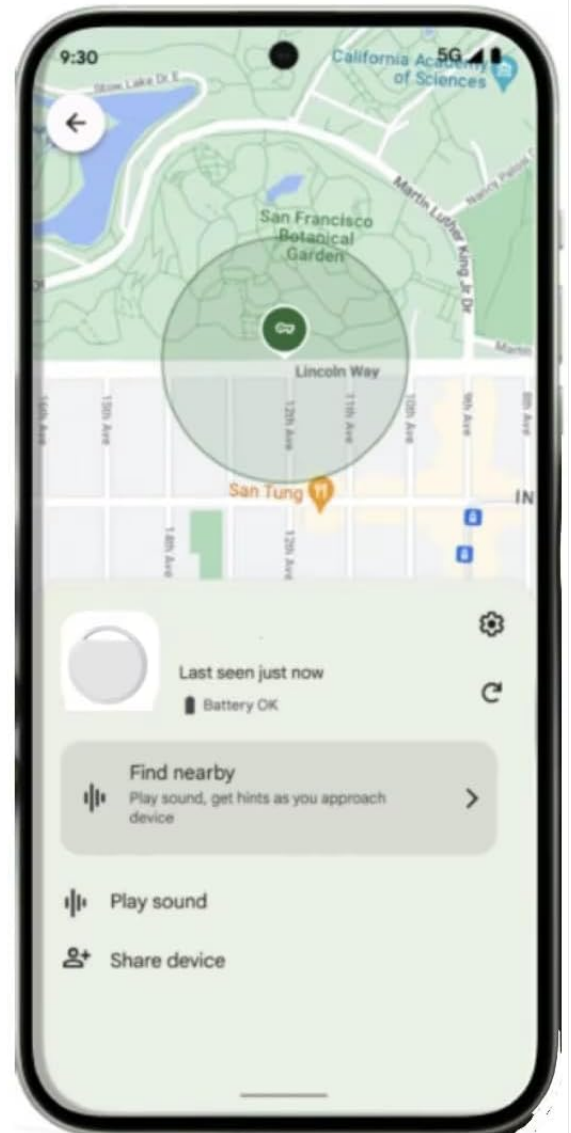

Image: The tracker in both black and white variants, alongside a smartphone screen demonstrating how the Google Find My Device app displays the tracker's location and offers options to locate it.

### 3. OPERATING THE TRACKER

#### 3.1. Locating Your Items

Once your tracker is paired, you can use your Android phone to find your items:

- **Map Location:** Open the Google Find My Device app. Your tracker's last known location will be displayed on a map. This is particularly useful for items left far away.
- **Play Sound:** If your item is nearby, select the "Play Sound" option in the app. The tracker will emit a loud ring, helping you pinpoint its exact location.
- **Find Nearby / Precision Finding:** Some Android devices and trackers support a "Find Nearby" or "Precision Finding" feature, which can guide you closer to the tracker using visual cues or signal strength indicators within the app.

# Voice Prompt

When near the tracker, click "play sound",  
the tracker will beep

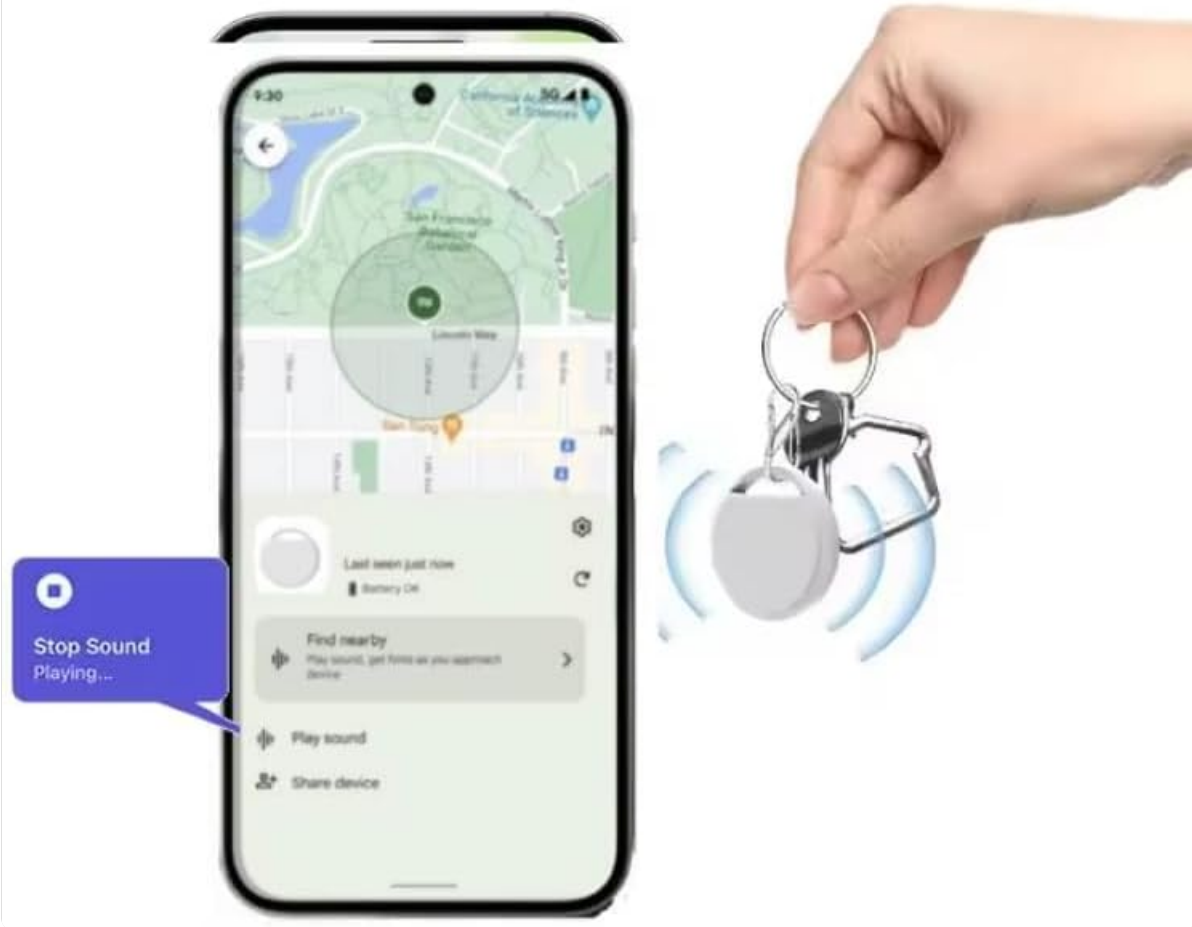
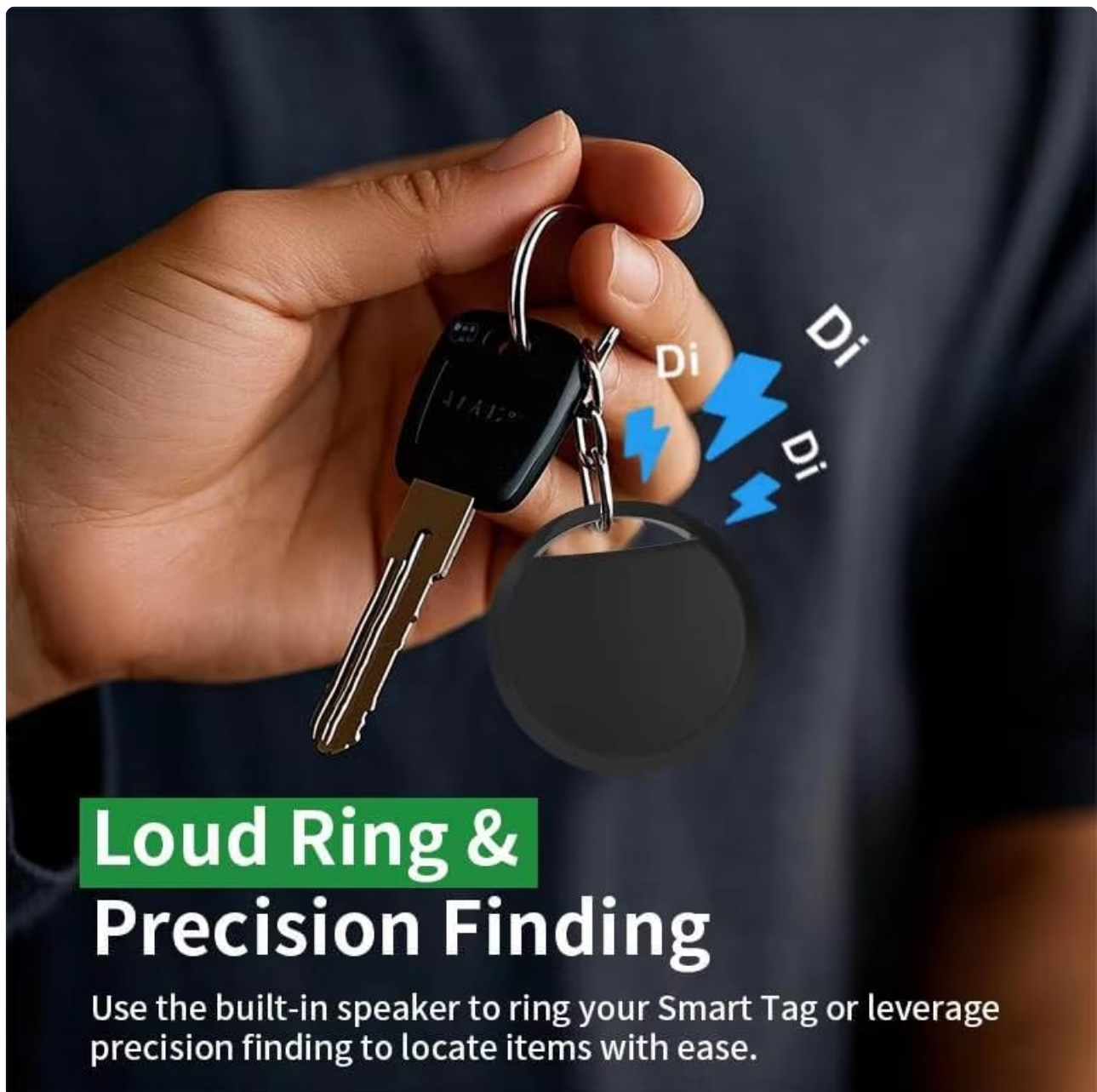

Image: Demonstrates the "Voice Prompt" feature, where clicking "play sound" on the phone app makes the tracker beep, aiding in finding nearby items.



## Loud Ring & Precision Finding

Use the built-in speaker to ring your Smart Tag or leverage precision finding to locate items with ease.

Image: Highlights the "Loud Ring & Precision Finding" feature, showing how the tracker's built-in speaker can be used to locate items with ease.

### 3.2. Left-Behind Remind

The tracker can notify you if you leave an item behind. When the tracker moves out of range of your phone, you may receive an alert on your device, indicating the item is no longer detected nearby and showing its last known location.



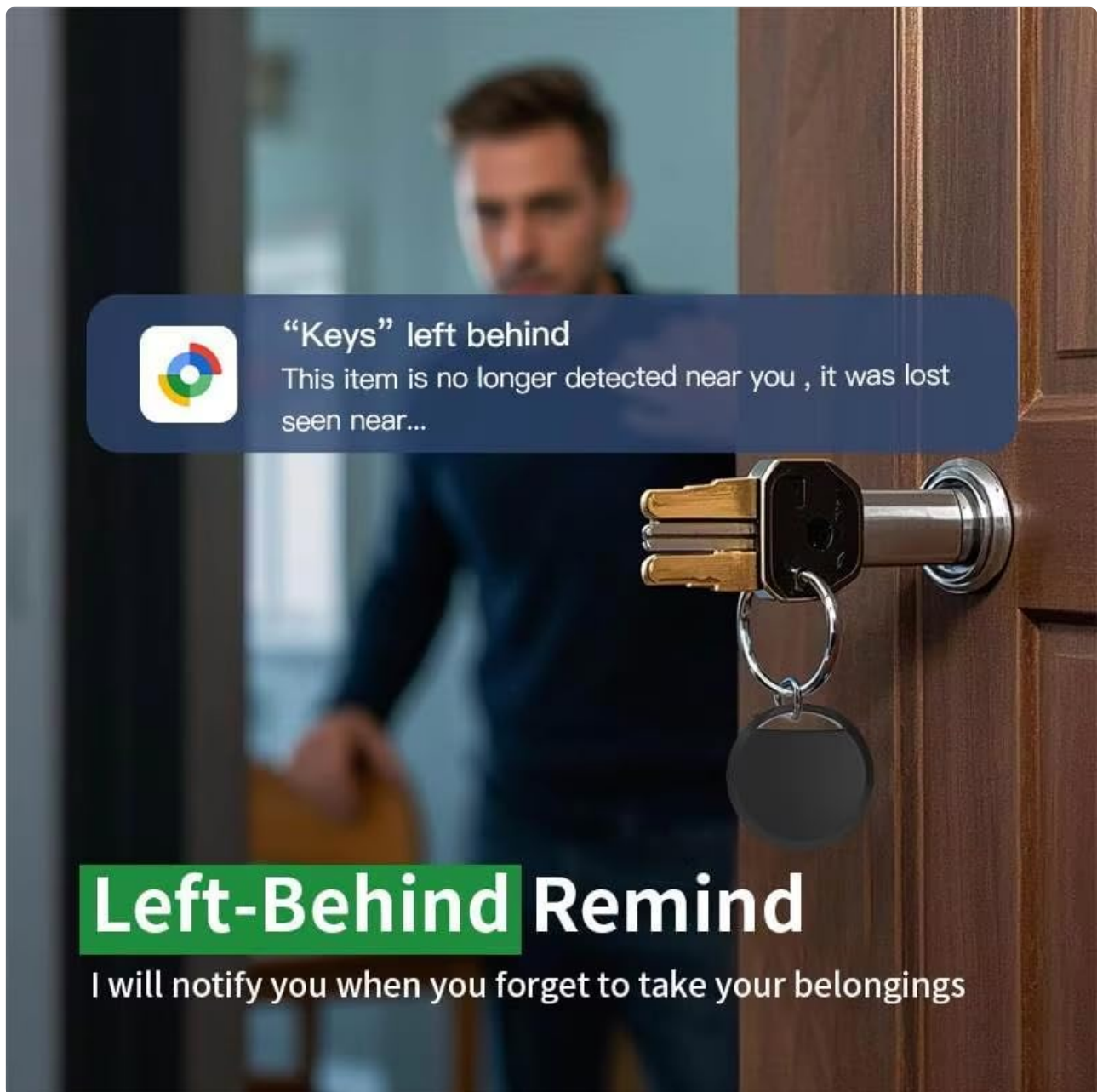

Image: Illustrates the "Left-Behind Remind" function, where the user is notified if they forget their belongings, showing a notification for "Keys" left behind.

### 3.3. Worldwide Tracking

Leveraging the Google Find My Device network, your tracker can be located globally. If your item is lost and comes within range of any Android device on the Find My Device network, its location will be updated, allowing you to track it from anywhere with no distance limits.

# Global precise positioning tracking

With Google System Support Accurate Tracking Worldwide

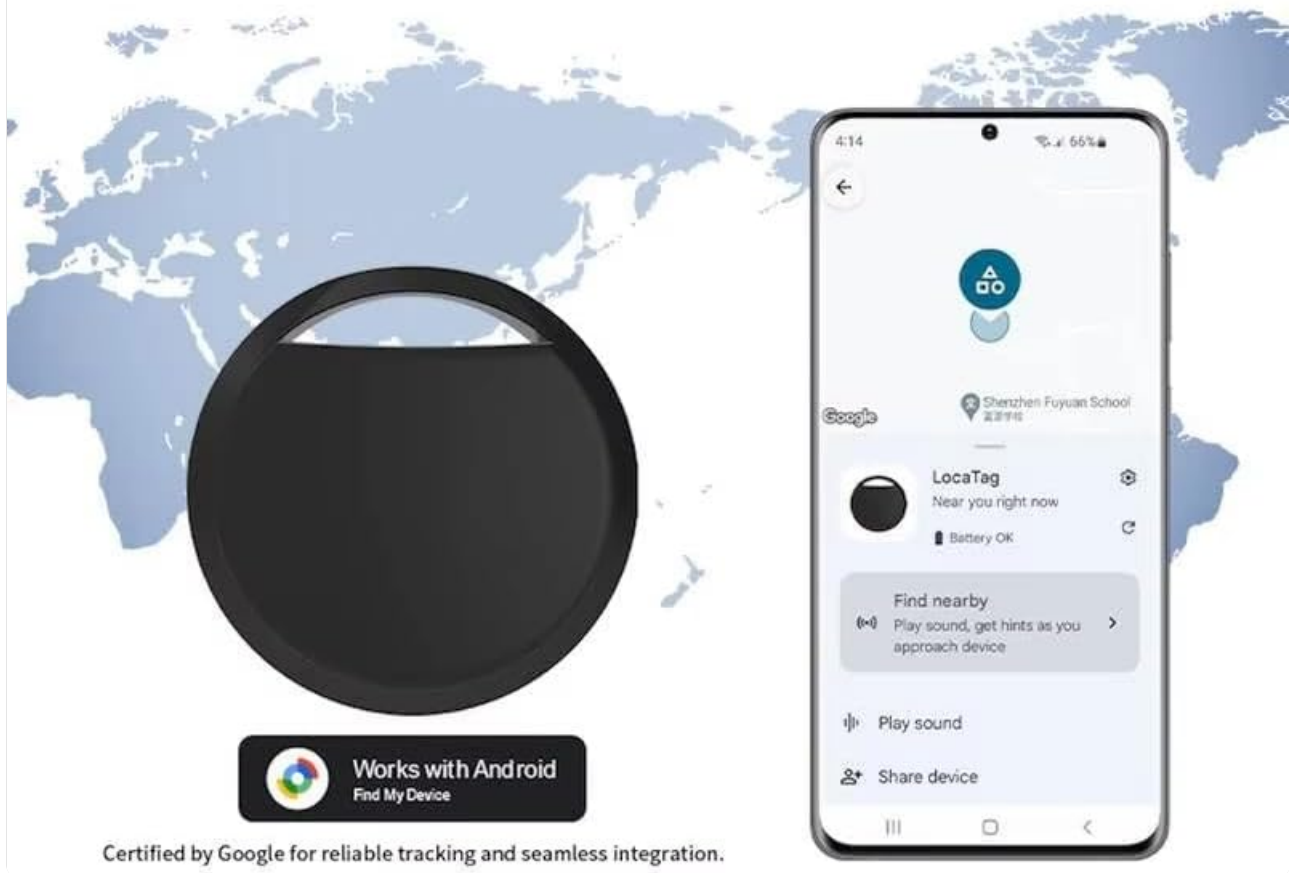

Image: Depicts the global precise positioning tracking feature, showing the tracker and a phone displaying its location on a world map, supported by the Google system.

## 4. MAINTENANCE

### 4.1. Battery Replacement

The CR2032 battery typically lasts up to one year. When the battery is low, you may receive a notification in the Google Find My Device app. Replace the battery as described in Section 2.1 to ensure continuous operation.

### 4.2. Cleaning

To clean your tracker, gently wipe it with a soft, dry, or slightly damp cloth. Do not use harsh chemicals or abrasive materials, as these can damage the device. Ensure the tracker is completely dry before re-attaching it to items.

## 5. TROUBLESHOOTING

If you encounter issues with your Bluetooth tracker, try the following steps:

- **Tracker Not Found / Not Connecting:**
  - Ensure your phone's Bluetooth is enabled.
  - Check if the tracker's battery is dead or low. Replace it if necessary.



- Make sure the tracker is within Bluetooth range of your phone (typically up to 30 feet indoors).
- Restart your phone's Bluetooth or the phone itself.
- Try re-pairing the tracker through the Google Find My Device app.

- **Sound Not Playing:**

- Ensure the tracker is within range and connected.
- Check the volume settings on your phone.
- Verify the tracker's battery level.

- **Inaccurate Location:**

- Ensure your phone has a stable internet connection (Wi-Fi or mobile data) and GPS is enabled.
- Location accuracy depends on the density of the Google Find My Device network. In sparse areas, the last known location might be less precise.

- **Battery Drains Quickly:**

- Ensure you are using a fresh, high-quality CR2032 battery.
- Extreme temperatures can affect battery life.

For further assistance, refer to the help section within the Google Find My Device application or consult the Google support website.

## 6. SPECIFICATIONS

Feature	Detail
<b>Model Number</b>	HK-CW-007
<b>ASIN</b>	B0F3WZCW5L
<b>Dimensions</b>	Approx. 2 x 2 x 1 inches (Package Dimensions)
<b>Item Weight</b>	0.8 ounces
<b>Battery Type</b>	1 x CR2032 (replaceable)
<b>Battery Life</b>	Up to 1 year
<b>Connectivity</b>	Bluetooth, Google Find My Device Network
<b>Compatible Devices</b>	Most Android phones (Samsung, Google, Xiaomi, Oppo, Vivo, etc.)
<b>Material</b>	Electronic Components, Plastic
<b>Color</b>	Black (for this specific model)
<b>Manufacturer</b>	China
<b>Country of Origin</b>	China

## 7. WARRANTY AND SUPPORT

Specific warranty information for this product is not provided in this manual. Please refer to the product packaging or the retailer's website for details regarding warranty coverage and terms.

For technical support or further inquiries, please contact the seller or refer to the support resources available through the Google Find My Device platform.

---

© 2025 Generic. All rights reserved.

This manual is for informational purposes only. Product specifications and features are subject to change without notice.