



[Manuals.plus](#) /

> [Halitaa](#) /

> Halitaa Farmhouse Shoe Storage Organizer User Manual

## Halitaa J6L039BR01A

# Halitaa Farmhouse Shoe Storage Organizer User Manual

Model: J6L039BR01A

[Safety](#)

[Information](#)

[Components](#)

[Setup](#)

[Operating](#)

[Maintenance](#)

[Troubleshooting](#)

[Specifications](#)

[Support](#)

## INTRODUCTION

---

Thank you for choosing the Halitaa Farmhouse Shoe Storage Organizer. This cabinet is designed to provide an efficient and stylish solution for organizing your footwear and other personal items in entryways, hallways, or living rooms. Featuring adjustable shelves and a convenient top drawer, it accommodates various shoe types, including boots, and offers additional storage for small essentials. Please read this manual carefully before assembly and use to ensure proper installation and safe operation.



Image: The Halitaa Farmhouse Shoe Storage Organizer with its double doors open, showcasing multiple shelves filled with various types of shoes. A top drawer is also visible, and the cabinet features a rustic brown finish with black metal hardware.

## SAFETY INFORMATION

---

Please adhere to the following safety guidelines to prevent injury or damage to the product:

- Always follow the assembly instructions carefully.
- Use the anti-tipping device provided to further enhance overall stability and prevent accidental tipping. This is crucial for households with children or pets.
- Do not overload the cabinet. Distribute weight evenly on shelves.
- Keep the area around the cabinet clear of obstacles to prevent tripping hazards.
- Use appropriate safety gear, such as gloves, when assembling the cabinet to protect your hands.
- Ensure all screws and fasteners are securely tightened before use. Periodically check and re-tighten if necessary.

# Prevent Tip-over Incidents Ensuring Your Family's Safety

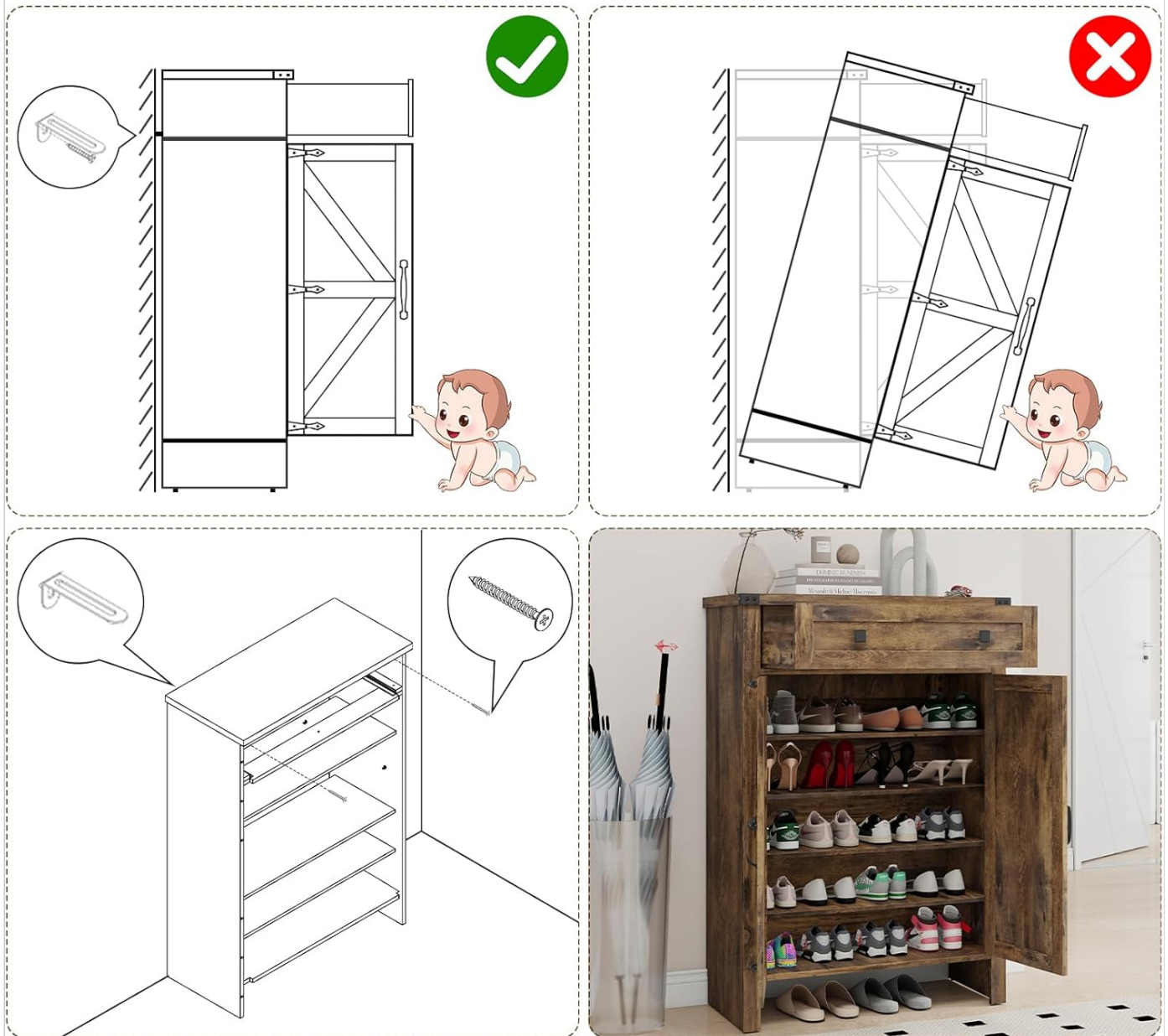

Image: A diagram showing the proper installation of the anti-tipping device, with a green checkmark indicating correct setup and a red 'X' indicating an unstable, untethered cabinet. This highlights the importance of securing the cabinet to the wall.

## COMPONENTS AND PARTS LIST

Before beginning assembly, ensure all parts are present and undamaged. Refer to the detailed installation instructions included in the packaging for a complete list of labeled parts and hardware.

- Shoe Cabinet Panels (various sizes for frame, doors, shelves, drawer)
- Installation Tools (basic tools may be included, check packaging)
- User Manual (this document)
- Metal Handles (for drawer and doors)
- Hinges and Drawer Slides
- Anti-tipping Device
- Screws, Dowels, and other Fasteners
- Non-slip Pads for base



Image: A technical drawing of the shoe cabinet with all key dimensions labeled in inches, including the overall height (45.43"), width (31.50"), depth (14.57"), and internal shelf heights, as well as drawer dimensions.

## SETUP AND ASSEMBLY

---

The Halitaa shoe cabinet is designed for easy assembly. Follow the step-by-step instructions provided in the separate installation guide that came with your product. Spare parts are labeled with numbers, and precise holes ensure accurate and quick assembly.

### Assembly Steps Overview:

1. **Unpack and Identify Parts:** Lay out all components on a clean, soft surface to prevent scratches. Match each part to the corresponding number in the instruction manual.
2. **Assemble the Frame:** Connect the side panels, top, and bottom panels using the provided fasteners.
3. **Install Shelves:** Insert the shelf pins into the pre-drilled holes at your desired height. Place the shelves onto the pins. Remember, three shelves are freely detachable for customized storage.

4. **Assemble and Install Drawer:** Follow instructions to build the drawer box and attach the metal handles and drawer slides. Slide the assembled drawer into its designated slot.
5. **Attach Doors:** Secure the hinges to the doors and then attach the doors to the main cabinet frame. Ensure doors open and close smoothly.
6. **Install Anti-Tipping Device:** This is a critical safety step. Secure the anti-tipping device to the back of the cabinet and then to a wall stud using the provided hardware.
7. **Attach Non-slip Pads:** Place the non-slip pads on the bottom of the cabinet legs to protect your floor and enhance stability.



Elegant Metal Handles



Stylish & Sturdy Iron Corner

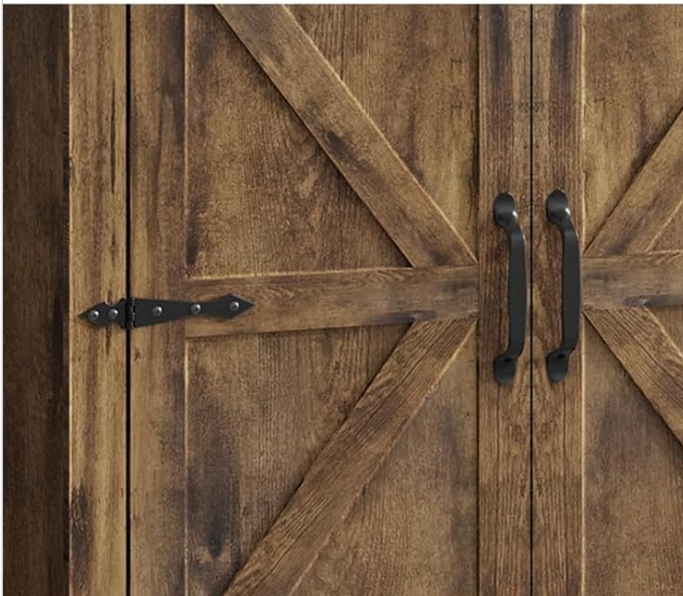

→-shaped Pattern



Stable Legs with Anti-slip & Scratch-resistant Pads

Image: A collage of four close-up images detailing the cabinet's design elements: elegant black metal handles, stylish and sturdy iron corner protectors, the distinctive X-shaped barn door pattern on the cabinet doors, and the stable legs equipped with anti-slip and scratch-resistant pads.

## OPERATING INSTRUCTIONS

---

The Halitaa Shoe Storage Organizer is designed for versatile storage and easy access.

### Shoe Storage:

- **Adjustable Shelves:** The cabinet features 3 freely detachable shelves. To adjust, simply remove the shelf and reposition the shelf pins into the desired pre-drilled holes. This allows you to customize the height of each compartment to accommodate various shoe types, including high heels, ankle boots, and tall boots.
- **High-Shoe/Boot Storage:** By removing one or more shelves, you can create larger vertical spaces specifically for storing taller footwear like martin boots or high-top shoes without squeezing or deforming them.
- **Double-Door Access:** The double-door design provides a wide opening, allowing you to easily see and access all your stored shoes at a glance.

### Drawer and Top Surface Use:

- **Large-Capacity Drawer:** The top drawer, equipped with two metal handles, is ideal for storing smaller items you need quick access to when entering or leaving your home. This includes keys, wallets, coin purses, cleaning supplies, or other personal belongings.
- **Spacious Top Surface:** The flat top surface of the cabinet can be utilized to place decorative objects, handbags, mail, or other items, maximizing the utility of the furniture piece.



Image: Two identical shoe cabinets are shown. The cabinet on the left has all shelves in place, storing various low-profile shoes. The cabinet on

the right demonstrates the adjustable shelf feature, with one shelf removed to create a taller compartment suitable for storing high boots upright.



Image: A close-up, overhead view of the open top drawer of the shoe cabinet. The drawer contains various small items such as eyeglasses, a notebook, a pen, a watch, wireless earbuds, and a wallet, demonstrating its utility for storing everyday essentials.

## MAINTENANCE

---

To keep your Halitaa Shoe Storage Organizer in optimal condition, follow these simple maintenance tips:

- **Cleaning:** Wipe the cabinet surfaces with a soft, damp cloth. Avoid using harsh chemicals or abrasive cleaners, as they may damage the finish.
- **Dusting:** Regularly dust the cabinet with a dry, soft cloth to prevent dust buildup.
- **Spills:** In case of spills, wipe them immediately with a dry cloth to prevent moisture damage.
- **Hardware Check:** Periodically check all screws, bolts, and fasteners to ensure they are tight. Re-tighten if necessary to maintain stability.
- **Avoid Direct Sunlight:** Prolonged exposure to direct sunlight can cause fading or warping of the wood finish.
- **Humidity Control:** Maintain a stable room temperature and humidity level to prevent wood expansion or contraction.

## TROUBLESHOOTING

---

Here are some common issues and their potential solutions:

Problem	Possible Cause	Solution
Cabinet is wobbly or unstable.	Loose fasteners; uneven floor; anti-tipping device not installed.	Ensure all screws are tightened. Move to a level surface or use shims. Install the anti-tipping device as per instructions.
Doors do not close properly or are misaligned.	Hinges are loose or improperly adjusted; cabinet not level.	Check and tighten hinge screws. Adjust hinges as needed (refer to assembly guide). Ensure the cabinet is on a level surface.
Drawer sticks or does not slide smoothly.	Drawer slides are misaligned or dirty; drawer overloaded.	Check that drawer slides are correctly installed and aligned. Clean slides if necessary. Reduce the weight in the drawer.
Missing parts during assembly.	Packaging error; parts overlooked.	Carefully re-check all packaging materials. Contact Halitaa customer service for assistance.

## SPECIFICATIONS

---

Feature	Detail
Brand	Halitaa
Model Name	J6L039
Item Model Number	J6L039BR01A
Color	Brown
Product Dimensions	14.57"D x 31.5"W x 45.43"H
Item Weight	41 Pounds
Material	Engineered Wood (Frame), Walnut Wood (Top), Metal (Handle)
Mounting Type	Floor Mount (Freestanding)
Number of Shelves	5 (3 freely detachable)
Special Features	Anti-Tipping, Long Boots Storage Freely, Removable Shelf, Top Drawer
Assembly Required	Yes
Recommended Uses	Home Decor, Shoe Storage
Room Type	Entryway, Hallway, Living Room

## WARRANTY AND CUSTOMER SUPPORT

---

Halitaa is committed to providing quality products and services. If you have any questions about your shoe storage cabinet before or after your purchase, including inquiries about missing parts, assembly issues, or product defects, please do not hesitate to contact our customer service team. We aim to reply within 24 hours.

For specific warranty information, please refer to the documentation included with your purchase or contact Halitaa customer support directly. Keep your purchase receipt as proof of purchase.



© 2025 Halitaa. All rights reserved.