

Redroad R11

Redroad R11 Robot Vacuum and Mop Cleaner User Manual

Model: R11

1. INTRODUCTION

Thank you for choosing the Redroad R11 Robot Vacuum and Mop Cleaner. This manual provides essential information for the safe and efficient operation, maintenance, and troubleshooting of your device. Please read this manual thoroughly before use and retain it for future reference.



Figure 1: Redroad R11 Robot Vacuum and Mop Cleaner with its self-emptying station and mobile application.

2. IMPORTANT SAFETY INSTRUCTIONS

To reduce the risk of injury or damage, read these safety instructions carefully when setting up, using, and maintaining your robot.

- This appliance can be used by children aged 8 years and above and persons with reduced physical, sensory or mental capabilities or lack of experience and knowledge if they have been given supervision or instruction concerning use of the appliance in a safe way and understand the hazards involved.
- Children should be supervised to ensure that they do not play with the appliance.
- Cleaning and user maintenance shall not be made by children without supervision.
- Use only the power adapter supplied by the manufacturer.
- Do not use the robot in environments with open flames or fragile objects.
- Ensure the charging dock is placed on a level surface against a wall, with adequate clear space around it.

3. PACKAGE CONTENTS

Verify that all components are present and in good condition upon unboxing.



Figure 2: Included components of the Redroad R11 package.

- Main Robot Unit
- Self-Emptying Station
- 2-in-1 Dustbin & Water Tank
- Mop Cloths (2)
- High-Efficiency Filters (2)
- Anti-Tangle Side Brushes (2)
- Dust Bags (2)
- Cleaning Brush
- User Manual (this document)

4. SETUP

4.1 Charging Station Placement

Place the self-emptying station on a hard, level surface against a wall. Ensure there is at least 0.5 meters (1.6 feet) of clear space on both sides and 1.5 meters (4.9 feet) in front of the station for optimal robot navigation and return.

4.2 Initial Charge

Before first use, fully charge the robot. Place the robot onto the charging pins of the self-emptying station. The indicator lights will show charging status. A full charge typically takes approximately 4-5 hours.

4.3 App Installation and Wi-Fi Connection

Download the Redroad app from your mobile device's app store. Follow the in-app instructions to connect your robot to your home Wi-Fi network. The R11 supports both 2.4GHz and 5GHz Wi-Fi bands.

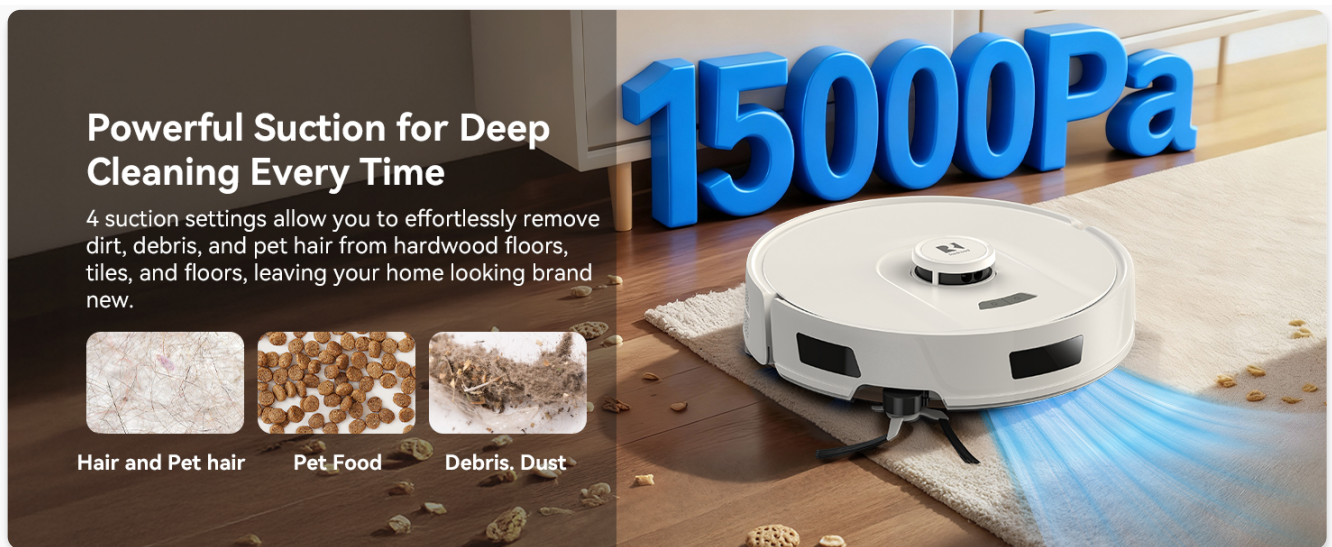

Figure 3: Connecting the Redroad R11 to the mobile application and enabling voice control.

5. OPERATING INSTRUCTIONS

5.1 Cleaning Modes

The Redroad R11 offers versatile cleaning options:

- **Vacuum Only:** For dry debris and carpet cleaning. Ensure the mop module is removed for optimal carpet vacuuming.
- **Mop Only:** For hard floors. The robot precisely controls water flow to prevent leaks or over-wetting.
- **Vacuum & Mop:** Simultaneous cleaning for hard floors.

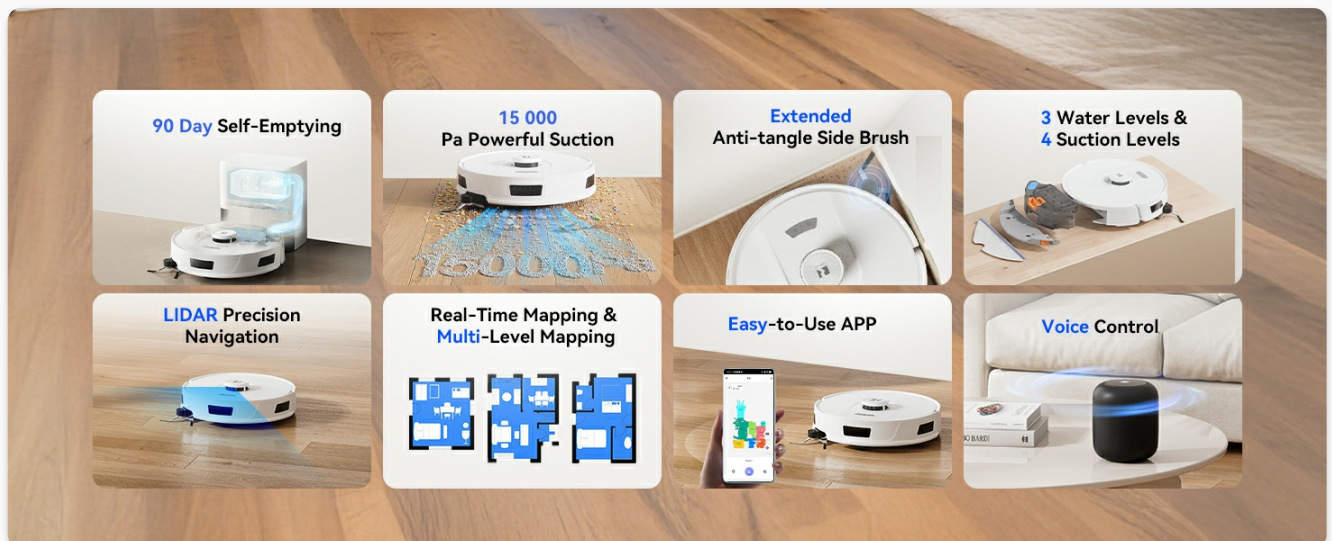

Figure 4: The Redroad R11 supports Vacuum Only, Mop Only, and combined Vacuum & Mop modes.

5.2 Starting a Cleaning Cycle

You can start a cleaning cycle using the physical button on the robot, the mobile app, or voice commands (if integrated with Alexa/Google Home).

5.3 Smart Navigation and Mapping

The R11 uses 360° Smart LiDAR Navigation to create an efficient cleaning route and map your home. This allows for multi-level mapping and precise room recognition.

Dear Customer,

thank you for your interest in our product! Providing you with a high-quality shopping experience is our core tenet.

We apologize that the relevant accessories of this product (including dust bags) are temporarily out of stock.

resulting in delayed delivery. The accessories are already in transit and are expected to arrive by the end of November.

Please rest assured that the product you purchased includes two dust bag accessories, which are sufficient for 180 days of use. We are making every effort to optimize our processes and will provide you with smoother services in the future.



Figure 5: The R11's 360° Smart LiDAR Navigation for efficient cleaning and multi-floor mapping.

5.4 Customizing Cleaning Settings

Through the Redroad app, you can:

- Set cleaning schedules for specific times.
- Adjust suction levels (4 levels available) and water flow levels (3 levels available) for different rooms or floor types.
- Define No-Go Zones and Virtual Walls to restrict the robot from certain areas.
- Select specific rooms or zones for cleaning.

Extra-Long Mechanical Arm Design

Get into every nook and cranny, leaving not a speck of dust behind!

100% Edge Coverage



Figure 6: Customizing cleaning solutions and schedules via the Redroad mobile application.

Upgraded External Expansion Untangling **Edge Brush**

The side brush allows hair to fall out automatically. Combined with a flexible roller brush that is quiet and powerful, it achieves the best cleaning results.

 **Edge Brush Hair En-
tanglement Rate**

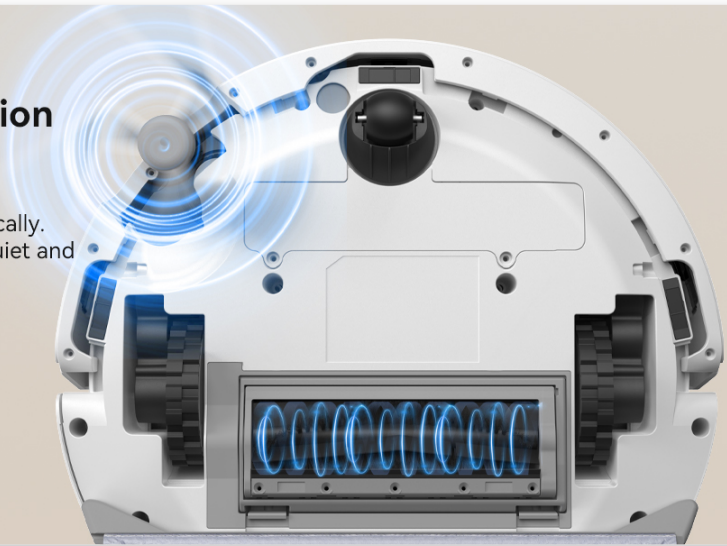
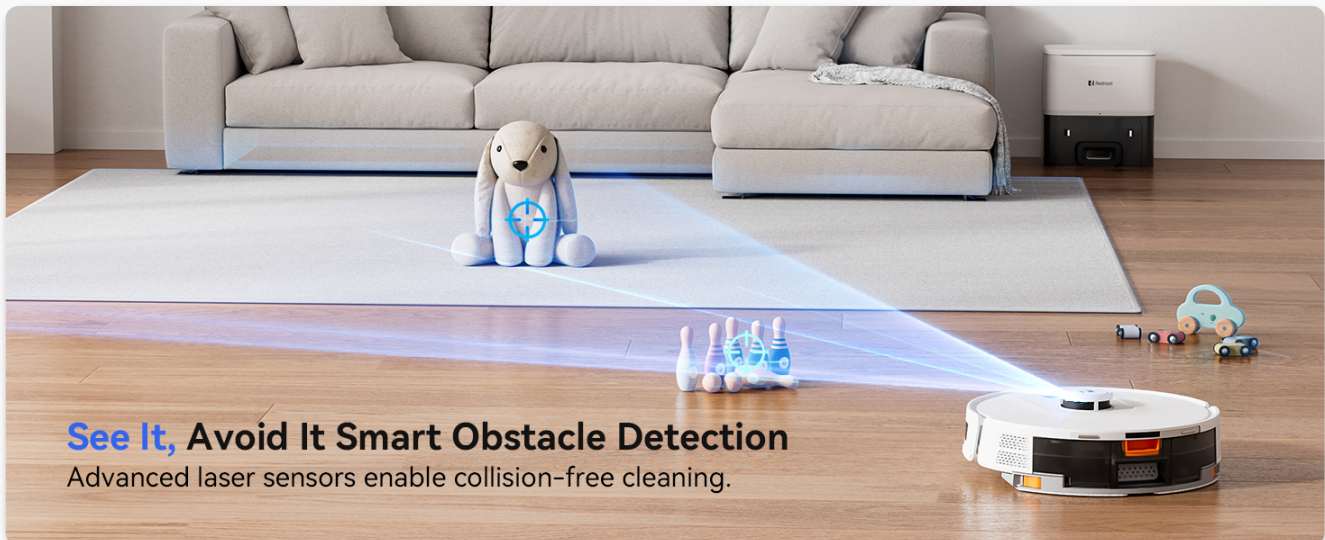

Figure 7: Setting up No-Go Zones and Virtual Walls for precise cleaning management.

5.5 Automatic Features

- **Auto-Boost Suction:** Ultrasonic sensors automatically detect carpets and increase suction power to 15,000Pa for deep cleaning.
- **Self-Emptying:** The robot automatically empties its dustbin into the 3.8L dust bag in the self-emptying station, providing up to 90 days of hands-free dust collection.
- **Recharge and Resume:** If the battery runs low during a cleaning cycle, the robot will return to the charging station, recharge, and then resume cleaning from where it left off.



See It, Avoid It Smart Obstacle Detection

Advanced laser sensors enable collision-free cleaning.

Figure 8: Smart Auto-Boost Suction feature for enhanced carpet cleaning.

90 Days of Automatic Dust Collection

4L upgraded high-capacity dust bag, no need to take out the trash for 13 weeks, save time and hassle!



Figure 9: The 90-day automatic dust collection system with a 4L dust bag.

6. MAINTENANCE

Regular maintenance ensures optimal performance and extends the lifespan of your Redroad R11.

6.1 Dust Bag Replacement

The 3.8L dust bag in the self-emptying station should be replaced approximately every 90 days, or when the app indicates it is full. Open the station's lid, remove the full bag, and insert a new one.

6.2 Dustbin and Water Tank Cleaning

The 2-in-1 dustbin and water tank should be emptied and rinsed after each mopping session or as needed. Remove the module from the robot, separate the components, empty debris, and rinse with water. Allow to air dry completely before reinserting.

6.3 Side Brush Cleaning

The extended anti-tangle side brushes should be checked and cleaned regularly to remove tangled hair and debris. The design minimizes hair entanglement, but periodic inspection is recommended.

No-Go Zone & Virtual Wall

Smarter, safer cleaning management



Figure 10: The extra-long mechanical arm design of the side brush for enhanced edge coverage.



Figure 11: The upgraded external expansion untangling edge brush system.

6.4 Main Brush Cleaning

Remove the main brush cover and lift out the main brush. Use the provided cleaning tool to cut and remove any tangled hair or fibers. Reinstall the brush and cover securely.

6.5 Filter Cleaning/Replacement

The HEPA filter located in the dustbin should be tapped clean periodically to remove dust. Replace the filter every 3-6 months, or as needed, to maintain optimal suction performance.

6.6 Sensor Cleaning

Wipe all sensors (Lidar, cliff sensors, wall sensors) with a clean, dry cloth to ensure accurate navigation and obstacle detection.

7. TROUBLESHOOTING

If you encounter issues with your Redroad R11, refer to the following common problems and solutions:

Problem	Possible Cause	Solution
Robot does not turn on or charge	Low battery; improper docking; power adapter issue	Ensure robot is correctly docked; check power connection; allow initial charge.
Poor cleaning performance	Full dustbin; clogged brushes/filter; low suction setting	Empty dustbin; clean/replace brushes and filter; increase suction via app.
Robot gets stuck frequently	Obstacles; dark surfaces (cliff sensors); tangled wires	Clear obstacles; use No-Go Zones; secure loose cables.
App connectivity issues	Incorrect Wi-Fi password; router too far; wrong Wi-Fi band	Verify Wi-Fi credentials; move robot closer to router; ensure 2.4GHz/5GHz compatibility.
Mop not dispensing water	Empty water tank; clogged water nozzle; incorrect water flow setting	Fill water tank; clean water nozzle; adjust water flow in app.

8. SPECIFICATIONS

Feature	Specification
Model	R11
Suction Power	Up to 15,000 Pa
Battery Capacity	3200 mAh Lithium Ion
Runtime	Up to 1 hour 15 minutes
Dust Bag Capacity (Self-Emptying Station)	3.8 L (approx. 90 days)
Navigation System	360° Smart LiDAR
Wi-Fi Connectivity	2.4GHz & 5GHz Dual Band
Filter Type	HEPA
Product Dimensions	24.9L x 15.7W x 25.5H Centimetres
Item Weight	7.34 kg
Color	White

9. WARRANTY AND SUPPORT

9.1 Warranty Information

The Redroad R11 Robot Vacuum and Mop Cleaner comes with a **2-Year Warranty**. This warranty covers manufacturing defects and operational malfunctions under normal use conditions.

9.2 Customer Support





For any operational issues, malfunctions, or warranty claims, please contact Redroad's official after-sales support team. We are committed to providing effective solutions within 24 hours. Please refer to the product packaging or the Redroad official website for specific contact details.



© 2025 Redroad. All rights reserved.

Related Documents - R11

	<p>R11 Smart Ring Technical Specifications and Features</p> <p>Comprehensive technical specifications for the R11 Smart Ring, detailing its hardware components, software functionalities, app integration, system requirements, and packaging information. Discover the advanced features of this wearable device.</p>
--	---

 <p>The image shows the cover of the 'WhatsGPS R11 GPS Tracker User Manual'. It features a black GPS tracker device on a white background. The text 'WhatsGPS' is at the top, followed by 'GPS Tracker' and 'Model R11'. Below the device image, it says 'User Manual'.</p>	<p>WhatsGPS R11 GPS Tracker User Manual</p> <p>User manual for the WhatsGPS R11 GPS Tracker, detailing product description, features, specifications, installation, and troubleshooting.</p>
 <p>The image shows the cover of the 'Shenzhen Woopoint Technology Fitness Band User Manual (Model R11)'. It features a grid of small images showing the fitness band in various colors and usage scenarios. The text 'Shenzhen Woopoint Technology' is at the top, followed by 'Fitness Band User Manual (Model R11)'.</p>	<p>Shenzhen Woopoint Technology Fitness Band User Manual (Model R11)</p> <p>User manual for the Shenzhen Woopoint Technology Fitness Band (Model R11), providing setup and usage information in multiple languages, along with FCC compliance details.</p>
	<p>MERACH R11 Air Rowing Machine User Manual</p> <p>Comprehensive user manual for the MERACH R11 Air Rowing Machine, detailing setup, operation, maintenance, safety instructions, and app integration.</p>
 <p>The image shows the cover of the 'Smart Camera Quick Manual - iCSee App'. It features a small image of a smart camera and the text 'Smart Camera Quick Manual - iCSee App'.</p>	<p>Smart Camera Quick Manual - iCSee App</p> <p>A concise guide to setting up and using a smart camera with the iCSee app, covering app download, device setup, Wi-Fi configuration, and cloud storage options.</p>
 <p>The image shows the cover of the 'Armstrong Flooring Cleaning and Care Instructions for Homogeneous Vinyl Sheet & Safeguard Ranges'. It features a grid of small images showing the flooring in various settings. The text 'Armstrong Flooring' is at the top, followed by 'Cleaning and Care Instructions for Homogeneous Vinyl Sheet & Safeguard Ranges'.</p>	<p>Armstrong Flooring Cleaning and Care Instructions for Homogeneous Vinyl Sheet & Safeguard Ranges</p> <p>Comprehensive cleaning and care instructions for Armstrong Flooring's Homogeneous Vinyl Sheet and Safeguard ranges, including initial care, routine maintenance, and protection during construction.</p>



[\[pdf\]](#) User Manual

MacUser Jun 1989 restored ocr bookmarks by Steve 8906 June Vintage Apple Grehcnsvie manual Or you can call one number them in action pushed the envelope of For instance I saw a cbart your very favor vintageapple org macuser

Wingz: 3-D Spreadsheet Breakthrough : SPEBJY 88030 CPUs -I Special Report: Mac IIcx Under the Ho ... Can tor additional Inormalion.Copyrioht C 19S9 by Om e Corpo1i lon. ORACLEis a 1eolsiered fadem1r11 olOracl. Theother companies mcntlonroown numeios 11ademar1cs. TRBA ,----- Dear Ora...

lang:en score:8 filesize: 59.99 M page_count: 306 document date: 2017-08-08