

Manuals+

[Q & A](#) | [Deep Search](#) | [Upload](#)

manuals.plus /

› **COREBOX** /

› **COREBOX 10-Amp Car Battery Charger User Manual**

COREBOX 10-Amp Car Battery Charger

COREBOX 10-Amp Car Battery Charger User Manual

Model: 10-Amp Car Battery Charger (Red-10E)

Brand: COREBOX

INTRODUCTION

The COREBOX 10-Amp Car Battery Charger is a versatile and intelligent device designed to efficiently charge and maintain various 12V batteries. Its compact design and advanced features make it an essential tool for vehicle owners, ensuring optimal battery performance and longevity.



The COREBOX 10-Amp Car Battery Charger is a versatile and intelligent device designed to efficiently charge and maintain various 12V batteries. Its compact design and advanced features make it an essential tool for vehicle owners.

SAFETY INFORMATION

Always prioritize safety when operating electrical devices. Please read and understand all safety precautions before using the COREBOX Battery Charger.

- Read the user manual carefully before using the charger.
- Ensure proper ventilation and avoid charging in a confined space.
- Only use the charger with compatible battery types as specified.
- Avoid exposure to water or extreme temperatures.
- Keep children and pets away from the charger during operation.
- Disconnect the charger from the power source before disconnecting from the battery.
- If any abnormality or damage occurs, stop using the charger immediately and contact customer support.
- Follow the vehicle's battery charging guidelines for proper maintenance.

PRODUCT OVERVIEW

Product Components

- COREBOX 10-Amp Battery Charger Unit
- Battery Alligator Clamps (Red for Positive, Black for Negative)
- AC Power Cord
- User Manual

LCD Display Description



The clear LCD display provides real-time information including charging status, voltage, current, battery type, temperature, and error codes. This intuitive interface ensures easy monitoring of the charging process.

SETUP

Initial Setup

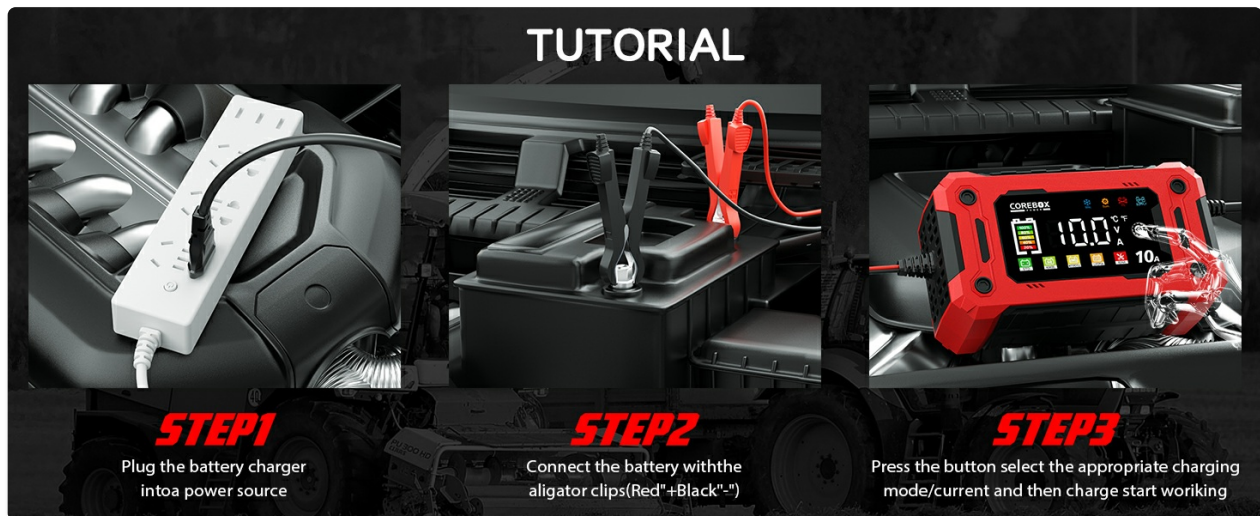

Follow these simple steps to set up your COREBOX battery charger. Ensure all connections are secure before powering on the device.

Connection Steps:

1. **Step 1:** Plug the battery charger into a power source.
2. **Step 2:** Connect the alligator clips to the battery terminals. Attach the **RED (+)** clamp to the positive battery terminal and the **BLACK (-)** clamp to the negative battery terminal.
3. **Step 3:** Press the mode button to select the appropriate charging mode/current, and then charging will begin automatically.

OPERATING MODES

MODE SWITCHING



Press this button to toggle charging modes

The charger features a mode selection button to cycle through different charging programs tailored for specific battery types.

- **Standard (STD) Mode:** For ordinary Lead-Acid batteries, including AGM, GEL, SLA, Flooded, and WET batteries.
- **AGM/GEL Mode:** Specifically designed for AGM and GEL batteries.
- **Motorcycle Mode:** Optimized for motorcycle batteries and other small 12V batteries.
- **LiFePO4 Mode:** For Lithium Iron Phosphate batteries.
- **Repair Mode:** Suitable for batteries with issues that cannot be charged normally. This mode attempts to repair and reactivate the battery.
- **Supply Mode:** Provides a stable 12V DC power supply for equipment that requires it, when a 12V battery is not connected.

Compatible Battery Types:

COMPATIBLE TYPES

LiFePO4 GEL EFB AMG WET Lead acid Deep cycle,etc.



This versatile charger supports a wide range of 12V battery types, ensuring compatibility with most vehicles and power needs.

FEATURES AND PROTECTION

9-Stage Intelligent Charging:

9-STAGE CHARGING

9-stages charging gently and accurately charge the battery.

1. Battery desulfation
2. Soft start charging
3. Bulk charging
4. Absorption charging
5. Trickle charge
6. Battery test
7. Recondition charging
8. Float&maintenance charging
9. Small current to maintain charging

The 9-stage intelligent charging system gently and accurately charges the battery, including advanced features like desulfation, repair, and low-current maintenance to restore, protect, and extend battery life.

Temperature Adjustment:

OPERATING MODE

Follow the steps below



Summer mode

Summer mode activates automatically above 80.6°F



Winter mode

Winter mode activates automatically below 50°F



The charger automatically adjusts charging based on ambient temperature, activating Winter Mode below 50°F and Summer Mode above 80.6°F for optimal performance.

Multiple Protection Features:

MULTIPLE PROTECTION

Safer and more reliable charging with built-in protection



Overheat Protection



Reverse Polarity Protection



Short circuit protection



Overcurrent Protection



Overload Protection



Auto Shut-Off



Overvoltage Protection

Equipped with comprehensive safety features including over-voltage, over-current, short-circuit, overheat, and reverse polarity protection, ensuring safe and worry-free use.

MAINTENANCE

Proper maintenance of your battery and charger will extend their lifespan and ensure reliable operation.

- Regularly check battery terminals for corrosion and clean them as needed.
- Ensure the battery is securely mounted to prevent vibration damage.
- For vehicles stored for extended periods, use the trickle charge or maintenance mode to keep the battery optimally charged.
- Avoid fully discharging your battery, as this can shorten its lifespan.
- Store batteries in a cool, dry place when not in use.

TROUBLESHOOTING COMMON PROBLEMS

Problem	Possible Cause	Solution
---------	----------------	----------

Problem	Possible Cause	Solution
The battery is low, but charger displays "FUL" (Fully Charged) when charging.	The voltage of the battery has become too low after long period non-use or the battery can be vulcanized.	Try the Repair Mode. If the battery still cannot be charged, it may need replacement.
The charger is not responding when plugged in.	No mains input or faulty power supply.	Check if the socket is active. Ensure the power cord is securely connected.
AC power supply is powered on, but the LCD screen is off.	Battery has zero power or is severely damaged.	The charger may not recognize a completely dead battery. Try charging in parallel with a known good battery or replace the battery.
Dissatisfaction for a long time (battery not fully charging or taking too long).	The battery may be old, damaged, or experiencing high internal resistance. Charger may also be overheating.	Check battery health. Ensure proper ventilation around the charger. If the battery is boiling, it may be short-circuited and needs replacement.

TECHNICAL SPECIFICATIONS

Specification	Value
Product Dimensions	8.4 x 2.6 x 4.3 inches
Item Weight	1.28 pounds
ASIN	B0F388RQ59
Customer Reviews	4.8 out of 5 stars (53 ratings)
Best Sellers Rank	#33,396 in Automotive (#165 in Battery Chargers)
Date First Available	April 1, 2025
Manufacturer	COREBOX
Brand	COREBOX
Color	Red-10E
Input Voltage	12 Volts
UPC	762949307922

PRODUCT OUTLINE DRAWING

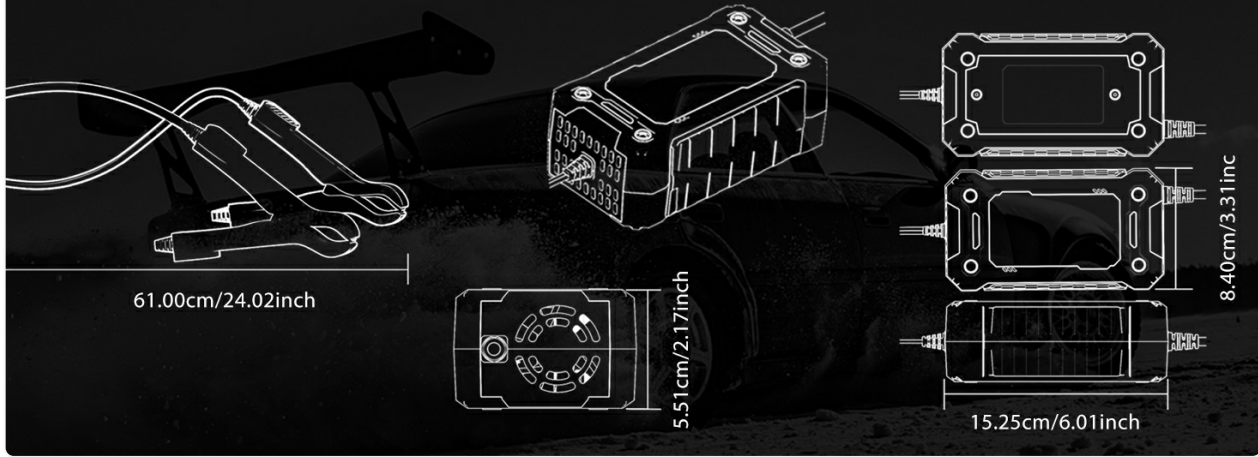

Detailed dimensions of the COREBOX 10-Amp Car Battery Charger, highlighting its compact and portable design.

OFFICIAL PRODUCT VIDEOS

Watch the official product video from the seller for a visual guide on the COREBOX 10-Amp Car Battery Charger.

Your browser does not support the video tag.

This video provides a quick overview of the COREBOX 12V Car Battery Charger (10E), demonstrating its compact size and basic functionality.

WARRANTY AND SUPPORT

COREBOX stands behind the quality of its products. While our brand is new to Amazon, we have been providing high-quality products and exceptional customer service for years in the offline market. We offer a full satisfaction guarantee. If you encounter any issues, our dedicated support team is ready to assist you, ensuring peace of mind with every purchase.

For further assistance or inquiries, please refer to the contact information provided in your product packaging or visit the official COREBOX website.